

**2BHK
FLAT**



APEX DEVELOPERS

Office Add:- Shop No.1, Plot No.29, Sector-25A, Ulwe

CONTACT FOR BOOKING

📞 9821773623

Project Specification

FLOORING

24"x48" Vitrified Flooring in All Rooms

KITCHEN

Granite Kitchen Platform With 5.55k Wall Tiles
Dado Up To Beam Level.

DOORS

Ecorative Laminated Flush Main Doors With
Wooden Frame.

Decorative Laminated Flush Internal Doors
Good Quality Grass Fature & Fittings

Decorative Laminated Flush Bath&we Doon
With Marble Moulding Frame.

BATH & WC

Designer Glazed Tiles Daño Upto
Beam Bottom

Quality Sanitary Wares.

Concealed Plumbing With Premium Quality
C.P. Fitting

ELECTRIFICATION

Concealed Brand Copper Wiring & Fittings
Provision Of Cable TV in Living & Bedrooms.
Ac Point Provision in Bedrooms.

WINDOWS

Powder Coated Staling Windows With Granite
Frame.

Powder Coated Glass Louvered Window In Toets.

WALLS & PAINTS

Distemper Paint On Internal Wall Acrylic/
Sandbox Matt Paint On External Walls

WATER TANE

Under Ground And Overhead Water Tank
With Adequate Water Storage Capacity.

TERRACE

Special Brickbat Water Proofing Treatment

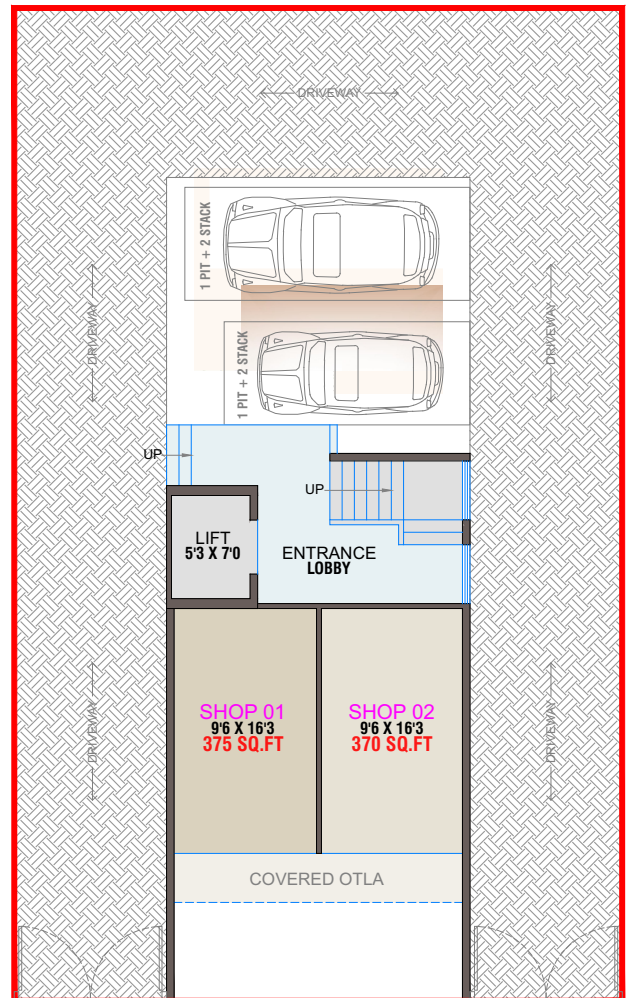

2BHK FLAT



MARUTI HEIGHT

APEX DEVELOPERS

Office Add:- Shop No.1, Plot No.29, Sector-25A, Ulwe

CONTACT FOR BOOK

9821773623



Architect
Chirag Gami
R.C.C Consultants
S.R Rao

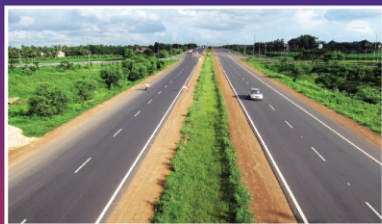

Sion-Panvel & JNPT-Uran Highway



Railway Station



International Airport



Panvel Bus Stand