

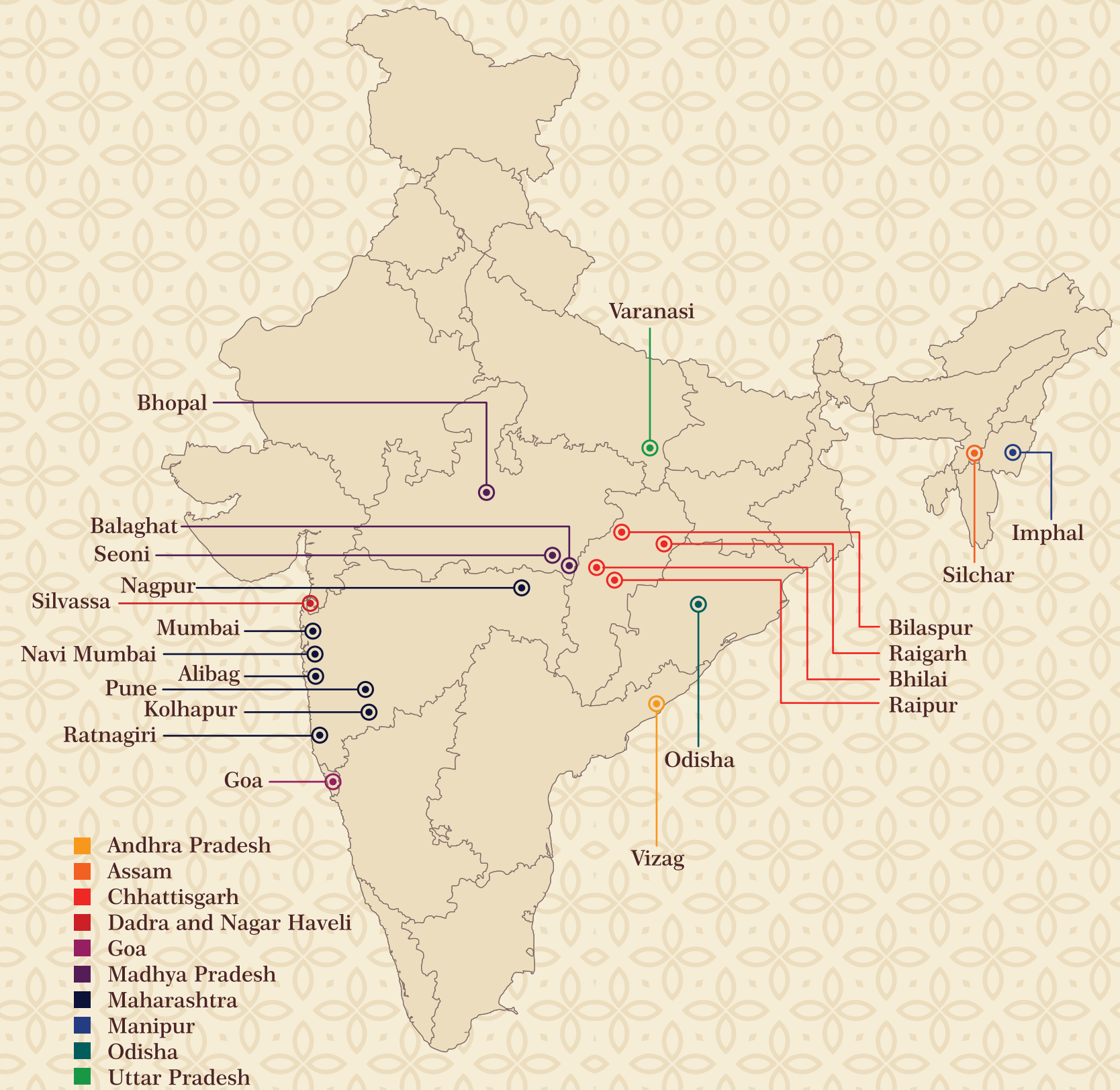

Where style comes naturally



Who we are

Difficult Roads often lead to beautiful destinations.

The road to tomorrow rests on the infrastructure developed today, and Banka Group, since its inception in 1982, has led the way. With a diverse array of infrastructure projects, including over 200 bridges, miles of roads, and multifarious real estate developments—commercial and residential—to our credit, Banka is helping bring futuristic dreams to life, today.

Our commitment to create aesthetic architecture matched by robust, high-quality construction gives our customers the best of both worlds: style and economy, and makes every project a new milestone on our journey to higher standards.

Infrastructure

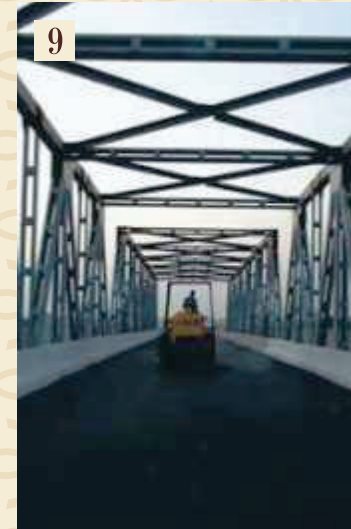

- 1] Bagh River Bridge, Madhya Pradesh
- 2] Ade Creek Bridge, Konkan, Maharashtra
- 3] Bav River Bridge, Ratnagiri, Maharashtra
- 4] Kashiram Nagar Flyover, Raipur, Chhattisgarh
- 5] Doodh Creek Bridge, Palghar, Maharashtra
- 6] Mova ROB, Raipur, Chhattisgarh
- 7] Godavari River Bridge, Nanded, Maharashtra
- 8] Mahanadi River Bridge, Raigarh, Chattisgarh
- 9] Khaparkheda ROB, Nagpur, Maharashtra
- 10] Jaigad Creek Bridge, Konkan, Maharashtra
- 11] Cumberjua Creek Bridge, Goa
- 12] Jeera River Bridge, Bargarh, Orissa

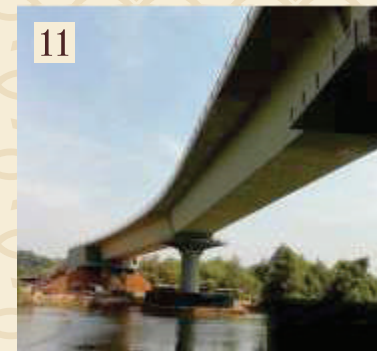

Our Valuable Clients

<p>Border Roads Organizations, New Delhi</p>	<p>Chattisgarh State - PWD</p>	<p>Narmada Valley Development Authority, Bhopal, M.P.</p>	<p>Madhya Pradesh State - PWD, Bhopal, M.P.</p>
<p>Indore Development Authority, Indore, M.P.</p>	<p>Central Public Works Department</p>	<p>Maharashtra State - PWD</p>	<p>Pimpri Chinchwad Municipal Corp., Pimpri, Pune</p>
<p>Konkan Railway Corporation Limited</p>	<p>Goa State Infrastructure Development Corporation, Panaji, Goa</p>	<p>Maharashtra State Power Generation Company Limited</p>	<p>Chhattisgarh State Power Transmission Company Limited</p>

దక్షిణ మధ్య రైల్వే
SOUTH CENTRAL RAILWAY
South Central Railway, Vishakhapatnam

Expansive Homecomings

The irresistible feeling of pride as you turn into your grand entryway will never grow old.

Banka Sapphire nestles in the heart of nature's abundance. A home with all the amenities coupled with serene surroundings gives a sense of fulfilment.

The ambience exudes positivity and ushers you in with a warmth that says 'Welcome Home'.



Registration Number Building A
P52100017790
www.maharera.mahaonline.gov.in



Registration Number Building A
P52100017790
www.maharera.mahaonline.gov.in



Artistic Impression

Good to look at. Great to live in

Experience the good life in a home that matches natural beauty with modern utility. Set in the relatively untouched environs of Pisoli, a short run from the tony NIBM enclave, Banka Sapphire is a breath of freshness in a crowded urban landscape. Rising an elegant 11 storeys high, with a layout that assures breathtaking views of the surrounding landscape, this is more than a home; it's your everyday getaway from the mundane.

Designed to delight senses and budgets, Sapphire spreads over 3 landscaped acres, offering a range of 1 & 2 bedroom apartments. Each residence crafted with the choicest fittings, and finished to meet Banka's benchmarks of uncompromising excellence.





When art
meets architecture,
Lifestyles
get
a makeover.





Everyday luxuries

Make the most of each day—your way. Sports, leisure, entertainment and all-round fun awaits every member of the family. Take your pick from the selection of lifestyle fulfilling amenities provided for your exclusive pleasure.



AMENITIES & ENTERTAINMENT

- Club House.
- Gymnasium with basic equipments.
- Activity room for indoor games.
- Community hall for meetings and gatherings.
- Lush green party lawn.
- Pleasure pool.
- Children's play area.
- Senior citizen relaxation area with sitting arrangements.

SAFETY AND SECURITY

- Fire fighting systems for all building.
- CCTV cameras at main entrance gate/lobby area.
- Main entrance gate with security cabin.



Where form meets function

As exquisite on the inside as it is on the outside, Banka Sapphire exceeds expectations with interior layouts that make the most of the natural light and breezy ambience that suffuses the locale. Thoughtful attention to details—from the robust construction to high-quality materials—ensure your home's beauty is not just skin deep, and assures a lifestyle worthy of appreciation for more than a lifetime.



Living Room



STRUCTURE
RCC framed structure designed for earthquake sustainability.

FLOORING
Vitrified flooring 2 feet X 2 feet in bedrooms, kitchen, and living area.
Anti-skid flooring in washrooms and terraces.

ELECTRICAL
Concealed electrical copper wiring.
Modular switches.
Adequate numbers of electrical points.
TV and telephone points in living room.
AC point in master bedroom.
Provision for exhaust fan in kitchen, toilet, WC & bathrooms.

PAINT
Oil Bound Distemper (OBD) for internal walls with two shades.
External paint with elevation effect.

DOORS
Wooden main door with wooden door frame and appropriate fittings.
Laminated flush doors with appropriate fittings.
Dry balcony door frame with granite frame.

WINDOWS
Powder coated three track aluminium sliding window with mosquito mesh.
Granite or engineered marble window sill for all windows.

KITCHEN
Granite kitchen platform.
Stainless steel sink.
Designer dado tiles up to lintel level in kitchen.
Electrical points for water purifier and refrigerator in kitchen.
Washing machine provision in dry balcony.

BATHROOMS
Glazed dado tiles up to lintel level in all bathrooms.
Hot & cold water mixer for shower.
Concealed internal plumbing.
Premium sanitary fittings.
Branded CP fittings.

LIFT
2 Automatic lifts with generator back-up.

VALUE ADDITION
Internal concrete road and combination of paving blocks.
Servant toilet for each building.
Adequate parking space for two wheelers and four wheelers.
Power back-up for lights in parking and common area.
Shopping area in the complex.
School bus facility from all major schools.
Railings in balcony.





Retail therapy was
never so convenient

**BANKA SAPPHIRE
DOWNTOWN**

FASHION

GLOBE

SAMSON

YAS

FLOREX

RELAX

HELLY

HELLY

ESCADA

NIKELON

ELEGANT

ARCH

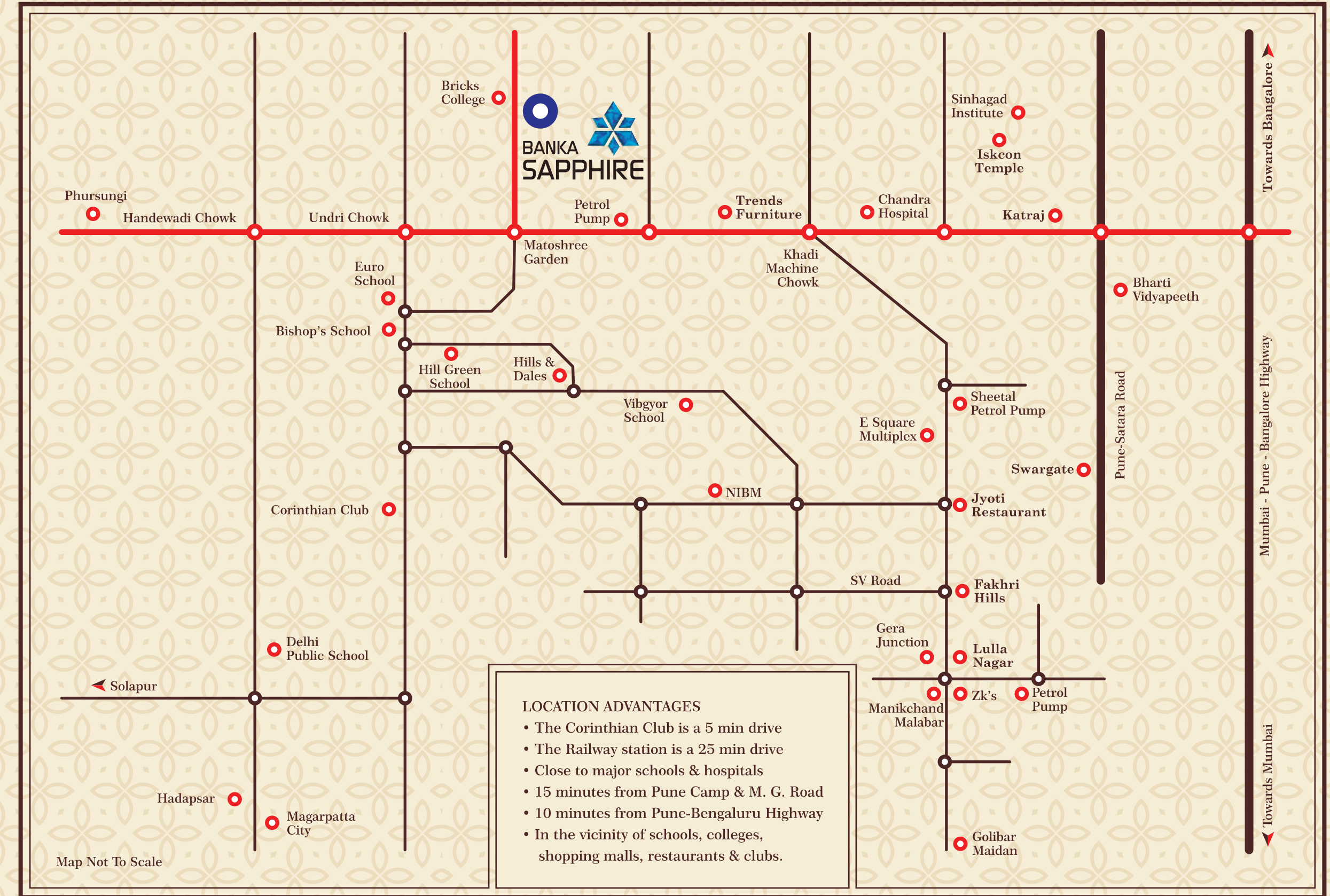
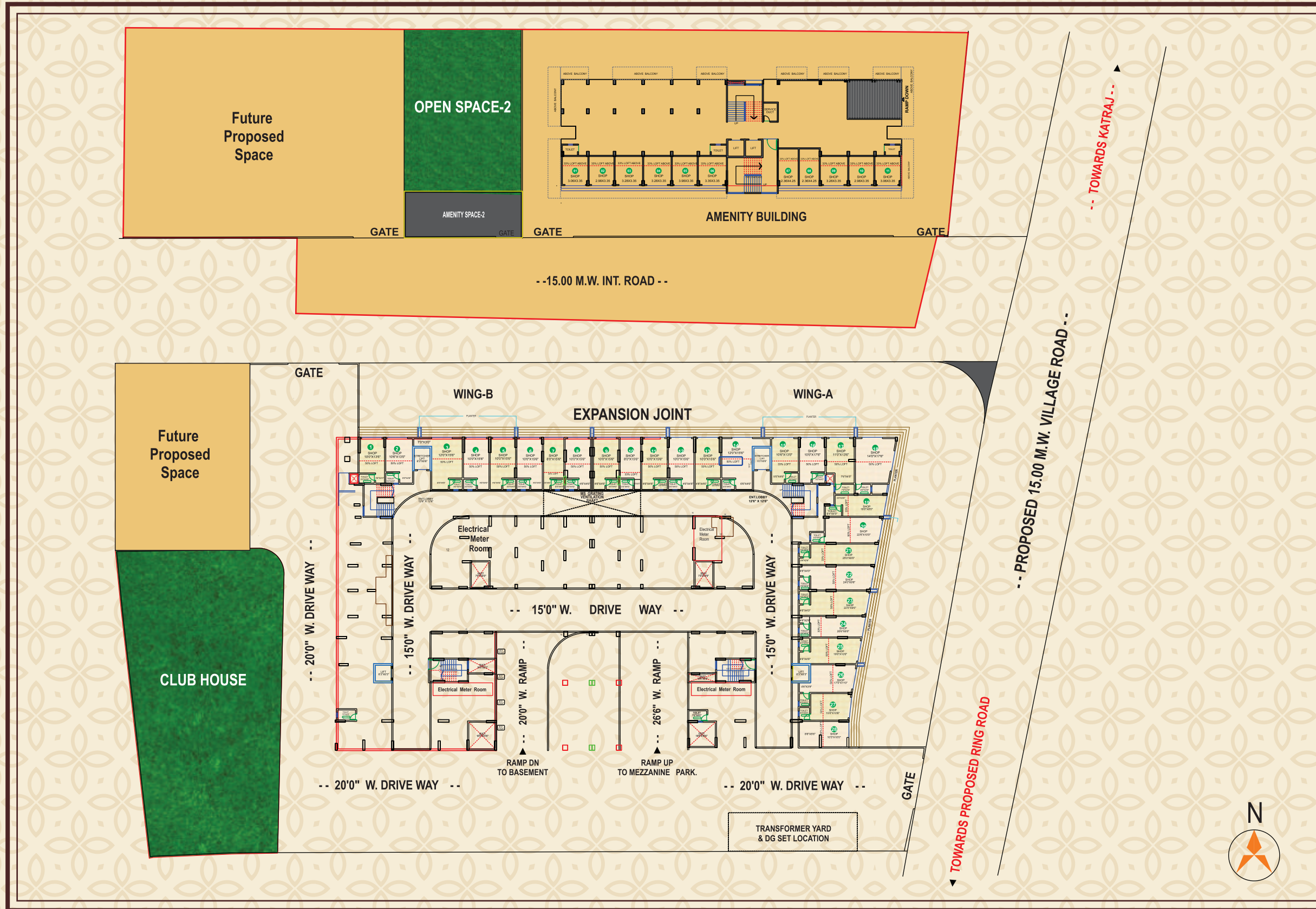



Site Address

Banka Sapphire, Survey No. 19/6, Opp Bricks Architecture College, Pisoli, Pune 411028, Maharashtra.

Mob.: +91 - 9920 22 9697, 9819 22 9697

Corporate Office Address

Banka Constructions, 205, Trade Corner, Saki Naka Junction, Andheri (East), Mumbai - 400 072.

Tel.: +91 - 22 2852 3030 / 2012 | Telefax : 022-2852 2013

Website: www.bankainfracon.com | E-Mail: info@bankainfracon.com



Registration Number Building A
P52100017790
www.maharera.mahaonline.gov.in

NOTE : This Brochure is purely conceptual and is designed in good faith to give you a fair and overall view of the project and is not a legal offering, nor will it be part of any agreement. Photographs are not necessarily comprehensive or current. Nothing contained in this brochure will take precedence in the final agreement. Number of buildings, areas, flats/units, amenities, specifications, floors, roads, open space etc. may be revised.

Promoters reserve the right to amend layouts, plans, elevations, designs, specifications, amenities, areas etc. without notice. The use of clubhouse shall be strictly in accordance with the rules and regulations. "Future Development" may consist of high-rise buildings.