

SAMVAAD  
**Sonnet**

**YES YOU ARE HERE**







**CLUB HOUSE  
& INDOOR GAMES**

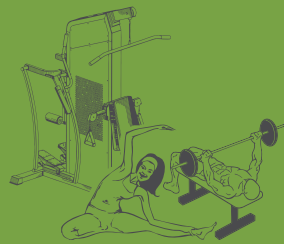

**WELL EQUIPPED  
GYMNASIUM**



**SITOUTS  
& CHILDREN PLAY AREA**

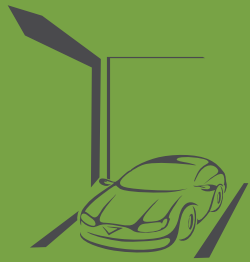

**ALLOTTED  
CAR PARKING**



## SPECIFICATION

### STRUCTURE

Earthquake resistance R.C.C frame structure

### WALL FINISH

Internal mala plaster with double coat putty finish & external double coat sand faced plaster with 100% acrylic water proof paint

### ELECTRIFICATION

Concealed copper wiring with sufficient light points and plug points with standard modular accessories

### TOILET

Designer tile dado upto lintel level and anti skid flooring, bath fittings and sanitary ware of Jaquar and Cera/equivalent brands

### FLOORING

Vitrified tiles flooring in drawing, dining, kitchen and all bed rooms

### DOORS & WINDOWS

Decorative main entrance door with wooden frame. All internal doors will be flush doors with wooden frames. Powder coated aluminum section windows with marble Sill

### KITCHEN

Mirror polished granite platform with adequate size s.s sink and Lintel level dado on platform side wall

### ELEVATOR

Lift of a well known company





**TYPICAL UNIT PLAN**

**A**

- 1 DRAWING / DINING 10'-0" X 21'-0"
- 2 KITCHEN 9'-0" X 13'-3"
- 3 BED ROOM 9'-0" X 10'-0"
- 4 BED ROOM 13'-9" X 10'-0"
- 5 TOILET 4'-0" X 7'-6"
- 6 WASH 6'-6" X 5'-0"
- 7 BED ROOM 12'-0" X 10'-0"
- 8 TOILET 6'-6" X 4'-6"

**B**

- 1 DRAWING / DINING 10'-0" X 21'-0"
- 2 KITCHEN 9'-0" X 13'-3"
- 3 BED ROOM 12'-0" X 10'-0"
- 4 BED ROOM 9'-6" X 9'-0"
- 5 BED ROOM 14'-0" X 10'-0"
- 6 TOILET 4'-0" X 7'-6"
- 7 WASH 6'-6" X 5'-0"
- 8 TOILET 6'-6" X 4'-6"



SAMVAAD  
**Sonnet**

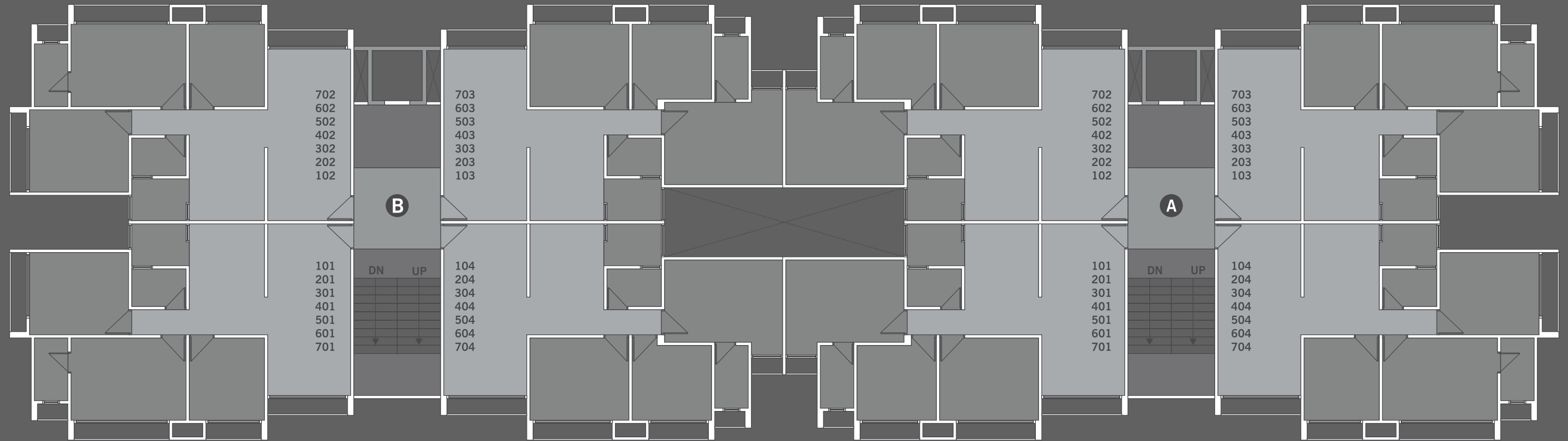

TYPICAL FLOOR PLAN



SAMVAAD  
**Sonnet**

Vaishnodevi Circle to Zundal Circle, Near Under Bridge, Off S.P. Ring Road, Near Gala Heaven, New Chandkheda.

09925006337 | 09825411289  
09824086171 | 09925025982

# HOLLOW PLINTH PLAN

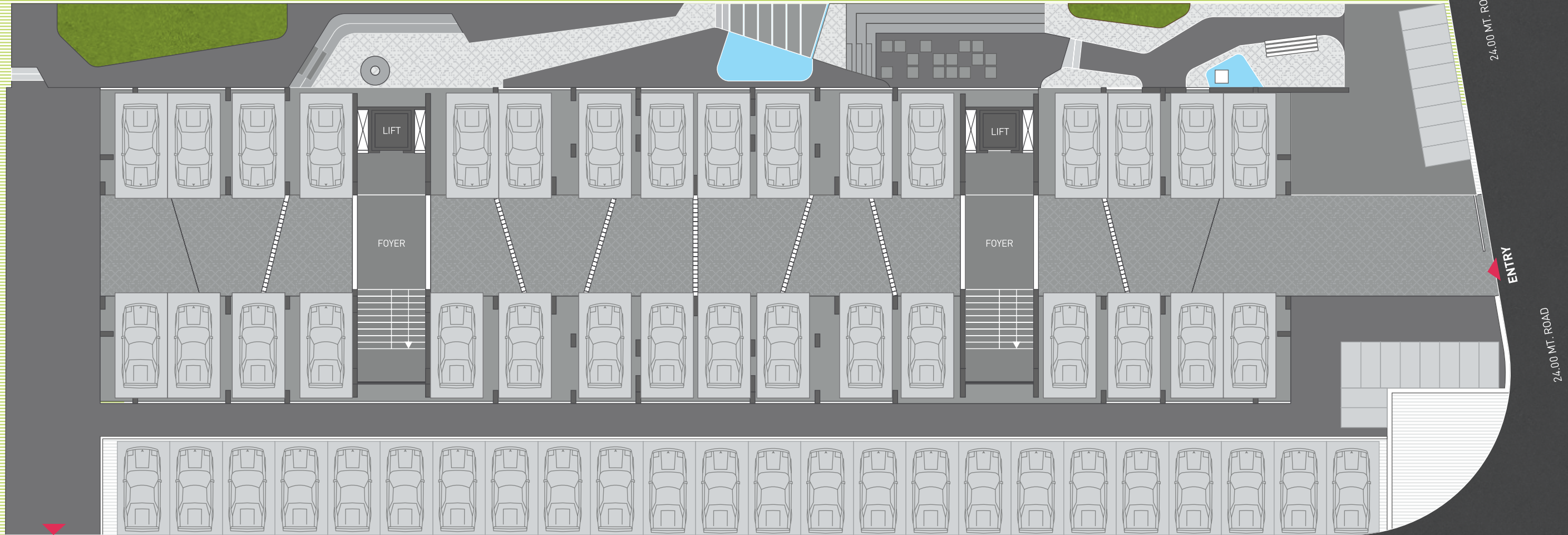

EXIT

18.00 MT. ROAD

18.00 MT. ROAD

18.00 MT. ROAD

24.00 MT. ROAD

24.00 MT. ROAD

**Notes** | Changes in elevation shall not be allowed | Electricity charges, legal charges and AMC charges shall be borne by the purchaser Stamp Duty, registration fees and any tax by state or central government shall be borne by the purchaser | All rights reserved to developer for any changes in plan and specifications | This brochure shall not be treated as part of legal document.

#### Developer



**SAMVAAD™**  
REAL ESTATE DEVELOPERS

[www.samvaadrealstate.com](http://www.samvaadrealstate.com)

#### Architect

9th Street Architects

Saurabh Verma

#### Structural Consultant

Achal Parikh

#### Plumbing, Electrical & A/C Consultant

Dipen Mehta

Aqua Utility Designs and Management (P) Ltd

**brim**