

|| MAULI KRUPA ||



MAULI PRIDE 2C

MAHARERA REGISTRATION NUMBER: P51800001199

Is available on the website <https://mahaonline.gov.in> under registered projects



MAHARERA REGISTRATION NUMBER
P51800001199



ULTRA MODERN AMENITIES



Swimming Pool



Garden



Children Play Area



Cafeteria



Meditation Centre

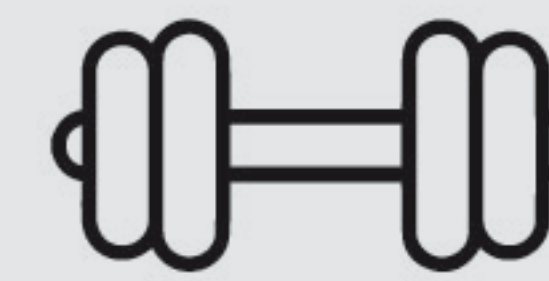

Gymnasium



Mauli Aarogyam
Hospital

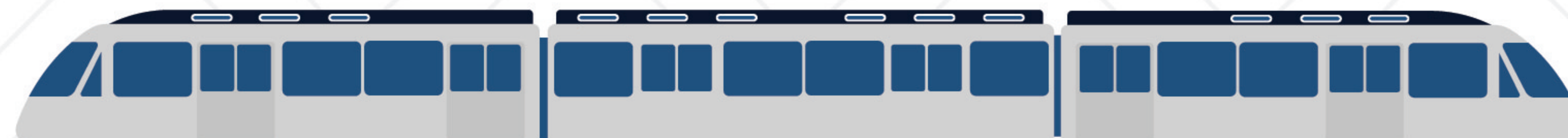

FLOOR PLAN

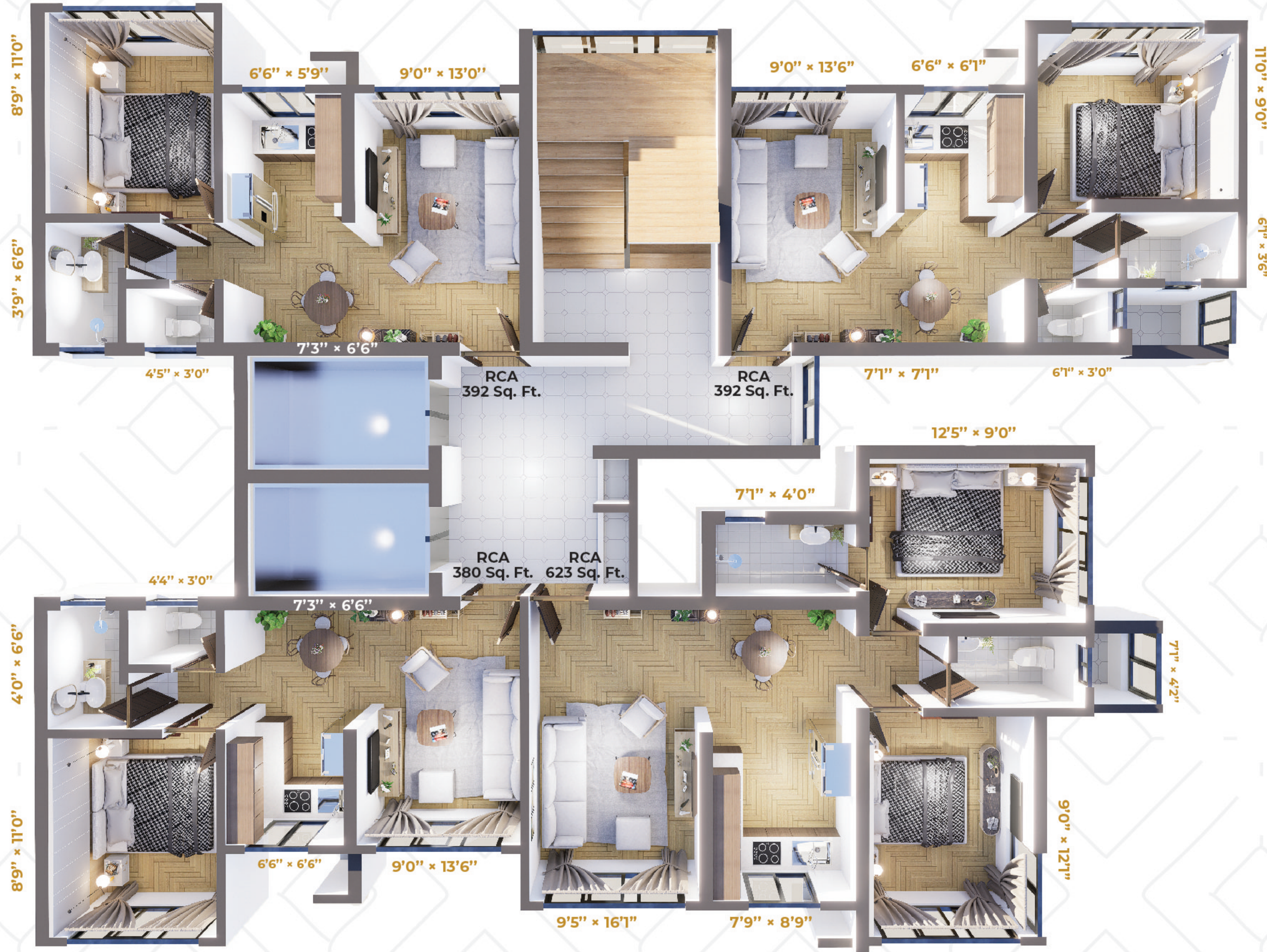

ISOMETRIC VIEWS

2BHK RCA - 623 Sq. Ft.



1BHK RCA - 392 Sq. Ft.

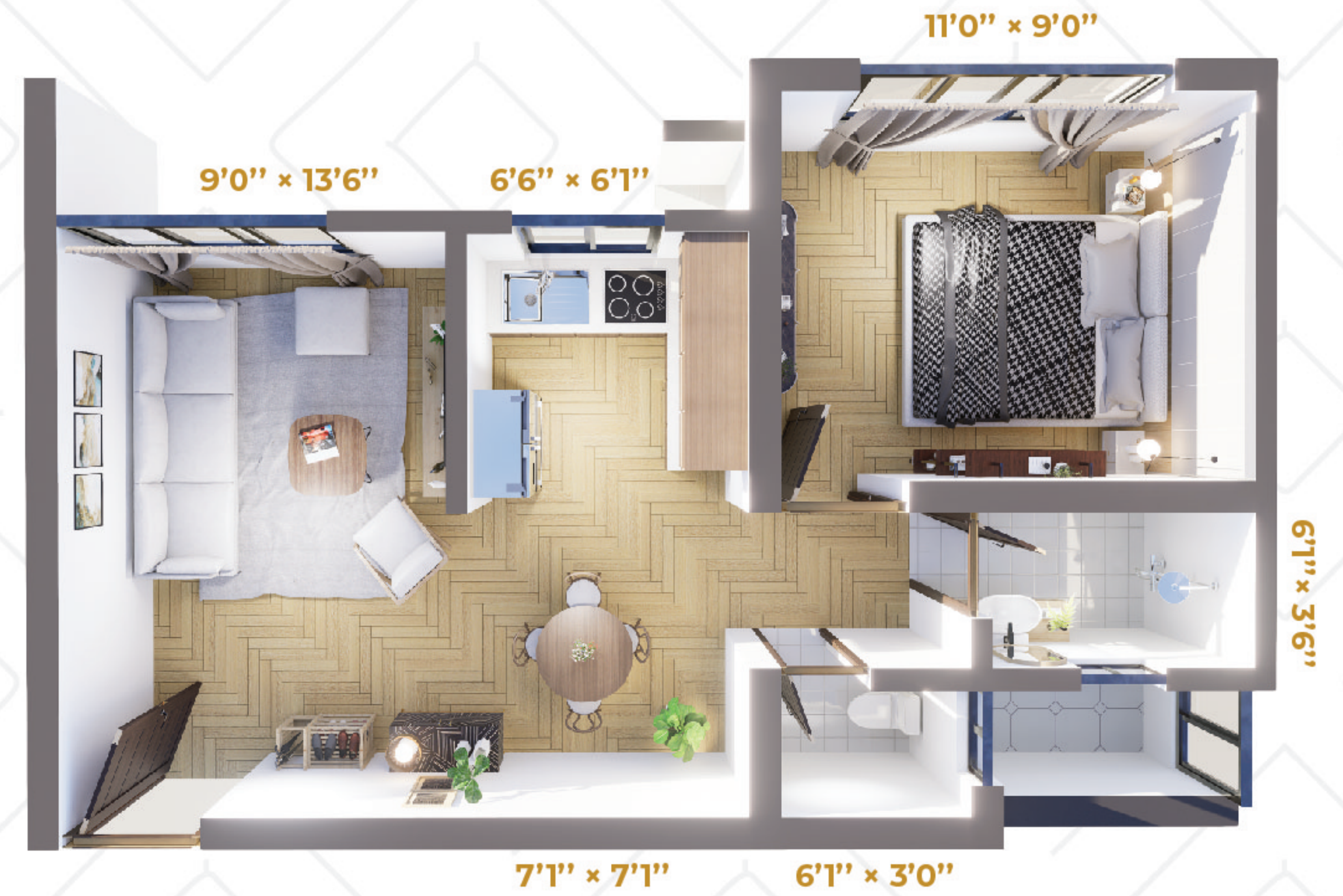

ISOMETRIC VIEWS

1BHK RCA - 392 Sq. Ft.

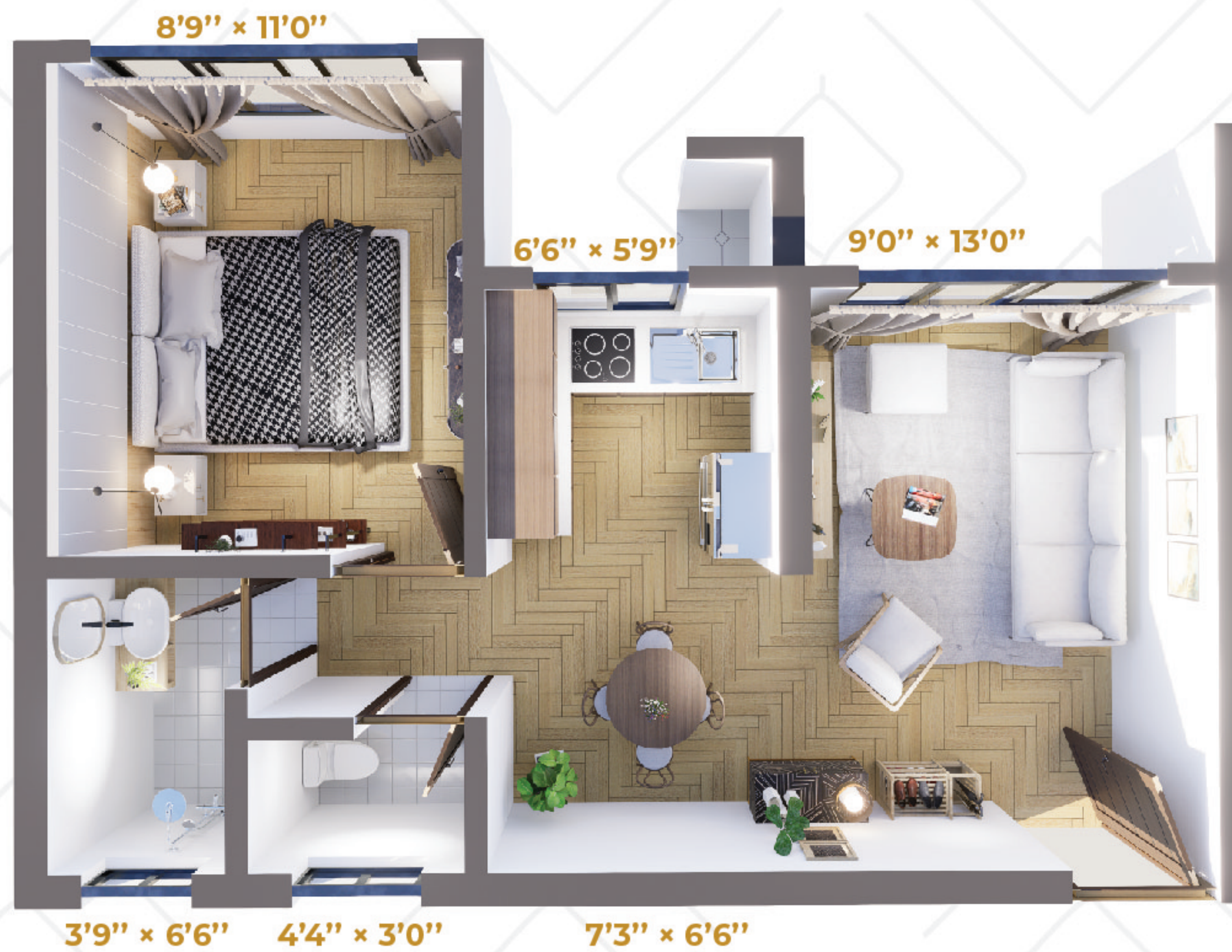

1BHK RCA - 380 Sq. Ft.





CONNECTIVITY & FEATURES

- Western Express Highway Facing Project
- Pushpa Park Metro Station Facing Project
- Stepaway From Mauli Arogyam Hospital
- T2 Airport : 20 Mins
- Malls & Hospital : 5 Mins
- Malad Railway Station : 10 Mins

LOCATION MAP

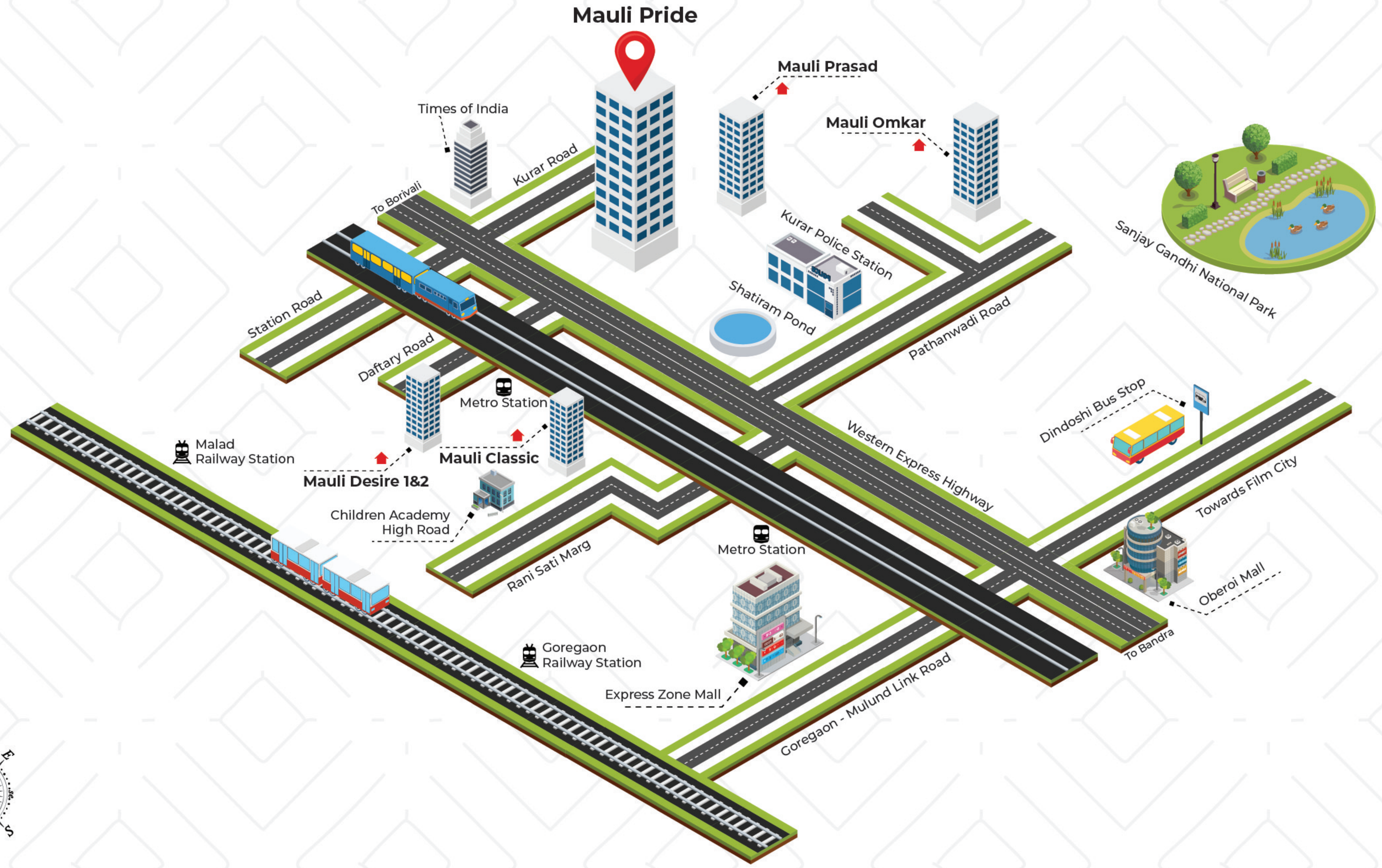

|| MAULI KRUPA ||

MAULI SAI DEVELOPERS



SALES OFFICE ADDRESS

Ground Floor, Maui Pride,
A-wing, Kurar Village, Malad (E),
Mumbai - 97

SITE ADDRESS

Maui Pride, Next To W.E. Highway,
Kurar Village, Malad (E),
Mumbai - 97

CONTACT US

8686020293/9854898541
enquiry@maulisaidevelopers.com
www.maulisaidevelopers.com

MAHARERA REGISTRATION NUMBER: P51800001199

Is available on the website <https://mahaonline.gov.in> under registered projects



MAHARERA REGISTRATION NUMBER
P51800001199