

Where Modern Living Meets
Comfort



DEVPRIYA

... ESSENCE OF LIFE ...

PLOT NO. 10B, SECTOR 18, ULWE

D
E
V
P
R
I
Y
A

Lunch box Dominos Adidas Fatrack

Fantasy Sleep Centre

Kidz Electronic

Coffee

l Phones

Teacup

M Retail





DEVPRIYA
... ESSENCE OF LIFE ...

WHERE IMAGINATION STOPS AND COMFORT LIFE STARTS

A good lifestyle is what makes you utter - "good", "awesome" or "wow". But an unimaginable lifestyle is what you absolutely spellbound and you will certainly feel that no adjective would be good enough to praise it.

Living in an abundant space of happiness while cherishing a view of open night sky with innumerable shaping stars, enjoying every single convenience at your doorstep, living in the epitome of lavishness and leading lifestyle what your imagination failed to dream of. Enjoy all these and more in one single project.

Shree Chamunda Realty presents Devpriya, a lifestyle beyond your expectations.

Come and experience the rise of lifestyle.

Project Features:

- B+G+11 Storey Residential cum Commercial Tower
- Shops & Spacious 2 & 3 BHK Flats with Balcony
- 2 High-speed Lifts
- Car Parking on Basement, Ground & First Floor
- Power back-up for lifts & common lights
- CCTV Surveillance & Intercom Facility
- Advanced Fire Fighting System
- Elegant Entrance Lobby

EXPERIENCE HAPPINESS ON THE HIGHS

Lifestyle Features:

Escaping to the calm serene, far away from the city's cacophony, rejoicing the ever-smiling moments of being amidst the playful childhood and a healthier living experience, Devpriya is all about the rise of a well-chosen lifestyle for you.

Come and experience the most pleasing lifestyle features on the amenities level of Devpriya and give your life an elevated happiness that you have always desired for.

Features:

- Well-equipped Gymnasium
- Kid's Play Area
- Indoor Games
- Landscaped Garden





All the images are for representation purpose only. Actual offering may vary.

THE AWE-INSPIRING ABODES OF WELL-CHOSEN FACILITIES

Everyone dreams of a home. A home of comfort, luxury and bigger space. Devpriya presents to you an abode, beyond your expectations yet perfectly suiting your needs. With thoughtfully designed spaces & interiors with world-class fixtures & fittings, your dream of a perfect home can be realised here.

Internal Specifications

FLOORING

- 32 Inch x 64 Inch Reputed Vitrified Flooring in all Rooms

KITCHEN

- Granite Kitchen Platform with S.S. Sink and service platform
- Designer Wall Tiles up to Full Height

DOORS

- Decorative Laminated Flush Main & Internal Doors with Wooden Frame
- Good Quality Brass Fixture & Fittings

WINDOWS

- Anodized Aluminium Sliding Windows with Glass
- Anodized Aluminum Glass Louvers Windows in Toilets

BATH & WC

- Designer Wall Tiles up to Beam Height
- Reputed Sanitary wares
- Concealed Plumbing with Reputed C.P. Fittings

WALLS & PAINTS

- Gypsum Finished Internal Walls with Asian Paint
- Acrylic Emulsion Paint for External Walls

ELECTRIFICATION

- ISI standard Concealed Copper Wiring of Reputed make
- Switches of Reputed make
- Provision for Cable TV, Telephone Points
- Intercom in Living Room
- AC Point Provision in all Bedrooms

WATER

- Under Ground And Overhead Water Tank With Adequate Water Storage Capacity

TERRACE

- Special Brickbat Water Proofing Treatment With China Chips

All the images are for representation purpose only. Actual offering may vary.



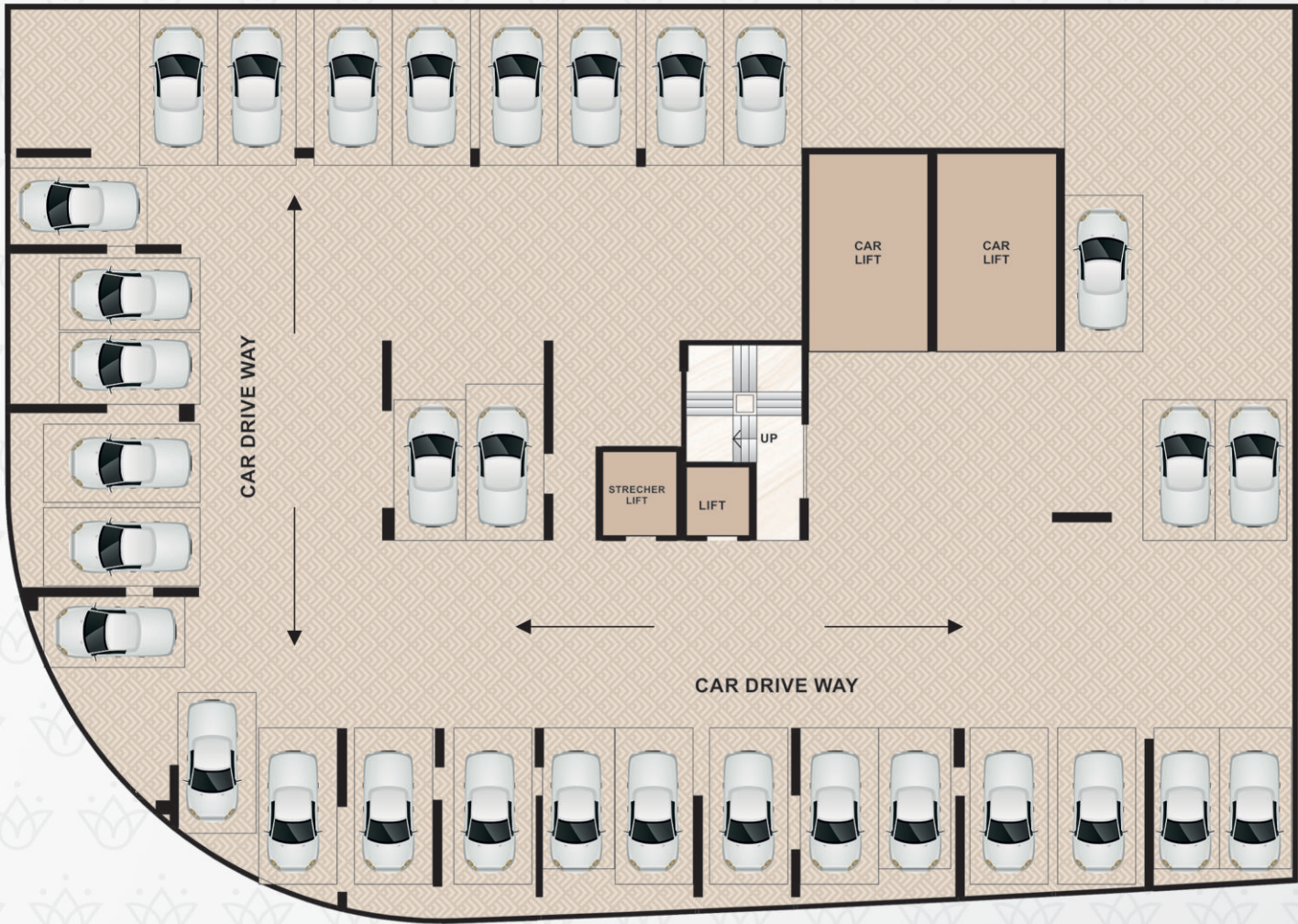

— BASEMENT FLOOR PLAN —



— GROUND FLOOR PLAN —



— 3RD TO 10 TH FLOOR PLAN —



— 11TH FLOOR PLAN —

Representation purpose only

ULWE, A NATURAL WORLD OF CONVENIENCE AND CONNECTIVITY

The Location

Located at the southern end of Navi Mumbai, Ulwe is surrounded by the Karanja River on the south-east and Uran node to the west. Being a well-connected location with Belapur, Nerul and Vashi in reach, Ulwe promises to be the destination of future. With JNPT port nearby and a number of residential & commercial developments taking place, this location has become a hot-spot for many.

Situated in the heart of Ulwe, Devpriya is a perfect residential destination for those who want a calm and peaceful life, away from the chaotic disturbances of the city.

Come and live serene life amidst nature and conveniences.

Location Advantages:

- Bamandongari & Kharkopar Railway Station is just 1 km away
- JNPT Port is just 15 kms away
- Nhava Sheva-Sewri Sea Link is just 1 km away
- Navi Mumbai International Airport is just 3 kms away
- Vashi 25 kms & CDB Belapur 6 kms away
- Ramsheth Thakur Sports Complex just 2 mins. drive
- Schools, Colleges, Hospitals & Shopping Centres in close vicinity





DEVPRIYA

... ESSENCE OF LIFE ...

PLOT NO. 10B, SECTOR 18, ULWE



All the images are for representation purpose only. Actual offering may vary.



COMPLETED PROJECTS IN ULWE



Gomaji Kasturi, Plot-76, Sector-5,
Ulwe, Navi Mumbai.



Kasturi Heritage, Plot-F37,
Sector-8, Ulwe, Navi Mumbai.



Sapphire, Plot-C2, Sector-8,
Ulwe, Navi Mumbai.



Shree Chamunda Dham, Plot-67A & 67B,
Sector-19, Ulwe, Navi Mumbai.



Star Galaxy, Plot-30,
Sector-18, Ulwe, Navi Mumbai.

Project By:



SHREE CHAMUNDA REALTY

CORPORATE OFFICE: The Great Eastern Summit, B 508 / 509, Plot No. 66, Sector 15, CBD Belapur, Navi Mumbai.

SITE ADDRESS: Devpriya, Plot No. 10B, Sector 18, Ulwe.

MAHA RERA REG. NO. : P52000052326  www.maharera.mahaonline.gov.in

| Website: www.theavenuegroup.in

ARCHITECT: Atul Patel Architects | RCC CONSULTANT: B. S. Sukthankar & Associates

MahaRera QR Code



This Communication is Purely conceptual and is not a legal offering. It is made for only promotional purpose. The information contained in this communication is only indicative of the kind of development that is proposed and is subject to change. The developers reserve the right to make changes or alterations at their sole discretion. Actual sizes of finished unit might be lesser than shown here due to Plastering, Putty, Tiling or due to structural members like Column offset & Beam Offset etc.