



॥ शुभपती शयव शजशरुड । डतीत डरुव सलतल-शरुड ॥

ROONGTA

॥ चलतुरकुड ॥
1 & 2 BHK FLATS



The developer may extend Fifth and Sixth floor in future by considering FSI as available.

Specifications

- Structure** : R.C.C. frame structure, external wall 6" thick and internal wall 4" thick block.
- Plaster** : External sandface & internal neeru finish plaster.
- Paint** : Internal oil bound distemper. External waterproof paint.
- Doors** : Laminated doors with S. S. fittings.
Laminated door with granite frames for toilets.
- Windows** : Three track aluminium powder coated sliding windows with mosquito net, safety grills & granite frames.
- Kitchen** : Granite kitchen platform 7.5" with stainless steel sink. Ceramic tile dado upto 4' above kitchen platform.
- Bath / Toilets** : Concealed plumbing with hot/cold mixer. Provision for geyser. single lever jaguar essco or equivalent toilet fitting. Designer glazed tile (12 X18) upto 7' and anti-skid tiled floor. superior quality sanitary ware.
- Flooring** : Vitrified 24 x 24 tiles. Terrace floor to be in rustique ceramic tiles.
- Electrification** : Concealed electrification. Adequate number of point of light, fan and plug points. Leon / Anchor / GM or equivalent modular switches. Washing machine point in balcony / alternate terrace.
- Parking** : Paved with paved block.
- Specification** : • Lift with battery back up.
• Common parking.

The developer may extend Fifth and Sixth floor in future by considering FSI as available.

Ram Mandir



Security Cabin & Entrance Gate

Party Lawn & Stage



Kids Play Area & Senior Citizen Sitting Space.

Images are artist impression only



ROONGTA
चित्रकूट
1 & 2 BHK FLATS

Common Parking & Ground Floor Plan

Special Amenities

1. RAM MANDIR
2. CHILDREN PLAY AREA
3. LAWN
4. CLUB HOUSE
5. TULSI VRINDAVAN
6. SENIOR CITIZEN PARK
7. BASKET BALL RING
8. GREEN GYM

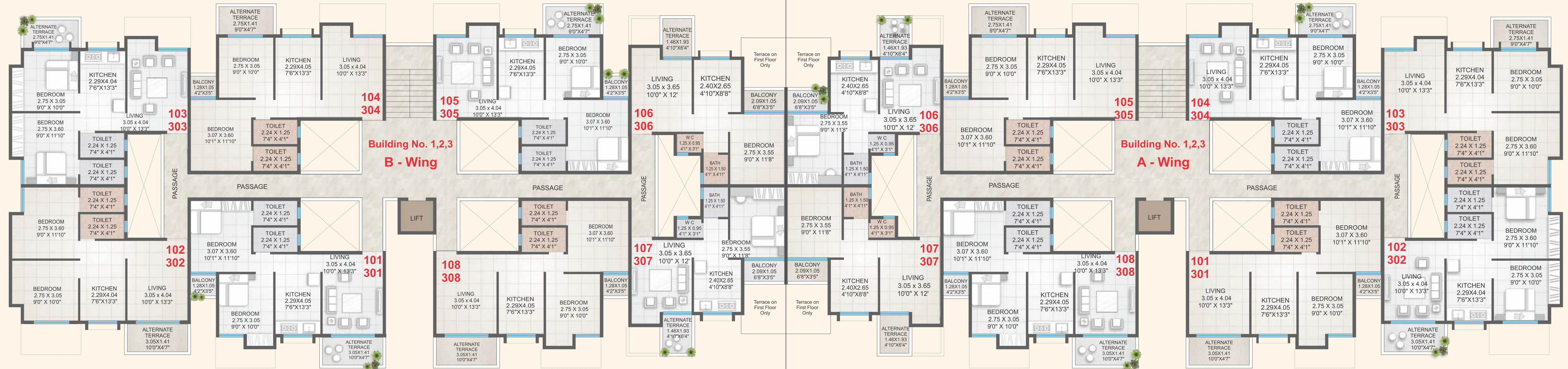

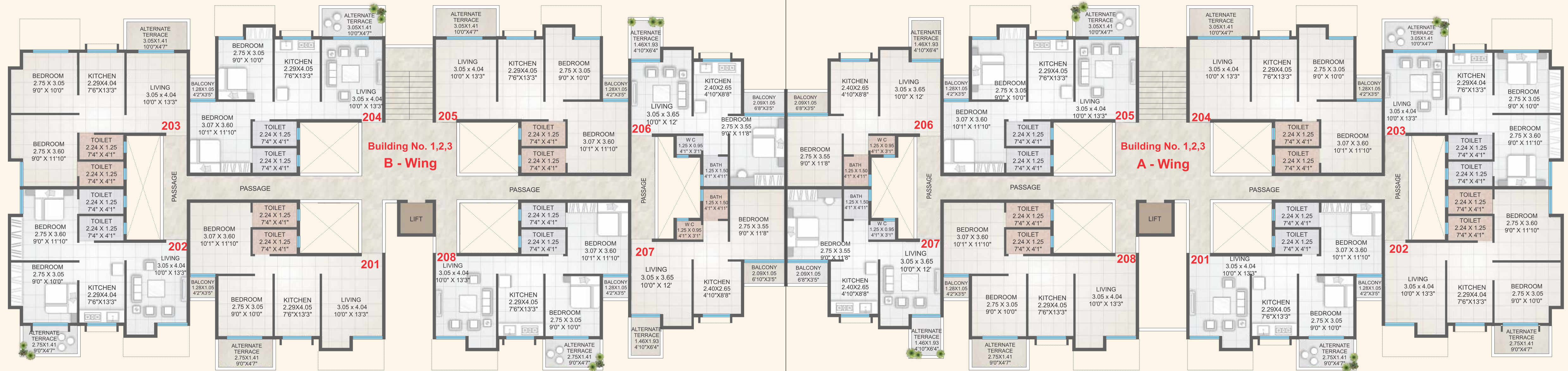

Location Map

ROONGTA
॥ चित्रकूट ॥
 1 & 2 BHK FLATS

Near Gurugobindsingh College,
 Indira Nagar Annex, Nashik

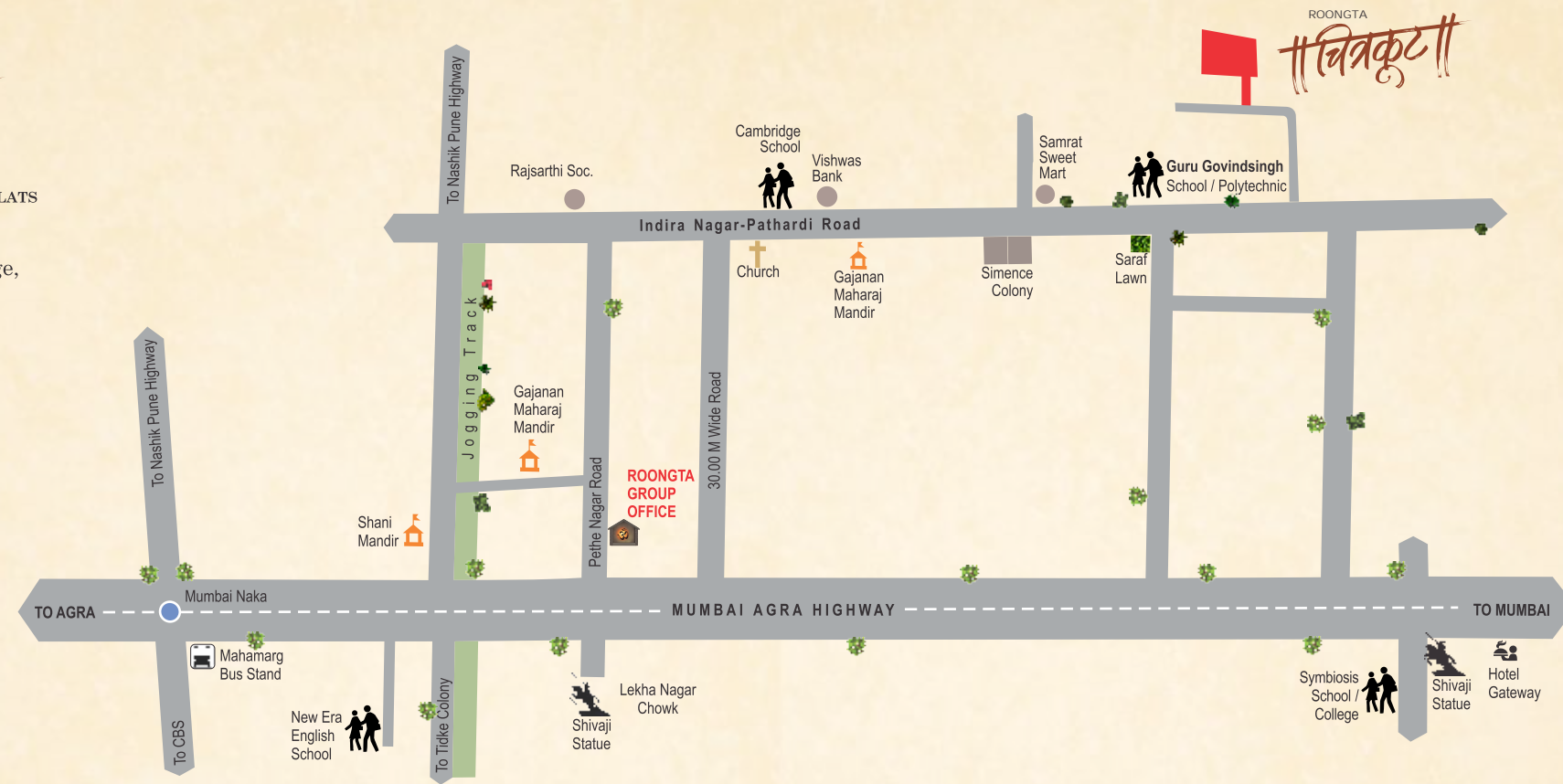

Images of amenities shown in this advertisement are purely indicative. The information contained in this brochure such as the plans, specification, images and other details herein are indicative only. The Developer reserves the rights to change any or all of these.



maharera.mahaonline.gov.in
 MahaRERA No P51600001657



Roongta GroupTM
 Builders & Developers
 INNOVATING... CREATING... TRANSFORMING

Corporate Office : Shree Tirumala Ashirwad Apt., Pethe Nagar Road (Indira Nagar), Opp. Bal Bharti, Nashik - 422 009. Ph.: 0253 - 2328719.
City Office : Padmalaxmi Apt., Near Vishwas Bank, Savarkar Nagar, Gangapur Road, Nashik - 422 013. Ph.: 0253 - 2970142.
Cell : 9764031000 | visit us : www.roongtagroup.co.in | email : connect@roongtagroup.co.in

Social Links : | **Mobile Apps.:** | |

Architect : Ar. Sagar Kabre

R.C.C. Designer : Sanjeev Patel

Legal Advisor : Vidyulata Tated

MAA-ADVTG-9225101311