

DEVELOPER



**ADVITH**  
INFRACON

BEHIND THE NEW TULIP INTERNATIONAL SCHOOL, STERLING CITY, BOPAL, AHMEDABAD - 58  
☎ 81607 88542, 79-844 53384

ARCHITECT  
SHAPERS 360

STRUCTURE BY  
SHREEJI STRUCTURA

MEP  
TRIMITY CONSULTANT

PR/GJ/AHMEDABAD/DASKROI/AHMEDABAD MUNICIPAL CORPORATION/MAA13481/090524/300427  
GUJRERARI.GUJARAT.GOV.IN

10.11.06.19.01.01.00.05

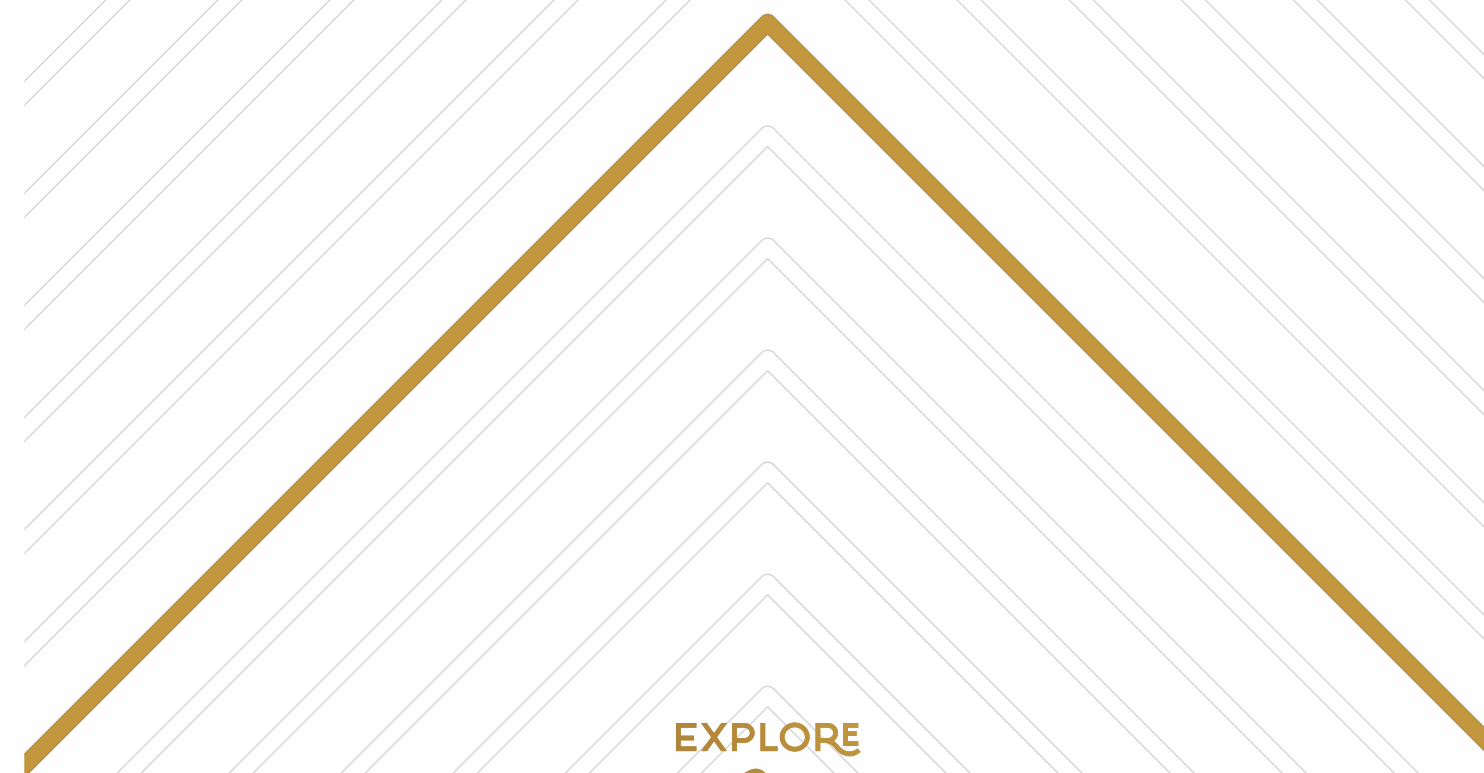

EXPLORE  
THE ARTISTRY OF  
**ELEGANCE**



# ADVITH ELEGANCE

## 3 BHK EXQUISITE LIVING

"ADVITH GROUP" ENVISIONS AN ENHANCED FUTURE WITH "ADVITH ELEGANCE". LOCATED AT BOPAL, AHMEDABAD; THIS 3 BHK RESIDENCE BRINGS THE ALLURE OF ADJOINING YOUR DAYS WITH REJUVENATION AND JOY. WHERE YOUR LIFESTYLE IS CURATED WITH EXCEPTIONAL DIMENSIONS OF LEISURELY DAYS.

BRING THE NEW ASPECT OF LIVING WITH "ADVITH ELEGANCE" WHERE YOU WILL FIND THE SOLACE OF SOULFUL EXPERIENCES.



WHERE LIES ENDLESS  
**MAJESTIC  
MOMENTS**

CRAFTING YOUR IMPECCABLE DAYS OF  
LIVING WITH FINELY CURATED COMFORT.

THE DESTINATION OF  
**GRACEFUL  
ASPIRATION**





RE-IMAGINE YOUR RAVISHING  
**LIFE WITH LEISURE**



LANDSCAPE GARDEN



CHILDREN PLAY AREA



INFORMAL SITOUT



GYM



TODDLER PLAY AREA



CLUB HOUSE



INDOOR GAMES



DROP OFF ZONE



WALKING TRACK



MINI BANQUET HALL



WELL DESIGNED ENTRANCE FOYER



OPEN AIR THEATRE



SPACE FOR DANCE & EXHIBITION



SOLAR FOR COMMON AREA



CCTV 24X7 SECURITY



FIRE SAFETY



AN ASCEND BEYOND  
**THE PERFECTION**





  
 GROUND  
 FLOOR

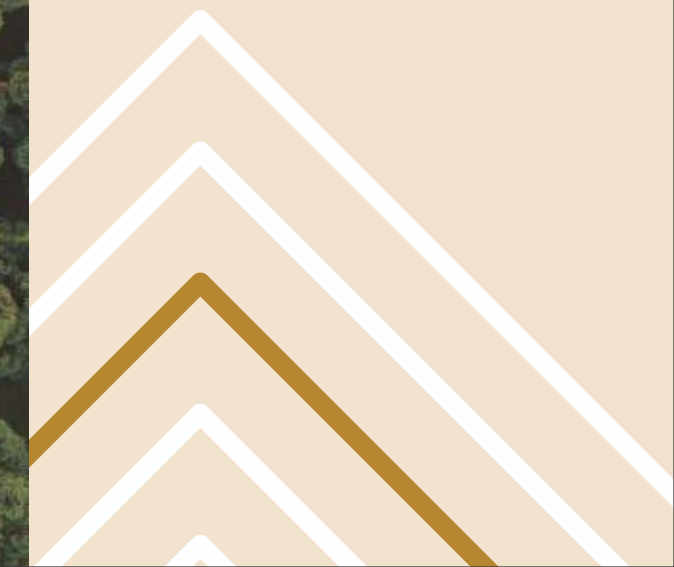

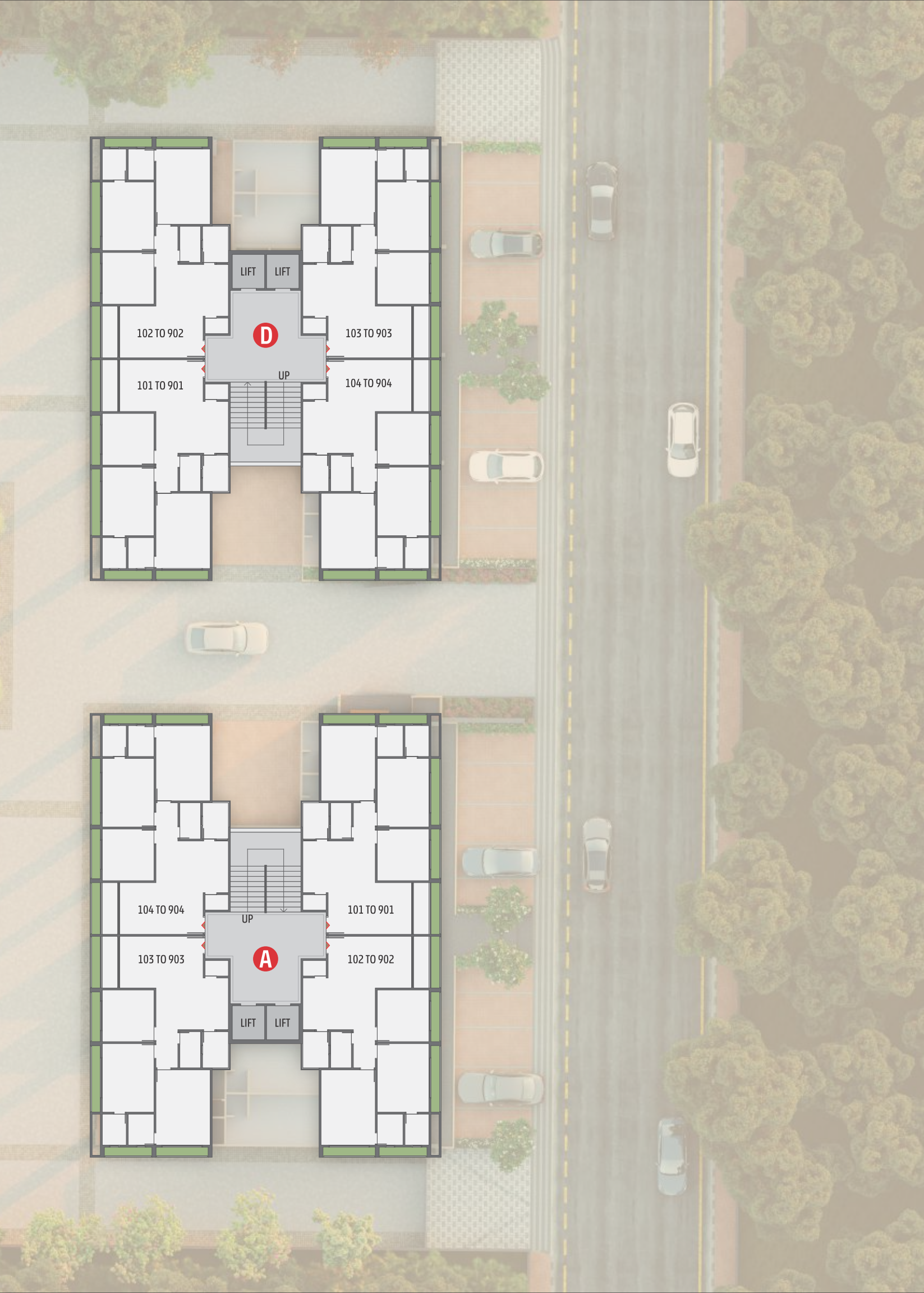
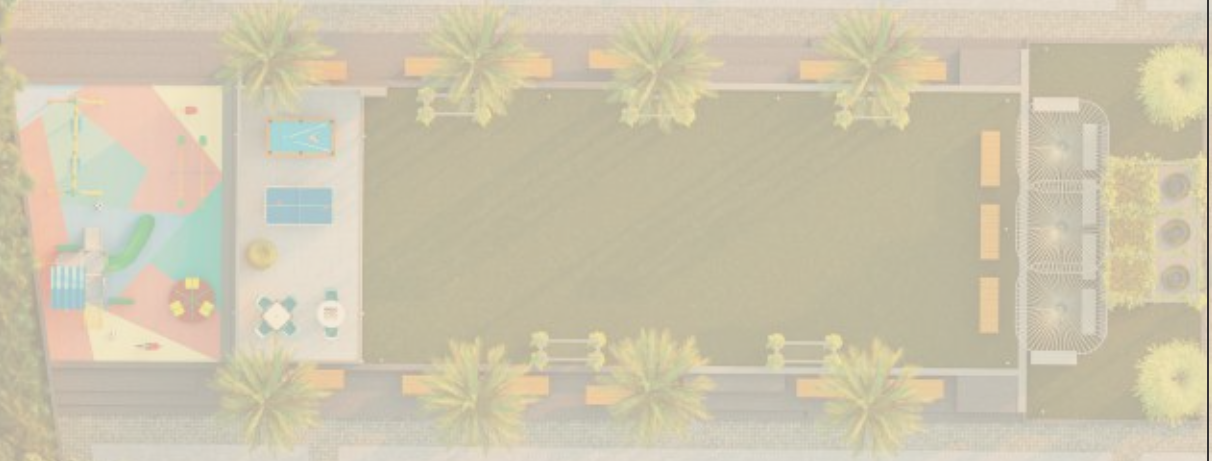
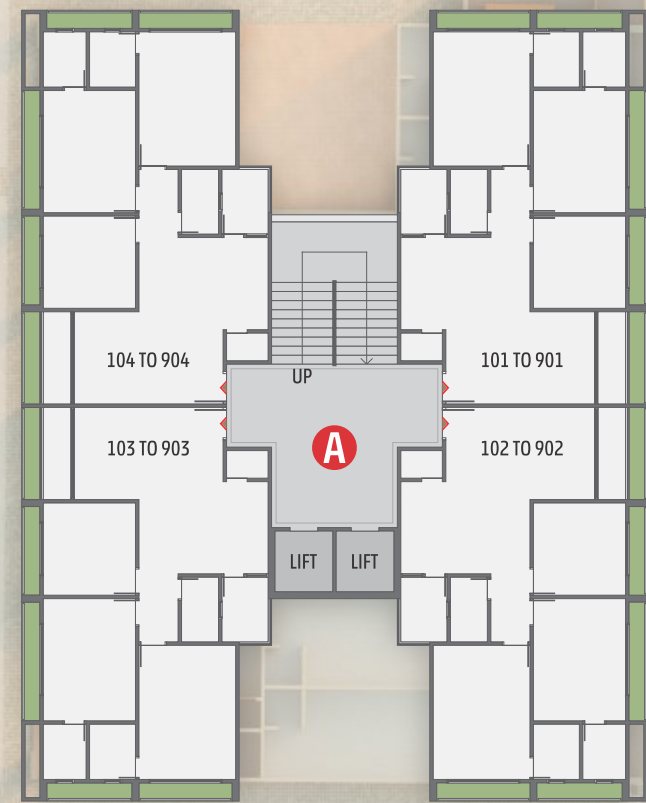
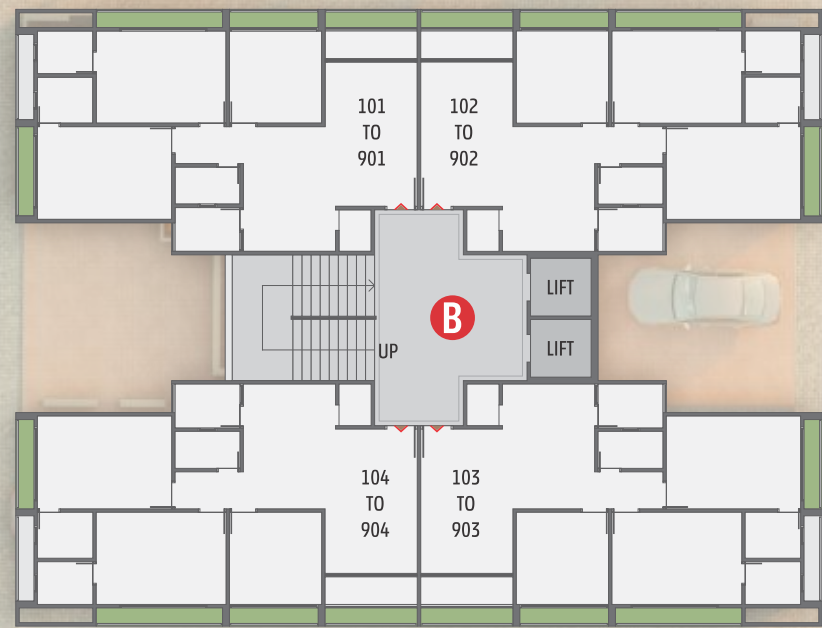
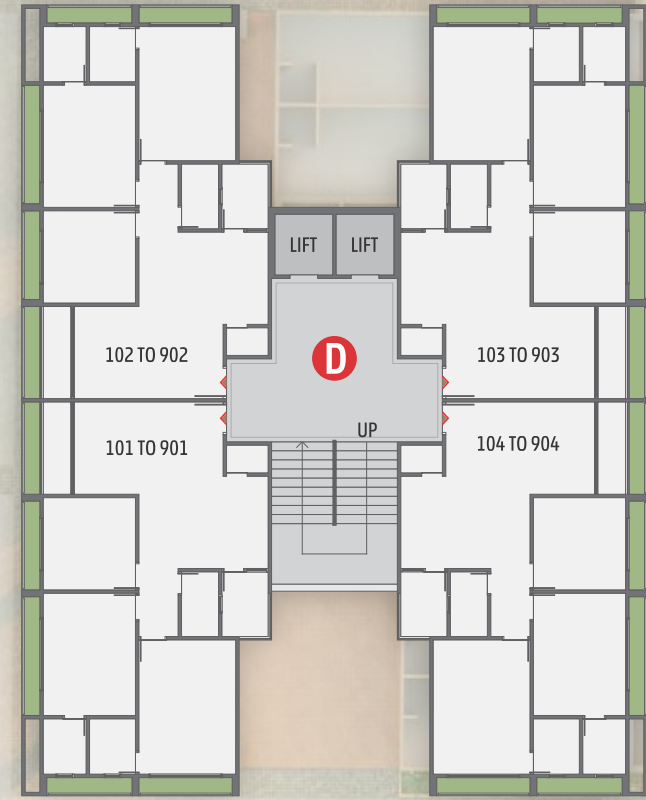

N  
TYPICAL FLOOR





3 БHK UNIT 1

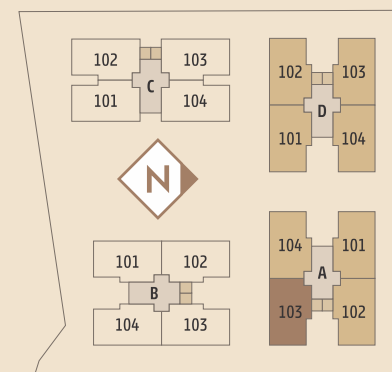



3 BHK UNIT 2

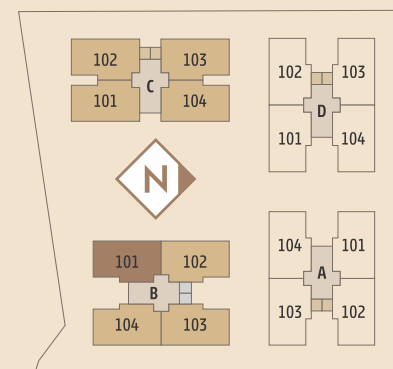



# SPECIFICATIONS

## **STRUCTURE**

R.C.C. WITH EARTHQUAKE RESISTANCE FRAME

## **FLOOR FINISH**

GOOD QUALITY VITRIFIED TILES IN COMPLETE APARTMENT  
CHINA MOSAIC WITH REQUIRED WATER PROOFING ON TERRACE

## **BATHROOMS**

GOOD QUALITY TILES FLOORING & DADO UP TO LINTEL LEVEL AS PER ARCHITECTS DESIGN  
BRANDED C.P. FITTINGS AND SANITARY WARE

## **KITCHEN**

GRANITE PLATFORM & S.S.SINK, TILES UP TO LINTEL LEVEL AS PER ARCHITECT DESIGN.  
PROVISION FOR WATER PURIFIER INSTALLATION

## **WASH**

ELECTRIC POINT FOR WASHING MACHINE WITH WATER INLET-OUTLET POINT IN WASH AREA  
GLAZED TILES DADO IN WASH AREA UPTO PARTAPET HEIGHT

## **DOORS**

DESIGNER MAIN DOOR & OTHER FLUSH DOORS WITH GOOD QUALITY LOCK

## **WINDOWS**

FULLY GLAZED POWDER COATED ALUMINIUM WINDOWS WITH STONE REVILLE

## **PLUMBING**

CONCEALED PLUMBING WITH GOOD QUALITY CPVC / UPVC PIPES AS WELL AS PEX PIPES (JOINT LESS) FOR THE LEAKAGE FREE PERFECT FITTINGS IN BATHROOM

## **WALLS/PAINT**

ALL INTERNAL WALL FINISH WITH PUTTY AND OUTER WALL WITH TEXTURE FINISH AND WEATHER SHIELD ACRYLIC PAINT

## **ELECTRIFICATION**

CONCEALED ISI MATERIAL COPPER WIRING  
ADEQUATE ELECTRIC POINTS AS PER ARCHITECT DESIGN  
MODULAR SWITCHES, MCB & ELCB

## **DTH & BROADBAND**

CENTRALISED CABLE FACILITY PROVIDED IN EACH APARTMENT

## **ELEVATOR**

TWO GOOD QUALITY AUTOMATIC ELEVATORS PER BLOCK

## **SECURITY SYSTEM**

MY GATE APPLICATION  
CCTV SURVEILLANCE COMMON AREA OF SOCIETY  
24X7 SECURITY GUARD

## **WATER SUPPLY**

24 HOURS WATER SUPPLY  
AUTO SENSOR WATER PUMPING SYSTEM

## **PARKING**

1 ALLOTTED CAR PARKING FOR EACH APARTMENT WITH NO EXTRA COST

WELL EQUIPPED FULL FIRE SYSTEM

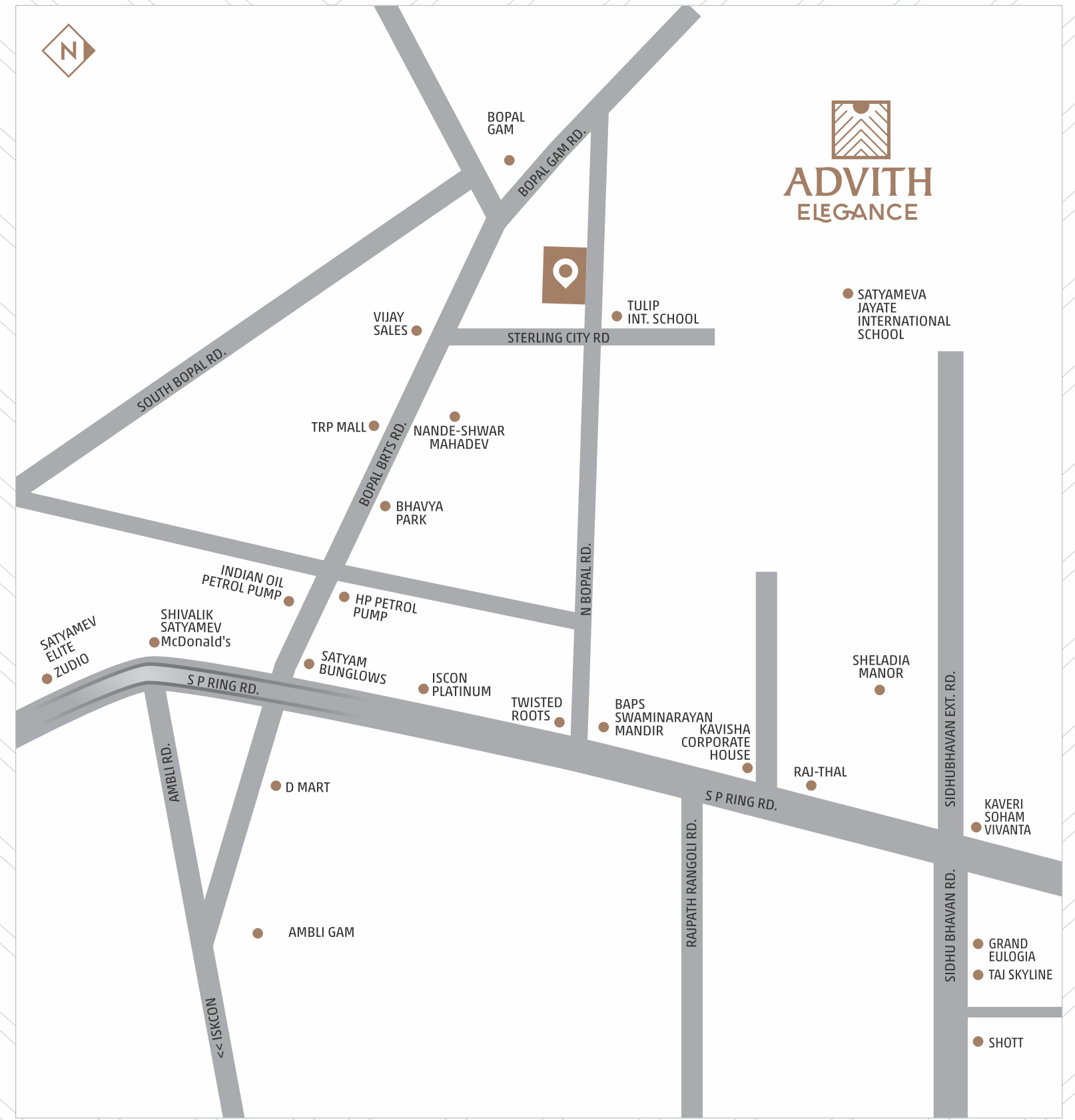

SCAN FOR LOCATION

**RULES & REGULATIONS** - Stamp Duty, Registration Charges, Legal Documentation Charges, GST, Maintenance Deposit and any other charges shall be borne by buyer separately. Any Additional charges of duties levied by government / local authority during or after the completion of the project will be borne by the buyer. Internal charges shall be done with prior permission and shall be charged in advance. Changes in external elevation shall not be permitted. All rights reserved by the developer for alteration / modification / improvement in specification / changes in dimensions and planning shall be binding to all. Business practices leading to pollution, causing material damage to the not allowed in the premises. Irregular payments may attract interest or lead to cancellation of booking/s.

**DISCLAIMER** - This brochure and model are not part of any legal documents. All dimensions / measurement given are unfinished and approximate. The photographs & artistic impressions are for references only. Actual building may vary from the representations mentioned in the brochure. This is not an advertisement within the meaning of RERA. This is not an offer, invitation or commitment of any nature. Receipts are advised to appraise the mselves of the necessary and relevant information of the project prior to making any purchase decisions. All the specifications of the flat shall be as per the final agreement between the parties. Subject to Ahmedabad jurisdiction only. T&C Applicable\*