

MATHRUSHRI ENCLAVES

**BBMP
APPROVED**

**BBMP
A-KHATA**



TYPICAL FLOOR PLAN





SPECIFICATION

- **Structure**
 RCC Frame Structure

- **Walls**
 Concrete Block Construction

- **Flooring**
 Vitrified Flooring

- **Painting**
 Oil Bound Distemper

- **Electrical**
 Anchor/equivalent Modular Switches,
 Anchor/equivalent Copper wires

- **Plumbing**
 European Water Closet (ECW) of Branded Make,
 Hot & Cold water mixer unit with shower in all
 toilets, All chromium Plated fittings of
 Branded Make

- **Door**
 Main Door of natural wood frame,
 Shutters with both side Masonite skin

- **Windows**
 Aluminum Windows

- **Kitchen**
 Granite Platform slab with Stainless
 Steel with drain board

Area Statement

UNIT - 1	1700 SFT (4 BHK)
UNIT - 2	1350 SFT (3 BHK)

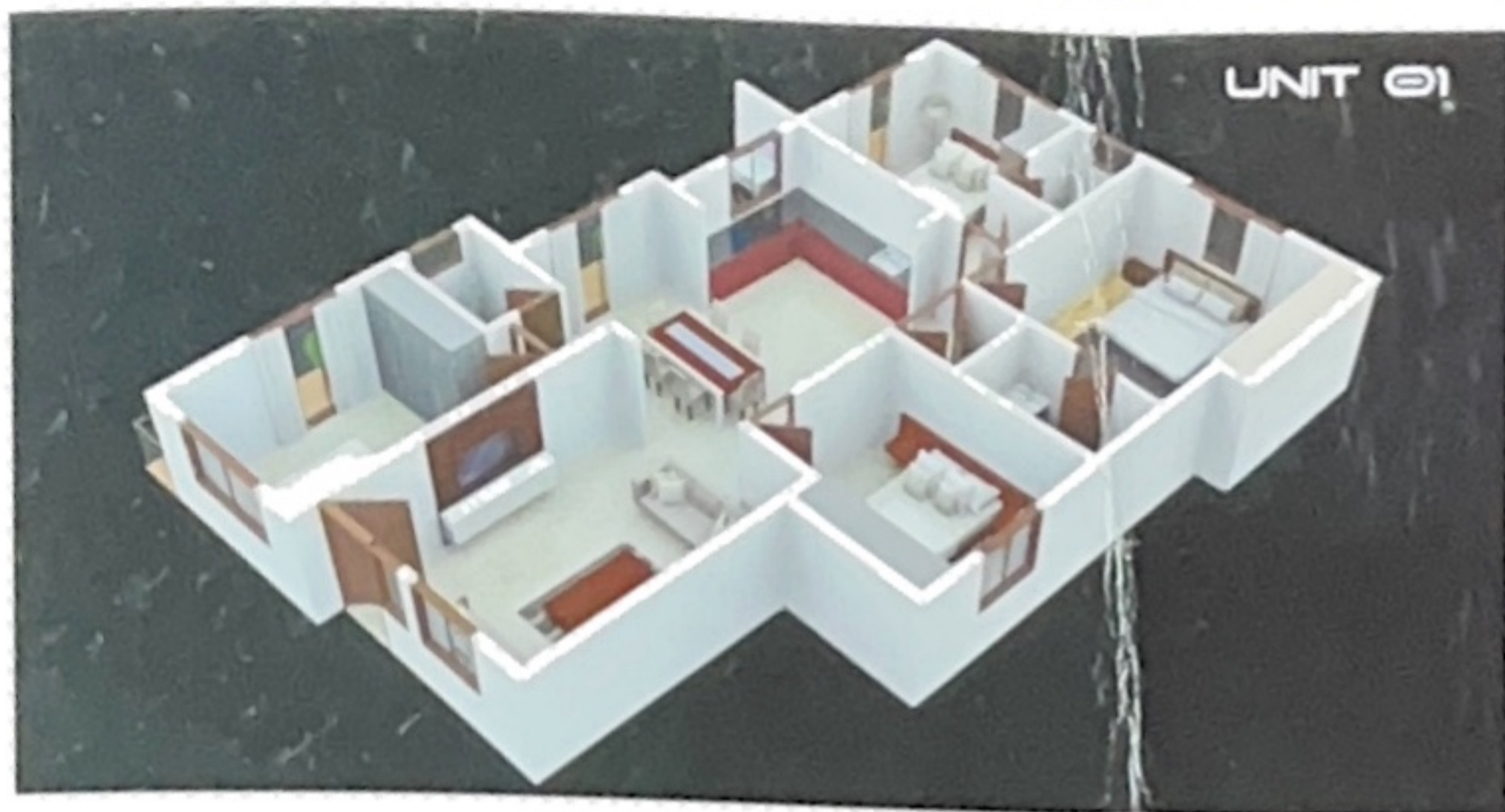

SPECIFICATION

- **Structure**
 RCC Frame Structure
- **Walls**
 Concrete Block Construction
- **Flooring**
 Vitrified Flooring
- **Painting**
 Oil Bound Distemper
- **Electrical**
 Anchor/equivalent Modular Switches,
 Anchor/equivalent Copper wires
- **Plumbing**
 European Water Closet (ECW) of Branded Make,
 Hot & Cold water mixer unit with shower in all
 toilets, All chromium Plated fittings of
 Branded Make
- **Door**
 Main Door of natural wood frame,
 Shutters with both side Masonite skin
- **Windows**
 Aluminum Windows
- **Kitchen**
 Granite Platform slab with Stainless
 Steel with drain board

Area Statement

UNIT - 1	1700 SFT (4 BHK)
UNIT - 2	1350 SFT (3 BHK)

Location Map

