



Your trust, Our success

ASTRO
Maison 
Premium Lifestyle
at Sarjapura Road *Douce*

Think thrice!

Apartments open to nature on three sides.

While investing on a property or opting for a place to live, it is quite natural that your mind ventures beyond second thoughts and seeks another dimension. A most desired location might be the first, a life-style which guarantees freedom should be the second. A dwelling place which is centrally located, still not aloof from the most enlightening moods of nature could be the third. In fact it is this third dimension which makes you discover happiness at your own home. Do think over, once you think thrice, we'd be first to second it!



*Maison Douce - the first
ever three-view apartment
at Sarjapur Road*

Maybe there are three sides to a coin! Especially when it comes to deciding on a place to live your future dream. Needless to say, a location like Sarjapur Road tempts everyone, but only a few get to experience a sweet dwelling place like Maison Douce which holds the entire niceties of such a location. When others just own an address to flaunt, you can live a life which excels their expectations.







ASTRO
Maison 
Premium Lifestyle
at Sarjapura Road *Douce*

What is sweet about your sweet home...

The design of Maison Douce is quite simple, combining the advantages of a location and contemporary design, Maison Douce makes you view life quite differently. With three sides open to lush greenery, the apartment makes sure your living gets tranquilized with soothing views , Every feature at Maison Douce is carefully planned and conceived for a life that crave for -you deserve nothing less.



At Maison Douce, happiness and the feeling of content is not just restricted to the exterior look and feel. In fact, the carefully designed interiors remind you that the concept of a home doesn't revolve around a stunning periphery alone. Apart from two well- designed rooms, Maison Douce also has an elegant, contemporary study-room solely for the coming generation.

The next generation
needs more, we have
room for that as well!



The range of facilities we provide at **Maison Douce** makes you savour the fruits of your labour. Apart from making you experience luxury, nature and convenience which others envy, you realize your long cherished dream, preserving something priceless for posterity!

Landscaped Gardens	Full-fledged Gym
Club House	24 Hours Security
Swimming Pool	24 Hours Power Backup
Multipurpose Hall	Rain Water Harvesting
Badminton Hall	Water Treatment Plant
Indoor Games Area	STP

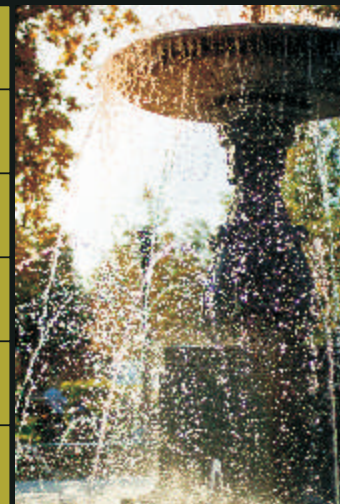

Master Plan



At Maison Douce, we realize that a home has to be well laid-out, not just in terms of its engineering excellence, but also in the manner it synchronizes with your taste and creates a positive field of influence in each and every action you perform. By opting for Maison Douce, you can be proud to have made the most judicious decision. Get ready for an all new lifestyle, right at the most sprawling location, free from pollution and the routine stretch.

Specifications

Structure:	<ul style="list-style-type: none">• RCC frame structure using ready mix concrete.• Solid concrete blocks for internal and outside walls.
Flooring:	<ul style="list-style-type: none">• Premium Vitrified tiles flooring with 4" skirting. - Kajaria / equalant branded• Non-skid flooring for utility and balconies.
Kitchen & Utility:	<ul style="list-style-type: none">• 19mm granite counter top for kitchen platform.• Glazed Tile dado up to 2' 0" height for kitchen and utility platform• Stainless steel sink in Kitchen and utility (in utility without drain board.• Provision for washing machine in utility.
Terrace:	<ul style="list-style-type: none">• Weather proof tile finish with water proof
Doors:	<ul style="list-style-type: none">• Main doors – Teakwood frame and teak paneled doors .• All internal doors with pre hanged readymade doors .• SS hard wares.
Windows:	<ul style="list-style-type: none">• Three track Aluminum Windows with mosquito mesh shutter and 5mm thick plain glass.• MS grill with enamel painted.
Toilets:	<ul style="list-style-type: none">• Ceramic tiles for toilets walls till 7'0" hight and floorings• Star white sanitary fittings with wall mounted EWC'S and wash basins.• C.P. Fittings from Jaquar or equivalent make..
Painting:	<ul style="list-style-type: none">• All internal walls are painted with Acrylic emulsion.• All external walls are painted with weather shield paint.• All M/S like grill, railing are painted with enamel paint.
Electrical:	<ul style="list-style-type: none">• All electrical switches are of Modular type with ISI certified brand.• All cables are of FRL grade from branded company.• Telephone/TV point will be provided..



Apt Type - 2 BHK + Study	Floor Plan A
Super Built up Area : 1465.52 Sqft	
Main Door: East facing Unit	

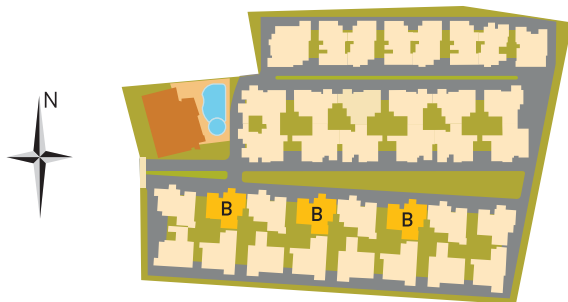
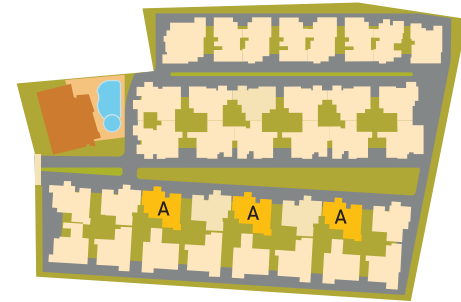

Floor Plan B	Apt Type - 2 BHK + Study
	Super Built up Area : 1436.77 Sqft
	Main Door: South facing Unit





Apt Type - 2 BHK + Study	Floor Plan C
Super Built up Area : 1439.25 Sqft	
Main Door: North facing Unit	

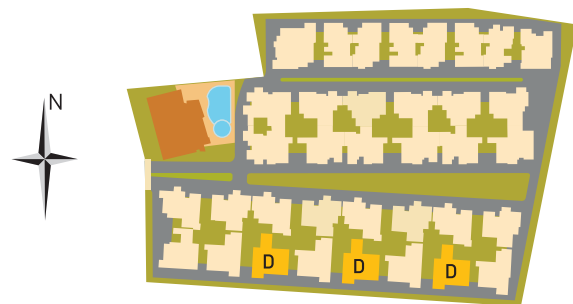
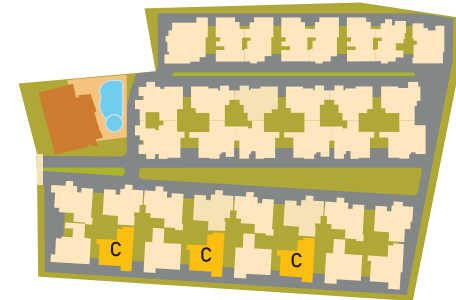

Floor Plan D	Apt Type - 2 BHK + Study
	Super Built up Area : 1452.60 Sqft
	Main Door: East facing Unit

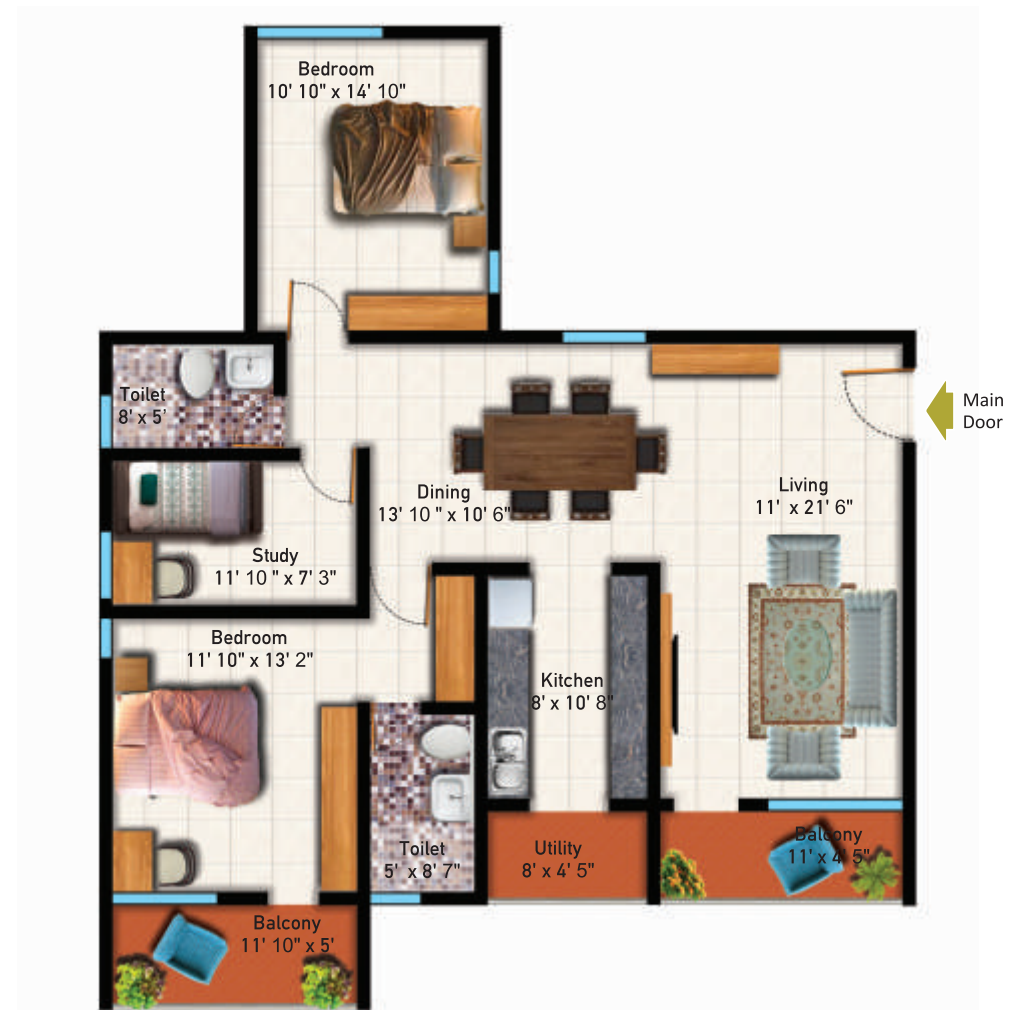



Apt Type - 2 BHK + Study	Floor Plan E
Super Built up Area : 1431.18 Sqft	
Main Door: East facing Unit	

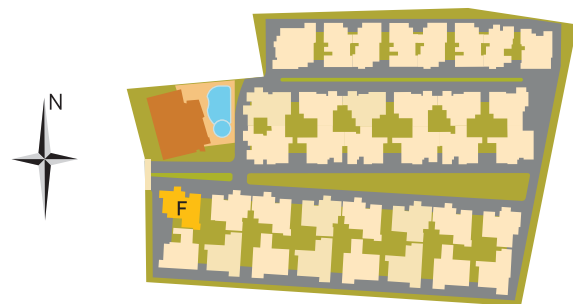
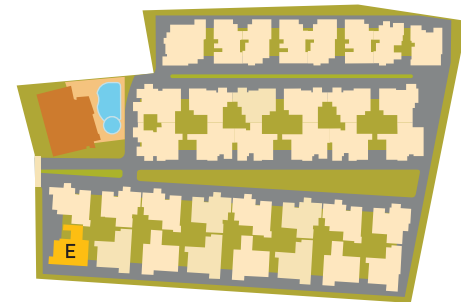

Floor Plan F	Apt Type - 2 BHK + Study
	Super Built up Area : 1486.94 Sqft
	Main Door: East facing Unit



Apt Type - 3 BHK	Floor Plan G
Super Built up Area : 1763.25 Sqft	
Main Door: East facing Unit	

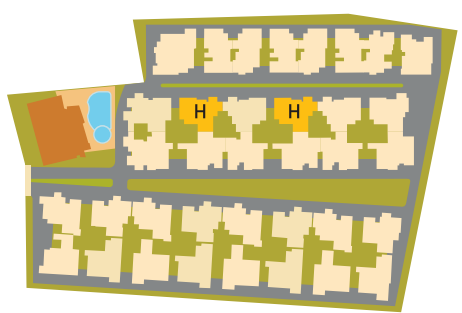
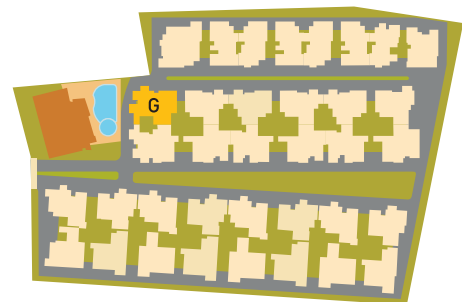

Floor Plan H	Apt Type - 2 BHK + Study
	Super Built up Area : 1393.94 Sqft
	Private Garden Area: 140.36 sqft.
	Main Door: South facing Unit





Apt Type - 2 BHK + Study	Floor Plan J
Super Built up Area : 1499.64 Sqft	
Private Garden Area: 191.38 sqft.	
Main Door: North facing Unit	

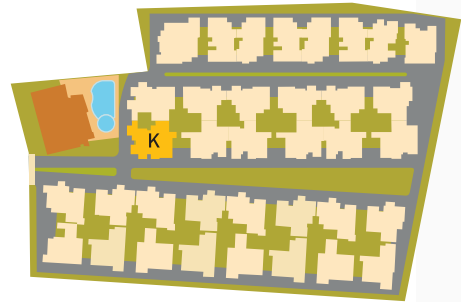
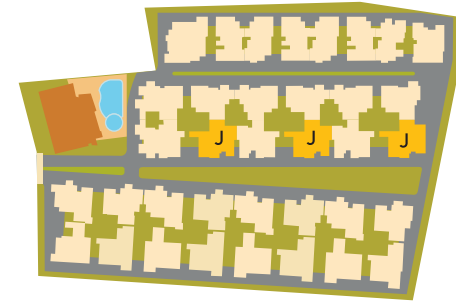

Floor Plan K	Apt Type - 3 BHK
	Super Built up Area = 1812.01 Sqft
	Private Garden Area: 191.38 sqft.
	Main Door: East facing Unit



Apt Type - 2 BHK + Study	Floor Plan 
Super Built up Area = 1456.37 Sqft	
Private Garden Area: 70.50 sqft.	
Main Door: East facing Unit	

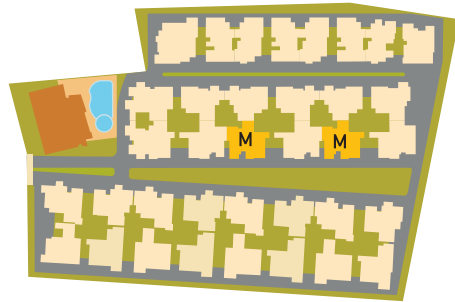
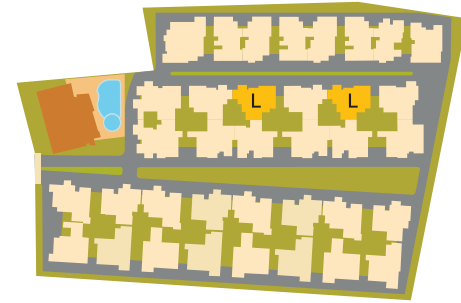

Floor Plan 	Apt Type - 2 BHK + Study
	Super Built up Area = 1491.14 Sqft
	Private Garden Area: 228.95 sqft.
	Main Door: East facing Unit





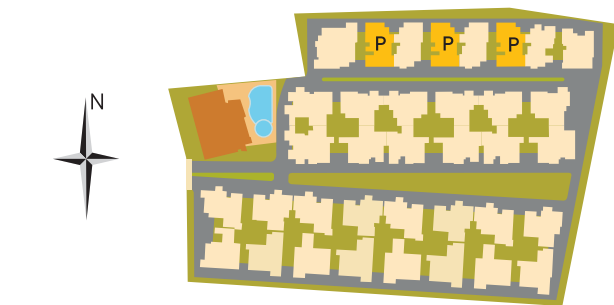
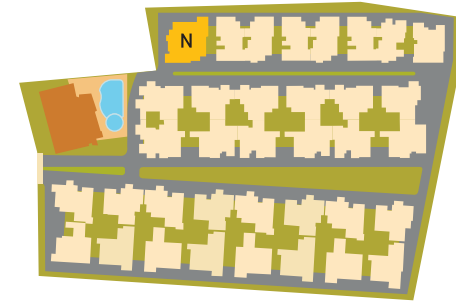

Apt Type - 3 BHK	Floor Plan N
Super Built up Area = 1963.79 Sqft	
Private Garden Area: 159.74 sqft.	
Main Door: East facing Unit	

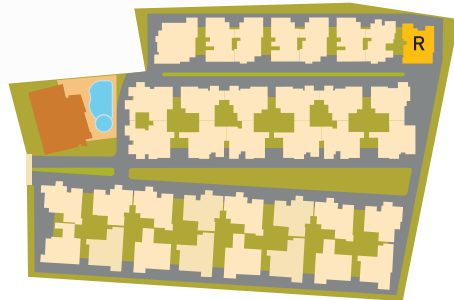

Floor Plan P	Apt Type - 2 BHK + Study
	Super Built up Area = 1404.48 Sqft
	Private Garden Area: 127.98 sqft.
	Main Door: North facing Unit



Floor Plan 	Apt Type - 2 BHK + Study
	Super Built up Area = 1437.75 Sqft
	Private Garden Area: 73.73 sqft.
	Main Door: North facing Unit

Apt Type - 2 BHK	Floor Plan 
Super Built up Area = 1329.79 Sqft	
Main Door: East facing Unit	

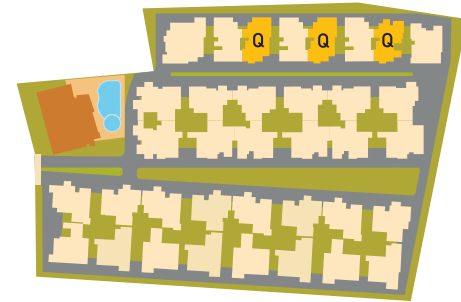



Your trust, Our success

Astro Builders & Developers

117/1, First Floor,
Rakshitha Complex,
Sarjapur Main Road
(Next to Wipro Corp. off)
Bangalore - 560 035.
Tel: 080-2844 1984 / 85
email: astro_builders@yahoo.com

For query call:

76 76 766 766

76 76 744 744

76 76 12 13 14

www.astrobuilders.in

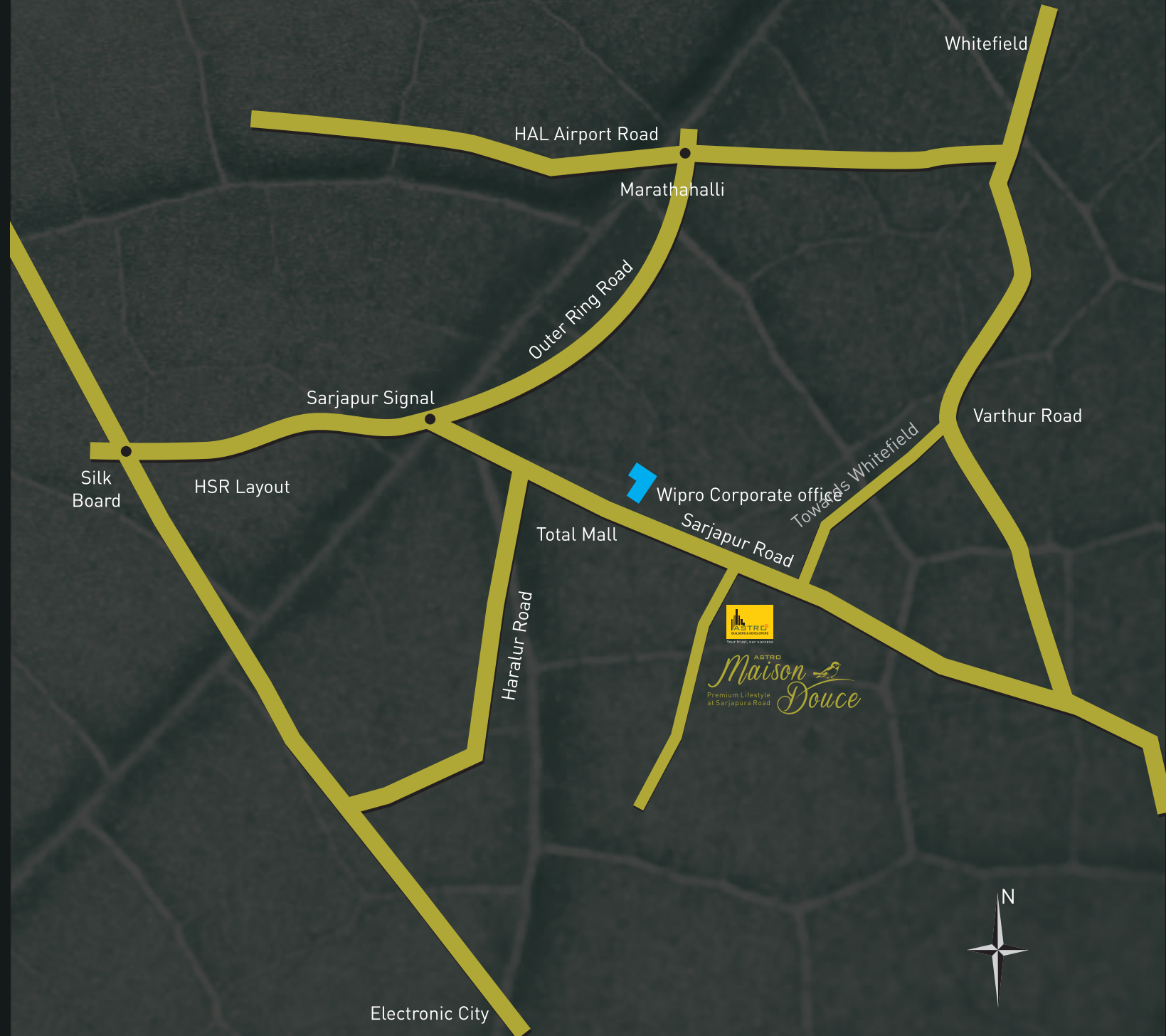

Disclaimer: This Product is not a legal offering and is purely conceptual to give an overall view of the project. The Plans, specifications, images and other project details are purely indicative and the developer reserves the right to change any or all of these in the interest of the project development.