



Kulswamini

Where  
*Elegance*  
Lives



**KULSWAMINI, ANNAPURNA NAGAR, BEHIND GHODAKE HALL,  
AADHAR WADI CHOWK, KALYAN WEST.**



# GROUND FLOOR PLAN

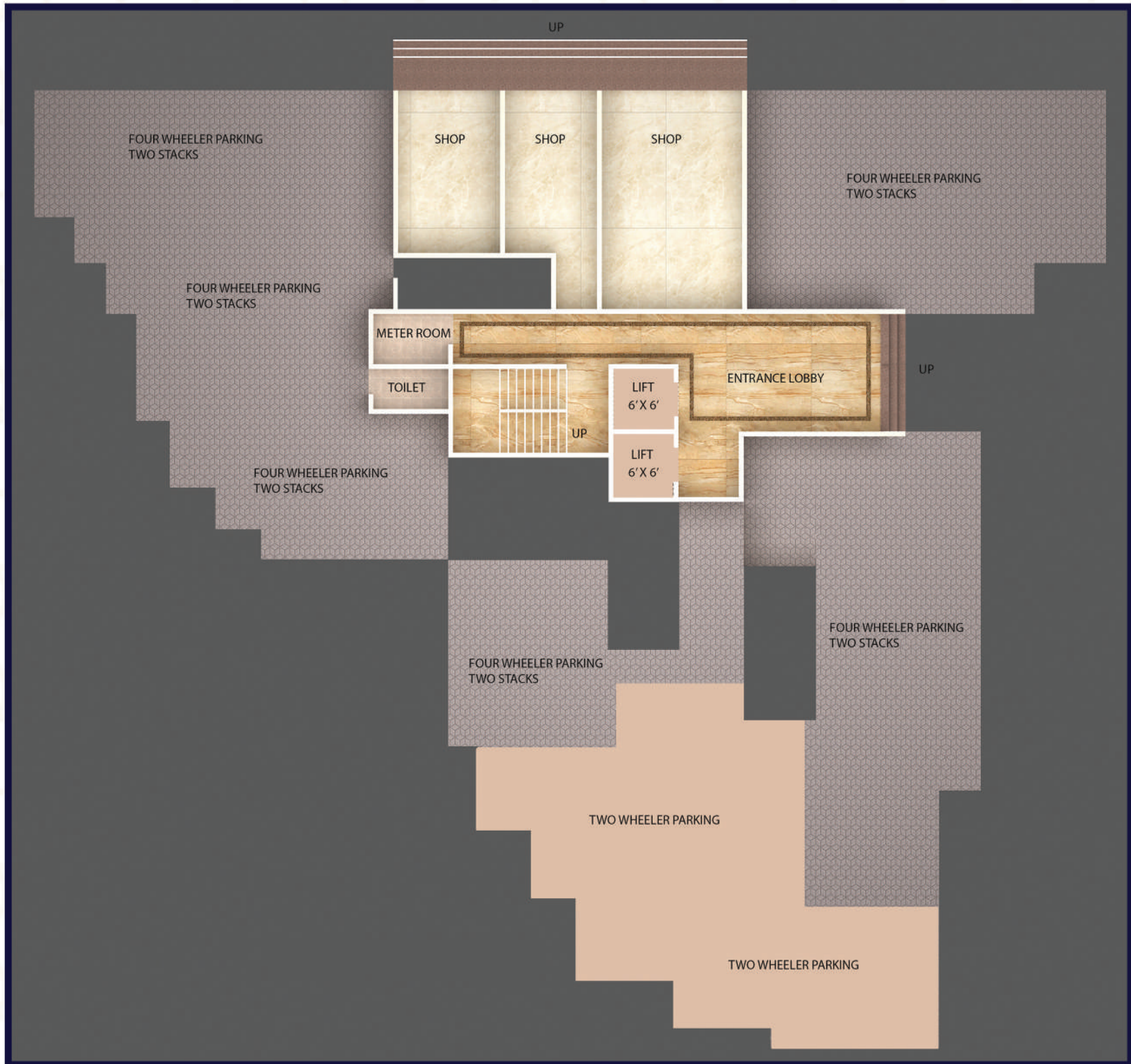

# 1 TO 7 TYPICAL FLOOR PLAN

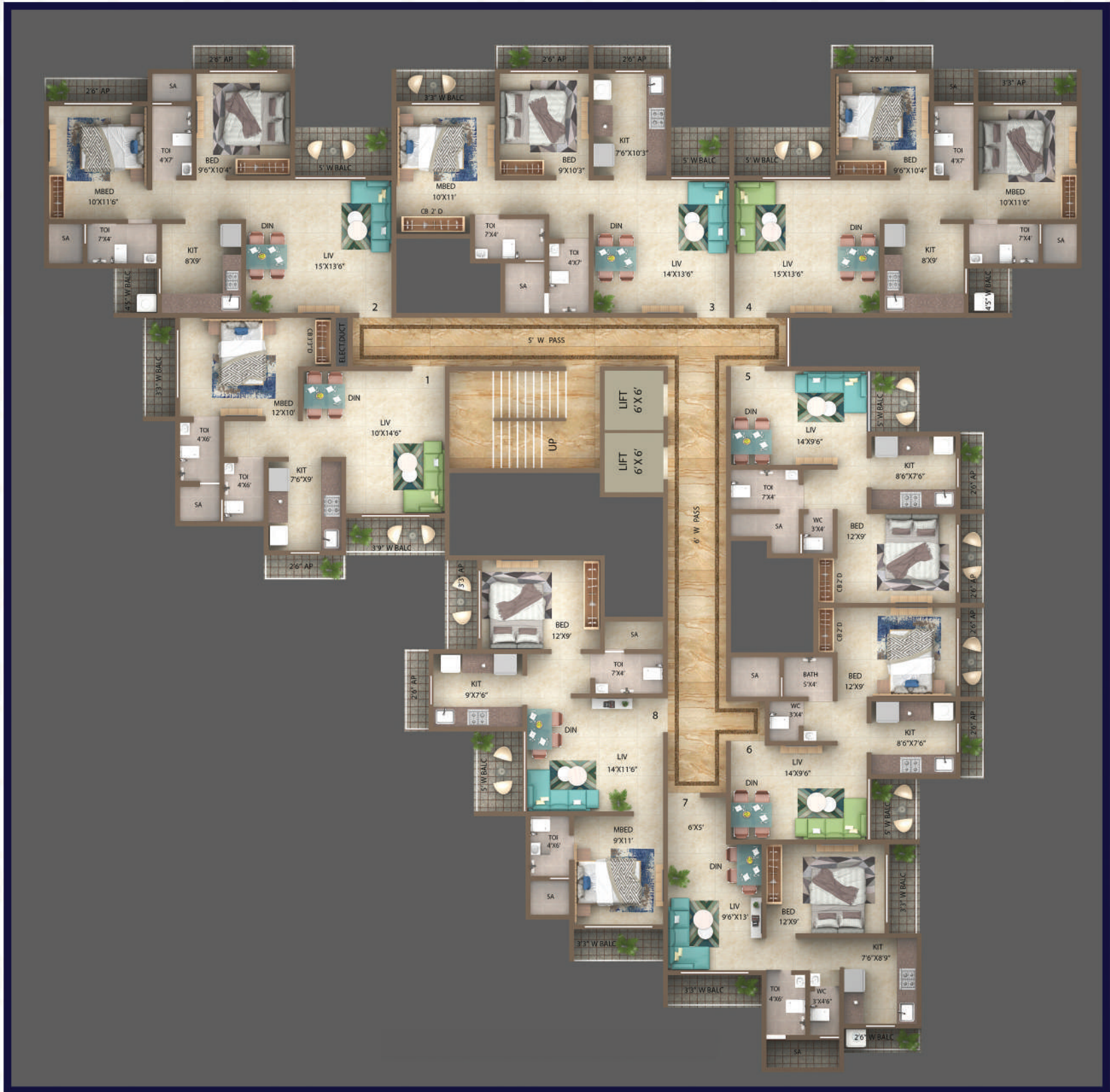



1 BHK



1 BHK



2 BHK



# AMENITIES

- Gypsum finish walls.
- Quality paints in all rooms.
- Branded interior & exterior paint.
- Kitchen full tiles above main platform below beam level.
- Modular stone platform with stainless steel sink on the main platform.
- Modular stone service platform.
- modular stone window sill with photo frame.
- SS trolley in kitchen below the main platform.
- Geyser in bathrooms.
- Ample electric points with Polycab brand or equivalent branded wiring.
- Standard/branded plumbing fittings.
- Standard/branded sanitary fittings.
- 1200 mm × 600 mm vitrified flooring in all rooms.
- Full tiles in bathrooms.
- Anti-skid tiles for FB/Deck/AP area.
- Wooden door frames for main door & bedrooms with attractive Laminate finished flush doors.
- Branded locks for main door & bedroom doors.
- Powder-coated aluminum sliding windows with one-way glass.
- Intercom facility in each flat.
- MS railing in FB/Deck/AP area up to 3 ft height from the floor level.
- Rooftop amenities children play area, Gazebo, meditation area, open air gym.
- Solar net metering system for effective consumption of electricity for common areas.



PROJECT BY:



Where  
*Elegance*  
Lives

Kulswamini

## SITE MAP

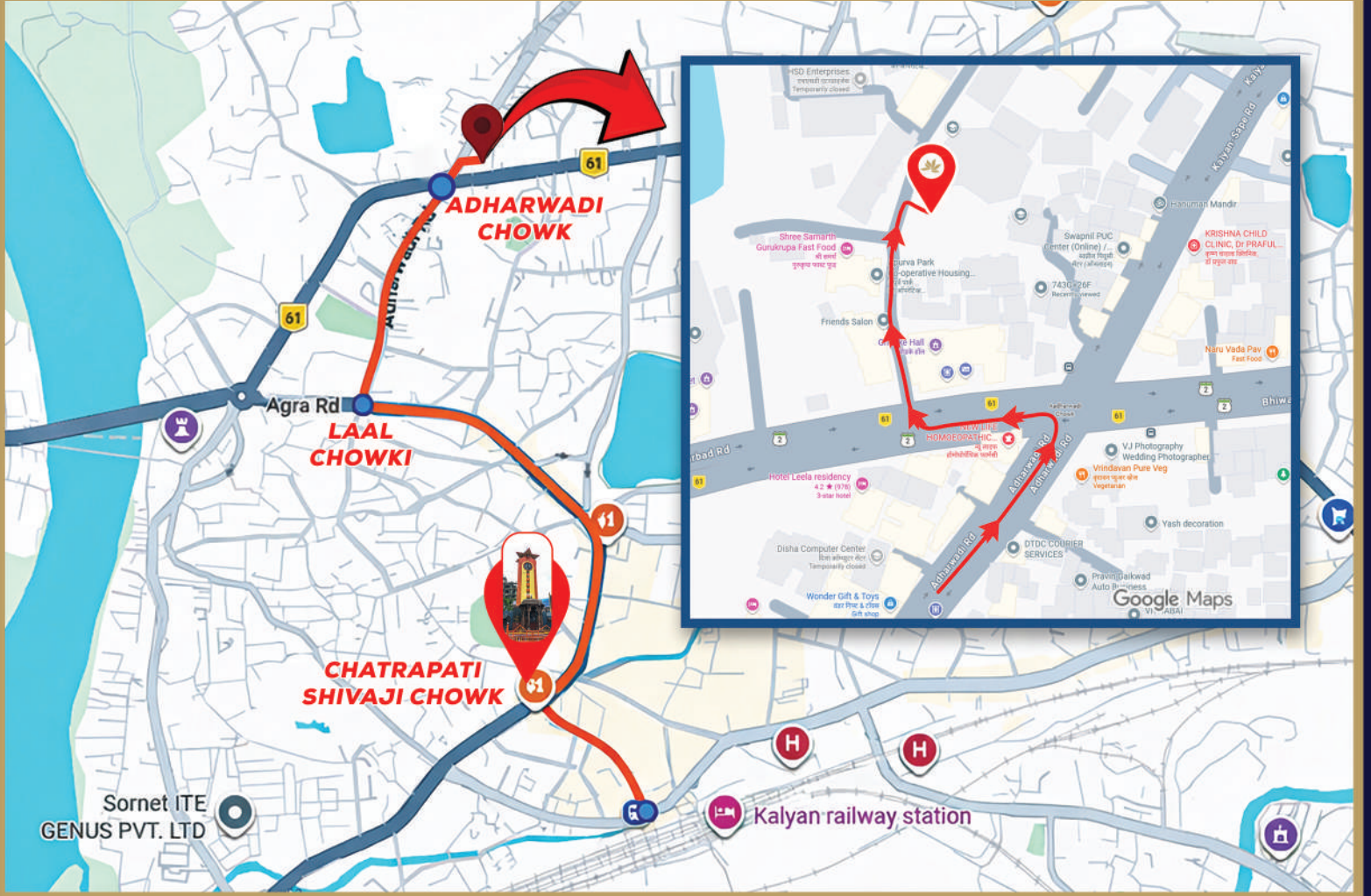

**MAHA RERA REG. NO.  
PM1330002502544**

Details Available on  
<https://maharera.maharashtra.gov.in/>

 [developerkulswamini@gmail.com](mailto:developerkulswamini@gmail.com)

 +91 9769433666

Disclosure: All specification, images, plan, designs, amenities, dimensions, elevations, any other information captured here in are indicative in respects of the whole project and is registered with MAHARERA for details please refer <http://maharera.mahaonline.gov.in>. The project may be subject to revision/s and/or alteration/s in accordance with approvals, orders, and/or compliance with laws/regulation in force from time to time. Unless otherwise stated all the images, visuals, materials and information contained herein are purely creative/artistic concepts and may not be actual representation of the product and/or any amenities. None of the above may be construed to form any basis of, and/or serve as an inducement for invitation for payment of any advance and/or deposit, to be made by a prospective customer under the relevant provisions of law or otherwise.