

PRAVYA

TRUE HOMES FOR THE TRUE YOU.





While the world is swayed
by the frills of luxury, we believe
in a living that's true to its design.

WE BELIEVE IN

TRUE RESIDENCES



LUXURY & LIFE

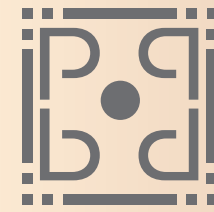

PRAVYA

TRUE HOMES FOR THE TRUE YOU.

Beneath the azure skies of Rajarhat, a new way of living is coming to life—crafted for those who value refined simplicity and seek only what's real. **Pravya** gives you a living true to its core, where nothing but the real facts of living matter.

TRULY UNCUT 3 & 4 BHK APARTMENTS

TRULY 3-SIDES-OPEN

TRULY VAASTU POSITIVE

TRULY 50+ AMENITIES

LANDSCAPE PODIUM

30,000 SQFT CLUB UTSAV

* Club Utsav & Tower 3, 4 & 5 are proposed in Phase II of the Project



7 TOWERS*
(INCLUDING
FUTURE PHASES)

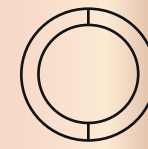

30,000 SQFT
CLUB UTSAV*

3 TRULY BREATH TAKING
VIEWS

PURELY
3 SIDES
OPEN



At Pravya, every tower offers a different perspective to the cityscape, a new view, a new vision for life.

* Club Utsav & Tower 3, 4 & 5 are proposed in Phase II of the Project

TRUTH HAS
IT'S OWN
DESIGN

At Pravya, truth is the starting point of every design decision. That is why our homes are truly three-sides open—not by description, but by experience, bringing in genuine light, air, and privacy. That is why our residences are truly uncut, planned without compromises or shortcuts, allowing spaces to remain whole, balanced, and honest. Guided by truly Vastu-compliant thinking, every orientation and layout is shaped with intent, not assumption, creating harmony that is naturally felt. And that is why our 50+ amenities are truly meaningful, counted for their impact on real life, not for decorative numbers. At Pravya, we have not just built homes; we have designed a way of living that is true in spirit, true in purpose, and true to life, crafted with integrity and built to endure.

— Ar. Manit Rastogi & Ar. Sonali Rastogi
Morphogenesis

AN EMOTION TRUE TO

DESIGN

TRUER TO LIFE.

At Pravya, we believe in crafting homes that are as authentic as the people who live in them. Inspired by the need for a balance between modern convenience and timeless values, this project brings you a living space that's connected, effortless, and rooted in reality. With truly vastu positive, 30,000 sqft CLUB UTSAV and more than 50+ premium amenities, we've created an environment where comfort, nature, and lifestyle meet. Close to key city locations, Pravya is designed for those who value truth in their surroundings and life.

— Soham & DTC



MASTER PLAN

LEGEND

- | | |
|-------------------------|---------------------------------|
| 1. ENTRY/EXIT | 10. KIDS' PLAY AREA |
| 2. TOWER 1 (G+13 FLOOR) | 11. GARDEN LOUNGE |
| 3. TOWER 2 (G+5 FLOOR) | 12. FITNESS ZONE |
| 4. TOWER DROP-OFF ZONE | 13. PARENTS' CORNER |
| 5. DRIVEWAY | 14. PIXEL SIT-OUT |
| 6. GARDEN PAVILION | 15. WATER POD |
| 7. FESTIVE GROUND | 16. TREE DECK/RECREATIONAL LAWN |
| 8. AMPHITHEATRE | 17. GARDEN CABANA |
| 9. SERVICE AREA | 18. JOGGING TRACK |





DROP OFF ZONE

NEVER MISS A FLIGHT
OR A MEETING
OR AN OPPORTUNITY



Close to the airport, offices, IT Hub,
Bengal Silicon Valley, Malls and close
to every essential destination of your
daily life. Feel the pace of connected
living at your getaway address
in Rajarhat.

TO BE TRULY
CONNECTED
TO THE CITY

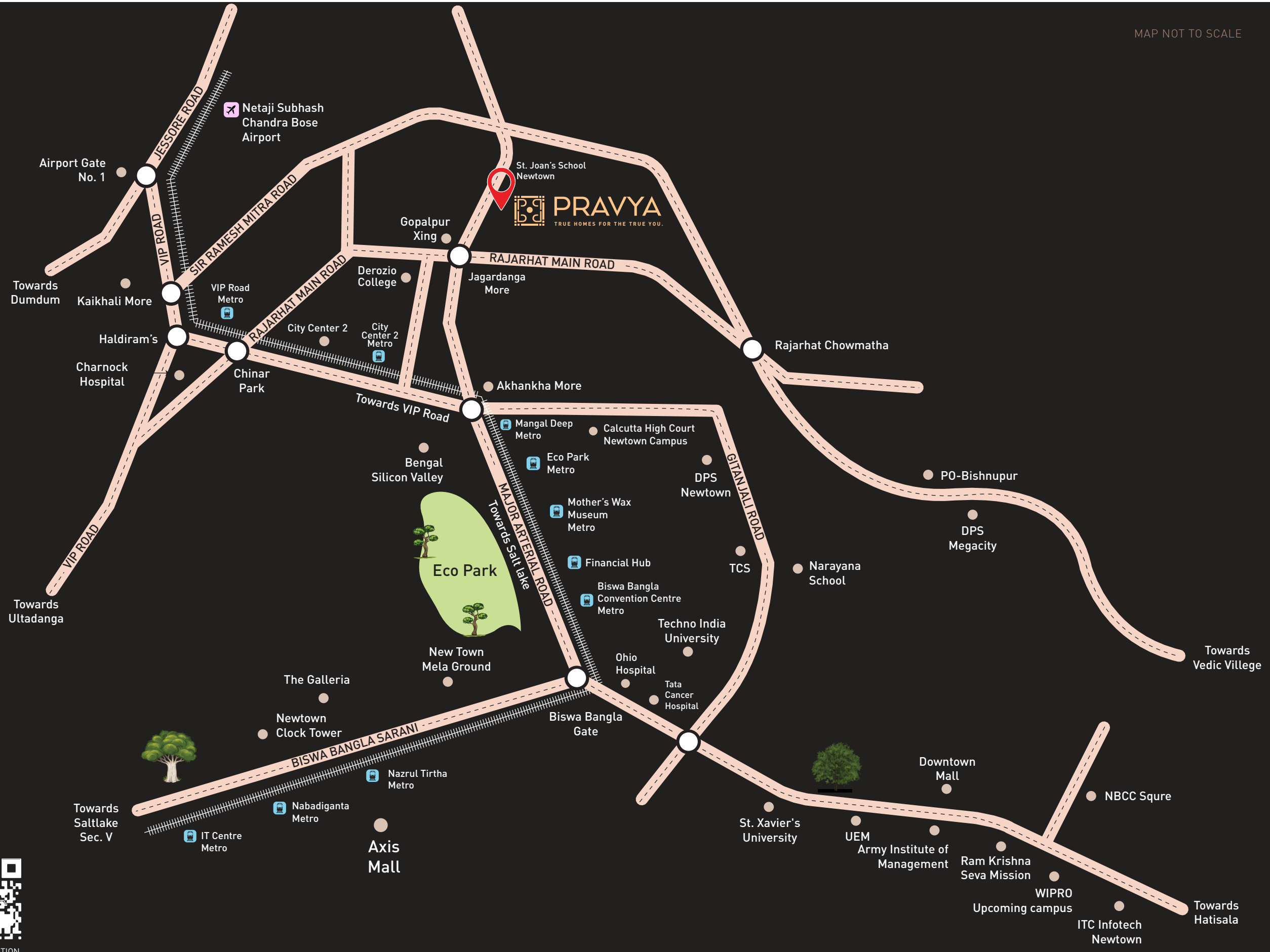

SCAN FOR LOCATION

CONNECTIVITY & TRANSPORT

| | |
|---|--------|
| Mangal Deep Metro | 2.4 km |
| Chinar Park Crossing | 3.3 km |
| Netaji Subhash Chandra Bose Int'l Airport | 5.3 km |
| Belgharia Expressway | 7.1 km |
| Dum Dum Railway Station | 9.4 km |

COMMERCIAL & OFFICE HUBS

| | |
|-------------------------------------|---------|
| Bengal Silicon Valley | 3.1 km |
| Ecospace Business Park | 7.2 km |
| New Town IT Hub (DLF, TCS, Infosys) | 7.5 km |
| Candor Techspace | 8.6 km |
| Sector V, Salt Lake | 12.8 km |

HOSPITALS & HEALTHCARE

| | |
|--|---------|
| Charnock Hospital | 3.7 km |
| Ohio Hospital | 7.8 km |
| Chittaranjan National Cancer Institute | 9.7 km |
| Tata Medical Center | 8.1 km |
| AMRI Salt Lake | 14.7 km |

SCHOOL

| | |
|-------------------------------------|----------|
| North Point Senior Secondary School | 5.7 km |
| Narayana School | 7.5 km |
| St. Stephen's School, Dum Dum | 7.9 km |
| DPS Megacity | 8.8 km |
| St. Joan's School, Newtown | Adjacent |

COLLEGES & UNIVERSITIES

| | |
|------------------------------------|---------|
| Derozio Memorial College | 1.0 km |
| DPS Newtown | 7.3 km |
| Amity University | 7.5 km |
| St. Xavier's University | 9.9 km |
| Techno India College of Technology | 12.6 km |

MALLS & ENTERTAINMENT

| | |
|------------------|---------|
| City Centre II | 2.8 km |
| Axis Mall | 8.4 km |
| City Centre I | 9.3 km |
| Down Town Mall | 10.6 km |
| Mani Square Mall | 12.2 km |

THREE DEDICATED
LEVELS FOR

TRULY ELEVATED AMENITIES

Every step you take at Pravya leads to something exciting — from vibrant podium experiences to the serene beauty of the landscaped outdoors, to the celebratory **CLUB UTSAV**, there's always something to discover.



PODIUM LEVEL



SPACIA

SOCIA →

CLUB UTSAV



GROUND LEVEL



GRACIA



Podium Level

Meditation Pavilion || Pixel Sit-out Nook || Yoga Zone || Sculpture Point
 Contemplation Pod || Kids' Play Area || Garden Lounge with Library || Adda Zone
 Relaxation Zone || Recreation Lawn || Fitness Zone/ Open Gym || Garden Cabana
 Planter Seating || Dance, Karate, Play Rehearsal Area || Tree Deck Multipurpose
 Lawn || Pebble Court || Senior Seating Corner || Totlet Zone || Reflexology Area

Club Utsav

Café || Co-working Space || Business Centre || Old Flock Adda || Guest Rooms
 Admin Room || Banquet Hall With Lawn || Mini Water Fountain || Community Hall
 Green Decks || Yoga Deck || Aerobics || Multipurpose Court (Badminton, Mini
 Basketball & Volleyball) || Cards Room || Pickle Ball Court || Gymnasium
 Indoor Games (Pool, Table Tennis, Foosball, Carrom, Chess & Dart) || Sports
 Lounge || Sports Viewing Gallery || Squash Court || Steam Room || Spa Room
 Infinity-edge Swimming Pool || Kids Splash Pool || Jacuzzi || Open Deck Party
 Lawn || Mini Theatre || BBQ Area || Crèche / Kids' Room

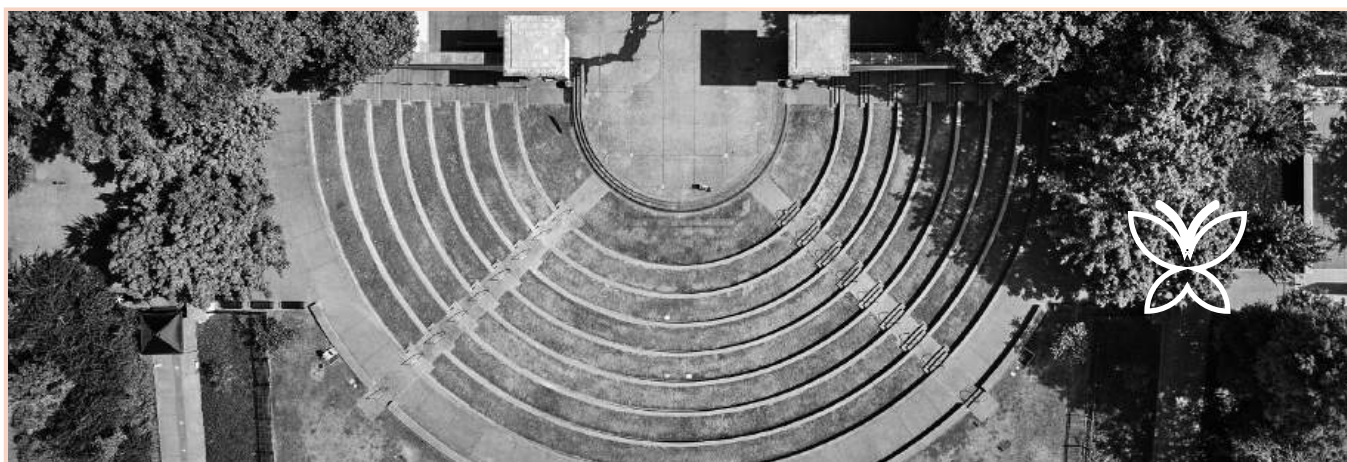

Ground Level

Festive Ground || Garden Pavillion || Amphitheatre || Jogging
 Track || Box Cricket Parents' Corner || Temple || Tower Drop off
 with special Paving Pattern



* Club Utsav & Tower 3, 4 & 5 are proposed in Phase II of the Project

DESIGN TO BE TRULY VAASTU POSITIVE

TO THE **LAWS OF VAASTU** AND THE **UNIVERSE**

Sunlight that feels right.
Air that flows freely.
Green that soothes.
Space that breathes.

Every home here is aligned to let nature do the work, bringing balance, ease, and positive energy into daily life. This is Truly Vaastu, built into the design itself, so living well feels effortless and instinctive.

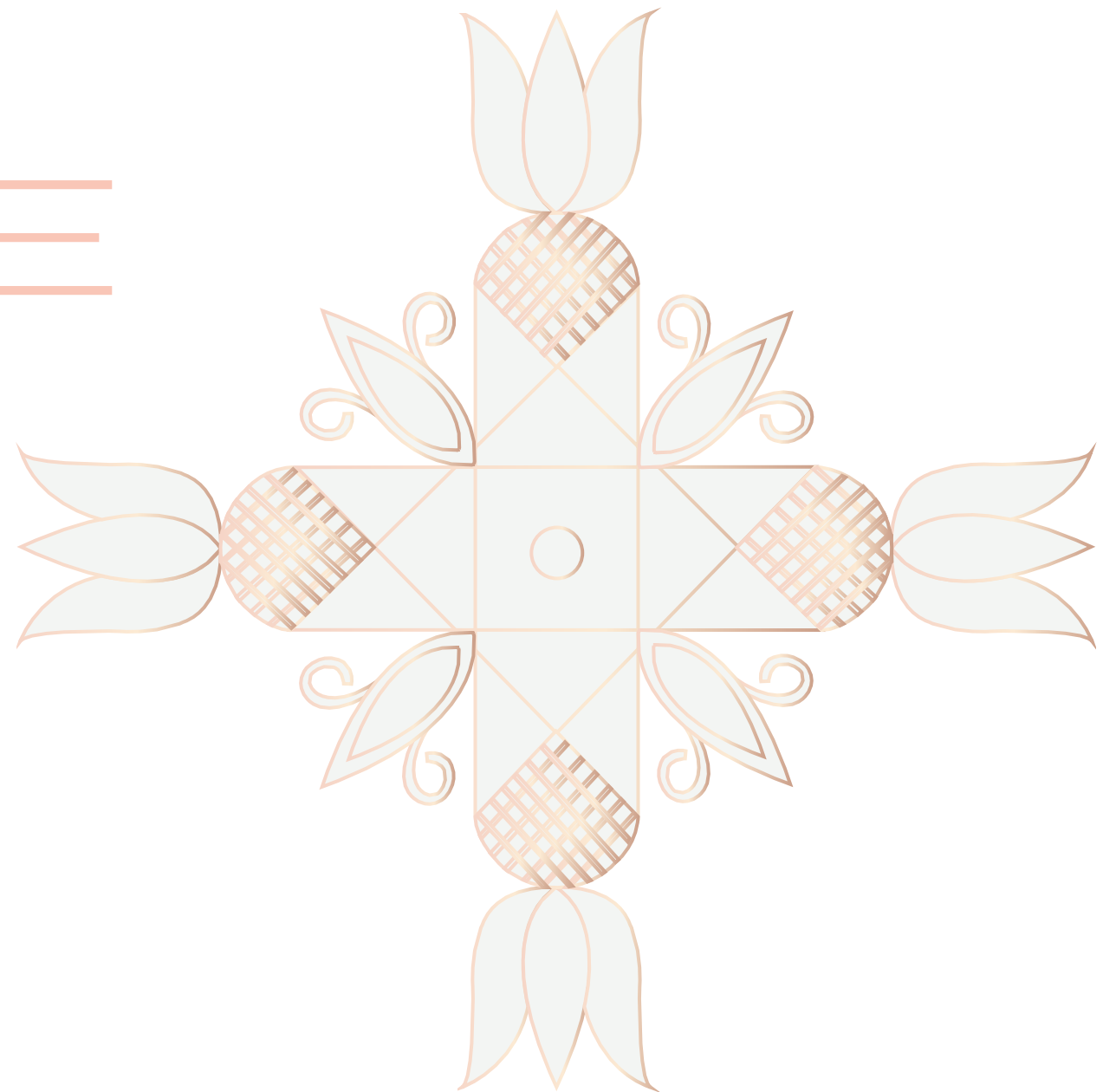

Kitchen is favourably placed in S or closer to SE.



Apartments are oriented and shaped with three sides open to make them vibrant and positive.

Apartment shapes are favourable as per Vastu.

Balconies positioned to enhance daylight, cross ventilation and airflow.

South-facing homes for better wind and air circulation

Master Bedroom is placed favourably in SW.

Furniture placement is also in line with basic Vastu principles.

All apartments are rectangular, with uncut corners



AN ARRAY OF ESSENTIAL FACILITIES

AS TRUE

AS PROMISED!

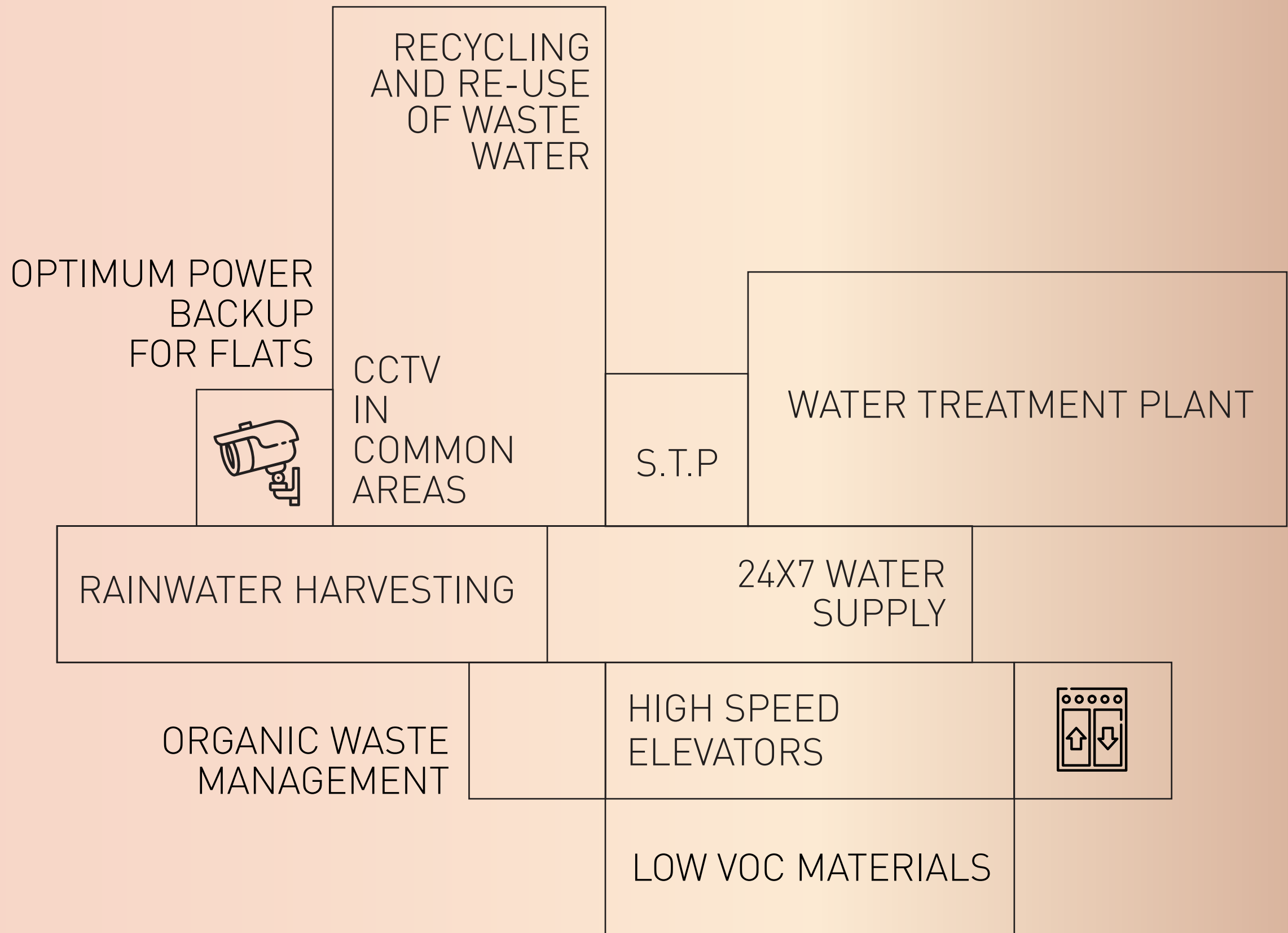

* Amenities & Facilities as mentioned in this brochure will be a combination of Phase I & Phase II of the Project as per sanction

TYPICAL

TOWER 1 PLAN

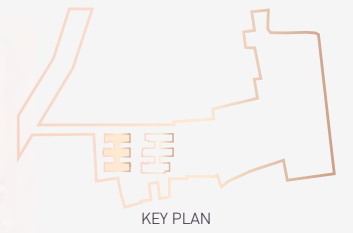

| FLAT TYPE | UNIT TYPE | CARPET | BALCONY AREA | BUA | SBUA |
|-----------|-----------|--------|--------------|------|------|
| 3 BHK+3T | A | 1083 | 80 | 1324 | 1761 |
| 3 BHK+2T | B | 870 | 58 | 1044 | 1389 |
| 3 BHK+3T | C | 1040 | 69 | 1257 | 1672 |
| 3 BHK+2T | D | 942 | 80 | 1133 | 1507 |
| 3 BHK+2T | E | 907 | 39 | 1056 | 1404 |
| 3 BHK+2T | F | 907 | 39 | 1053 | 1400 |



NOT TO SCALE

TOWER 1 FLAT A

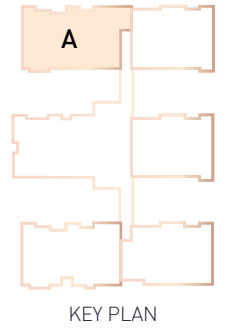

| L | D | V1 | V2 | K | B1 | T1 | B2 | T2 | B3 | T3 |
|-----------------------|----------------------|---------------|---------------|----------------------|-----------------------|----------------------|-----------------------|---------------------|-----------------------|---------------------|
| LIVING | DINING | BALCONY | BALCONY | KITCHEN | BEDROOM | TOILET | BEDROOM | TOILET | BEDROOM | TOILET |
| 11'-6" X 15'-5" | 17'-2" X 8'-3" | 5'-4" Wide | 4'-1" Wide | 9'-6" X 10'-1" | 12'-0" X 11'-5" | 5'-0" X 11'-7" | 12'-0" X 10'-0" | 8'-0" X 5'-0" | 12'-0" X 10'-0" | 8'-0" X 5'-0" |



| UNIT TYPE | FLAT TYPE | SBUA (SQ.FT.) | BUA (SQ.FT.) | CARPET AREA (SQ.FT.) | BALCONY AREA (SQ.FT.) |
|------------|-----------|---------------|--------------|----------------------|-----------------------|
| 3 BHK - 3T | A | 1761 | 1324 | 1083 | 80 |

TOWER 1
FLAT B

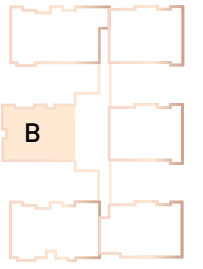

KEY PLAN



| L | D | V1 | V2 | K | B1 | T1 | B2 | T2 | B3 |
|-----------------------|----------------------|----------------|---|----------------------|-----------------------|----------------------|-----------------------|---------------------|-----------------------|
| LIVING | DINING | BALCONY | BALCONY <small>(WITH FLOWER BED)</small> | KITCHEN | BEDROOM | TOILET | BEDROOM | TOILET | BEDROOM |
| 12'-0" X 14'-5" | 10'-0" X 9'-3" | 4'- 0" wide | 3' X 5" wide | 8'-0" X 11'-1" | 11'-9" X 10'-1" | 10'-0" X 5'-0" | 10'-0" X 11'-0" | 5'-5" X 6'-8" | 10'-0" X 10'-0" |



| UNIT TYPE | FLAT TYPE | SBUA (SQ.FT.) | BUA (SQ.FT.) | CARPET AREA (SQ.FT.) | BALCONY AREA (SQ.FT.) |
|------------|-----------|---------------|--------------|----------------------|-----------------------|
| 3 BHK - 2T | B | 1389 | 1044 | 870 | 58 |

TOWER 1 FLAT C

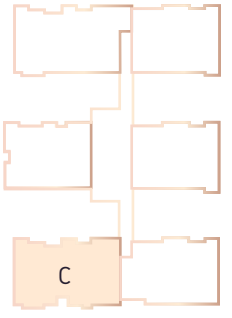

KEY PLAN



| L | D | V1 | V2 | K | B1 | T1 | B2 | T2 | B3 | T3 |
|-----------------------|---|---------------|---------------|----------------------|-----------------------|---------------------|------------------------|---------------------|-----------------------|----------------------|
| LIVING & DINING | | BALCONY | BALCONY | KITCHEN | BEDROOM | TOILET | BEDROOM | TOILET | BEDROOM | TOILET |
| 11'-6" X 23'-3" | | 5'-4" Wide | 4'-0" Wide | 8'-6" X 11'-6" | 12'-0" X 11'-5" | 8'-0" X 5'-0" | 11'-10" X 10'-0" | 5'-0" X 8'-0" | 11'-9" X 11'-4" | 5'-0" X 11'-6" |



NOT TO SCALE



| UNIT TYPE | FLAT TYPE | SBUA (SQ.FT.) | BUA (SQ.FT.) | CARPET AREA (SQ.FT.) | BALCONY AREA (SQ.FT.) |
|------------|-----------|---------------|--------------|----------------------|-----------------------|
| 3 BHK - 3T | C | 1672 | 1257 | 1040 | 69 |

TOWER 1 FLAT D

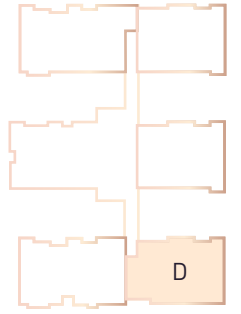

KEY PLAN

| L | D | V1 | V2 | K | B1 | T1 | B2 | T2 | B3 | W.I.W |
|-----------------------|----------------------|--|-----------------|----------------------|-----------------------|---------------------|-----------------------|---------------------|-----------------------|---------------------|
| LIVING | DINING | BALCONY <small>WITH FLOWERS BED</small> | BALCONY | KITCHEN | BEDROOM | TOILET | BEDROOM | TOILET | BEDROOM | W.I.W |
| 12'-6" X 13'-4" | 10'-4" X 9'-3" | 5'-4" Wide | 4' X 0" Wide | 7'-2" X 10'-5" | 12'-7" X 10'-1" | 5'-0" X 8'-0" | 12'-4" X 10'-0" | 8'-0" X 5'-1" | 12'-3" X 10'-0" | 5'-4" X 7'-0" |



| UNIT TYPE | FLAT TYPE | SBUA (SQ.FT.) | BUA (SQ.FT.) | CARPET AREA (SQ.FT.) | BALCONY AREA (SQ.FT.) |
|------------|-----------|---------------|--------------|----------------------|-----------------------|
| 3 BHK - 2T | D | 1507 | 1133 | 942 | 80 |

TOWER 1 FLAT E & F

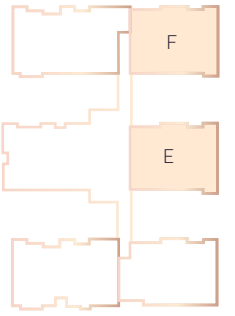

KEY PLAN



| L | D | V1 | K | B1 | T1 | B2 | T2 | B3 |
|-----------------------|----------------------|---|----------------------|-----------------------|---------------------|-----------------------|---------------------|-----------------------|
| LIVING | DINING | BALCONY <small>WITH FLOWER BED</small> | KITCHEN | BEDROOM | TOILET | BEDROOM | TOILET | BEDROOM |
| 12'-7" X 13'-4" | 10'-6" X 9'-4" | 5'- 4' wide | 7'-2" X 10'-0" | 11'-0" X 12'-1" | 5'-0" X 8'-0" | 12'-3" X 10'-0" | 8'-6" X 5'-1" | 12'-3" X 10'-0" |



NOT TO SCALE



| UNIT TYPE | FLAT TYPE | SBUA (SQ.FT.) | BUA (SQ.FT.) | CARPET AREA (SQ.FT.) | BALCONY AREA (SQ.FT.) |
|------------|-----------|---------------|--------------|----------------------|-----------------------|
| 3 BHK - 2T | E | 1404 | 1056 | 907 | 39 |
| 3 BHK - 2T | F | 1400 | 1053 | 907 | 39 |

TYPICAL

TOWER 2 PLAN

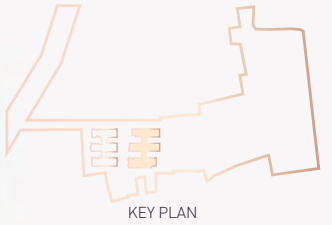

| FLAT TYPE | UNIT TYPE | CARPET | BALCONY AREA | BUA | SBUA |
|-----------|-----------|--------|--------------|------|------|
| 3 BHK+3T | A | 1083 | 80 | 1316 | 1750 |
| 3 BHK+3T | B | 1045 | 70 | 1257 | 1672 |
| 4 BHK+3T | C | 1299 | 88 | 1541 | 2050 |
| 4 BHK+3T | D | 1377 | 86 | 1611 | 2143 |
| 3 BHK+3T | E | 1093 | 48 | 1264 | 1681 |
| 3 BHK+3T | F | 1093 | 48 | 1261 | 1677 |



TOWER 2 FLAT A

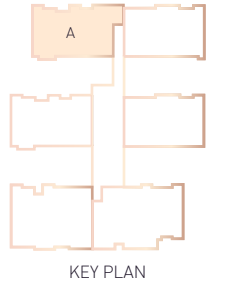

| L | D | V1 | V2 | K | B1 | T1 | B2 | T2 | B3 | T3 |
|-----------------------|----------------------|---------------|---------------|----------------------|-----------------------|----------------------|-----------------------|---------------------|-----------------------|---------------------|
| LIVING | DINING | BALCONY | BALCONY | KITCHEN | BEDROOM | TOILET | BEDROOM | TOILET | BEDROOM | TOILET |
| 11'-6" X 15'-5" | 17'-2" X 8'-3" | 5'-4" Wide | 3'-5" Wide | 9'-6" X 10'-1" | 12'-0" X 11'-5" | 5'-0" X 11'-7" | 12'-0" X 10'-0" | 8'-0" X 5'-0" | 12'-0" X 10'-0" | 8'-0" X 5'-0" |



| UNIT TYPE | FLAT TYPE | SBUA (SQ.FT.) | BUA (SQ.FT.) | CARPET AREA (SQ.FT.) | BALCONY AREA (SQ.FT.) |
|------------|-----------|---------------|--------------|----------------------|-----------------------|
| 3 BHK - 3T | A | 1750 | 1316 | 1083 | 80 |

TOWER 2 FLAT B

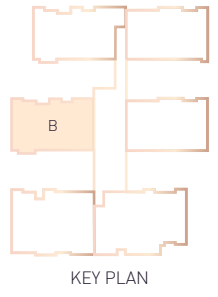

| L | D | V1 | V2 | K | B1 | T1 | B2 | T2 | B3 | T3 |
|-----------------------|----------------------|--|--|----------------------|-----------------------|---------------------|------------------------|----------------------|-----------------------|---------------------|
| LIVING | DINING | BALCONY <small>WITH FLOUNDER DECK</small> | BALCONY <small>WITH FLOUNDER DECK</small> | KITCHEN | BEDROOM | TOILET | BEDROOM | TOILET | BEDROOM | TOILET |
| 15'-5" X 10'-4" | 11'-5" X 8'-3" | 5'-4" wide | 3'-5" wide | 9'-6" X 10'-1" | 12'-0" X 11'-5" | 8'-0" X 5'-0" | 11'-10' X 10'-0" | 5'-0" X 11'-7" | 12'-0" X 11'-4" | 5'-0" x 7'-9" |



| UNIT TYPE | FLAT TYPE | SBUA (SQ.FT.) | BUA (SQ.FT.) | CARPET AREA (SQ.FT.) | BALCONY AREA (SQ.FT.) |
|------------|-----------|---------------|--------------|----------------------|-----------------------|
| 3 BHK - 3T | B | 1672 | 1257 | 1045 | 70 |

TOWER 2 FLAT C

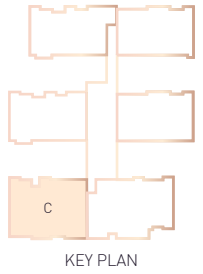

| L | D | V1 | V2 | K | B1 | T1 | B2 | T2 | B3 | T3 | B4 |
|-----------------------|-----------------------|----------------|---|----------------------|-----------------------|---------------------|-----------------------|---------------------|-----------------------|---------------------|-----------------------|
| LIVING | DINING | BALCONY | BALCONY <small>WITH FLAMED BED</small> | KITCHEN | BEDROOM | TOILET | BEDROOM | TOILET | BEDROOM | TOILET | BEDROOM |
| 16'-3" X 17'-3" | 12'-0" X 10'-4" | 5'- 4' wide | 5'- 4' wide | 8'-0' X 14'-0" | 12'-0" X 10'-8" | 8'-0" X 5'-0" | 11'-9" X 10'-0" | 5'-0" X 8'-0" | 11'-6" X 10'-0" | 8'-0" X 5'-0" | 11'-0" X 12'-0" |



| UNIT TYPE | FLAT TYPE | SBUA (SQ.FT.) | BUA (SQ.FT.) | CARPET AREA (SQ.FT.) | BALCONY AREA (SQ.FT.) |
|------------|-----------|---------------|--------------|----------------------|-----------------------|
| 4 BHK - 3T | C | 2050 | 1541 | 1299 | 88 |

TOWER 2 FLAT D

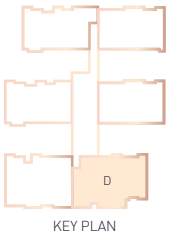

| L | D | V1 | V2 | K | B1 | T1 | B2 | T2 | B3 | T3 | B4 |
|-----------------------|------------------------|-----------------|---|-----------------------|-----------------------|----------------------|-----------------------|---------------------|-----------------------|----------------------|-----------------------|
| LIVING | DINING | BALCONY | BALCONY <small>(WITH FLOWER BED)</small> | KITCHEN | BEDROOM | TOILET | BEDROOM | TOILET | BEDROOM | TOILET | BEDROOM |
| 16'-2" X 14'-0" | 10'-08" X 10'-2" | 4' X 0" wide | 5' X 4" wide | 9'-6" X 13'-11" | 10'-0" X 12'-1" | 5'-0" X 12'-1" | 11'-6" X 10'-0" | 8'-0" X 5'-0" | 11'-8" X 13'-3" | 5'-0" X 12'-0" | 11'-7" X 10'-5" |



| UNIT TYPE | FLAT TYPE | SBUA (SQ.FT.) | BUA (SQ.FT.) | CARPET AREA (SQ.FT.) | BALCONY AREA (SQ.FT.) |
|------------|-----------|---------------|--------------|----------------------|-----------------------|
| 4 BHK - 3T | D | 2143 | 1611 | 1377 | 86 |

TOWER 2 FLAT E & F

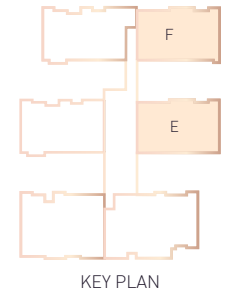

| L | D | V1 | K | B1 | T1 | B2 | T2 | B3 | T3 |
|--------|--------|---|---------|---------|--------|---------|--------|---------|--------|
| LIVING | DINING | BALCONY <small>WITH FLOORED DECK</small> | KITCHEN | BEDROOM | TOILET | BEDROOM | TOILET | BEDROOM | TOILET |
| 17'-4" | 12'-6" | 5'-4" | 9'-0" | 11'-9" | 5'-0" | 13'-5" | 8'-0" | 12'-0" | 5'-0" |
| X | X | Wide | X | X | X | X | X | X | X |
| 13'-4" | 11'-3" | | 10'-1" | 12'-0" | 8'-0" | 10'-0" | 5'-0" | 10'-1" | 10'-0" |



| UNIT TYPE | FLAT TYPE | SBUA (SQ.FT.) | BUA (SQ.FT.) | CARPET AREA (SQ.FT.) | BALCONY AREA (SQ.FT.) |
|------------|-----------|---------------|--------------|----------------------|-----------------------|
| 3 BHK - 3T | E | 1681 | 1264 | 1093 | 48 |
| 3 BHK - 3T | F | 1677 | 1261 | 1093 | 48 |

SPECIFICATIONS THAT DEFINE THE **TRUE MEANING OF DETAIL**

Structure & Masonry

| | |
|-----------|------------|
| Structure | RCC |
| Masonry | Block Work |

Internal Wall Finish

Gypsum Plaster / Putty

Flooring

| | |
|------------------|--|
| Living / Dinning | Vitrified Tiles (4' X 2' Branded Tiles) |
| All Bedrooms | Vitrified Tiles (4' X 2' Branded Tiles) |
| Kitchen Flooring | Vitrified Tiles (4' X 2' Branded Tiles) |
| Kitchen Dado | Ceramic Tiles Up to 2' Above Counter (2' X 1' Branded Tiles) |
| Kitchen Counter | Granite Slab with Stainless Steel Sink |
| Toilet Flooring | Anti-skid Tiles (2' X 2' Branded Tiles) |
| Toilet Dado | Ceramic Tiles (4' X 2' Branded Tiles) |
| All Balconies | Vitrified Tiles (4' X 6" Wood Look Finish Branded Tiles) |
| Terrace | Anti-skid Vitrified Tiles (Wood Look Finish 4' X 2') |

Doors & Windows

| | |
|------------------------|---|
| Door Frames | Solid/Engineered Wooden Frame |
| Main Door of Apartment | Both Side Laminated Solid Core Flush Door |
| Inside Doors | Flush Doors |
| Windows | Fully Glazed Powder Coated - Aluminium Windows, Windows - |
| Aluminium | Openable, Door (Outdoor) - Aluminium Sliding. |

Hardware & Fittings

Branded Locks & Hardware Fittings- Godrej / Dorset / Quba / Europa or Similar

Railings

Ms Railings Painted.

Electrical

Concealed Copper Wire of Reputed Brands- Havells / RR Kabel / Polycab / KEI or Similar

Adequate Electrical Points in Bedroom, Living Room, Dining Room, Kitchen & Toilet

Modular Switches of Reputed Brands – Havells, Anchor, Schneider, Legrand or Similar

Electrical Point for Water Filter In Kitchen.

Provision for Chimney or Exhaust Point in Kitchen,

Air Conditioning

Provision for Air Conditioning (AC)

Sanitary Ware

Jaquar / Kohler / American Standard or Equivalent Reputed Brand.

CP Fittings

Jaquar / Kohler/ Grohe or Equivalent Reputed Brand.

Provision for hot and cold line in shower area only.

Elevators

Kone / Schindler / Otis / Johnson ~ Modern Elevator of Reputed Make or Equivalent.

Exterior

External Wall Finish : Paint

Others Facilities

24 Hours Water Supply.

Water Treatment Plant.

Optimum Back-up Power Supply in all flats to run essential electrical appliances

CCTV

CCTV Surveillance on The Ground Floor of The Complex & other Strategic Areas

MEET THE MAKERS OF A

TRUE

REMARKABLE LIVING



With over 37+ years of expertise in real estate, Soham Group is synonymous with restoring heritage property and redefining both residential and commercial urban spaces. We create living experiences that embody delight, functionality, and integrity—driven by a vision to set new benchmarks in modern urban living.

Our Projects:



Soham SynerG



THE LEVELZ



MORYA



Soham Industrial Hub



Diamond Heritage



NAVITA



With 40+ years of legacy and landmarks like Capital City, Southern Heights, and Palm Grove, DTC builds more than homes — they build communities rooted in trust, design, and true value.

Our Projects:



DTC Stillwaters



DTC Capital city



DTC Capital Crest



DTC GOOD EARTH



DTC Palm Grove



DTC Sojon

PRINCIPAL ARCHITECT

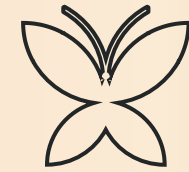

STRUCTURAL CONSULTANT



LANDSCAPE ARCHITECT



BRANDING



COME, LET YOUR

LIFESTYLE

BE THE TRUTH TO BEHOLD



DEVELOPER



CO-DEVELOPER



CORPORATE ADDRESS:

Soham Group, Diamond Heritage
Unit 301D & 1411 16, Strand Rd, Fairley Place
B.B.D. Bagh, Kolkata, West Bengal 700001

P: 033 – 4004 4409

E: sales@sohamstates.com

W: www.sohamstates.com

Mobile Number: +91 70444 40123

SITE ADDRESS:

Mouza, J.L. No: 2, P.S: Narayanpur, Gopalpur, Kolkata,
Beside St. Joan's School Newtown,
West Bengal 700136

RERA No.: WBRERA/P/NOR/2026/003900 || <https://rera.wb.gov.in/>

Disclaimer: This is not an offer or invitation for offer. Furniture & fixtures shown are not part of the offer. The brochure is purely conceptual. Information included in the brochure including elevation details, specifications, dimensions, designs, layouts and rendered images are strictly provided for representative and illustrative purposes, and are subject to modification.