



MODERN LIFE  
WITH A  
TOUCH OF  
STYLE

 **GANESH-2**  
HEIGHTS

**1-2-3 BHK**  
EXCLUSIVE FLATS & SHOPS

**LIFE IS A SYMPHONY OF  
HAPPINESS HERE..**

Bask in the joy of coming home to brilliantly planned architecture where each and every element has been perfectly created to present you with a dreamlike majestic living.



Artistic image\*



Bess

Givenchy

Giorgio Armani

TopShop

Alexander

Prada

Rock Smith

Fendi

Lanvin

Fendi

DKNY

Gieci

Tenzo



Artistic image\*

## SUCH A CAPTIVATING SPACE, IT ALMOST FEELS MAGICAL

Everywhere you look charming scenery follows you. Exquisite artefacts, water bodies and lush landscape come together to create an enchanting ambience that appeases your eyes as well as your soul.



Basic Vastu  
99%



Jogging Track



24 x 7 Security



Automatic 2 Lift



Children  
Play Zone



Gas Line



Surrounding  
Bungalows Area



Private Bor  
& Water Supply  
Pressure System



Ample Natural  
Light & Ventilation



Top Floor  
Penthouse Unit



24 x 7 CCTV  
Surveillance  
AT Common AREA



Fire Safety  
Measures

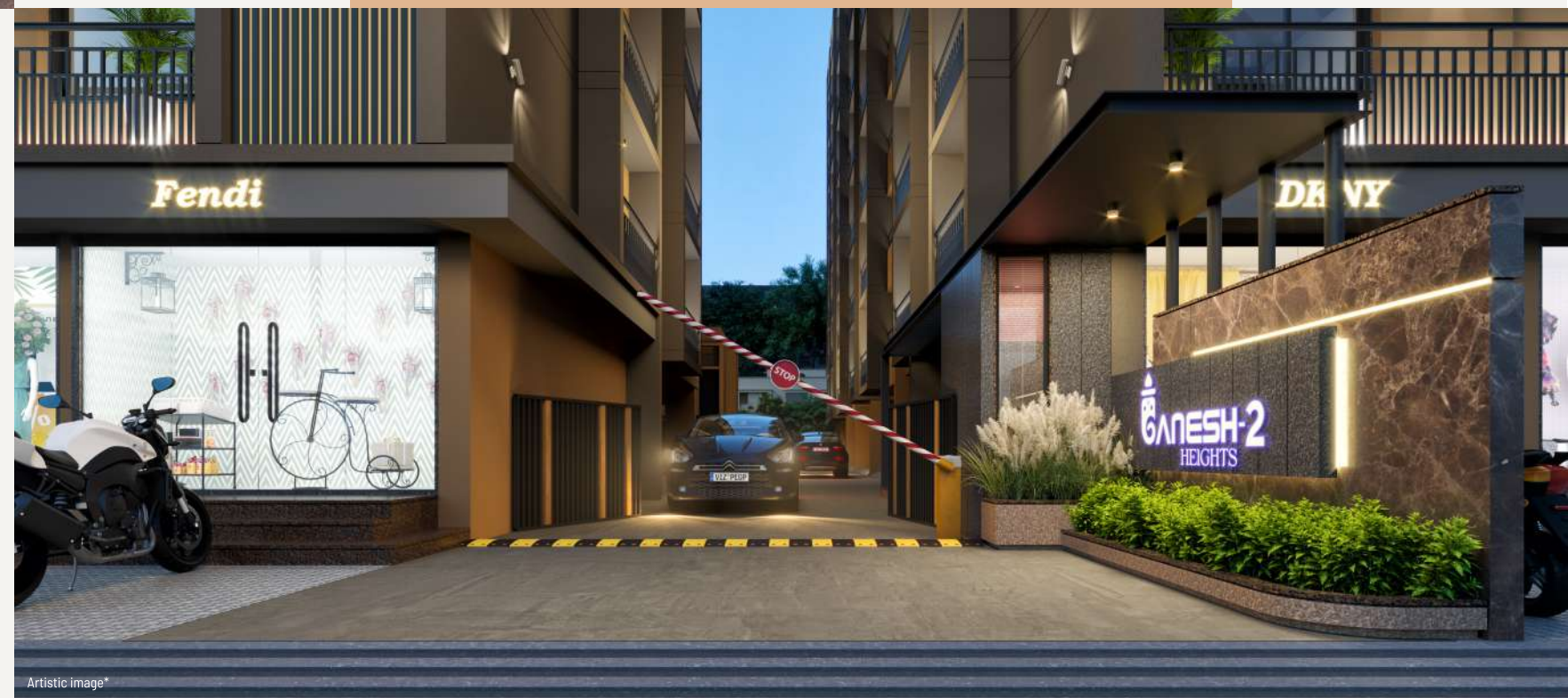

Artistic image\*



Sufficient  
Distance Between  
Buildings



Club House



Tree Plantation  
in Surrounding  
Area



Pickup &  
Drop off Zone



Landscape  
Garden



Basement  
Parking



Leisure  
Sit-out



Water Body



Society  
Street Light



Beautifully  
Entrance Foyer



Solar Power  
Panels For  
Common Area



Artistic image\*

OPEN YOUR CURTAINS TO  
SURREAL BEAUTY..



12.00 MT WIDE ROAD

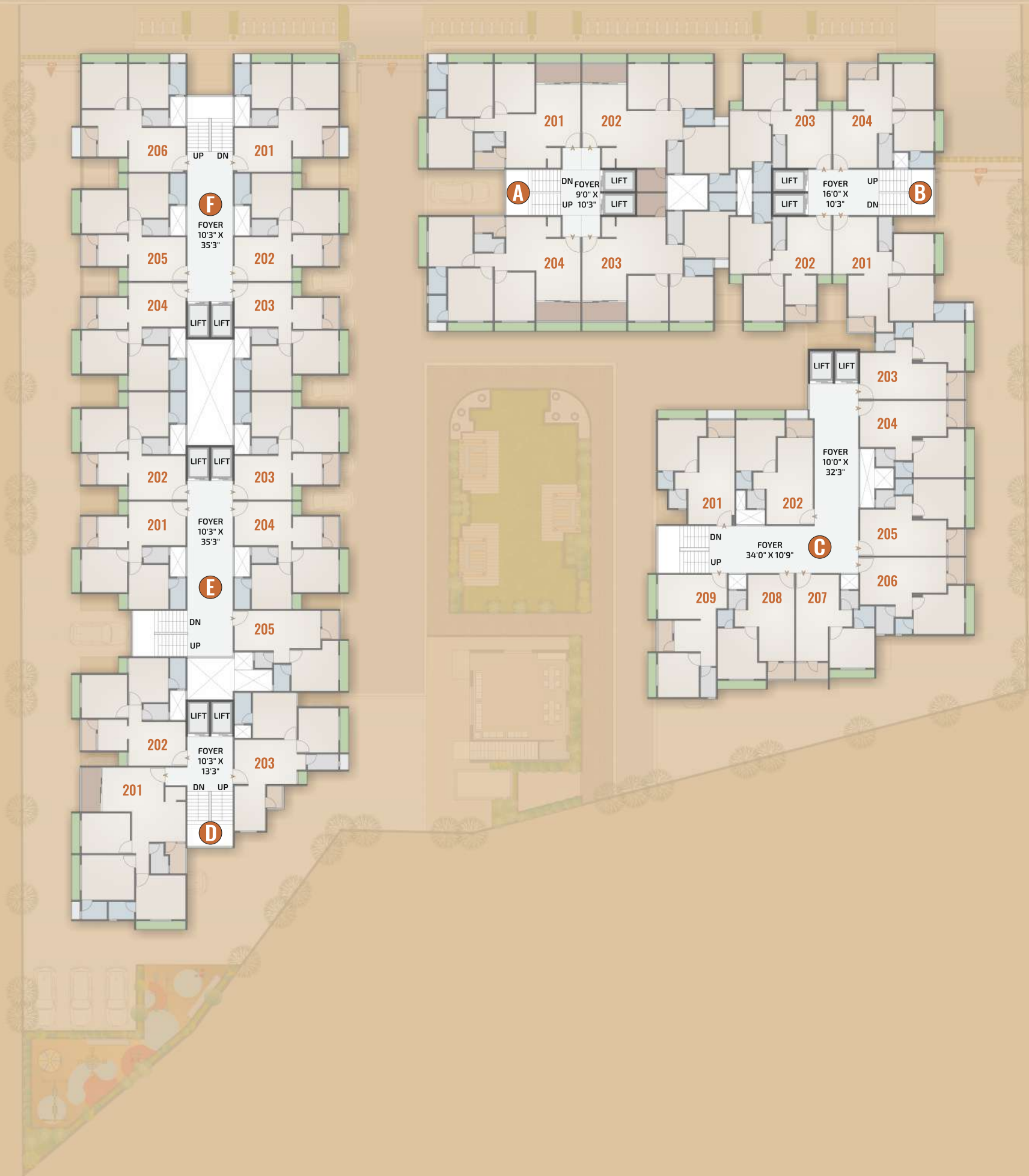

**BLOCK - A**  
TYPICAL PLAN

**BLOCK - B**  
TYPICAL PLAN

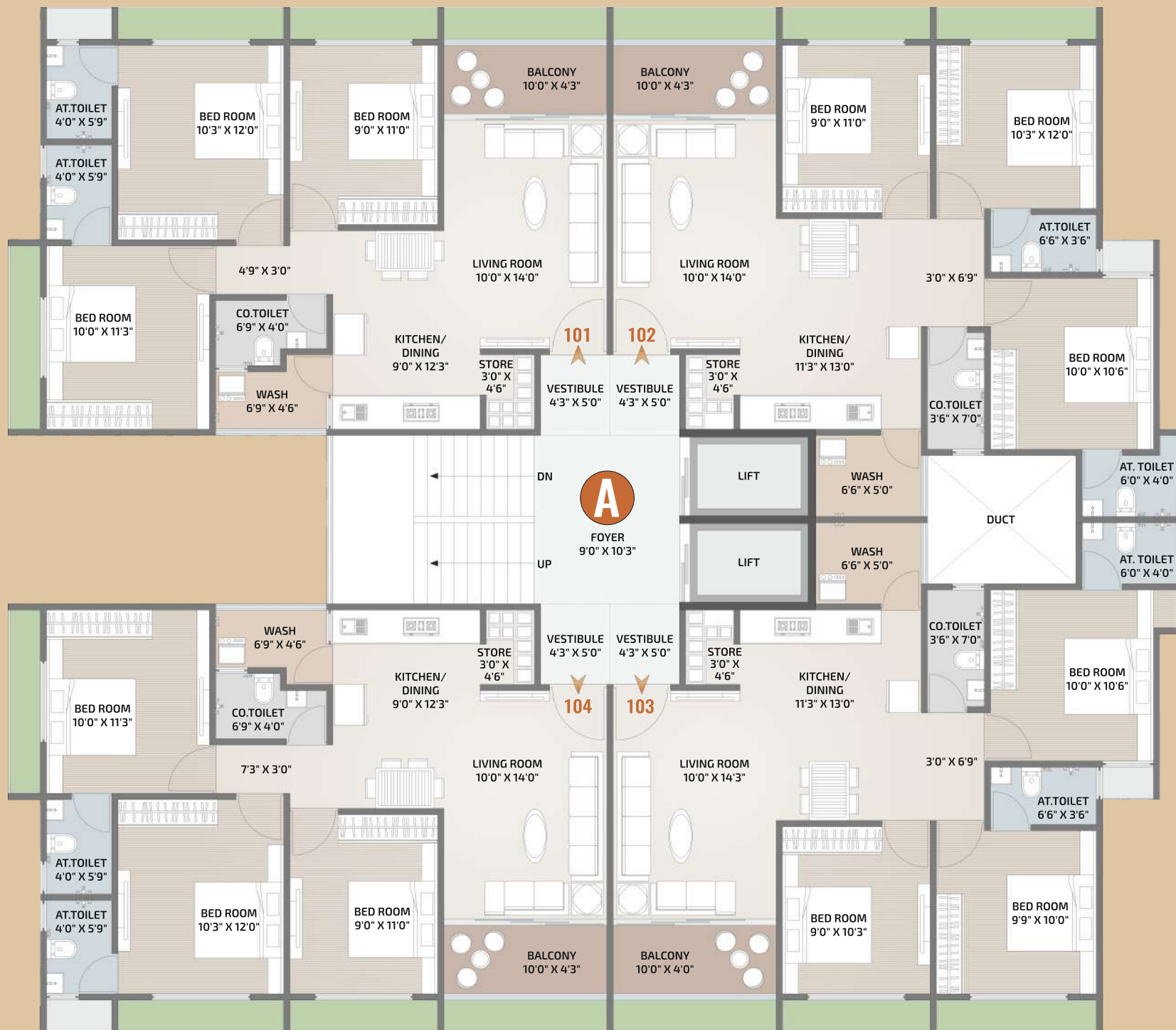

**BLOCK - C**  
TYPICAL PLAN



**BLOCK - D**  
TYPICAL PLAN



**BLOCK - E**  
TYPICAL PLAN

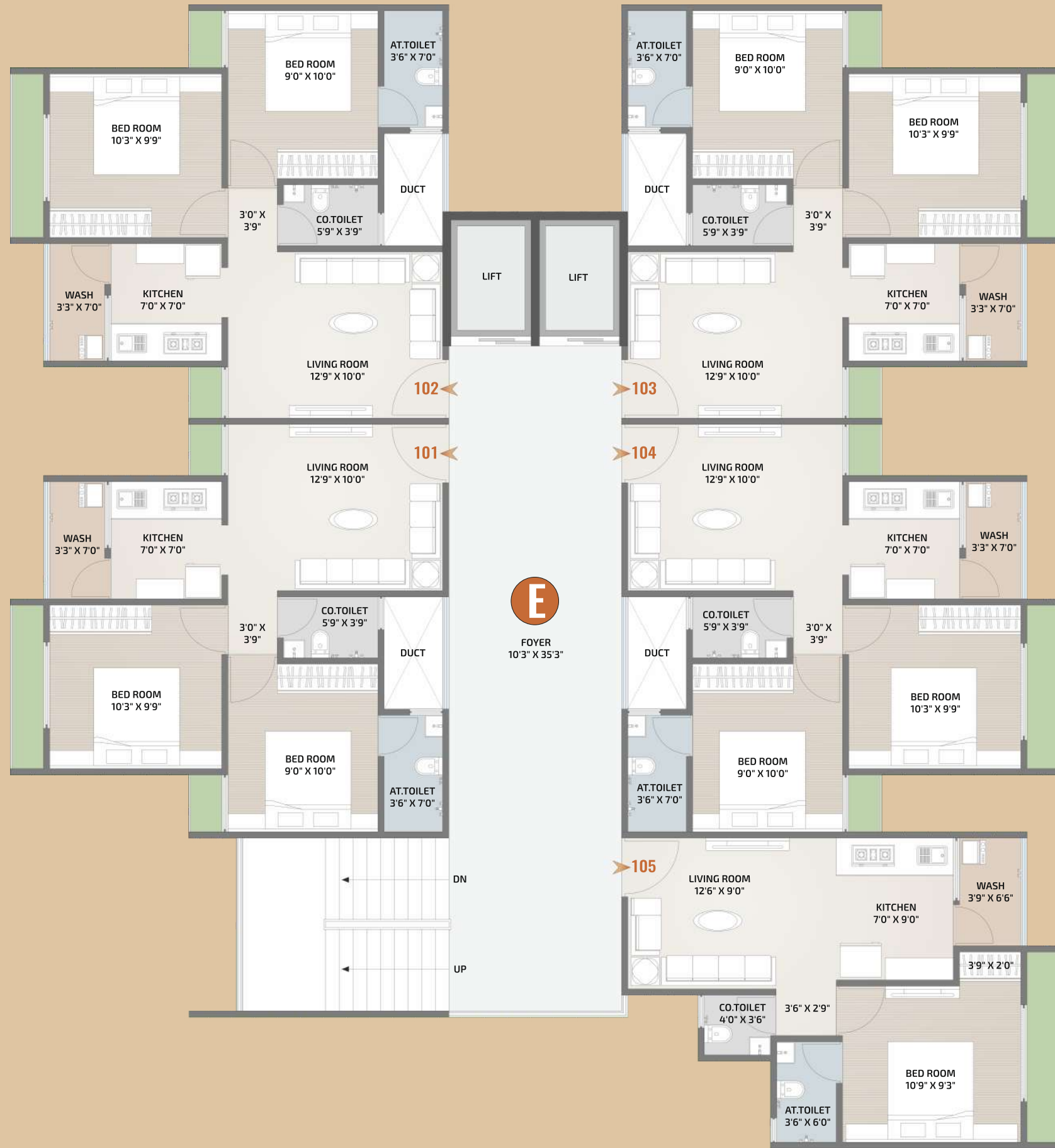

**BLOCK - F**  
TYPICAL PLAN



1 BHK  
UNIT PLAN



2 BHK  
UNIT PLAN



3 BHK  
UNIT PLAN



IMPERIAL HOME THAT DOES  
JUSTICE TO YOUR STATUS



# SPECIFICATIONS FOR FLATS

- FLOORING**  
Vitrified tiles in all areas.  
Ceramic tiles dado in bathroom up to lintel level.
- INTERIOR PLASTER**  
Single coat mala.
- EXTERIOR PLASTER**  
Double coat mala with acyclic paint.
- INSIDE FINISH**  
Mala plaster finish with primer.
- WINDOW**  
Anodized sliding aluminum section window.

- KITCHEN**  
Granite platform with dado of ceramic tiles up to lintel level.  
Stainless steel sink.  
Anti-skid tiles in wash yard.
- PLUMBING**  
Branded company CP fittings.  
Sanitary ware & pipes of branded company.
- OUTSIDE FINISH**  
Acrylic paint.
- DOOR**  
Main door - Decorative main door with wooden frame.  
Internal doors - Flush doors.
- ELECTRIC**  
ISI Makes Modular switches, MCB/ELCB and ISI wires.
- LIFT**  
2 Premium quality automatic lifts in each block.

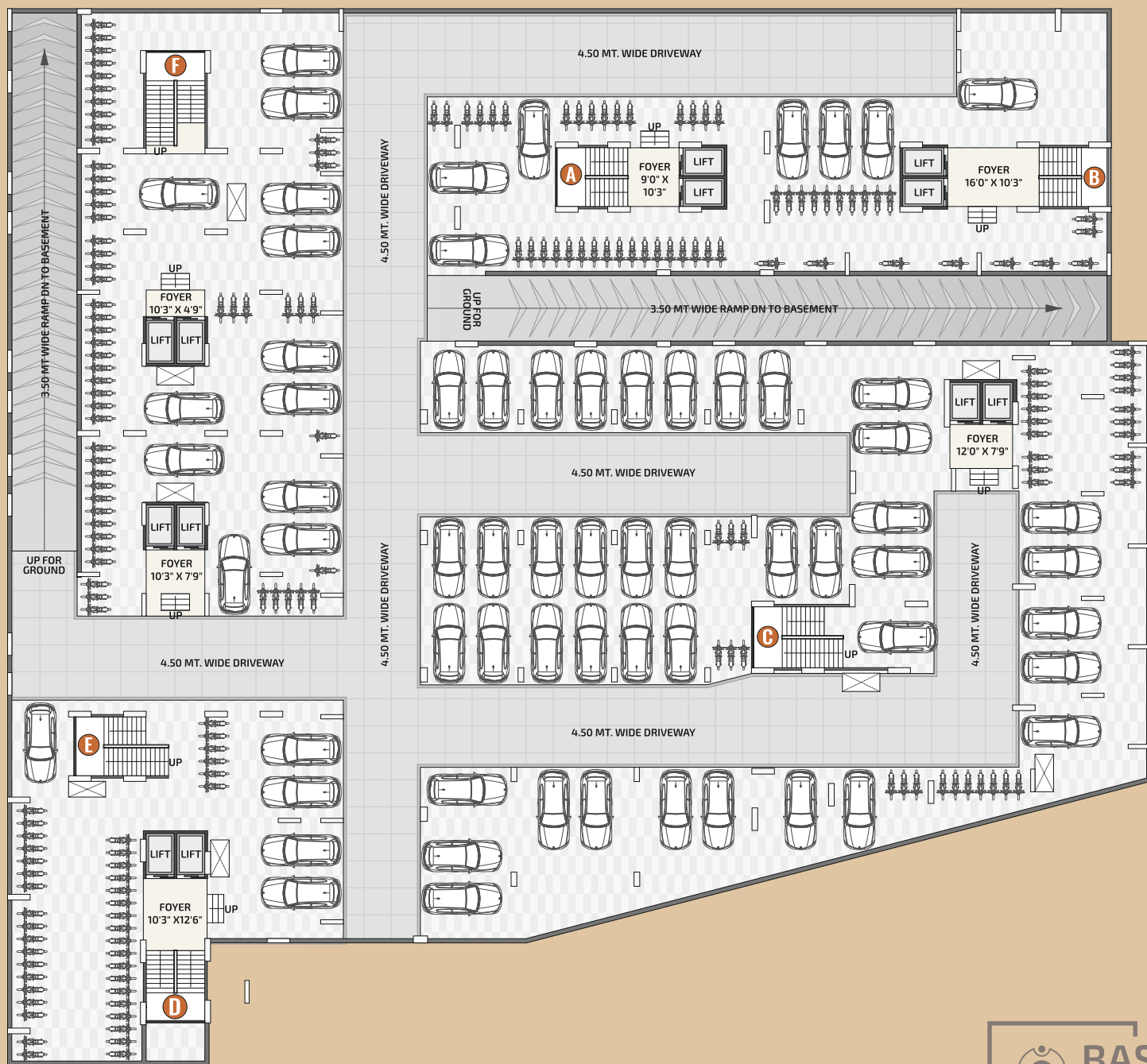

## BASEMENT PLAN



### nearby centers

|                         |                      |                   |                   |                    |                           |
|-------------------------|----------------------|-------------------|-------------------|--------------------|---------------------------|
| S.P. Ring Road<br>5 min | Petrol Pump<br>5 min | School<br>5 min   | Hospital<br>5 min | Temple<br>5 min    | Bus Stop<br>3 min         |
| Party Plot<br>5 min     | Garden<br>4 min      | Collage<br>30 min | Mall<br>5 min     | Multiplex<br>5 min | Railway Station<br>20 min |

### DISCLAIMER

The Brochure is for the easy presentation of the Project. It should not be considered as a part of the legal documents. For further information regarding the project, the Member / customer is requested to check the details on RERA website or at the Developer's office before going ahead with the Booking. - The Furniture and fixtures, electrical appliances and other loose items shown in the brochure are only for illustrative purposes and do not form a part of the standard product on sale. The furniture layout shown in the brochure is only suggestive and subject to change as per site conditions and as per the instructions of the Project Architect. - Developer reserves the Right to make any changes in design, Plans, Specifications, Amenities, Elevation etc. without any prior notice. Such changes would be binding on all the buyers / members. - Colour, design, size, quality, pattern of construction materials may change subject to availability. - The promoter / Developer reserves the Right to make minor on-site changes during the course of construction and such changes shall be binding on all the members / customers of the project. - The dimensions shown in the brochure are approximate and calculated from unfinished surfaces and are rounded off to nearest whole number. The carpet area mentioned is calculated as per the provisions of RERA act with the help of AutoCAD software. - The images (interior and exterior views) in the brochure are computer simulated graphics for representational purpose and are subject to errors and omissions. The images used may be stock images or images based on the architectural plans of the project. They shall not be constructed as actual depictions of the project. - The north direction shown in the brochure is approximate and can be erroneous. The member / customer is expected to verify the same personally before going ahead with the booking. - The key plan in the brochure is not to scale and does not depict the exact location of the project or the connecting road network or other abutting structures or landmarks. It is only for representation purpose and gives a rough idea about the approximate location of the project. The member / customer is requested to visit the project site and check the physical location of the project and its surroundings before going ahead with the booking. - All the Government & Semi Government charges like Stamp duty, Service Tax / GST and any Tax by state or central Government shall be borne by members / customers of the project. - Legal documentation charges, TORRENT, PNG gas connection charges, AUDA / AMC, Narmada water charges, advance maintenance shall be borne by the members / customers of the project separately. - Changes in elevation shall not be allowed to be done by members / customers of the project. - Any additional Liabilities due to change in the by-laws, shall be borne by members / customers of the project. - Subject to Ahmedabad Jurisdiction.

**LOCATION MAP**



Developers  
**Meghaninagar Projects LLP**

**GANESH HEIGHTS-2**  
 Nr. Shreeji Sky Heights, Nr. Shri Hari Heaven, Lambha.  
 For Inquiry : 70431 35149, 79887 59542, 72111 09614

Architect  
**CREATIVE ASSOCIATES**