



**Olympus**

For the select few ...

*A Premium Apartment  
with **25** Selected Flats  
with a Grand Finish.*



# Typical Floor Plan



Typical Floor Plan : Block - A

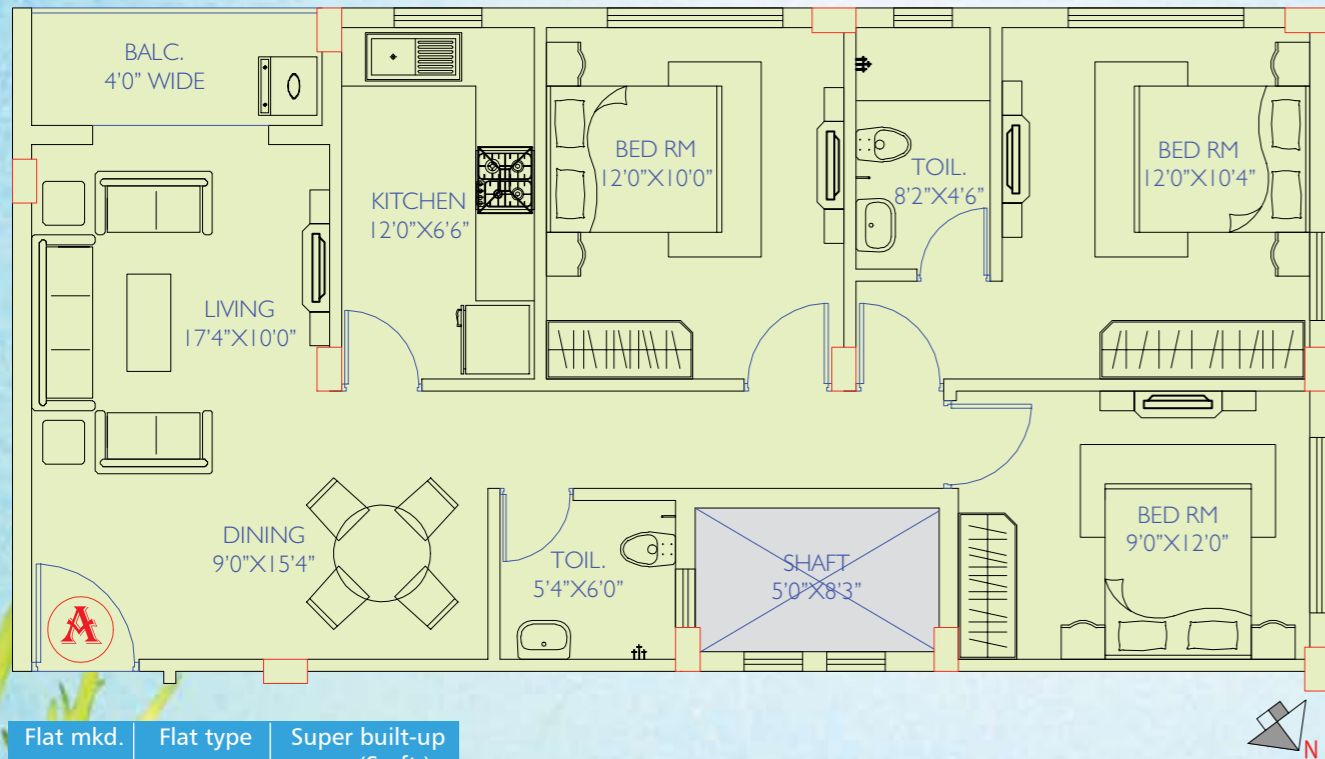

Flat mkd.	Flat type	Super built-up area (Sq.ft.)
A	3 BHK	1265.00

Typical Floor Plan : Block - B

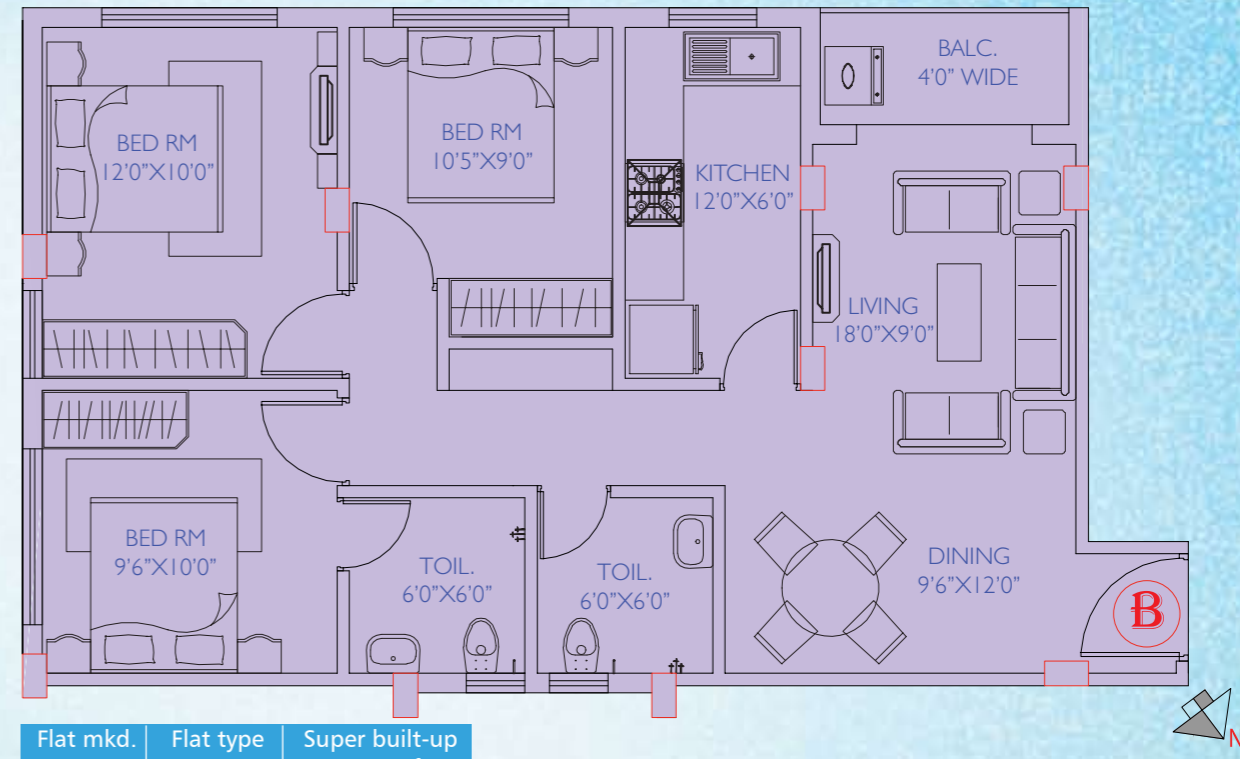

Flat mkd.	Flat type	Super built-up area (Sq.ft.)
B	3 BHK	1114.00

Typical Floor Plan : Block - C

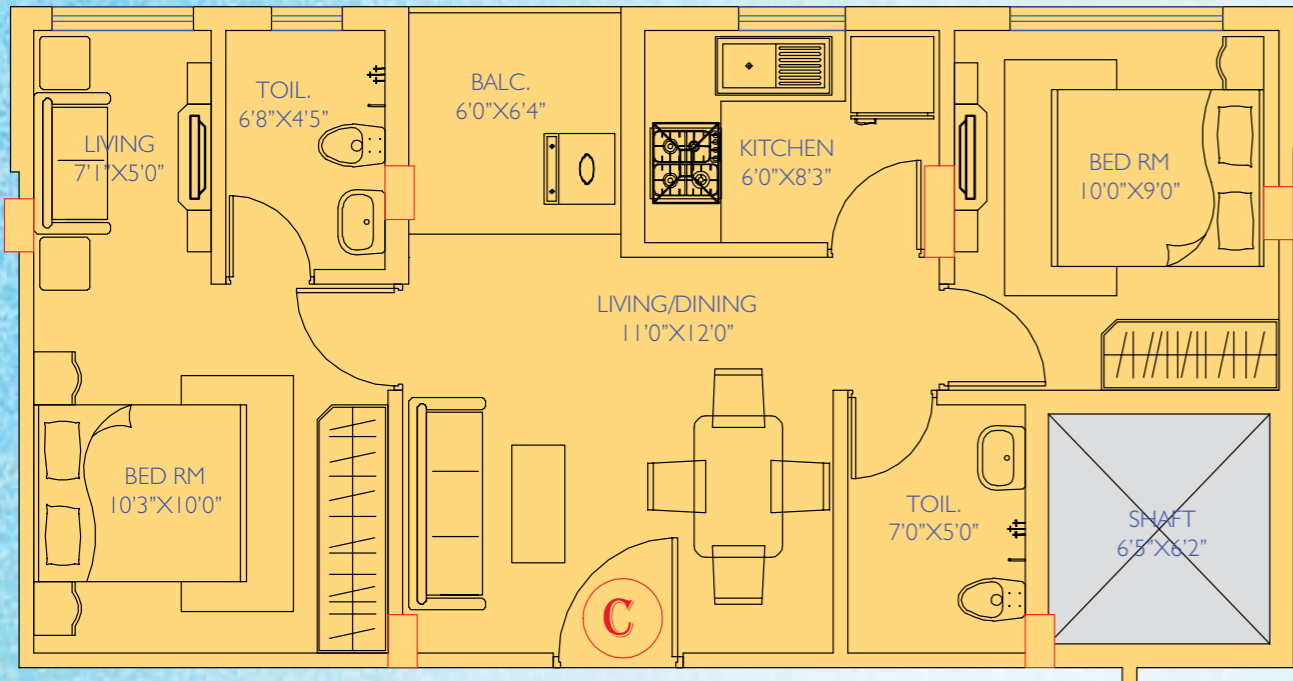

Flat mkd.	Flat type	Super built-up area (Sq.ft.)
C	2 BHK	805.00



Typical Floor Plan : Block - D

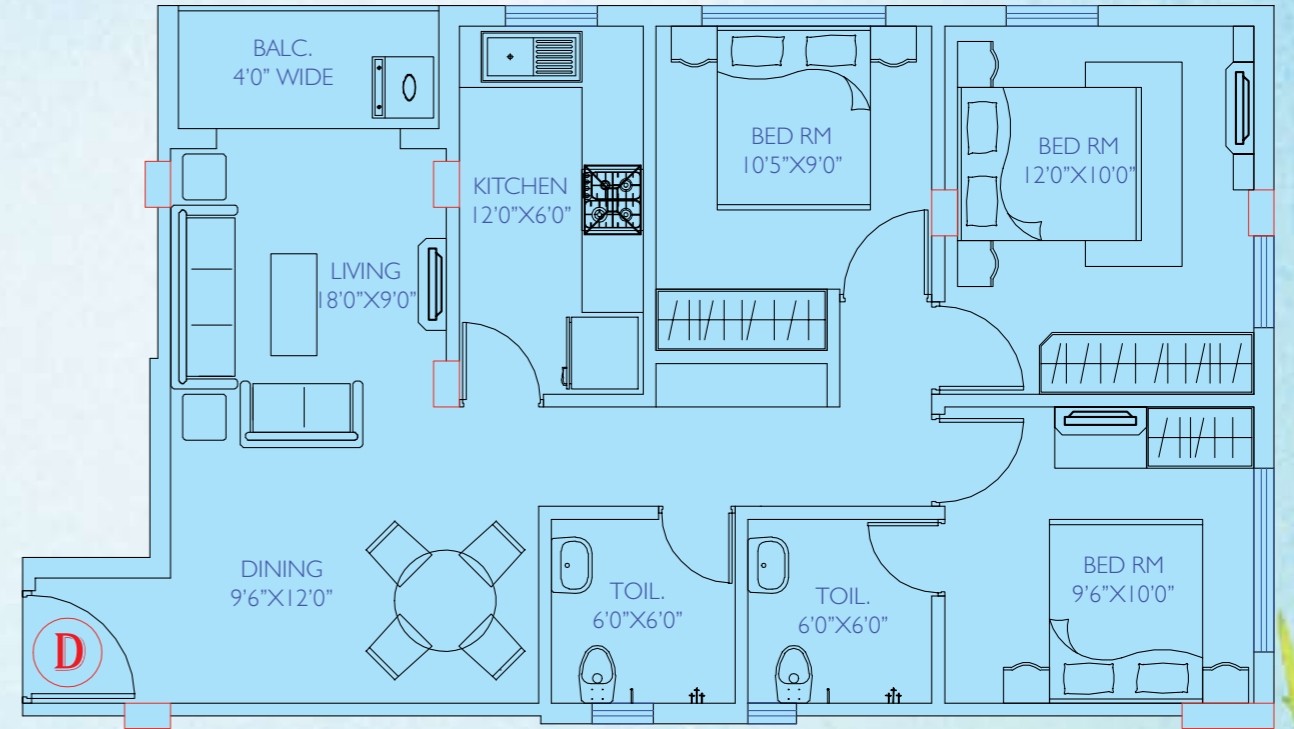

Flat mkd.	Flat type	Super built-up area (Sq.ft.)
D	3 BHK	1127.00



## Typical Floor Plan : Block - E

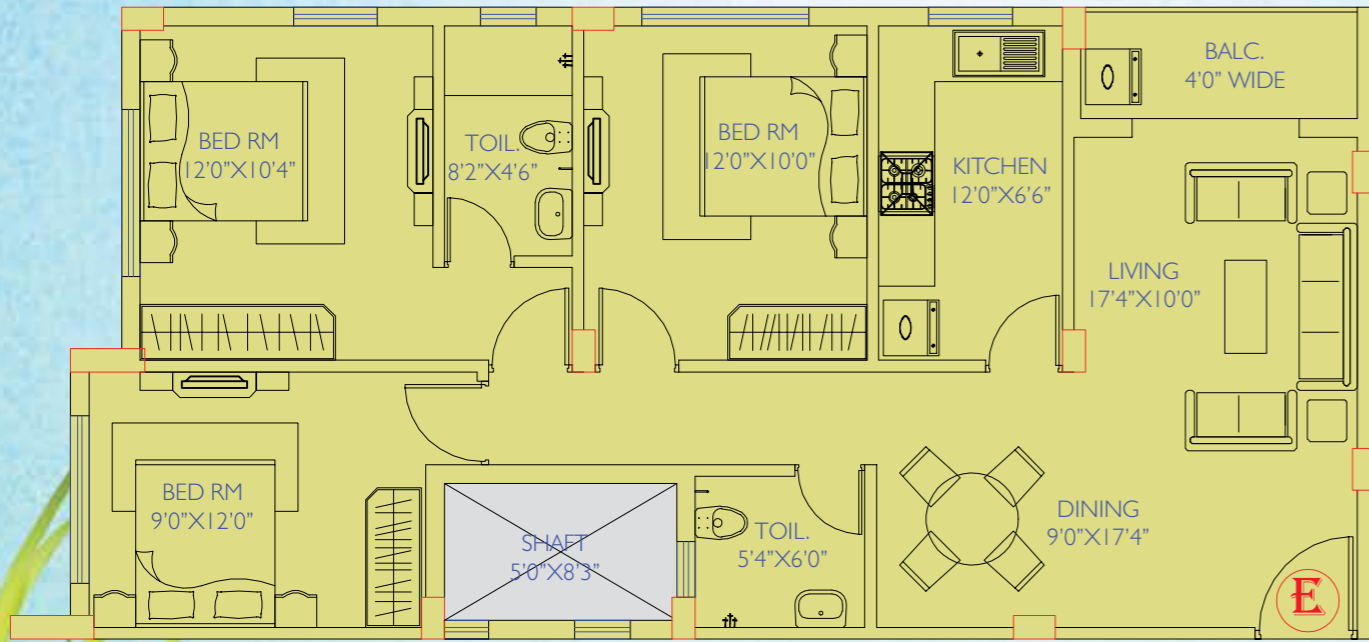

Flat mkd.	Flat type	Super built-up area (Sq.ft.)
E	3 BHK	1289.00



## Location Map

Located in the Heart of all Commercial activities, resulting in a **Lifestyle for Life.**





## Amenities

- Automatic Lift of Repute Brand
- 24 Hours Power Back Up
- Transformer

## Specification

### Foundation

RCC Foundation

### Super Structure

Reinforced Cement Concrete  
Framed Structure

### Walls

Bricks Masonry

### Rooms

**Floor :** Vitrified tiles in living / dinning area and bedrooms  
area and bedrooms

**Wall :** Plaster of Paris finish

### Kitchen

**Floor :** Cramic Tiles

**Counter :** Black granite counter top

**Sink :** Stainless steel sink

**Dado :** Ceramic tiles (2ft above counter)

### Toilets

**Floor :** Ceramic tiles

**Dodo :** Glazed tiles

**W.C. :** European type of Jaguar / Parryware or similar  
reputed brand

**Wash Basin :** Jaguar / Parryware or similar reputed brand

**Fitting :** C.P.

**Door Frame :** Wooden frame

**Shutter :** Flush door (Decorative main door)

**Windows :** Sliding aluminium anodized

### Electrical

#### Concealed Copper Weering

Reputed modular switches (Crabtree or equivalent)

**Power Supply :** Through WBSEB network

**Generator :** Power Back-up 24x7

**Lift :** Reputed brand

**Staircase / Lobby :** Spacious staircase, elegant lobby and  
floor corrdors with good quality marble / kotastone granite

**Water supply :** 24x7 captive water supply

Developer



**MAGNOLIA**

Inrastructure Development Ltd.

**ISO 9001 - 2008 COMPANY**

Creating Value... Building dreams...

93, Dr. Suresh Chandra Banerjee Road, Kolkata-700 010

Email : [contact@magnoliainfrastructure.com](mailto:contact@magnoliainfrastructure.com)

Web : [magnoliainfrastructure.com](http://magnoliainfrastructure.com)

---

Architect

**Raj Agrawal & Associates**

---

For bookings call

**90388 15000**