

VENKATESH   
**SKYDALE**



# LOOK UP TO A SUPERIOR LEGACY

Founded in 2000 by Mr. Ankush Asabe, Shree Venkatesh Buildcon has become a name to reckon within a span of 20 years. At Venkatesh Buildcon, we have been constantly shaping lives by providing them with a humble abode that they would cherish for the following years to come.

After having successfully completed 19 projects in record time, we take pride in helping people realize their aspiration to own their dream home.

Venkatesh Buildcon has established itself as a dependable brand which can be trusted by everyone alike. For every individual, "life" is like an invaluable gift which should be preserved with utmost care and concern.





TALJAI HILLS

Artistic Impression

# LOOK UP TO MAGNIFICENT HOMES

At Venkatesh Skydale, every nook and corner of the homes inspire exuberant living and exude elegance at its finest. Living in such magnificent **2, 3, 4 & 5 BHK homes** is more than just a luxury - it is a privilege. Strategically located at the heart of Pune beside Rajaram Bridge, Sinhagad Road, these homes are thoughtfully designed with world-class amenities for you to indulge into endless moments of joy. Not just that, malls, hospitals, schools & colleges, everything you need, are centrally located within a stone's throw. At Venkatesh Skydale, we have 501 Flats, 20 Shops & 23 Offices, it inspire you to LOOK UP to the rich grandeur, just as we look up to your greatness.





Artistic Impression

# LOOK UP TO AN UPBEAT EXUBERANCE

With such a lively environment and lovely spaces, the sheer abundance at Venkatesh Skydale plays the perfect symphony of serenity and bliss. The cordially crafted state-of-the-art amenities stir your enthusiasm and uplift your exuberance. Spreading joy and sharing smiles would become a daily practice at Venkatesh Skydale.



Embrace the **blissful nature** all around

# LOOK UP TO UNMATCHED CONVENIENCE



The homes at Venkatesh Skydale are designed to offer you the state-of-the-art amenities crafted to delight you. The experience of absolute comfort and unmatched style is what defines the uniqueness of Venkatesh Skydale. Come, be a part of a community that experiences exquisiteness all around.



Experience the absolute advantage of **comfort & convenience**



Artistic Impression

# LOOK UP TO MAGNIFICENT HOMES

While the superior craftsmanship intrigues the artist in everyone, the artfully crafted homes at Venkatesh Skydale inspire you to LOOK UP to an upgraded lifestyle.





Artistic Impression



TOP VIEW

**AMENITIES**

- |  |                                   |  |
|--|-----------------------------------|--|
| 1. Jogging Track / Walkway                         | 11. Provision of Projector        | 21. Natural Play Area                  |
| 2. Yoga & Meditation area with hut                 | 12. Buffet Area                   | 22. Senior Citizen Sit-Outs            |
| 3. Sculpture                                       | 13. Cafeteria / Library           | 23. Acupressure Track                  |
| 4. Floor Exercise Space                            | 14. Seating Area                  | 24. Open Air Gym                       |
| 5. Chit-Chat Corner                                | 15. Amphi-Seating                 | 25. Gazebo                             |
| 6. Children's Play Area(Rubber Flooring)           | 16. Swimming Pool (Infinity Edge) | 26. Bird Watching Area                 |
| 7. Play Area for Day Care Center (Rubber Flooring) | 17. Baby Pool                     | 27. Half Basketball Court with Seating |
| 8. Small Party Lawn                                | 18. Jacuzzi                       | 28. Seating                            |
| 9. Party Lawn                                      | 19. Cabana                        | 29. Stargaze Area / Galaxy Corner      |
| 10. Stage with Background Wall                     | 20. Filtration Room               | 30. Multipurpose Lawn                  |

**KEY FOR OPEN SPACE - 1**

31. Gymnasium (Separate for Ladies & Gents)
32. Spa (Separate for Ladies & Gents)
33. Creche
34. Multi-Media / Security Room
35. Indoor Games
36. Aerobics & Zumba Hall
37. Party Hall
38. Business Lounge / WI-FI Zone Space
39. Play Area
40. Society Office
41. Private Screening Room
42. Drivers room

**KEY FOR OPEN SPACE - 2**

1. Pathway
2. Lawn Area
3. Seating
4. Stepping Stones
5. Tile Area with Pergola above
6. Feature Wall
7. Multipurpose Play Court
8. Cricket Pitch
9. Children's Play Area (Rubber Flooring)

1. Pathway
2. Seating
3. Badminton Court - 1
4. Badminton Court - 2
5. Chess Board
6. Snakes & Ladder
7. Stage
8. Musical Garden



At Venkatesh Skydale, preserving your health and wellness has been our topmost priority. The mindful spaces exude peace of mind like never before and fill you with rejuvenating energy that keeps you charged and pumped up.



Breathe in **positive vibes** day in & day out



At Venkatesh Skydale, spending quality time with yourself and your family is given utmost importance. We have made provisions for amenities including a spa and a mini-theatre to relax, refresh and re-connect with life.



Bond with yourself and your family



Artistic Impression



Artistic Impression



Artistic Impression

At Venkatesh Skydale, elegance and sophistication of the project is what sets a benchmark for others to follow. The project flaunts a suave persona that reflects your accomplishments and makes space for you to do a victory parade in your own style.

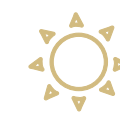

Bask in the **glorious magnificence** of the interiors

## COMMON AMENITIES



Children's Play Area  
(Rubber Flooring)



Gym with Spa  
(Separate for Ladies & Gents)



Crèche with Play Area  
(Rubber Flooring)



Jogging Track



Yoga & Meditation Area



Cafeteria & Library



Party Lawns



Stage with  
Background Wall



Swimming pool & kids pool  
with Infinity edge



Aerobics  
& Zumba Hall



Half Basketball Court  
with Seating



Jacuzzi



Cabana



Natural Play Area



Senior Citizen Sit-Out



Seating Area



Indoor Games



Private Screening Room



Drivers Room



## EXCLUSIVE SPECIFICATIONS



Digital Latching System  
to flat main door



Provision for common  
dish antenna



Video door phone



Chimney, Cooktop &  
Kitchen Trolleys



AC in Master Bedroom



## SPECIFICATIONS

### RCC

- Design as per Earthquake resistance norms
- Internal Autoclaved Aerated Concrete (A.A.C.) Blocks walls - 150 mm
- External R.C.C. Non-Structural walls (Mivan) - 125 mm

### WALL FINISH

- Gypsum to internal wall
- Sand faced plaster / Texture paint to external wall

### DOORS AND WINDOW

- Doors – wooden/plywood door frame with laminated shutter and quality hardware
- Aluminum/ UPVC sliding door for balcony with mosquito net
- Flat - UPVC window with mosquito net
- Toilet door - Granite frame and wooden frame with laminated shutter
- Window granite frame with M.S. safety grills (Inside)

### FLOORING

- Flat - Vitrified tiles 1m X 1m/0.8m X 1.5m for entire flat
- Terrace/Balcony - Ceramic/Vitrified tiles
- Common passage - Vitrified tiles
- Staircase tappa - Tandoor/Kota
- Utility - Ceramic / Vitrified

### KITCHEN

- Granite otta with stainless steel sink
- Kitchen Dado - Upto lintel level
- Provision electrical and plumbing point for washing machine
- Providing chimney, Cooktop & Kitchen Trolleys of good quality make

### TOILET

- Dado - Ceramic/Vitrified tiles up to lintel level
- Geyser in all bathrooms
- Flooring – Anti-skid
- Exhaust fan in all bathroom
- Aluminum/ UPVC window
- Glass partition for master bathroom

### DRY BALCONY

- Granite otta with stainless steel sink
- Ceiling mounted Cloths Drying Pulleys

### ELECTRICAL

- Basic Home Automation
- Modular electrical switches with concealed copper wiring
- TV point in living and master bedroom
- Video door phone and intercom facility
- Provision for common dish antenna for individual building
- Provision for AC point in living and all bedroom
- Provision of broadband connectivity in living & master bedroom
- Provision for inverter point
- Providing AC in Master Bedroom

### PLUMBING AND SANITATION

- Internal concealed CPVC plumbing with Jaquar/Grohe/equivalent make
- Sanitary ware - Jaquar/Cera/Toto/equivalent make

### PAINTING

- Internal walls finishing with acrylic oil bond distemper
- External wall finish - Apex weather-proof emulsion paint
- M.S. grill (Inside) for windows with oil paint

### LIFT

- Automatic lift Kone/Otis/Schindler/Hyundai make with DG backup

### WATER SOURCE

- PMC (Civil Authority), borewell & water tankers (Chargeable)

### FIRE FIGHTING

- Firefighting system with sprinkler and smoke detector in all rooms as approved by Fire Department of PMC

### SECURITY

- Mobile Application based Gate Management System
- Digital Latching System to flat main door



Every space that's crafted **exemplifies excellence**

## LOCATION MAP



### Schools

St. Xavier's School – 0.2 km  
 Silver Crest School – 0.6 km  
 Sinhadgad Spring Dale School – 2.5 km

### Colleges

Cummins College – 1.3 km  
 Sinhadgad College – 2.5 km  
 Navale Medical College – 3.1 km

### Hospitals

Deenanath Mangeshkar Hospital – 2.4 km  
 Navale Hospital – 3.1 km  
 Sahyadri Hospital – 4.1 km

### Gardens

Sarasbaug – 3.9 km  
 P.L. Deshpande Garden – 1.8 km  
 Tathawade Udyan – 1.9 km

### Malls & Multiplexes

Brand Factory / Trends – 1 km  
 Abhiruchi Mall & Multiplex / Big Bazaar – 3 km  
 City Pride Multiplex (Kothrud) – 3km

### Landmarks

Rajaram Bridge – 50 m  
 Mumbai - Bengaluru Highway – 3 km  
 Kothrud – 3.5 km, Deccan – 4.8 km

### Transportation Hubs

Swargate Bus Stand – 6 km  
 Shivajinagar Bus Stand – 7.3 km  
 Pune Railway Station – 8.3 km  
 Pune Airport – 18 km

## Completed Projects



2 & 3 BHK (256 flats & 6 Shops)  
 Dhayari, Pune



2 & 3 BHK (186 flats)  
 Dhayari, Pune



1, 2 & 3 BHK (667 Flats & 6 Shops)  
 Ambegaon Khurd, Pune



1 & 2 BHK (340 Flats & 8 Shops)  
 Loni Kalbhor, Pune



1 & 2 BHK (121 Flats & 6 Shops)  
 Ambegaon Khurd, Pune



1 & 2 BHK (Phase 1-161 Flats & 28 Shops)  
 Ambegaon Khurd, Pune



1, 2 & 3 BHK (968 Flats, 6 Shops & 22 Offices)  
 Keshavnagar, Mundhwa, Pune



2 BHK (191 Flats)  
 Keshavnagar, Mundhwa, Pune



1 & 2 BHK (174 Flats)  
 Ambegaon Khurd, Pune

## Under Construction Projects



2 BHK (237 Flats)  
 Keshavnagar, Mundhwa



2 & 3 BHK (87 Flats)  
 Bhusari Colony, Kothrud, Pune



2 BHK (374 Flats)  
 Keshavnagar, Mundhwa, Pune



2, 3 & 4 BHK Superlative Homes  
 (400 Flats, 16 Showrooms & 62 Offices)  
 Patwardhan Baug, Erandwane, Pune 4



2, 3 BHK & 4 BHK Duplexes  
 (389 Flats, 3 Showrooms & 120 Offices)  
 Pimple Nilakh, Pune



Commercial Project  
 @ Balewadi, Pune

## UPCOMING PROJECTS

Venkatesh **Skylark**  
 Sinhadgad Road, Pune

Venkatesh **Skydove**  
 Sinhadgad Road, Pune

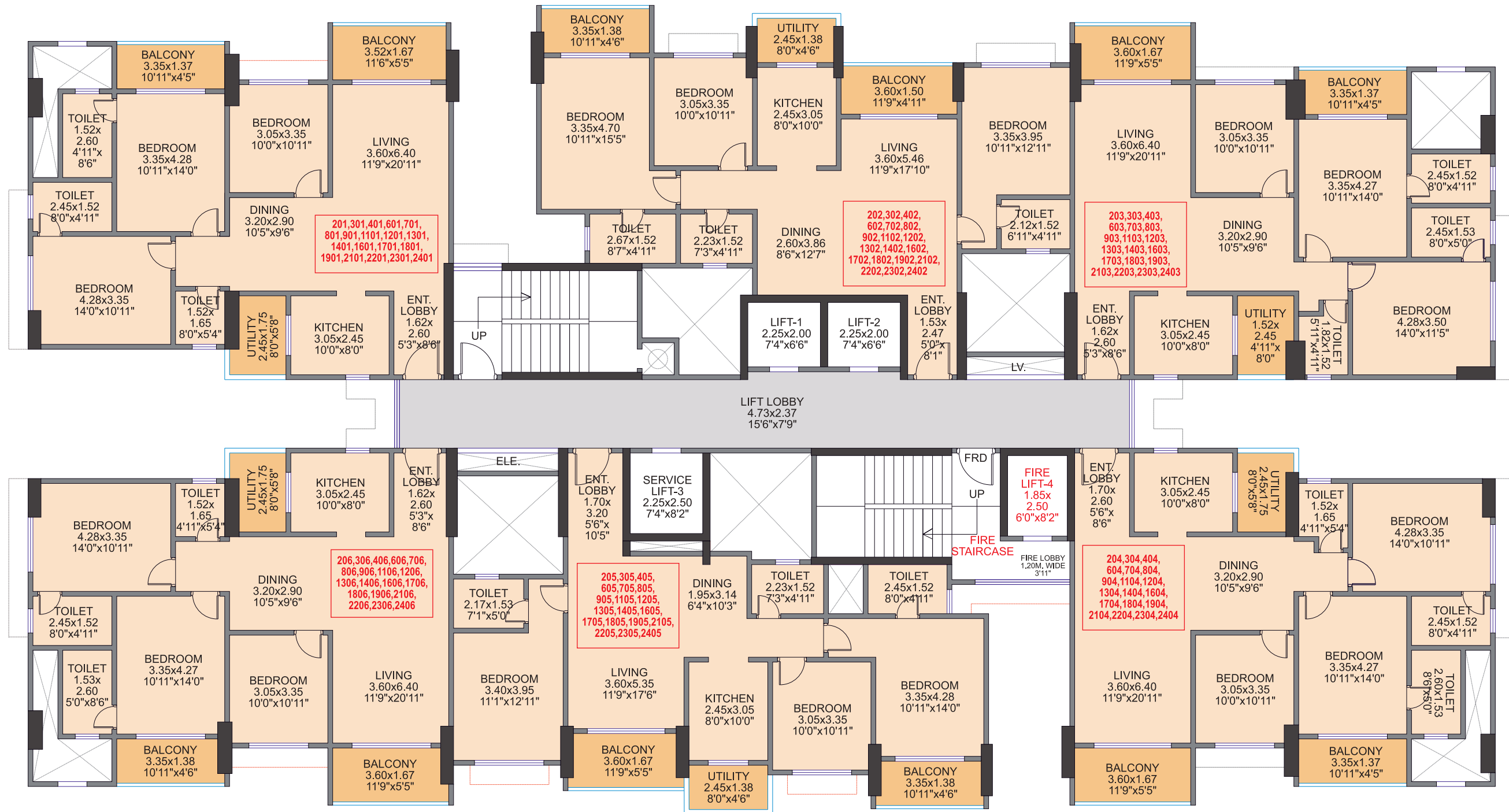

**CARPET AREA STATEMENT**

FLAT TYPE	FLAT NO.	RERA CARPET AREA IN SQ.M.	BALCONY IN SQ.M.	TOTAL IN SQ.M.	TOTAL IN SQ.FT.
3BHK	201,301,401,601,701,801,901,1101,1201,1301,1401,1601,1701,1801,1901,2101,2201,2301,2401	103.10	14.79	117.89	1268.96
3BHK	202,302,402,602,702,802,902,1102,1202,1302,1402,1602,1702,1802,1902,2102,2202,2302,2402	103.25	13.37	116.62	1255.29
3BHK	203,303,403,603,703,803,903,1103,1203,1303,1403,1603,1703,1803,1903,2103,2203,2303,2403	103.84	14.92	118.76	1278.33
3BHK	204,304,404,604,704,804,904,1104,1204,1304,1404,1604,1704,1804,1904,2104,2204,2304,2404	103.06	14.92	117.98	1269.93
3BHK	205,305,405,605,705,805,905,1105,1205,1305,1405,1605,1705,1805,1905,2105,2205,2305,2405	99.65	14.09	113.74	1224.29
3BHK	206,306,406,606,706,806,906,1106,1206,1306,1406,1606,1706,1806,1906,2106,2206,2306,2406	103.06	14.92	117.98	1269.93

**WING-A**

**TYPICAL FLOOR PLAN**  
 (2<sup>nd</sup>, 3<sup>rd</sup>, 4<sup>th</sup>, 6<sup>th</sup>, 7<sup>th</sup>, 8<sup>th</sup>, 9<sup>th</sup>, 11<sup>th</sup>, 12<sup>th</sup>, 13<sup>th</sup>, 14<sup>th</sup>, 16<sup>th</sup>, 17<sup>th</sup>, 18<sup>th</sup>, 19<sup>th</sup>, 21<sup>st</sup>, 22<sup>nd</sup>, 23<sup>rd</sup>, 24<sup>th</sup> Floor)

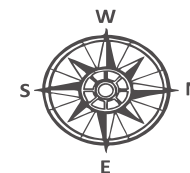

**Note :** All Dimensions are in Meter.



The Project / Phase has been registered vide MahaRERA registration number: P52100025576 (Phase 3)  
 website: <http://maharera.mahaonline.gov.in> under registered projects.



**CARPET AREA STATEMENT**

FLAT TYPE	FLAT NO.	RERA CARPET AREA IN SQ.M.	BALCONY IN SQ.M.	TOTAL IN SQ.M.	TOTAL IN SQ.FT.
3BHK	501,1001,1501,2001	103.10	14.79	117.89	1268.96
3BHK	502,1002,1502,2002	103.25	13.37	116.62	1255.29
3BHK	503,1003,1503,2003	103.84	14.92	118.76	1278.33
2BHK	504,1004,1504,2004	77.42	8.89	86.31	929.04
3BHK	505,1005,1505,2005	99.65	14.09	113.74	1224.29
3BHK	506,1006,1506,2006	103.06	14.92	117.98	1269.93

**Note :** All Dimensions are in Meter.



The Project / Phase has been registered vide MahaRERA registration number: P52100025576 (Phase 3) website: <http://maharera.mahaonline.gov.in> under registered projects.

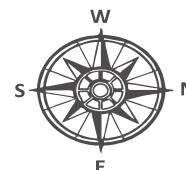

**WING-A**

5<sup>th</sup>, 10<sup>th</sup>, 15<sup>th</sup> & 20<sup>th</sup> FLOOR PLAN



# WING-B



## 1<sup>st</sup>, 3<sup>rd</sup>, 7<sup>th</sup>, 9<sup>th</sup>, 11<sup>th</sup>, 13<sup>th</sup>, 17<sup>th</sup> TYPICAL FLOOR PLAN

CARPET AREA STATEMENT				
FLAT TYPE	FLAT NO.	CARPET AREA SQM.	TERRACE CARPET AREA SQM.	OPEN BALCONY CARPET AREA SQM.
2BHK	101,301,701,901,1101,1301,1701	70.26	0.00	15.45
2BHK	102,302,702,902,1102,1302,1702	70.26	5.34	10.03
3.5BHK	103,303,703,903,1103,1303,1703	106.41	4.52	9.03
2.5BHK	104,304,704,904,1104,1304,1704	86.39	0.00	13.77
2.5BHK	105,305,705,905,1105,1305,1705	79.30	0.00	14.80
2BHK	106,306,706,906,1106,1306,1706	67.41	5.22	10.19

Note : All Dimensions are in Meter.



The Project / Phase has been registered vide MahaRERA registration number : P52100024644 (Phase 2) and is available on the website <http://maharera.mahaonline.gov.in> under registered projects.



# WING-B



## 2<sup>nd</sup>, 6<sup>th</sup>, 8<sup>th</sup>, 12<sup>th</sup>, 16<sup>th</sup> TYPICAL FLOOR PLAN

CARPET AREA STATEMENT				
FLAT TYPE	FLAT NO.	CARPET AREA SQM.	TERRACE CARPET AREA SQM.	OPEN BALCONY CARPET AREA SQM.
2BHK	201,601,801,1201,1601	70.27	5.22	10.18
2BHK	202,602,802,1202,1602	70.25	0.00	15.30
3.5BHK	203,603,803,1203,1603	106.49	4.86	9.03
2.5BHK	204,604,804,1204,1604	86.39	0.00	13.77
2.5BHK	205,605,805,1205,1605	79.30	0.00	14.80
2BHK	206,606,806,1206,1606	66.67	0.00	10.19

Note : All Dimensions are in Meter.



The Project / Phase has been registered vide MahaRERA registration number : P52100024644 (Phase 2) and is available on the website <http://maharera.mahaonline.gov.in> under registered projects.

VENKATESH  
**SKYDALE**

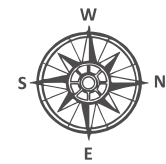

4<sup>th</sup>, 14<sup>th</sup> TYPICAL FLOOR PLAN

CARPET AREA STATEMENT				
FLAT TYPE	FLAT NO.	CARPET AREA SQM.	TERRACE CARPET AREA SQM.	OPEN BALCONY CARPET AREA SQM.
2BHK	401,1401	70.27	5.22	10.18
2BHK	402,1402	70.25	0.00	15.30
3.5BHK	403,1403	106.49	4.86	9.03
2.5BHK	404,1404	86.39	0.00	13.77
2.5BHK	405,1405	79.30	0.00	14.80
2BHK	406,1406	66.67	0.00	10.19

Note : All Dimensions are in Meter.



The Project / Phase has been registered vide MahaRERA registration number : P52100024644 (Phase 2) and is available on the website <http://maharera.mahaonline.gov.in> under registered projects.

# WING-B

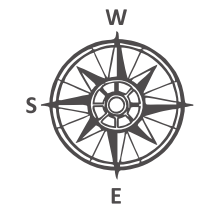

## 5<sup>th</sup>, 15<sup>th</sup> TYPICAL FLOOR PLAN

CARPET AREA STATEMENT				
FLAT TYPE	FLAT NO.	CARPET AREA SQM.	TERRACE CARPET AREA SQM.	OPEN BALCONY CARPET AREA SQM.
1BHK	501,1501	57.73	0.00	15.45
2BHK	502,1502	70.26	5.34	10.03
3.5BHK	503,1503	106.41	4.52	9.03
2.5BHK	504,1504	86.39	0.00	13.77
2.5BHK	505,1505	79.30	0.00	14.80
2BHK	506,1506	67.41	5.22	10.19

Note : All Dimensions are in Meter.



The Project / Phase has been registered vide MaharERA registration number : P52100024644 (Phase 2) and is available on the website <http://maharera.mahaonline.gov.in> under registered projects.



**TYPICAL FLOOR PLAN**  
 (3<sup>rd</sup>,7<sup>th</sup>,9<sup>th</sup>,11<sup>th</sup>,13<sup>th</sup>,17<sup>th</sup>,19<sup>th</sup>,21<sup>st</sup> Floor)

CARPET AREA STATEMENT					
FLAT TYPE	FLAT NO.	RERA CARPET AREA SQ.M.	BALCONY SQ.M.	TERRACE SQ.M.	TOTAL SQ.M.
2BHK	301,701,901,1101,1301,1701,1901,2101	70.69	15.37	0.00	86.06
3BHK	302,702,902,1102,1302,1702,1902,2102	91.36	13.86	0.00	105.22
5BHK	303,703,903,1103,1303,1703,1903,2103	222.92	21.29	0.00	244.21
2BHK	304,704,904,1104,1304,1704,1904,2104	71.46	15.47	0.00	86.93
2BHK	305,705,905,1105,1305,1705,1905,2105	71.18	10.07	6.51	87.76





**TYPICAL FLOOR PLAN**  
(2<sup>nd</sup>, 4<sup>th</sup>, 6<sup>th</sup>, 8<sup>th</sup>, 12<sup>th</sup>, 14<sup>th</sup>, 16<sup>th</sup>, 18<sup>th</sup>, 22<sup>nd</sup> Floor)

CARPET AREA STATEMENT					
FLAT TYPE	FLAT NO.	RERA CARPET AREA SQ.M.	BALCONY SQ.M.	TERRACE SQ.M.	TOTAL SQ.M.
2BHK	201,401,601,801,1201,1401,1601,1801,2201	70.72	10.10	6.51	87.33
3BHK	202,401,602,802,1202,1402,1602,1802,2202	91.81	13.86	0.00	105.67
5BHK	203,403,603,803,1203,1403,1603,1803,2203	222.87	20.66	0.00	243.53
2BHK	204,404,604,804,1204,1404,1604,1804,2204	72.26	15.47	6.51	94.24
2BHK	205,405,605,805,1205,1405,1605,1805,2205	71.13	15.07	0.00	86.20

Note : All Dimensions are in Meter.



The Project / Phase has been registered vide MahaRERA registration number: P52100021836 (Phase 1)  
website: <http://maharera.mahaonline.gov.in> under registered projects.

# WING-C

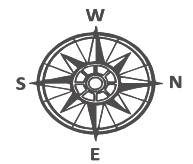

## TYPICAL 5<sup>th</sup>.15<sup>th</sup> FLOOR PLAN

### CARPET AREA STATEMENT

FLAT TYPE	FLAT NO.	RERA CARPET AREA SQ.M.	BALCONY SQ.M.	TERRACE SQ.M.
1BHK	501,1501	61.66	10.10	0.00
3BHK	502,1502	91.81	13.86	0.00
5BHK	503,1503	222.92	21.29	0.00
2BHK	504,1504	71.46	15.47	0.00
2BHK	505,1505	71.18	10.07	6.51

Note : All Dimensions are in Meter.



The Project / Phase has been registered vide MahaRERA registration number: P52100021836 (Phase 1) website: <http://maharera.mahaonline.gov.in> under registered projects.

VENKATESH  
**SKYDALE**

# WING-C



## TYPICAL 10<sup>th</sup>,20<sup>th</sup> FLOOR PLAN

CARPET AREA STATEMENT				
FLAT TYPE	FLAT NO.	RERA CARPET AREA SQ.M.	BALCONY SQ.M.	TERRACE SQ.M.
1BHK	1001,2001	62.45	10.10	6.51
3BHK	1002,2002	91.81	13.87	0.00
5BHK	1003,2003	222.87	20.66	0.00
2BHK	1004,2004	72.26	15.47	6.51
2BHK	1005,2005	71.13	15.07	0.00

Note : All Dimensions are in Meter.

The Project / Phase has been registered vide MahaRERA registration number: P52100021836 (Phase 1)  
 website: <http://maharera.mahaonline.gov.in> under registered projects.

# WING-D

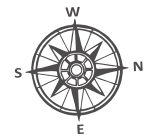

## WING-D

**TYPICAL FLOOR PLAN**  
(2<sup>nd</sup>, 3<sup>rd</sup>, 4<sup>th</sup>, 6<sup>th</sup>, 7<sup>th</sup>, 8<sup>th</sup>, 9<sup>th</sup>, 11<sup>th</sup>, 12<sup>th</sup>, 13<sup>th</sup>, 14<sup>th</sup>, 16<sup>th</sup>, 17<sup>th</sup>, 18<sup>th</sup>, 19<sup>th</sup>, 21<sup>st</sup>, 22<sup>nd</sup> Floor)

CARPET AREA STATEMENT					
FLAT TYPE	FLAT NO.	RERA CARPET AREA IN SQ.M.	BALCONY IN SQ.M.	TOTAL CARPET AREA IN SQ.M.	TOTAL CARPET AREA IN SQ.Ft.
3BHK	201,301,401,601,701,801,901,1101,1201,1301,1401,1601,1701,1801,1901,2101,2201	102.18	15.00	117.18	1261.32
2BHK	202,302,402,602,702,802,902,1102,1202,1302,1402,1602,1702,1802,1902,2102,2202	85.52	13.66	99.18	1067.57
4BHK	203,303,403,603,703,803,903,1103,1203,1303,1403,1603,1703,1803,1903,2103,2203	121.87	14.99	136.86	1473.16
3BHK	204,304,404,604,704,804,904,1104,1204,1304,1404,1604,1704,1804,1904,2104,2204	100.54	14.99	115.53	1243.56
3BHK	205,305,405,605,705,805,905,1105,1205,1305,1405,1605,1705,1805,1905,2105,2205	103.97	14.73	118.70	1277.68
3BHK	206,306,406,606,706,806,906,1106,1206,1306,1406,1606,1706,1806,1906,2106,2206	104.20	14.89	119.09	1281.88

Note : All Dimensions are in Meter.



MahaRERA No.: P52100025615(Phase-4)  
<http://mahareraonline.gov.in>

# WING-D

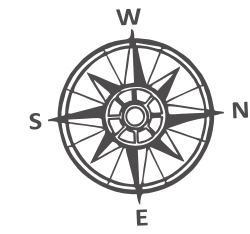

## WING-D

TYPICAL FLOOR PLAN 5<sup>th</sup>, 10<sup>th</sup>, 15<sup>th</sup>, 20<sup>th</sup> Floor)

CARPET AREA STATEMENT					
FLAT TYPE	FLAT NO.	RERA CARPET AREA IN SQ.M.	BALCONY IN SQ.M.	TOTAL CARPET AREA IN SQ.M.	TOTAL CATPET AREA IN SQ.Ft.
3BHK	501, 1001, 1501, 2001	102.18	15.00	117.18	1261.32
2BHK	502, 1002, 1502, 2002	85.52	13.66	99.18	1067.57
4BHK	503, 1003, 1503, 2003	121.87	14.99	136.86	1473.16
3BHK	504, 1004, 1504, 2004	100.54	14.99	115.53	1243.56
2BHK	505, 1005, 1505, 2005	79.31	8.61	87.92	946.37
3BHK	506, 1006, 1506, 2006	104.20	14.89	119.09	1281.88

Note : All Dimensions are in Meter.



MahaRERA No.: P52100025615(Phase-4)  
<http://mahareraonline.gov.in>



## C R E D I T S

Planning Architect  
**Suresh Babu & Partners, Mumbai**

Liasoning Architect  
**Savli Architect, Pune**

Landscape Designers  
**Mr. Mahesh & Mrs. Vaishali Chinchalkar**

RCC Consultant  
**Spectrum Consultant**

Legal Advisor  
**Adv. Unmesh Deshpande**

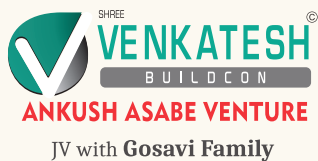

**Corporate Office:** 7<sup>th</sup> Floor, Vikram Monarch, Plot No. 490 A/1,  
Ganeshkhind Road, Shivajinagar Bhamburda, Pune 411016  
**Ph: 020 25662397, 020 25667112**

**Site Address:** Sr. No. 20, Plot No.- "H", Beside Rajaram Bridge,  
Sinhagad Road, Pune 411051 **Ph: 77699 99217, 90494 35858**  
**Email: sales@svbpl.in**

[www.venkateshbuildcon.com](http://www.venkateshbuildcon.com) | [www.svbpl.in](http://www.svbpl.in)



MahaRERA number  
Phase 1- P52100021836  
Phase 2- P52100024644  
Phase 3- P52100025576  
Phase 4- P52100025615  
<https://maharera.mahaonline.gov.in>

**Disclaimer:** This brochure is purely conceptual and not a legal offering nor will be part of the agreement. Images shown are for representation purpose only. Number of floors and number of units may be revised. Developer reserves the rights to amend the layout, plans, elevation, colour schemes, specifications, amenities, etc. without any prior notice.