



Proposed Residential Development at Harshaguda, Hyderabad

CONCEPT | October 28, 2025

Plot no: 15, 8-3-684/3-15,
LIC Colony, Srinagar Colony,
Hyderabad – 500073,

Ph: +91 40 23743324 / 25,
Fax: +91 40 66621253

www.fhdgroup.in

We add value to your vision.

MASTER PLAN

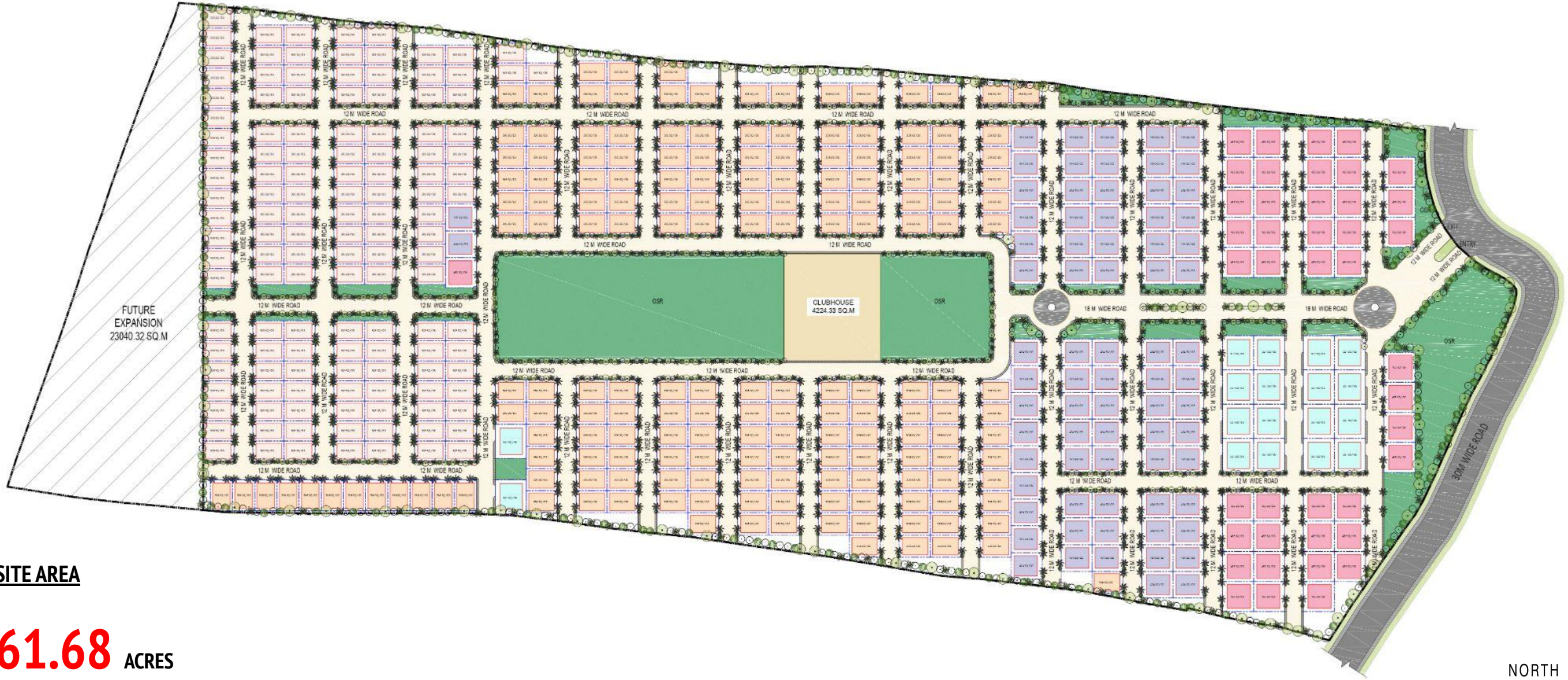

SITE AREA

61.68 ACRES
 2,49,617.88 SQ.M



PROPOSED VILLA DEVELOPMENT @HARSHAGUDA , HYDERABAD				
DESCRIPTION	Sq.Mts	Sq.Fts	Acres	% Dist.
SITE AREA	2,49,617.88	26,86,886.86	61.68	
OSR REQUIRED	24,961.79	2,68,688.69	6.17	10.00%
PLOTTED AREA	1,40,352.81	15,10,757.65	34.68	56.23%
CLUB HOUSE AREA	4,224.33	45,470.69	1.04	1.69%
TOTAL PLOTTED AREA	1,44,577.14	15,56,228.33	35.73	57.92%
ROADS	73,524.64	7,91,419.22	18.17	29.45%
OSR PROPOSED	31,331.53	3,37,252.59	7.74	12.55%
OTHERS/SERVICES	184.57	1,986.71	0.05	0.07%
				100%

Type of Villa	Plot Size	Plot Area		No.s Achieved	% Dist.
		Sq.mts	Sq.yds		
303_EF	65'-0" X 42'-0"	253.34	303	74	29%
303_WF		253.34	303	58	
336_EF	65'-0" X 46'-6"	280.94	336	81	40%
336_WF		280.94	336	88	
336_NF		280.94	336	12	
404_EF	65'-0" X 56'-0"	337.795	404	46	17%
404_WF		337.795	404	29	
455_EF	65'-0" X 63'-0"	380.438	455	18	10%
455_WF		380.438	455	25	
517_EF	65'-0" X 71'-8"	432.89	518	8	4%
517_WF		432.89	518	10	
TOTAL				449	100%

VILLA PLANS

303 SQYDS PLOT - 19.812 M X 12.80 M



NORTH



FHD
INDIA

303 SQYDS - EAST FACING

GROUND FLOOR PLAN

PLOT AREA: 253.59 SQ.M. | 303.29 SQ.YDS. |
2,729.65 SQ.FT.

TOTAL BUILT-UP AREA:
351.33 SQ.M - 3,781.74 SQ.FT



Proposed Residential Development at Harshaguda, Hyderabad



NORTH



FIRST FLOOR PLAN

PLOT AREA: 253.59 SQ.M. | 303.29 SQ.YDS. |
2,729.65 SQ.FT.

TOTAL BUILT-UP AREA:
351.33 SQ.M - 3,781.74 SQ.FT



NORTH



FHD
INDIA

303 SQYDS - EAST FACING

SECOND FLOOR PLAN - OP 1

PLOT AREA: 253.59 SQ.M. | 303.29 SQ.YDS. |
2,729.65 SQ.FT.

TOTAL BUILT-UP AREA:
351.33 SQ.M - 3,781.74 SQ.FT



Proposed Residential Development at Harshaguda, Hyderabad



NORTH



FHD
INDIA

303 SQYDS - EAST FACING

SECOND FLOOR PLAN - OP 2

PLOT AREA: 253.59 SQ.M. | 303.29 SQ.YDS. | 2,729.65 SQ.FT.

TOTAL BUILT-UP AREA:
351.33 SQ.M - 3,781.74 SQ.FT



Proposed Residential Development at Harshaguda, Hyderabad



NORTH



FHD
INDIA

303 SQYDS - WEST FACING

GROUND FLOOR PLAN

PLOT AREA: 253.59 SQ.M. | 303.29 SQ.YDS. |
2,729.65 SQ.FT.

TOTAL BUILT-UP AREA:
371.87 SQ.M - 4,002.821 SQ.FT



Proposed Residential Development at Harshaguda, Hyderabad



FIRST FLOOR PLAN

PLOT AREA: 253.59 SQ.M. | 303.29 SQ.YDS. |
2,729.65 SQ.FT.

TOTAL BUILT-UP AREA:
371.87 SQ.M - 4,002.821 SQ.FT

NORTH





SECOND FLOOR PLAN

PLOT AREA: 253.59 SQ.M. | 303.29 SQ.YDS. |
2,729.65 SQ.FT.

TOTAL BUILT-UP AREA:
371.87 SQ.M - 4,002.821 SQ.FT

NORTH



FHD
INDIA

303 SQYDS - WEST FACING



Proposed Residential Development at Harshaguda, Hyderabad

VILLA PLANS

336 SQYDS PLOT - 19.812 M X 14.17 M



NORTH



FHD
INDIA

336 SQYDS - EAST FACING

GROUND FLOOR PLAN

PLOT AREA: 280.73 SQ.M. | 335.75 SQ.YDS. |
3,021.81 SQ.FT.

TOTAL BUILT-UP AREA:
390.95 SQ.M - 4,208.20 SQ.FT



Proposed Residential Development at Harshaguda, Hyderabad



FIRST FLOOR PLAN

PLOT AREA: 280.73 SQ.M. | 335.75 SQ.YDS. | 3,021.81 SQ.FT.

TOTAL BUILT-UP AREA:
390.95 SQ.M - 4,208.20 SQ.FT

NORTH





SECOND FLOOR PLAN

PLOT AREA: 280.73 SQ.M. | 335.75 SQ.YDS. | 3,021.81 SQ.FT.

TOTAL BUILT-UP AREA:
390.95 SQ.M - 4,208.20 SQ.FT

NORTH





GROUND FLOOR PLAN

PLOT AREA: 280.73 SQ.M. | 335.75 SQ.YDS. |
3,021.81 SQ.FT.

TOTAL BUILT-UP AREA:
413.99 SQ.M - 4,456.20 SQ.FT

NORTH





FIRST FLOOR PLAN

PLOT AREA: 280.73 SQ.M. | 335.75 SQ.YDS. |
3,021.81 SQ.FT.

TOTAL BUILT-UP AREA:
413.99 SQ.M - 4,456.20 SQ.FT

NORTH





NORTH



FHD
INDIA

336 SQYDS - WEST FACING

SECOND FLOOR PLAN

PLOT AREA: 280.73 SQ.M. | 335.75 SQ.YDS. |
3,021.81 SQ.FT.

TOTAL BUILT-UP AREA:
413.99 SQ.M - 4,456.20 SQ.FT



Proposed Residential Development at Harshaguda, Hyderabad



Proposed Residential Development at Harshaguda, Hyderabad

CONCEPT | October 28, 2025