



sarvome
delivering value

SHREE
HOMES



PREMIUM LOCATION - AFFORDABLE LIVING

SECTOR-45, FARIDABAD

LARGEST 2 BHK APARTMENTS
in Haryana Affordable Housing Policy 2013



Artistic Impression

LICENCE NO. 105 OF 2019 DATED 10.09.2019

UNIT - 2 BHK (TYPE-A)

CARPET AREA
645.80 SQ.FT.
+
BALCONY AREA
120.00 SQ.FT.



UNIT - 2 BHK (TYPE-B)

CARPET AREA
645.80 SQ.FT.
+
BALCONY AREA
120.00 SQ.FT.

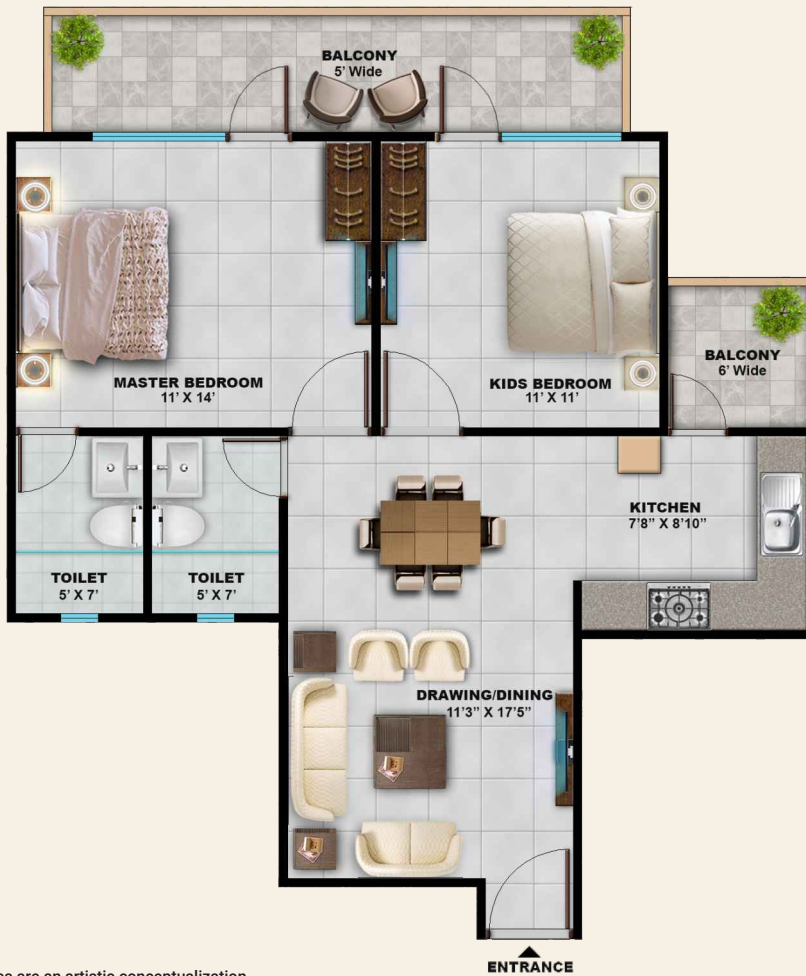

SITE PLAN



Disclaimer:
This is an Artistic View only and not legally binding.

FEATURES

- ◆ Premium Location in Sector-45, Faridabad
- ◆ Walking Distance from Delhi-Mathura Road & Mewla Maharajpur Metro Station
- ◆ 4 Flats to a core with 2 Lifts
- ◆ Affordable Project with IGBC - Platinum Rating
- ◆ 100% Apartments with East-West Entry
- ◆ 10 mins drive from Sarita Vihar

BENEFITS

- ◆ 5 Years Free Maintenance*
- ◆ Prices fixed by Govt. of Haryana*
- ◆ Upto 90% bank finance
- ◆ Subsidy of upto ₹ 2.67 Lacs under PMAY
- ◆ Easy payment plan spread over 3 years*
- ◆ No PLC

PAYMENT PLAN

TIME OF PAYMENT	INSTALLMENTS
At the time of submission of the Application	5% of the Total Cost
Within 15 days of issuance of Allotment Letter	20% of the Total Cost
Within 6, 12, 18, 24, 30 & 36 months from the date of issuance of Allotment letter	6 equal installments 12.5% each of the Total Cost

All payments to be made through Cheque/Demand Draft/Pay Order drawn in favour of 'M/S JSTL A/C SHREE HOMES', payable at Faridabad.

*Price- As per Govt. Notification- PF-27-III/2021/28851 Dated- 16.11.2021 | Cost of Carpet Area- Rs 4200 per Sq. ft. | Cost of Balcony Area- Rs 1000 per Sq. ft.

* The above mentioned price list, payment plan and terms & conditions will be applicable as per 'Affordable Group Housing Policy dated 19.08.2013' notified by Haryana Government and any other subsequent notifications as applicable.

LOCATION MAP

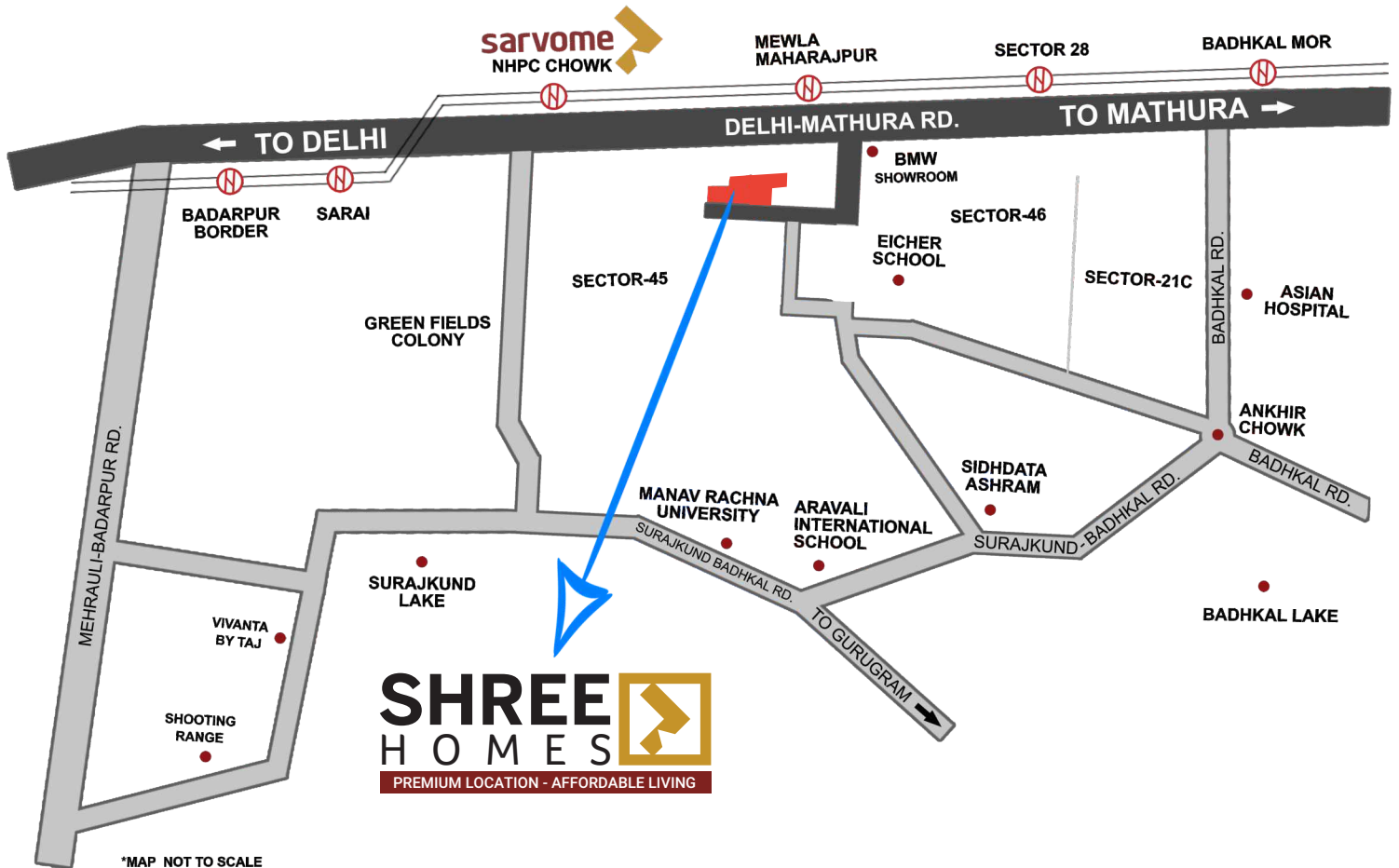

sarvome
delivering value



Corporate & Registered Office: Sarvome House, Sector 45, Faridabad-121003, Haryana, India

SHREE HOMES

PREMIUM LOCATION - AFFORDABLE LIVING

SECTOR-45, FARIDABAD

3 BHK APARTMENTS
(HARYANA AFFORDABLE HOUSING POLICY 2013)



HRERA-PKL-112-2019
DATED: 11/04/2019

3 BHK@
₹26.31*

LACS ONLY

*Incl. EDC/IDC



UNIT TYPE - 3 BHK

TOTAL COST
₹ 26,31,600* + GST

BOOKING AMOUNT
₹ 1,32,896

*(Incl EDC/IDC)

CARPET AREA

645.40 SQ.FT.

+

BALCONY AREA

100.00 SQ.FT.

=

TOTAL AREA

745.40 SQ.FT.



All images are an artistic conceptualization.

FEATURES

- ◆ Premium Location in Sector-45, Faridabad
- ◆ Walking Distance from Delhi-Mathura Road & Mewla Maharajpur Metro Station
- ◆ 4 Flats to a core with 2 Lifts
- ◆ 1st Affordable Project with IGBC - Platinum Rating
- ◆ 100% Apartments with East-West Entry

BENEFITS

- ◆ 5 Years Free Maintenance*
- ◆ Prices fixed by Govt. of Haryana*
- ◆ Upto 90% bank finance
- ◆ Subsidy of upto ₹ 2.67 Lacs under PMAY
- ◆ Easy payment plan spread over 3 years*
- ◆ No PLC

PAYMENT PLAN

TIME OF PAYMENT	INSTALLMENTS
At the time of submission of the Application	5% of the Total Cost
Within 15 days of issuance of Allotment Letter	20% of the Total Cost
Within 6, 12, 18, 24, 30 & 36 months from the date of issuance of Allotment letter	6 equal installments 12.5% each of the Total Cost

All payments to be made through Cheque/Demand Draft/Pay Order/NEFT/RTGS drawn in favour of 'M/S JSTL A/C SHREE HOMES', payable at Faridabad.

SITE PLAN



Disclaimer: This is an Artistic View only and not legally binding.

LOCATION MAP



*MAP NOT TO SCALE

Disclaimer: The proposed affordable group housing scheme in Sector-45, Faridabad is duly approved/licensed by the Office of Director General, Town & Country Planning Dept., Haryana vide License no. 52 of 2019 dated 07.03.2019 (Area measuring 6.081 Acres) developing 876 dwelling units. This project is being developed under Haryana Affordable Group Housing Policy dated 19.08.2013 and modifications and amendments thereto. All the approvals can be checked in the office of the developers. The developer reserves the right to get the approved building plans revised at any stage till completion of the buildings as per prevailing government norms.

SPECIFICATIONS

FLOORING	
Living/Dining	Vitrified Tiles/IPS
Bedroom	Vitrified Tiles/IPS
Balcony	Ceramic Tiles/IPS
Toilets	Ceramic Tiles/IPS
Kitchen	Vitrified Tiles/IPS
WALL FINISH	
Living/Dining	OBD
Bedroom	OBD
Toilets	OBD
External	Standard Exterior Emulsion
KITCHEN	
Platform	Stone
Wall Finish	Tiles upto 2 Feet from the Counter
Others	Stainless Steel Sink (Single Bowl)
DOORS & WINDOWS	
Door/Window Outer	Hardwood/MS Z-Section/Fiber/uPVC/Powder Coated Aluminium
Door Frame	Hardwood / M.S. / Fiber Door Frames
Doors	Moulded Skin Doors / Fiber Door / Flush Doors with enamel paint.
TOILETS	
Walls	Ceramic Tiles
CP Fittings	Standard Fittings
Chinaware	Standard Fittings
ELECTRICAL	
Fittings	ISI Marked Wires, Switches and MCBs
MISCELLANEOUS	
Structure	Earthquake Resistant Structure



sarvome
delivering value



Corporate & Registered Office: Sarvome House, Sector 45, Faridabad-121003, Haryana, India

