



DAC  
MILLENNIUM  
PORUR 2.8

# From MD's Desk

## The DAC Way

### **Driven by Purpose. Defined by Precision.**

At DAC Developers, we don't just build structures — we craft homes where families create memories, dreams take shape, and happiness finds a home. Backed by over a decade of trust, every DAC project is a balance of functionality and emotion, comfort and aesthetics.

Each home is the result of a clear process, built around three core principles — each one carefully thought through, long before the first brick is laid.

### **Right Location**

It starts with asking: would we want to live here?

Before a single blueprint is drawn, we walk the land. We study the surroundings, the community, the future potential. Is it connected, yet calm? Are schools, hospitals, workplaces, and essentials within reach? Does it feel like home — not just today, but ten years from now?

At DAC, choosing a location is never about what's trending. It's about what sustains — peace of mind, daily ease, and long-term value. That's the lens we use. And we don't compromise on it.

### **Right Design**

Every line on the layout answers a real-life need.

We imagine how a family might move through the space — where light should pour in, where kids might play, how a kitchen becomes the heart of a home. Design isn't just about aesthetics for us.

It's about solving quietly — for comfort, for efficiency, for joy. Storage where you need it. Balconies that breathe. Plans that evolve with time.

We design like we're going to live there ourselves — because homes should grow with you, not limit you.

### **Right Process**

What you don't see is what makes all the difference.

Long before the first stone is laid, we've done the groundwork — approvals, soil studies, partner vetting, and plan reviews.

Every step is thought through, refined, and backed by systems.

Our time lines aren't just optimistic targets — they're structured commitments.

We obsess over the behind-the-scenes — quality checks, material sourcing, vendor coordination — because that's what ensures peace of mind at handover.

This is what we mean by building with integrity: not just what's visible, but everything that holds it up.

We take pride in how we build — not just the homes themselves, but the entire journey. From design to delivery, customization to celebration, our process is built to make every step seamless and personal.

Because at DAC, we believe:

**“When you build a happy home, you make the world a little happier.”**

**Welcome to a world where homes are made with heart.**

**Welcome to DAC.**



**Mr. S. SATHISH KUMAR**  
Managing Director



\*The artistic representation provided is for illustrative purpose, and variations in the actual elevation of the resident project may occur due to architectural adjustments and construction considerations.

## A FIRST HOME THAT FEELS LIKE THE FIRST CHAPTER OF FOREVER

0.97 Acres | S+5 Structure | 138 Apartments |  
2, 2.5 & 3 BHK | 642 Sq.Ft. - 1047 Sq.Ft.

Millennium by DAC is a thoughtfully planned residential community, located just 2.8 km from Porur junction - a well - connected, peaceful pocket that offers both calm and convenience.

Just across from one of Chennai's most reputed schools and surrounded by vibrant development, Millennium is more than a cluster of homes. It's where childhood memories take root, careers take off, and families come into their own.

This is where space, smart design, and a better way of living come together to create something extraordinary.

# CLOSE TO WHAT MATTERS. CONNECTED TO WHAT GROWS.

Millennium puts you in a location that's not only peaceful - but powerful.

You're close to Chennai's major IT corridors, education hubs, healthcare, and shopping - yet tucked into a serene residential pocket that offers quiet, everyday ease.

Whether it's your child's school run, a quick grocery trip, or your daily office commute - everything feels closer from here.

## LOCATION ADVANTAGES

### SCHOOLS

- ❖ PSBB Millennium School - 120 m
- ❖ Narayana E-Techno School - 1.8 kms
- ❖ St Francis International School - 2.1 kms
- ❖ ORCHIDS The International School - 2.5 kms
- ❖ Anand Singapore International School - 2.7 kms
- ❖ Velammal Bodhi Campus Kolapakkam - 2.8 kms

### COLLEGES

- ❖ St. Joseph's College (Arts & Science) - 3.3 kms
- ❖ Madha Medical College - 4.3 kms
- ❖ Sri Ramachandra University - 4.6 kms
- ❖ Muthukumaran Medical College - 5.0 kms
- ❖ Saveetha Dental College - 9.6 kms

### HOSPITALS

- ❖ Bestow Hospital - 950 m
- ❖ SN Hospital - 3.2 kms
- ❖ Kedar Hospital - 4.5 kms
- ❖ Sri Ramachandra Hospital - 4.6 kms
- ❖ MIOT Hospital - 6.4 kms
- ❖ Apollo Speciality Hospitals, Vanagaram - 8.6 kms

### WORK HUBS

- ❖ RMZ One Paramount - 5.0 kms
- ❖ L&T Campus - 5.9 kms
- ❖ Cognizant Technology Solutions - 7.0 kms
- ❖ DLF Cyber City - 7.0 kms
- ❖ Olympia Technology Park - 8.7 kms
- ❖ Guindy Industrial Estate SIDCO - 9.8 Kms

### ATTRACTIONS

- ❖ D - Mart - 6.2 kms
- ❖ Nandambakkam Trade Centre - 7.2 kms
- ❖ Kathipara Urban Square - 8.6 kms
- ❖ Aerohub - 8.9 kms
- ❖ Nexus Forum Vijaya Mall - 9.4 kms
- ❖ Kundrathur Murugan Temple - 9.8 kms

### TRANSPORT

- ❖ Moorthy Nagar Bus Stop - 500 m
- ❖ Gerugambakkam Bus Stop - 850 m
- ❖ Moulivakkam Bus Stop - 1.2 Kms
- ❖ Porur Junction - 2.8 Kms
- ❖ Chennai International Airport - 7.9 Kms
- ❖ Vadapalani Metro - 9.7 Kms

# Location Map

(Not to Scale)





## A MORNING ROUTINE THAT STARTS WITH PEACE OF MIND



Imagine sending your child to school - with no traffic, no honking, and no anxiety. Just a walk across the road. Millennium offers you the rare privilege of being close to one of the city's most respected educational institutions - giving your children a head start in life, and giving you peace of mind every single morning.

More time for breakfast | Less time in transit | Every day, a little easier.



## FROM STARTING OUT TO SETTLING DOWN - EVERYTHING FITS

There's a quiet confidence that comes with having your own space - a space where every decision feels more meaningful, and every day feels more yours.

At Millennium, life is made to flow around you - unhurried mornings, shared routines, spontaneous laughter, and moments that gently become memories. It's where relationships deepen, new chapters unfold, and your family finds a rhythm that finally feels natural.

Whether you're planning for what's next or settling into what's now, this is a place that supports your pace - and grows with your joys, your challenges, and your every milestone.



## **A STRIKING FACADE THAT DEFINES MODERN LIVING**

Millennium by DAC blends contemporary elegance with timeless appeal. Thoughtfully crafted with clean lines, warm hues, and strategic lighting, it creates an inviting presence that stands out day and night. Every balcony, texture, and design element has been meticulously detailed to ensure not just aesthetic appeal, but also a sense of harmony with the surroundings. This is more than just an address - it's an architectural statement designed to inspire pride for years to come.



The artistic representation provided is for illustrative purpose, and variations in the actual elevation of the resident project may occur due to architectural adjustments and construction considerations.

# EVERY ROOM, DESIGNED FOR YOUR COMFORT



**LIVING & DINING**

A seamless blend of living and dining - crafted to bring families together in style and comfort.



**KITCHEN**

A well-planned kitchen that blends functionality and smart storage, proving great design doesn't have to cost more



**MASTER BEDROOM**

The main bedroom offers the perfect blend of functionality and warmth - designed to make you feel at home



**KIDS BEDROOM**

A cheerful space where little dreams grow - designed for comfort, creativity, and joyful moments



**BALCONY**

Your own private nook to relax, recharge, and reconnect—with nature or yourself

\*The artistic representation provided is for illustrative purpose, and variations in the actual elevation of the resident project may occur due to architectural adjustments and construction considerations.



## A PERFECT PLACE FOR YOUR FAMILY TO BLOOM

Where comfort, joy, and togetherness  
thrive every day.

Step into a home that nurtures love and laughter. Designed with thoughtful spaces and enriched with lifestyle amenities, this is more than just an apartment - it's a space where your family blossoms. From serene green zones to active play areas, every detail is crafted to support a vibrant, fulfilling life.

“Here, happiness lives in every corner”



KIDS PLAY AREA



FULLY EQUIPPED GYM

## LIFESTYLE THAT DELIGHTS, EVERY SINGLE DAY

INDOOR GAMES ROOM



ASSOCIATION ROOM





MULTIPURPOSE HALL



ROOFTOP PERGOLA SEATING /  
TERRACE PARTY AREA / BARBEQUE COUNTER

## AMENITIES DESIGNED FOR JOY, COMFORT & CONNECTION



ZUMBA / AEROBICS ROOM



SENIOR CITIZEN ZONE / REFLEXOLOGY PATHWAY

# DESIGNED TO GIVE YOU MORE, WITHOUT ASKING FOR MORE.

## MORE CARPET AREA



150mm AAC block external walls = thinner walls = more usable space inside your home.

## LOWER ELECTRICITY BILLS



Excellent thermal insulation keeps interiors cooler, reducing AC usage and power costs.

## PEACE & QUIET



Superior sound insulation for a calmer, more private living experience.

## FASTER HANDOVER



AAC blocks allow quicker construction, so you can move in sooner and start living sooner.

## DURABLE & SAFE



Fire-resistant, termite-proof, and moisture-protected - built to last.

## ECO-FRIENDLY



Sustainable, low-carbon materials = lower environmental impact and cleaner living.

At DAC, we believe intelligent design is the highest form of luxury. That's why every home at Millennium is built with a singular purpose - to give you more where it matters most.

❖ At Millennium, every inch is designed to work smarter - so you can live better.

❖ It's not just smart engineering. ❖ It's better living by design ❖ More comfort. More space. More value per square foot.

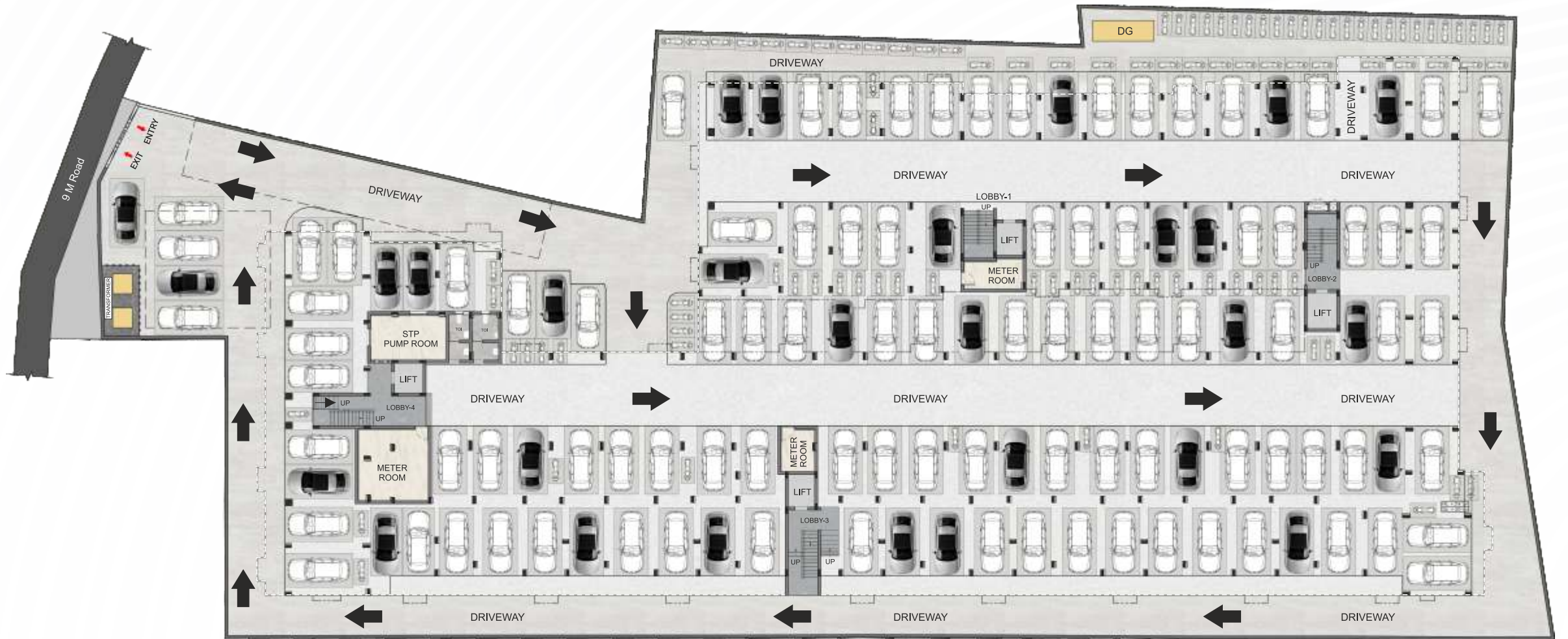
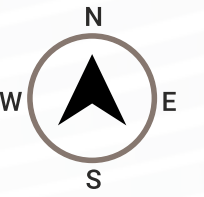

STILT FLOOR & CAR PARKING

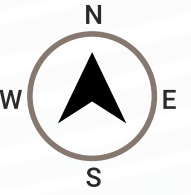

**1, 2, 3 & 4 TYPICAL FLOOR PLAN**

| UNIT NO             | TYPE      | SIZE       | FACING |
|---------------------|-----------|------------|--------|
| 101, 201, 301 & 401 | 2BHK + 2T | 807 SQ.FT. | SOUTH  |
| 102, 202, 302 & 402 | 2BHK + 2T | 806 SQ.FT. | SOUTH  |
| 103, 203, 303 & 403 | 2BHK + 2T | 642 SQ.FT. | SOUTH  |

| UNIT NO             | TYPE      | SIZE       | FACING |
|---------------------|-----------|------------|--------|
| 129, 229, 329 & 429 | 2BHK + 2T | 860 SQ.FT. | NORTH  |
| 130, 230, 330 & 430 | 2BHK + 2T | 807 SQ.FT. | NORTH  |

**KEY PLAN**

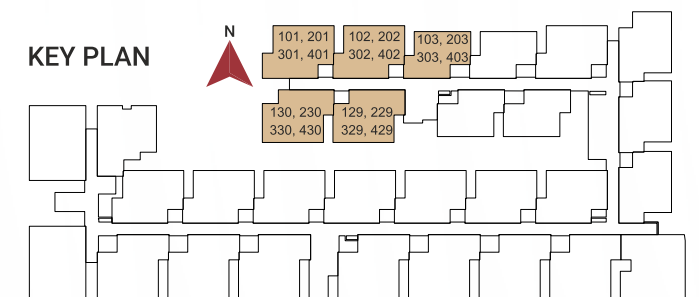

\*Furniture shown in the plan are only for indicative purpose \*Room sizes may vary according to the unit size  
 \*Balconies & Private terraces may have visible plumbing lines, which are securely positioned as part of the design and cannot be relocated.

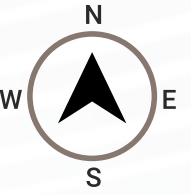

**1, 2, 3 & 4 TYPICAL FLOOR PLAN**

| UNIT NO             | TYPE      | SIZE       | FACING |
|---------------------|-----------|------------|--------|
| 104, 204, 304 & 404 | 2BHK + 2T | 642 SQ.FT. | SOUTH  |
| 105, 205, 305 & 405 | 2BHK + 2T | 807 SQ.FT. | SOUTH  |
| 106, 206, 306 & 406 | 2BHK + 2T | 798 SQ.FT. | WEST   |

| UNIT NO           | TYPE      | SIZE       | FACING |
|-------------------|-----------|------------|--------|
| 107,207,307 & 407 | 2BHK + 2T | 806 SQ.FT. | WEST   |
| 127,227,327 & 427 | 2BHK + 2T | 642 SQ.FT. | NORTH  |
| 128,228,328 & 428 | 2BHK + 2T | 642 SQ.FT. | NORTH  |

**KEY PLAN**

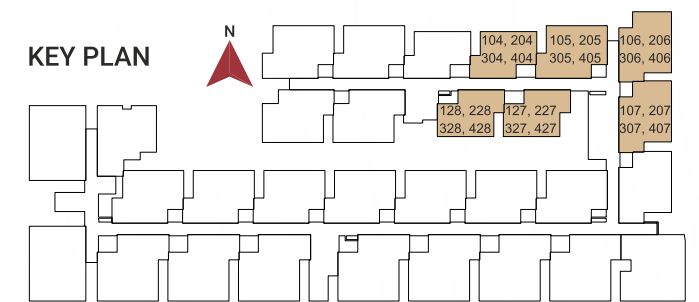

\*Furniture shown in the plan are only for indicative purpose \*Room sizes may vary according to the unit size  
 \*Balconies & Private terraces may have visible plumbing lines, which are securely positioned as part of the design and cannot be relocated.

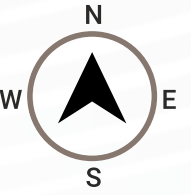

**1, 2, 3 & 4 TYPICAL FLOOR PLAN**

| UNIT NO             | TYPE        | SIZE        | FACING |
|---------------------|-------------|-------------|--------|
| 108, 208, 308 & 408 | 2BHK + 2T   | 807 SQ.FT.  | WEST   |
| 109, 209, 309 & 409 | 2.5BHK + 2T | 1033 SQ.FT. | NORTH  |
| 110, 210, 310 & 410 | 2.5BHK + 2T | 981 SQ.FT.  | NORTH  |

| UNIT NO             | TYPE        | SIZE       | FACING |
|---------------------|-------------|------------|--------|
| 111, 211, 311 & 411 | 2.5BHK + 2T | 984 SQ.FT. | NORTH  |
| 125, 225, 325 & 425 | 2BHK + 2T   | 806 SQ.FT. | SOUTH  |
| 126, 226, 326 & 426 | 2BHK + 2T   | 807 SQ.FT. | SOUTH  |

**109, 209, 309 & 409**

**KEY PLAN**

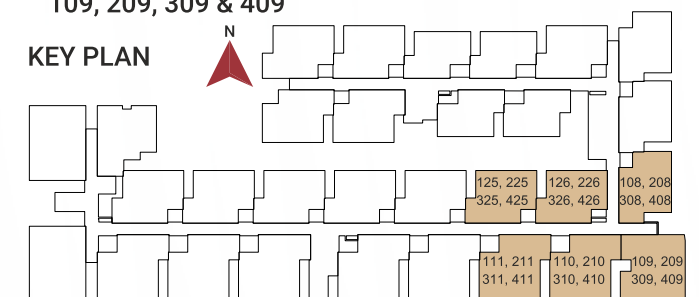

\*Furniture shown in the plan are only for indicative purpose \*Room sizes may vary according to the unit size  
 \*Balconies & Private terraces may have visible plumbing lines, which are securely positioned as part of the design and cannot be relocated.

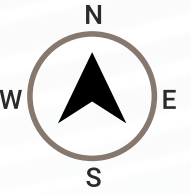

122, 222, 322 & 422

123, 223, 323 & 423

124, 224, 324 & 424



5'0" WIDE CORRIDOR

5'0" WIDE CORRIDOR

114, 214, 314 & 414

113, 213, 313 & 413

112, 212, 312 & 412



5'0" WIDE CORRIDOR

1,2,3 & 4 TYPICAL FLOOR PLAN

| UNIT NO             | TYPE        | SIZE       | FACING |
|---------------------|-------------|------------|--------|
| 112, 212, 312 & 412 | 2.5BHK + 2T | 984 SQ.FT. | NORTH  |
| 113, 213, 313 & 413 | 2.5BHK + 2T | 984 SQ.FT. | NORTH  |
| 114, 214, 314 & 414 | 2.5BHK + 2T | 987 SQ.FT. | NORTH  |

| UNIT NO             | TYPE      | SIZE       | FACING |
|---------------------|-----------|------------|--------|
| 122, 222, 322 & 422 | 2BHK + 2T | 806 SQ.FT. | SOUTH  |
| 123, 223, 323 & 423 | 2BHK + 2T | 806 SQ.FT. | SOUTH  |
| 124, 224, 324 & 424 | 2BHK + 2T | 806 SQ.FT. | SOUTH  |

KEY PLAN

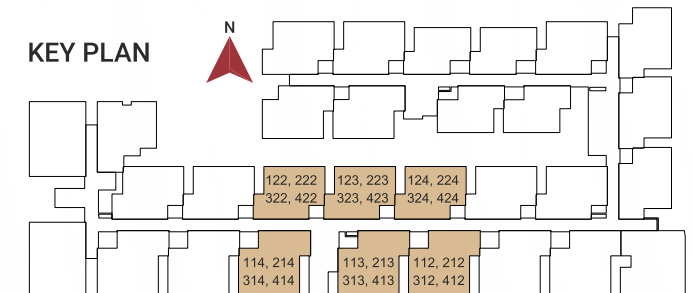

\*Furniture shown in the plan are only for indicative purpose \*Room sizes may vary according to the unit size  
 \*Balconies & Private terraces may have visible plumbing lines, which are securely positioned as part of the design and cannot be relocated.

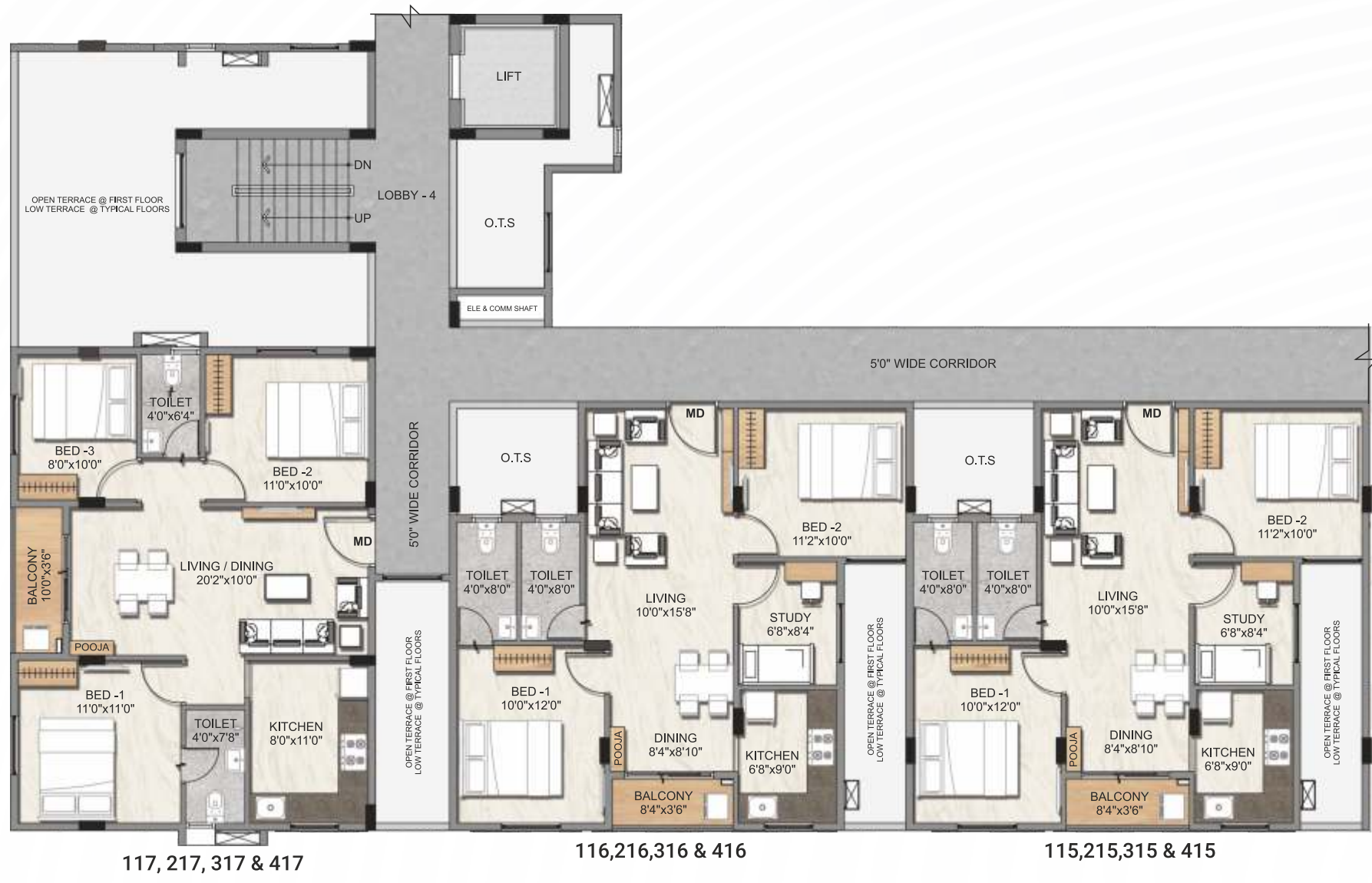
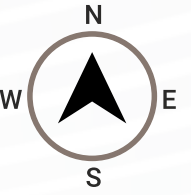

**1, 2, 3 & 4 TYPICAL FLOOR PLAN**

| UNIT NO             | TYPE        | SIZE        | FACING |
|---------------------|-------------|-------------|--------|
| 115, 215, 315 & 415 | 2.5BHK + 2T | 984 SQ.FT.  | NORTH  |
| 116, 216, 316 & 416 | 2.5BHK + 2T | 984 SQ.FT.  | NORTH  |
| 117, 217, 317 & 417 | 3BHK + 2T   | 1047 SQ.FT. | EAST   |

\*Furniture shown in the plan are only for indicative purpose \*Room sizes may vary according to the unit size  
 \*Balconies & Private terraces may have visible plumbing lines, which are securely positioned as part of the design and cannot be relocated.

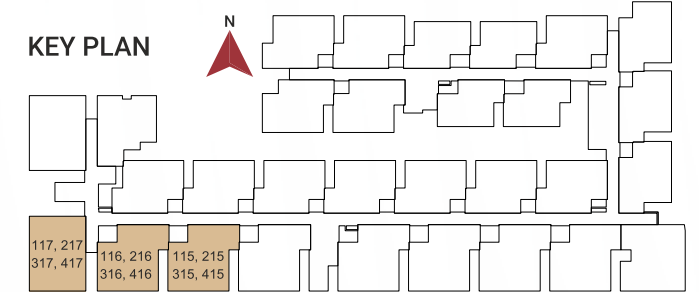

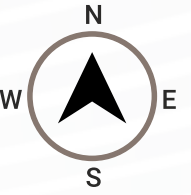

**1,2,3 & 4 TYPICAL FLOOR PLAN**

| UNIT NO             | TYPE      | SIZE        | FACING |
|---------------------|-----------|-------------|--------|
| 118, 218, 318 & 418 | 3BHK + 2T | 1047 SQ.FT. | EAST   |
| 119, 219, 319 & 419 | 2BHK + 2T | 864 SQ.FT.  | WEST   |

| UNIT NO             | TYPE      | SIZE       | FACING |
|---------------------|-----------|------------|--------|
| 120, 220, 320 & 420 | 2BHK + 2T | 807 SQ.FT. | SOUTH  |
| 121, 221, 321 & 421 | 2BHK + 2T | 806 SQ.FT. | SOUTH  |

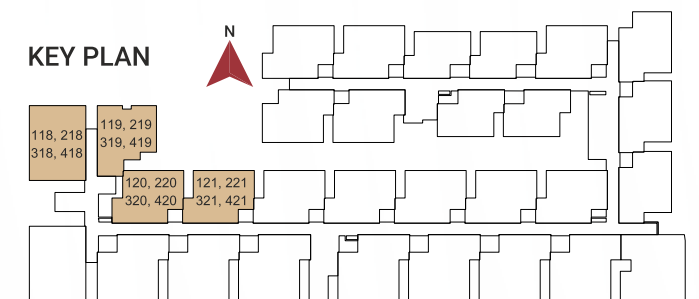

\*Furniture shown in the plan are only for indicative purpose \*Room sizes may vary according to the unit size  
 \*Balconies & Private terraces may have visible plumbing lines, which are securely positioned as part of the design and cannot be relocated.

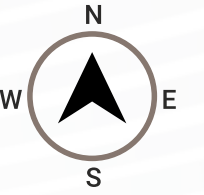

**5TH FLOOR PLAN**

| UNIT NO | TYPE      | SIZE       | FACING |
|---------|-----------|------------|--------|
| 501     | 2BHK + 2T | 807 SQ.FT. | SOUTH  |
| 502     | 2BHK + 2T | 806 SQ.FT. | SOUTH  |
| 503     | 2BHK + 2T | 642 SQ.FT. | SOUTH  |

\*Furniture shown in the plan are only for indicative purpose \*Room sizes may vary according to the unit size  
\*Balconies & Private terraces may have visible plumbing lines, which are securely positioned as part of the design and cannot be relocated.

**KEY PLAN**

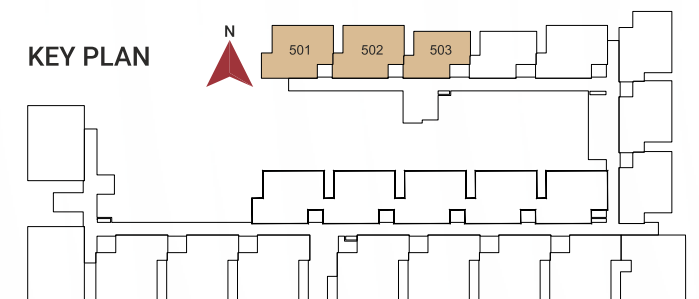

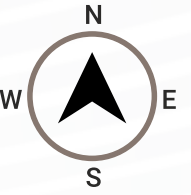

**5TH FLOOR PLAN**

| UNIT NO | TYPE      | SIZE       | FACING |
|---------|-----------|------------|--------|
| 504     | 2BHK + 2T | 642 SQ.FT. | SOUTH  |
| 505     | 2BHK + 2T | 807 SQ.FT. | SOUTH  |

| UNIT NO | TYPE      | SIZE       | FACING |
|---------|-----------|------------|--------|
| 506     | 2BHK + 2T | 798 SQ.FT. | WEST   |
| 507     | 2BHK + 2T | 806 SQ.FT. | WEST   |

**KEY PLAN**

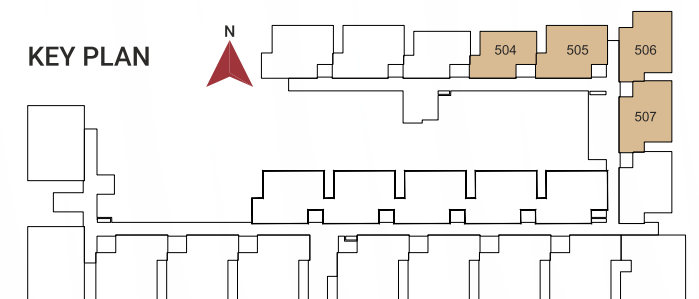

\*Furniture shown in the plan are only for indicative purpose \*Room sizes may vary according to the unit size  
\*Balconies & Private terraces may have visible plumbing lines, which are securely positioned as part of the design and cannot be relocated.

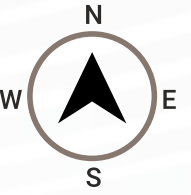

**5TH FLOOR PLAN**

| UNIT NO | TYPE        | SIZE        | FACING |
|---------|-------------|-------------|--------|
| 508     | 2BHK + 2T   | 807 SQ.FT.  | WEST   |
| 509     | 2.5BHK + 2T | 1033 SQ.FT. | NORTH  |

| UNIT NO | TYPE        | SIZE       | FACING |
|---------|-------------|------------|--------|
| 510     | 2.5BHK + 2T | 981 SQ.FT. | NORTH  |
| 511     | 2.5BHK + 2T | 984 SQ.FT. | NORTH  |

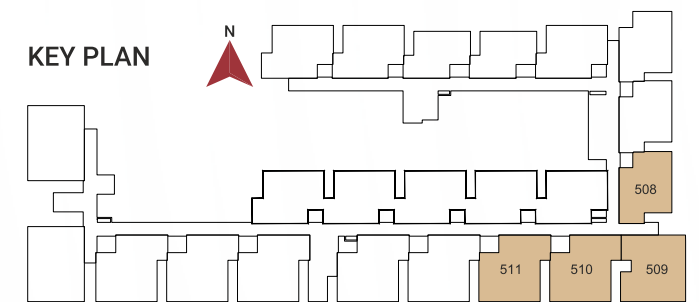

\*Furniture shown in the plan are only for indicative purpose \*Room sizes may vary according to the unit size  
\*Balconies & Private terraces may have visible plumbing lines, which are securely positioned as part of the design and cannot be relocated.

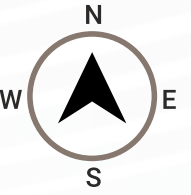

**5TH FLOOR PLAN**

| UNIT NO | TYPE        | SIZE       | FACING |
|---------|-------------|------------|--------|
| 512     | 2.5BHK + 2T | 984 SQ.FT. | NORTH  |
| 513     | 2.5BHK + 2T | 984 SQ.FT. | NORTH  |
| 514     | 2.5BHK + 2T | 987 SQ.FT. | NORTH  |

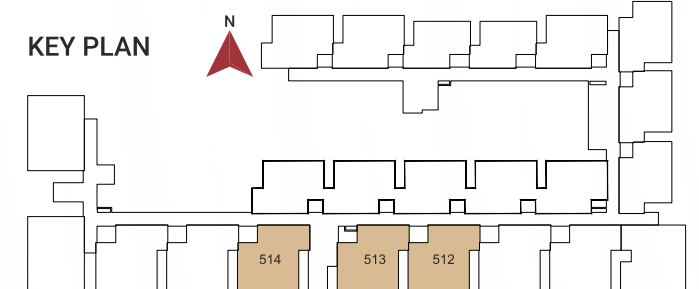

\*Furniture shown in the plan are only for indicative purpose \*Room sizes may vary according to the unit size  
\*Balconies & Private terraces may have visible plumbing lines, which are securely positioned as part of the design and cannot be relocated.

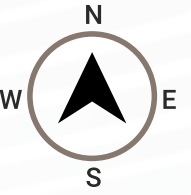

**5TH FLOOR PLAN**

| UNIT NO | TYPE        | SIZE        | FACING |
|---------|-------------|-------------|--------|
| 515     | 2.5BHK + 2T | 984 SQ.FT.  | NORTH  |
| 516     | 2.5BHK + 2T | 984 SQ.FT.  | NORTH  |
| 517     | 3BHK + 2T   | 1047 SQ.FT. | EAST   |

\*Furniture shown in the plan are only for indicative purpose \*Room sizes may vary according to the unit size  
\*Balconies & Private terraces may have visible plumbing lines, which are securely positioned as part of the design and cannot be relocated.

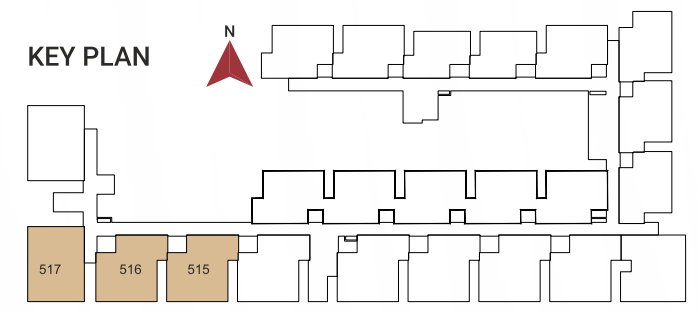

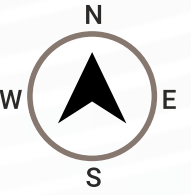

### 5TH FLOOR PLAN

| UNIT NO | TYPE      | SIZE        | FACING |
|---------|-----------|-------------|--------|
| 518     | 3BHK + 2T | 1047 SQ.FT. | EAST   |

\*Furniture shown in the plan are only for indicative purpose \*Room sizes may vary according to the unit size  
 \*Balconies & Private terraces may have visible plumbing lines, which are securely positioned as part of the design and cannot be relocated.

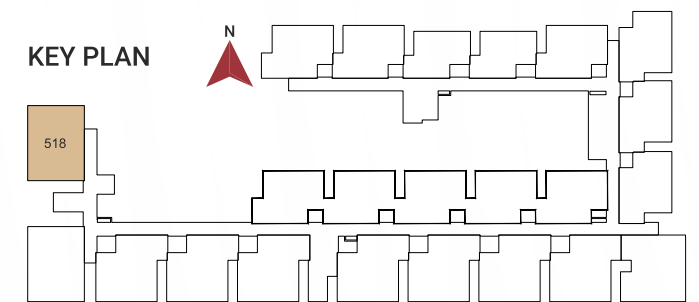

# THE DETAILS THAT DEFINE YOUR HOME

## STRUCTURE



- ❖ RCC Framed Structure and AAC blocks used for 150mm External/100mm Internal walls.
- ❖ Anti-Termite Treatments wherever applicable during Construction Stage.

## KITCHEN



- ❖ 600MM x 600MM Vitrified tile flooring from KAJARIA/AGL or equivalent make.
- ❖ 18mm thick Black granite of size as per drawing for kitchen platform will be provided.
- ❖ Stainless steel sink without drain board - FRANKE/DIAMOND or equivalent make will be provided.
- ❖ Sink water point - CP fittings will be provided.

## TILING



### FLOORING

- ❖ All tiles will be from KAJARIA/AGL or equivalent make.
- ❖ Living, dining and bedrooms - 600MMx600MM vitrified tiles with spacers.
- ❖ Toilets, balconies & utility area - Antiskid ceramic tiles with spacers.
- ❖ Terrace - Weather proof tiles.
- ❖ Door threshold in flats will be finished with granite.
- ❖ Staircase - finished with Granite flooring. Stilt floor lobby with Granite flooring and Corridors & typical floor lobby - vitrified tiles. Car Parking - Grano flooring .

### DADO

- ❖ All tiles will be from KAJARIA/AGL or equivalent make.
- ❖ Kitchen - 600MM x 300MM ceramic wall tiles up to 600MM above the platform will be provided.
- ❖ Toilet - 450MM x 300MM ceramic wall tiles up to 2400MM height from the floor level.

## DOORS / WINDOWS / VENTILATORS



- ❖ MAIN DOOR (1050MM x 2100MM) 2100MM HEIGHT, frame is made of pre-hung engineered ABS door. Shutter of 38mm thick and pressed with high pressure ABS sheets on both sides with grooves and designer hardware's of YALE/GODREJ or equivalent make.
- ❖ BEDROOM DOOR (900MM x 2100MM) 2100MM HEIGHT, frame is made of pre-hung engineered ABS door. Shutter of 35mm thick and pressed with high pressure ABS sheets on both sides and designer hardware's of YALE/GODREJ or equivalent make.
- ❖ TOILET DOOR (750MM x 2100MM) 2100MM HEIGHT, frame is made of pre-hung engineered ABS door. Shutter of 35mm thick and pressed with high pressure ABS sheets on both sides and designer hardware's of YALE/GODREJ or equivalent make.
- ❖ UPVC French doors with sliding shutter will be from PROMINANCE/SIMTA or Equivalent make.
- ❖ UPVC Windows with sliding shutters for all windows will be from PROMINANCE/SIMTA or Equivalent make.
- ❖ Grills will be provided.
- ❖ UPVC Ventilators with pin headed glass along with Exhaust fan provision will be from PROMINANCE / SIMTA or Equivalent make.

## PAINTING FINISHES



- ❖ All internal walls will be finished with 2 coats of smooth putty, 1 coat of primer and 2 coats of Premium emulsion paint of NIPPON/ASIAN or Equivalent make.
- ❖ All external walls will be finished with Texture, 1 coat of primer and 2 coats of weather proof emulsion paint of NIPPON/ASIAN or Equivalent make.
- ❖ Ceilings will be finished with 2 coats of smooth putty, 1 coat of primer and 2 coats of Tractor Emulsion NIPPON/ASIAN or Equivalent make.
- ❖ MS Railing for Balcony and Staircase finished with enamel paint aesthetically designed & fixed to wall.

## ELECTRICAL FIXTURES / FITTINGS



- ❖ Three-phase power supply with concealed wiring will be provide.
- ❖ All switches will be of HAVELLS/SIEMENS or equivalent make.
- ❖ Cables & wiring will be of POLYCAB /HAVELLS/ ANCHOR or equivalent make.
- ❖ Split A/C provision with electrification will be provided in Living room cum Dining and in all bedrooms.
- ❖ 15A plug points will be provided for Refrigerator, Washing machine and Micro-oven.
- ❖ 15A plug points will be provided for Geyser in all toilets.
- ❖ 5A socket for chimney will be provided in kitchen, electrification for exhaust fan point in all toilets.
- ❖ Power backup of 600W is provided for each 2 BHK unit, 800W for each 3 BHK unit, along with backup for essential points in the common areas.
- ❖ TV points will be provided in Living and Master bedroom and Telephone/Internet point in Living & Master bedroom.
- ❖ Type - C charging port in switch boards will be provided in Living and in all bedrooms. Solar power for the essential points in common areas.

## PLUMBING & SANITARY



- ❖ All sanitary ware in ceramic of superior brands like ESSCO BY JAQUAR/PARRYWARE or equivalent will be provided.
- ❖ EWC with health faucet of superior brand like ESSCO BY JAQUAR/PARRYWARE or equivalent will be provided.
- ❖ Washbasin of superior brand like ESSCO BY JAQUAR/PARRYWARE or equivalent will be provided in toilets.
- ❖ CP fittings of superior brand like ESSCO BY JAQUAR/PARRYWARE or equivalent will be provided.
- ❖ Single lever HI - FLOW concealed diverter of ESSCO BY JAQUAR/PARRYWARE or equivalent makes of hot & cold mixer with overhead shower will be provided in the toilets.
- ❖ CPVC/UPVC pipelines/ PVC Soil waste lines/ sewage pipelines and Rainwater lines of a quality ISI brands like ASHIRVAD/SUPREME/PRINCE or Equivalent will be provided.

## COMMON POINTS

- ❖ Site perimeter fenced by Compound wall with Entry/Exit gates will be provided.
- ❖ CCTV surveillance at pivotal points across the site extent which makes it a secure gated community.
- ❖ Two number of bore wells will be provided along with one common well.
- ❖ Security cabin will be provided at the Entry gate.
- ❖ Elevators of 13 Passengers/10 Passengers of JOHNSON/OTIS or equivalent make.
- ❖ Common sump, Sewage Treatment Plant and Rain Water Harvesting will be provided.

# SIX DISTINCT REASONS TO CALL MILLENNIUM HOME .

Discover why Millennium by DAC is more than just a place to live  
it's a lifestyle choice that blends comfort, convenience, and long-term value.

## 1. PRIME LOCATION

Seamlessly connected to Porur, Guindy, Mount-Poonamallee Road, Kathipara Junction, the Chennai Bypass, and the Outer Ring Road placing you at the heart of the city's growth corridor.

## 2. IT & EDUCATION HUB

Stay close to leading tech parks like DLF Cyber City and L & T Infotech, and prestigious institutions including PSBB Millennium School, Omega International, and Saveetha Dental College.

## 3. SMART, EFFICIENT HOMES

Thoughtfully planned 2, 2.5, and 3 BHK residences with intelligent layouts that maximize usable space for comfortable everyday living.

## 4. MORE SPACE FOR LESS

Optimized with minimal wall thickness, ensuring maximum usable area within your home.

## 5. FAMILY-CENTRIC AMENITIES

Enjoy a well-balanced lifestyle with a fully Equipped Gym, Indoor Games Room, Zumba & Aerobics Room, Rooftop Party Area, Senior Citizen Zone, and Children's Play Area.

## 6. SECURE & COMFORTABLE LIVING

Experience peace of mind with CCTV surveillance, reliable power backup, and a gated community environment.





\*The artistic representation provided is for illustrative purpose, and variations in the actual elevation of the resident project may occur due to architectural adjustments and construction considerations.



DAC DEVELOPERS PVT. LTD.

### CORPORATE OFFICE:

New No.27, Old No.19, K-Block, A1, First Main Road, Anna Nagar East, Chennai - 600 102.

**BRANCHES : CHENNAI | COIMBATORE | DUBAI | SINGAPORE**



info@dacdevelopers.com



www.dacdevelopers.com

Member  
**CREDAI**



This brochure is for informational purposes only and is not a binding offer. Details, pricing, and specifications are subject to change without notice. Images are artistic representations and not necessarily reflective of the final product. Prospective buyers should verify all information independently and consult with our sales team for the most up-to-date details. The developer reserves the right to make necessary changes to the project. For specific information, contact our sales team or visit our sales office.