



**Unibera**  
It's all about YOU

Corporate Office: A-11A, Unibera House, Sector-58, Noida, (U.P)  
Phone: +91 120 4807450-99 (50 Lines)  
E-mail: info@unibera.com  
Web: www.unibera.com, www.uniberagroup.in

A member of  
**CREDAI**

SMS: UNB to 56767 | CALL: 9278222333



Lease deed executed (Bahi No. - 1, Jild No. - 13545, Pages 231-340), registration No. - 15293, dated 21-06-2013; Map Sanctioned Ref. No. - PLG/(BP)3245 OPA No. 588, Dated 27-01-2014; All NOCs\* obtained



**Unibera**  
It's all about YOU



*It's all about "U" & Ur's Family's  
Home Paradise !!!*

**Unibera** Group, an established and leading Brand into Residential as well as Commercial Real Estate Sector with its Company, Unibera Developers (P) Ltd has not only created a benchmark of Customer Satisfaction and Trust into this competitive sector but also with its innovative and distinguished approach has created a niche for itself as a Brand "Unibera - Its All About U"

**Unibera** presents the all new Elite range of lifestyle apartments at Greater Noida. Designed and carefully crafted to offer you an elite lifestyle that you have always cherished.

After all a Home is a place where you live every moment of life, a place where you celebrate every occasion, a place where you experience the best of your life.

This is why we have created Unibera Tower, stylishly crafted luxury apartments where you enjoy a quintessential lifestyle that is sought by many but experienced by few.

### Jewels in the Crown of Group

- Swarn Ganga Apartments, Vasundhra, Gzb (Completed)
- Park view Apartments, Vasundhra Gzb (Completed)
- Coral Greens, Khandala, Pune (Completed)
- Sanskriti Apartments, NH24 Indirapuram Gzb (Ongoing)
- Solaris Apartments, Sec-75, Noida (Ongoing)
- Eleven Orchid, (villa projects) Moradabad (Ongoing)



**2250** Sq.ft  
4BHK + Sev. Qurt.



**1455** Sq.ft  
Tower- 1 & 5 3BHK





**1455** Sq.ft  
 Tower- 2 3BHK

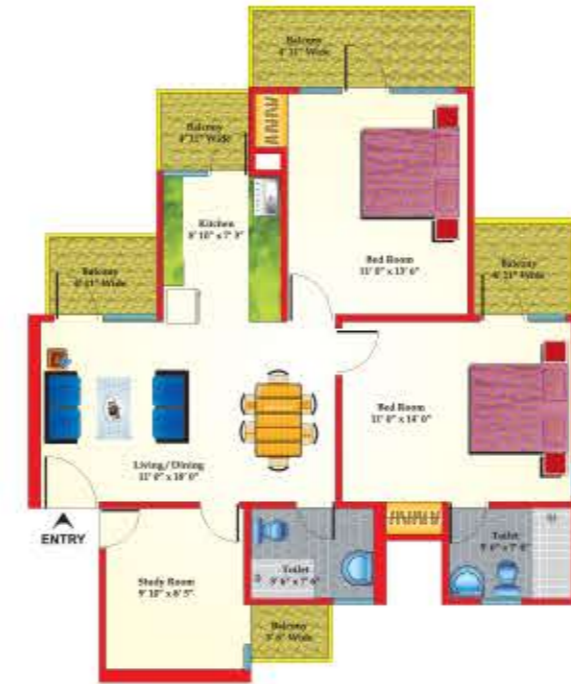

**1305** Sq.ft  
 2BHK + Study Room



**1250** Sq.ft  
2BHK + Study Room

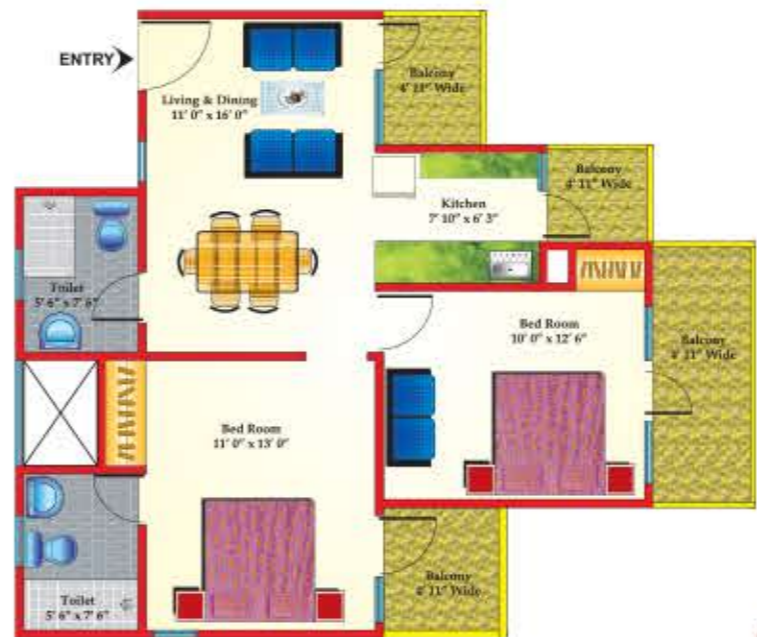

**1025** Sq.ft  
2BHK



## Legends:-

- |                            |                               |
|----------------------------|-------------------------------|
| 1. Main Entry              | 2. Guard House                |
| 3. Exit                    | 4. Driveway                   |
| 5. Parking                 | 6. Ramp                       |
| 7. Entrance Step           | 8. Entrance Plaza             |
| 9. Yoga/ Meditation Area   | 10. Childrens Play            |
| 11. Reflecting Pool        | 12. Basketball Court          |
| 13. Badminton Court        | 14. Interaction Area          |
| 15. Club and Changing Room | 16. Swimming Pool             |
| 17. Toddlers Pool          | 18. Wooden Deck               |
| 19. Pergola                | 20. Central Green             |
| 21. Jogging Track          | 22. Nodes                     |
| 23. Color Garden           | 24. Feature Wall with Benches |
| 25. Floating Pavilion      | 26. Sit Out                   |
| 27. Commercial Block       | 28. Gazebo                    |
| 29. Outside Plot           | Podium                        |

## *Exclusive Features*

- Security lobby with lift
- Wi- Fi- Enabled Apartments
- Cable/DTH Facility
- Wooden flooring in Master Bedroom
- Air Conditioner in Master Bedroom
- Wooden Cup boards in all Bedroom
- Modular Kitchen
- Lights & Fans in all rooms
- Chandelier in living room
- Intercom
- Service Lifts
- Spacious Balconies
- Podium Landscape

*Comfort & Space...*





# Facilities

## Sport Zone

- Billiards and TT Room
- Skating Ring
- Jogging Track
- Tennis Court
- Basket Ball Court

## Comfort Zone

- Business Lounge
- Grocery Shop
- Unisex Saloon & Spa
- Library
- Coffee Shop
- Guest Parking

## Health Zone

- Gymnasium
- Yoga Centre
- Swimming Pool

## Kids Zone

- Creche
- Day Boarding
- Play Area

## 3-Tier Security System

- Tier 1 Security (Premises Level)
- Tier 2 Security (Tower Level)
- Tier 3 Security (Apartment Level)





## Concierge Service

Life at Unibera Tower is like living in a seven star resort, which is why we have a dedicated Concierge Service. Just order and we will deliver the following services at your doorstep:

- 24 hours electrician service
- 24 hours plumber service
- Ambulance on Call
- Bill payment service
- Cable/DTH service
- Car cleaning personal management
- Carpenter service
- Centralized maid placement and management
- Courier service
- Doctor on call
- Driver placement and management
- Driving Licence/Passport assistance
- Flower delivery
- Food on order
- Gardener service
- Laundry service
- Medicine on call
- Movie tickets booking
- Newspaper/magazine vendor management
- Senior citizens care
- Shuttle service to nearest metro station
- Tax consultation services
- Taxi on call
- Tiffin service
- Travel tickets booking
- Tution teacher coordination



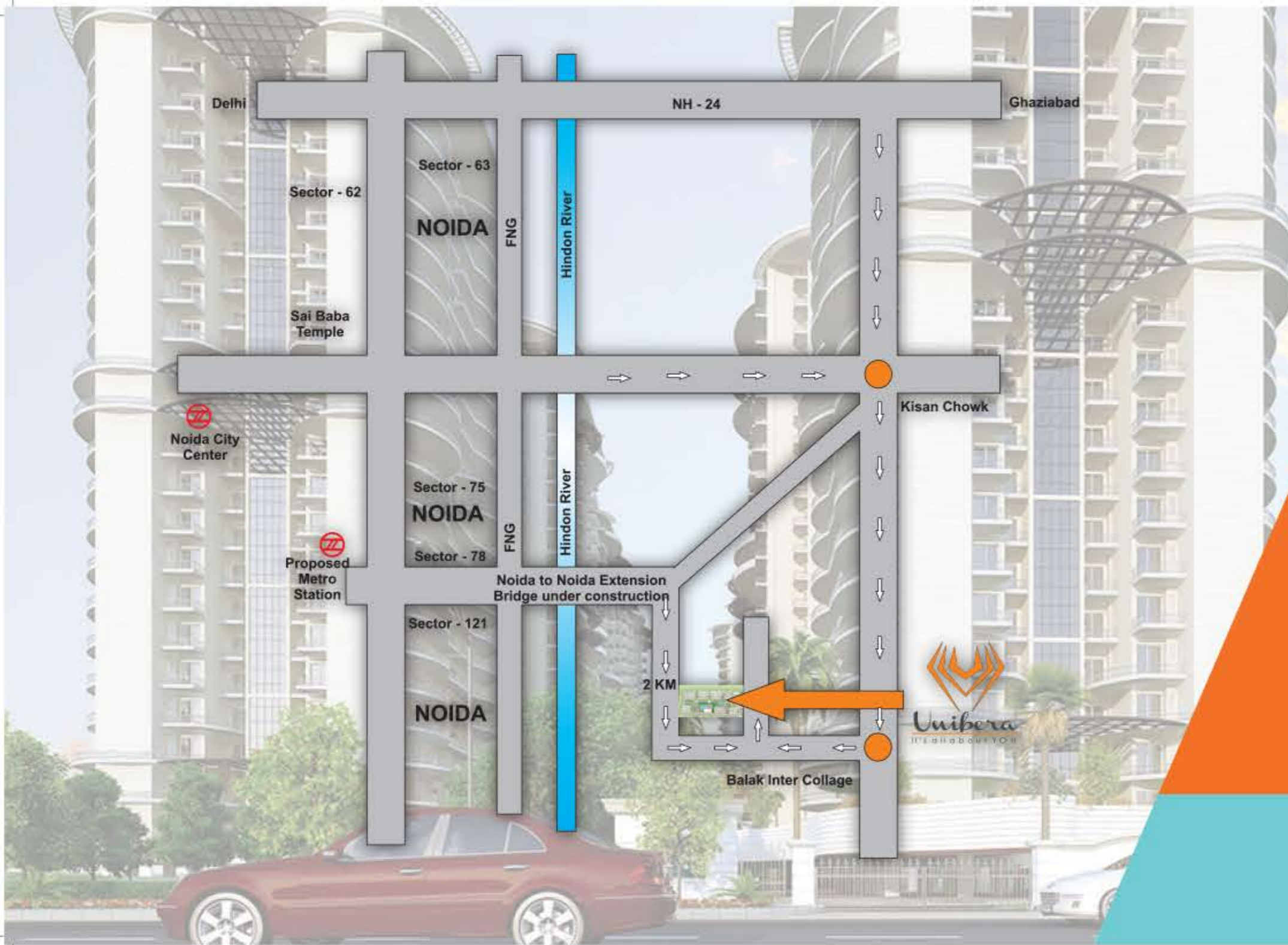

# Specification

Location	Floor	External Door & Window	Electrical Fittings	Walls	Fittings	Internal Door	Ceilings	Hardware	Electrical
Living Room	Vitrified Tiles / Marble Flooring	Powder Coated Aluminum window shutter and door flush shutter with Aluminium Frame.	Modular Switches	Oil Bound Distemper	Chandelier, Lights and Fans	Flush Door with Wooden Frame	Oil Bound Distemper		
Dining	Vitrified Tiles	Powder Coated Aluminum window shutter and door flush shutter with Aluminium Frame.	Modular Switches	Oil Bound Distemper	Lights and Fans	Flush Door with Wooden Frame	Oil Bound Distemper		
Bed Rooms	Vitrified Tiles / Marble Flooring	Powder Coated Aluminum window shutter and door flush shutter with Aluminium Frame.	Modular Switches	Oil Bound Distemper	Lights, Fan and Wardrobe	Flush Door with Wooden Frame	Oil Bound Distemper		
Master Bed Room	Wooden Flooring	Powder Coated Aluminum window shutter and door flush shutter with Aluminium Frame.	Modular Switches	Texture Paint on One Wall	Lights, Fan, AC and Wardrobe	Flush Door with Wooden Frame	Oil Bound Distemper		
Study	Ceramic Tiles / Marble Flooring	Powder Coated Aluminum window shutter and door flush shutter with Aluminium Frame.	Modular Switches	Oil Bound Distemper	Lights and Fan	Flush Door with Wooden Frame	Oil Bound Distemper		
Kitchen	Vitrified Tiles / Marble Flooring	Powder Coated Aluminum window shutter and door flush shutter with Aluminium Frame.	Modular Switches	Ceramic tiles of 2' height from the Platform and oil Bound Distemper	Modular Kitchen, S.S Sink with C.P. Fittings, Lights, Independent R.O.	Flush Door with Wooden Frame	Oil Bound Distemper		
Wash Room	Ceramic Tiles / Marble Flooring	Powder Coated Aluminum window shutter and door flush shutter with Aluminium Frame.	Modular Switches	Ceramic tiles of 2' height and Oil Bound Distemper	Geysers in Master Bathroom, Washbasin WC & C.P. Fittings	Flush Door with Wooden Frame	Oil Bound Distemper		
Balconies	Ceramic Tiles / Marble Flooring	Powder Coated Aluminum window shutter	Sheet and Switches	Oil Bound Distemper	Lights and Fan		Oil Bound Distemper		
Lift	PVC Flooring		Sheet and Switches						
Lobbies / Corridor	Kota Stone			Oil Bound Distemper					

All doors and windows with metal fittings with mortice lock on the main door

Copper wiring and PVC concealed conduit. Provision for adequate light and power points as well as Television and T.V. Outlets and Protective M.C.B.s.

### Outside

- Entrance Lobby • Podium Based Landscaped Garden • Kids' Play Park
- Hi-Speed and Service Elevators • Earthquake Resistant RCC Structure
- Plentiful Water Supply • Power Backup in Common Areas • Water Softener Plant
- Rain Water Harvesting • Provision For Gas Pipe Line • EPBAX • Guard Security

### Inside

- Choice of 2, 3 & 4 BHK Lifestyle Apartments • Ample Parking
- Cross Ventilated Apartments with Wide Open Balconies
- Modern Tiles in Toilets • Modern Sanitary Wares
- Well Planned Kitchen with Wood Work • Granite Cooking Platform
- Stainless Steel Sink

### Consumption

- Air Conditioner in Master Bedroom • Chandelier in Living Room
- Electrical Fittings of Tube Lights & Fans • Modular Switches
- High-quality Copper Wiring • Geysers in Master Bathroom