

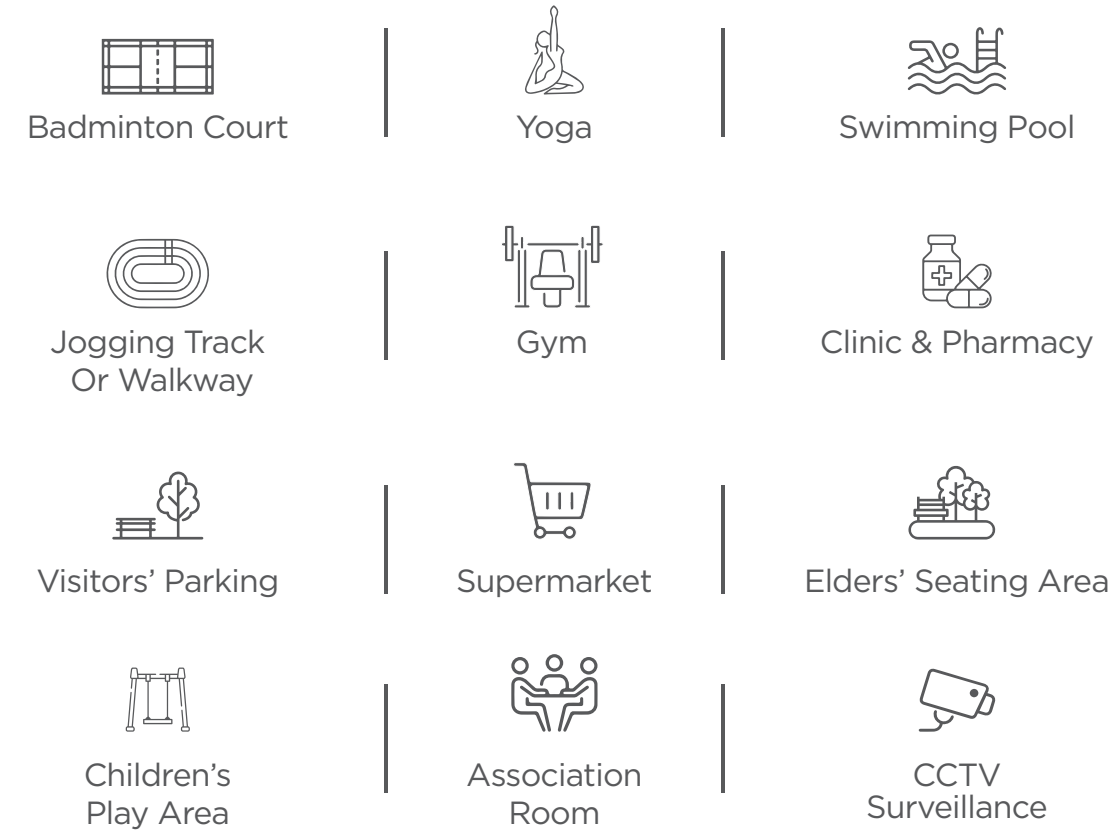

LEGEND

- | | |
|---------------------|-------------------------|
| 01 Entry | 09 Club House |
| 02 Arrival Plaza | 10 Ramp In |
| 03 Swimming Pool | 11 Outdoor Gym |
| 04 Jogging Track | 12 Badminton Court |
| 05 Cricket Nets | 13 Outdoor Seating Area |
| 06 Kids Play Area | 14 Ramp Out |
| 07 Elder's Park | 15 Exit |
| 08 Transformer Yard | |

AMENITIES



SPECIFICATIONS

- STRUCTURE**
R.C.C framed structure.
- SUPER STRUCTURE**
9" Thick AAC blocks/red clay bricks for external walls.
4" Thick AAC blocks/red clay bricks for internal walls.
- FLOORING**
Drawing, living & dining vitrified tiles 4'x2'.
Bedrooms - Vitrified tiles 4'x2'.
Balcony - Anti-skid ceramic tiles.
- DOORS & WINDOWS**
Main door - Teak-wood frame & pre-mould flushed shutter in wood; with PU polish on both sides.
Internal doors - Engineered wood frame & flushed shutters with laminate.
Windows - uPVC frame glazed sliding or openable shutters.
Windows & balcony doors provision for mosquito-mesh shutters.
- ELECTRICALS**
Concealed wiring with PVC insulated copper wires and modular switches.
TV and Telephone points in drawing, living rooms and all bedrooms.
Provision for split AC in drawing, living, dining rooms and all bedrooms.
ELCB and individual meters for all apartments.
- PAINTING**
External walls - Textured paint
Internal walls & ceilings - Acrylic emulsion paint
Railings - Enamel paint on all MS railings.
- KITCHEN & UTILITY**
Flooring dadoing vitrified tiles (2'x2').
Sink glazed ceramic tile (upto 2' height above kitchen platform).
SS sink with CP tap and provision for fixing water-purifier.
- TOILETS & FITTINGS**
Flooring - Anti-skid ceramic tiles (1'x1').
Dadoing - Ceramic tiles (upto toilet door height - 1'x2' or 1'x1.5').
Counter - Artificial marble/Granite with ceramic basin wash.
WCS and chrome plated fittings - Hindware/Cera or equivalent.
Single lever tap and shower mixer - Hindware/Cera or equivalent.
Provision for geysers in all toilets except maid's toilet.
- LIFTS**
3 Passenger lifts of good make with the capacity of 8 passengers each.
2 Service lifts of good make with the capacity of 10 passengers each.
- GENERATOR**
Generator power supply will be provided to common areas.
- UTILITY**
Flooring dadoing, Anti-skid ceramic tiles (1'x1').
Provision for washing machine.

WELCOME TO A SURREAL SPACE

Built to be a home for life, Amrutha Sagar is a 2 & 3 BHK apartment home in the heart of Kompally. Made on 2 acres, the project is a spacious home ideal for families of all sizes to grow and prosper in comfort. It's time to explore an abode built on the foundation of quality and comfort.

PROJECT OVERVIEW

02 ACRES | **164 UNITS** | **2 Basements + G + 8 FLOORS**

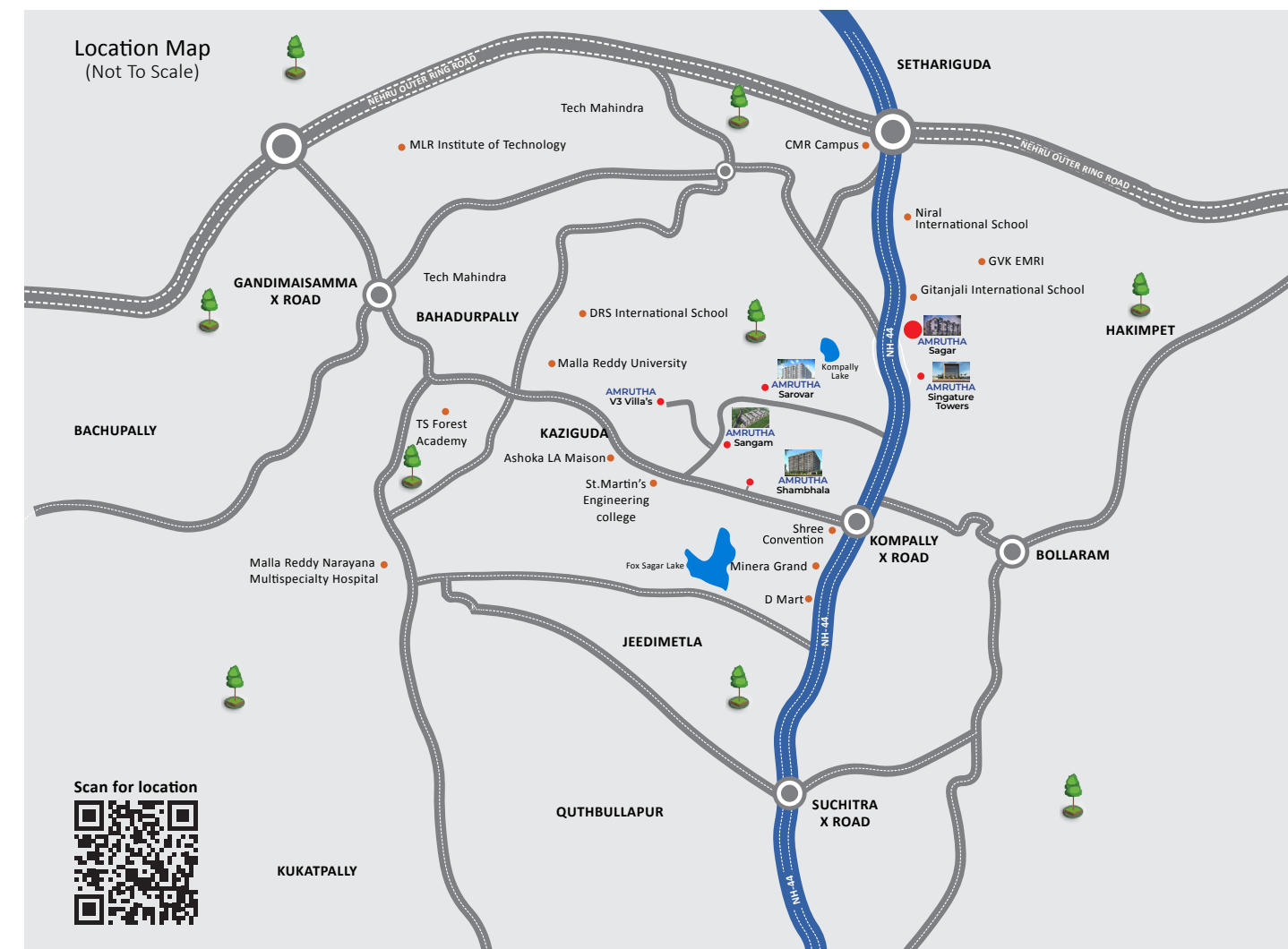

LOCATION HIGHLIGHTS

- | | | |
|--|---|--|
| HOSPITALS | LEISURE | EDUCATIONAL INSTITUTIONS |
| <ul style="list-style-type: none"> Russh Hospital Renova Hospitals Ankura Hospital Suraksha Hospital MediCiti Hospitals | <ul style="list-style-type: none"> Leonia Resort Aalankrita Resorts Dhola-Ri-Dhani Cine Planet Aranya Resort Raichandani Mall | <ul style="list-style-type: none"> TNR NorthCity Mall ORCHIDS The International School DRS International School Oakridge International School Delhi International School Malla Reddy Engineering College Loyola Academy |



CORPORATE OFFICE:
Sy.No. 180,182/A and 183 Part Kompally Village, Dundigal, Gandimaisamma Mandal, Medchal-Malkajgiri - 500014

SITE ADDRESS:
Amrutha Sagar Survey No: 83P. Situated At Kompally Village & Gram Panchayat, Dundigal-Gandimaisamma Mandal, Medchal-Malkajgiri District, Telangana State.

FOR BOOKINGS CONTACT:
+91 91000 07183
sales@amruthaprojects.in
Follow Us: [Social Media Icons]



RERA NO.: P02200007236

NOTE: This folder is purely conceptual and not a legal offer. Area is tentative and actual areas arrived at completion of the flat may differ. The promoters reserve the right to make changes in elevation, plans & specifications as deemed fit.



KOMPALLY
2 & 3 BHK
LUXURY APARTMENTS

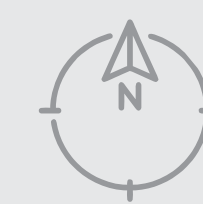

TYPICAL FLOOR PLAN

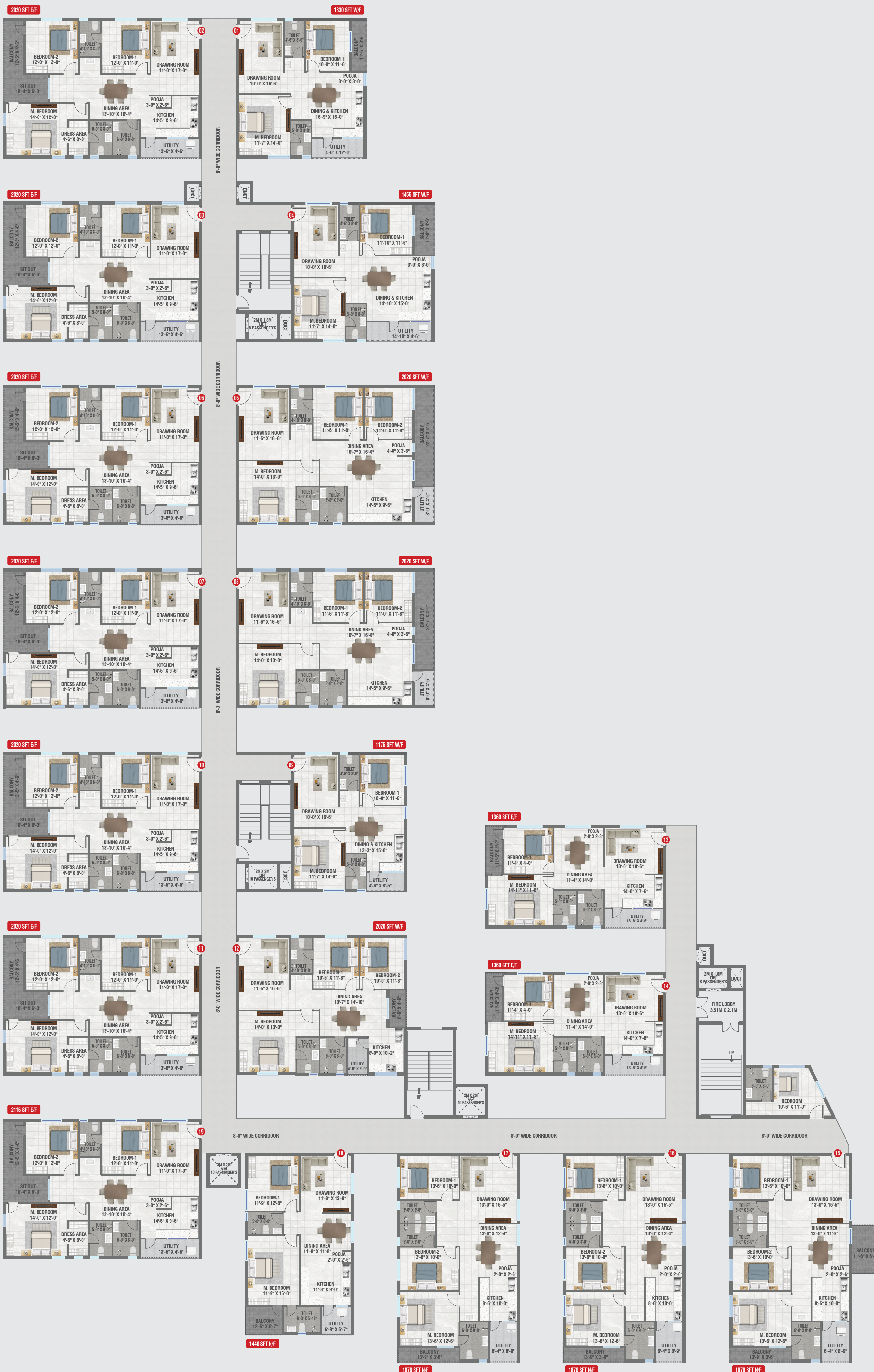

FLAT NO	BHK	AREA (Sft)	FACING
01	2BHK	1330	WEST
02	3BHK	2020	EAST
03	3BHK	2020	EAST
04	2BHK	1455	WEST
05	3BHK	2020	WEST
06	3BHK	2020	EAST
07	3BHK	2020	EAST
08	3BHK	2020	WEST
09	2BHK	1175	WEST
10	3BHK	2020	EAST
11	3BHK	2020	EAST
12	3BHK	1735	WEST
13	2BHK	1360	EAST
14	2BHK	1360	EAST
15	3BHK	1970	NORTH
16	3BHK	1870	NORTH
17	3BHK	1870	NORTH
18	2BHK	1440	NORTH
19	3BHK	2115	EAST