

A project by



303 & 304, "B&F Habitat" Bldg,  
New Canca - Parra By-Pass Road,  
Khorlim, Mapusa, Goa 403507 India

Email: [sales@bfreality.in](mailto:sales@bfreality.in) | Website: [www.bfreality.in](http://www.bfreality.in)

+91 9011074947 / +91 9657029822

# Whispering<sup>TM</sup> Glenz

I took a walk in the woods and came out taller than the trees  
- Henry David Thoreau

A project by **B&F**<sup>TM</sup> and  
reality



Project promoted by RVJ Trading Private Limited

“CRAFTED WITH PRECISION  
DEFINED BY EXCELLENCE”



“Get Lulled By  
Nature’s Bosom”



A sanctuary that transcends every desire.



Artist Impression



# WGG

A sanctuary that transcends every desire.

## “Serenity Redefined. Whispering Glenz.”

The phrase "Serenity Redefined" succinctly encapsulates the essence of the Whispering Glenz residential project: an epitome of luxury redefined within nature's embrace.

The use of "Serenity Redefined" suggests a unique and heightened state of calmness, while "Whispering Glenz" implies a subtle and inviting atmosphere, evoking a sense of exclusivity and comfort. This enclave of elegance seamlessly integrates with its lush surroundings, offering a lifestyle that harmonises comfort and sophistication.





Artist Impression

## “ A Grandiose Gateway to Magnificence.”

A stately drive, canopied by a tree-lined entryway paints the path with the bounty of nature's grace, leading you to the grandeur of Whispering Glenz.

Fall in love with the welcoming carpet of autumnal hues, a floral symphony on either side and a nameplate that stands as a prelude to the enchantment and magic that awaits within.



# “An Edifice Crafted With Threads of Tranquillity.”

Whispering Glenz is an Architectural marvel set amidst Nature's Tapestry.

The elevation of our residences stands as a testament to architectural finesse, a harmonious fusion of contemporary design and natural aesthetics.



Artist Impression



## “Beyond Imagination. Your Xquisit Sanctum.”

Enjoy unmatched extravagance, as elegance meets comfort and refinement blends with seclusion in your living room at Whispering Glenz.

The living space is meticulously designed to create an inviting atmosphere for shared moments and relaxation. Luxury meets togetherness in perfect harmony, making it the ideal intimate habitat for you and your loved ones to unwind.



# “Panoramic Vistas from Your Personal Sky Lounge”

Your Balcony at Whispering Glenz - where vistas become mind treasures, where the world's magnificence extends from the horizon to your private enclave providing one a tranquil escape from the bustling world below.

Your private refuge to unwind and savour sunsets and lively gatherings.





Artist Impression

## “ Timeless sophistication Eleganze Haven”

Step into a realm of opulence within the intimate confines of Whispering Glenz Luxury Bedrooms. The bedrooms at Whispering Glenz are artfully designed where every detail is curated to provide a haven of comfort and style. Discover your personal retreat in our thoughtfully designed bedrooms.

At Whispering Glenz slumber in elegance, awaken in peaceful ambience completely revitalised.



## “Intimate Haven - Relaxation in Luxe Surroundings”

The boudoir at Whispering Glenz where extravagance meets respite.

The master bedroom at "Whispering Glenz" is a luxurious escape, marrying sophisticated design with a soothing ambiance, assuring peaceful and rejuvenating nights.





“Culinary Journeys Begin Here  
where gourmet artistry  
unravels”

For the exhibitionist in you, the open plan layout sets the stage to showcase your culinary skills, a perfect canvas for gastronomic exploits.

The adjoining dining area complements this setting with an ambiance that elevates every meal.



# “Culinary Sutra Where dining ignites a sensory delight”

At Whispering Glenz, every meal becomes a masterpiece and every moment a celebration. Each dining space is meticulously designed to offer an immersive experience, combining sophistication with functionality, from bespoke lighting to exquisite furnishings.

Whispering Glenz sets the stage for epicurean indulgence inviting you to savour the finest moments in the heart of luxurious living.







“Enjoy a kiss from the stars lying under a velvety sky”

The allure in the privacy of your plunge pool, where nature's chorus meets seamlessly with water's rhythm orchestrating a symphony.

“The harmony soothes away all the weariness of the grind. a true testament of an extraordinary abode”



“Your antidote to exhaustion  
soothed by nature’s bosom”

Gather atop the terrace, unwind in the luxurious embrace of the Jacuzzi, and revel in moments of sheer delight with friends and family. Here, amidst the skyline, leave the worries behind and immerse yourself in carefree conversations, laughter, and relaxation.

“A haven where the world’s  
troubles fade away, replaced by the  
joy of cherished connections, all  
against the backdrop of an exquisite  
terrace setting.”





“A wellness zone for fitness & vitality.”

Elevate and tone your physical condition in the state-of-the-art gym, where wellness meets avant-gardism, ensuring a workout experience like no other

Welcome to your fitness centre, where wellness converges with modernity, crafting an unparalleled workout experience.

“A transformational fitness journey. to redefine limits & embrace a lifestyle of holistic wellness.”



## “A Tranquil Passage Within Nature’s Embrace”

Embark on a journey of serenity as you stroll through the enchanting garden walkway where lush foliage and vibrant blooms create a picturesque path, inviting residents to unwind amidst nature's embrace.

The carefully curated landscape seamlessly intertwines with the architectural beauty, offering a tranquil escape within the heart of the community.

Whether it's a morning meander or a twilight saunter, the garden walkway becomes a sanctuary where the whispers of leaves and the fragrance of blossoms converge, fostering a sense of peace and connection with the outdoors.

At Whispering Glenz, the garden walkway is not just a passage; it's a meditative sojourn, a living canvas that unfolds with every step, inviting you to pause, reflect, and appreciate the beauty that surrounds you.



Super Built-up Area

73.70 - 78.70 sq.m

793.30 - 847.12 Sq. ft



**IBHK**  
Block- A & E



Cocoon yourself  
amongst the sky,  
the stars  
& the woods

**2BHK**  
Block- B , C & D



Super Built-up Area

111.40 - 116.5 Sq.m

1199.10 - 1254.00 Sq. ft



Super Built-up Area

171.80 - 202.90 sq. m

1849.24 - 2184 sq. ft



2BHK With Terrace  
Block- B, C & D



Epic sunsets  
and cherished  
moments.

Super Built-up Area

227.80 - 233.10 sq. m

2452.02 - 2509.07 sq. ft



3BHK With Terrace  
Block- A & E

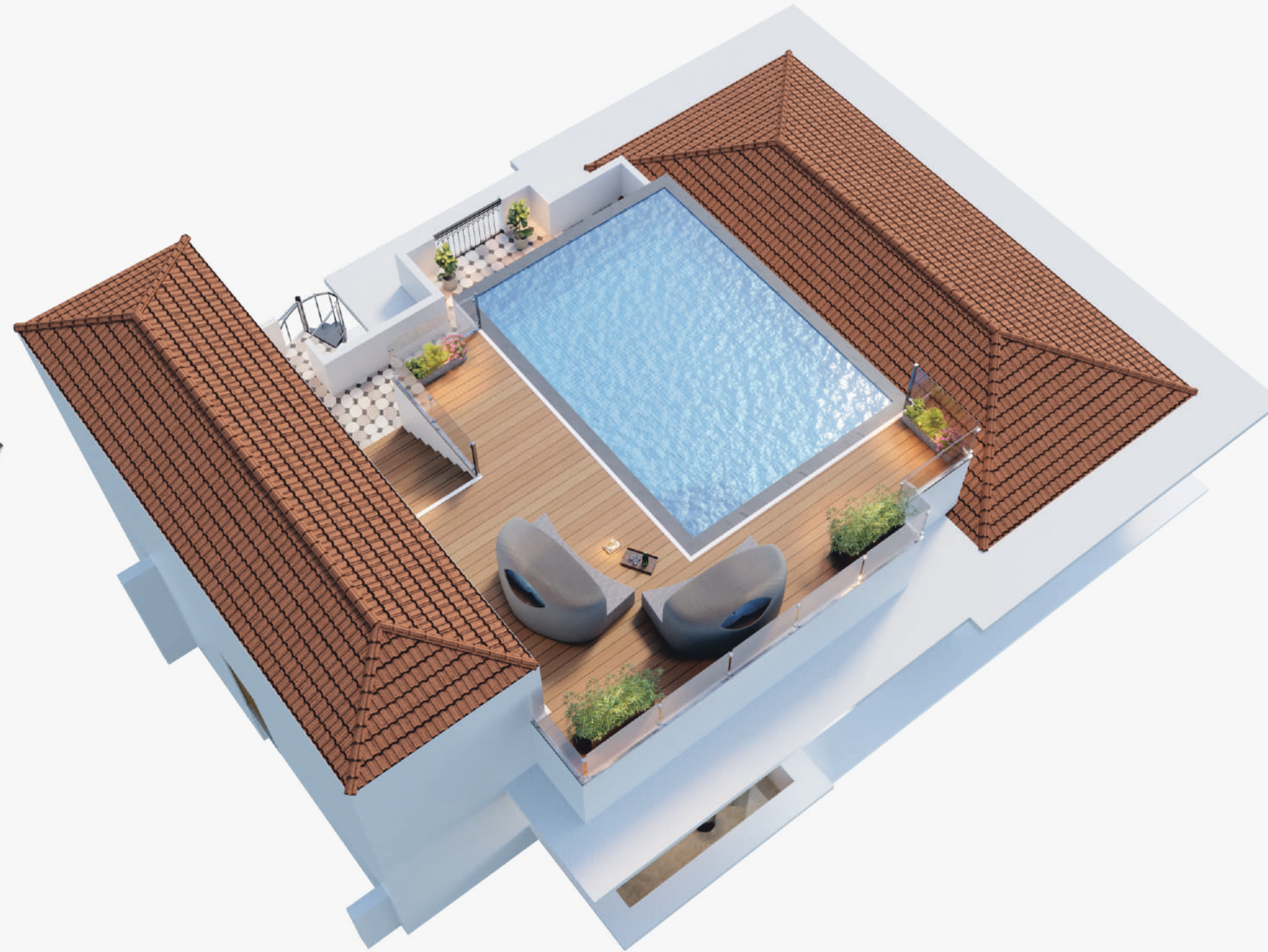

Living Spaces  
Redefined



## Top-notch amenities & premium features

- Gated Community
- 24/7 security
- CCTV surveillance
- High-speed internet connectivity
- Infinity-edge swimming pool
- Penthouses with Private Plunge-Pool and Jacuzzi
- Unrivaled Luxury
- Stylish Interiors
- Mesmerizing Views
- Outdoor Bliss
- Prime Location

## The ultimate in dream life-style

Whispering Glenz is not just a residence; it's a lifestyle.

Where every detail is meticulously designed for your comfort and pleasure.

# AMENITIES



### Infrastructure

- Picturesque green manicured driveway
- Secure gated complex
- Inviting A/C Reception with Parking:
- Paved driveway & manicured foliage around the complex
- Elevators for all blocks
- Secured block entrances
- EV charging points provision



### Security Measures

- CCTV monitoring and surveillance systems
- Intercom to Reception / Security Gate
- 24/7 on-site manned security



### Landscaping and Maintenance:

- Manicured grass verges alongside paved driveway
- Landscaped and covered walkways with shrubbery
- Garbage collection and composting pits
- Year-round common maintenance (Gardens, Lighting, Pool, Tanks, Drainage, etc.)



### Apartment Feature

- Aesthetically designed apartments
- Luxe penthouse suites featuring plunge pools or jacuzzi
- Concealed high-speed internet access points
- Use of high-grade materials



### Amenities

- Infinity Pool with Feature: (rain shower, poolside decking and cabana)
- Versatile Dual-purpose Sports Court
- Barbeque Area
- Gymnasium with equipment



### Services

- Comprehensive leasing and maintenance services can be provided on the property
- Common amenities generator backup
- Power backup for one light & fan in every room



### Kitchen

- Fitted modular kitchen with hob and chimney with extractor
- Open kitchen with breakfast counter
- Polished granite platform with wall tile backdrop
- Adequate provision for built-in fire-resistant power sockets
- Plumbing provision for washing machine



### Bedroom / Apartment

- Ac fitted in all living areas
- Glass enclosure for the master bathroom only
- Vanity cabinet in bathrooms
- Geysers in all bathrooms and kitchen
- Mortise locks (S.S finish) on all bedroom doors
- Other door fittings in S.S
- Provision of adequate sockets, power and light points of fire-resistant grade



### Structure:

- Weatherproof paint for exterior surfaces
- Acrylic emulsion for interior surfaces
- Water supply through CPVC pipes from an overhead storage tank and ground-level sump tank fed by the government water department.



### Living

- Floor-to-ceiling height UPVC French doors
- Planned niche shelving around wash basins and shower unit
- Vitrified tiles along with skirting



### Electricals:

- 3-Phase power with concealed, fire-resistant, double-insulated wiring
- Adequate points in every room: lights, fans, power, switches, sockets
- AC provision in living and bedrooms



### Bathroom

- Countertops for all bathrooms
- Mirrors, towel rails, and toilet holders for all bathrooms
- Sanitary ware with premium "Kohler or equivalent" fittings
- Bathrooms fitted with hot and cold mixer taps
- Extractor fans in all bathrooms
- Master bathroom with glass enclosure
- Shower curtains for other bathrooms



### Exterior

- Illuminated garden pathways paved with stone slabs
- Arch entryway and paved drive into the project
- Adequate landscaping around the project



### Door & Windows

- High-grade 1.2 Mtr. Wide door
- Frame and shutter shall be of high-quality wood
- Woodwork — door frame and shutter shall be polished/painted
- Mortise locks (S.S finish) on all bedroom doors



OUR COMPLETED PROJECTS -  
**RESIDENTIAL & COMMERCIAL**



a name synonymous with excellence.

### About Us

B&F Realty is a real estate developer based in Goa, India, established over 40 years ago and currently helmed by the second generation. The company has a proven track record of consistently delivering quality, aesthetics, and ahead-of-time projects, which has won the loyalty and trust of its clientele.

B&F Realty is renowned for creating complete life-spaces for a lifetime, not just homes. From luxury villas to stunning apartments and farmhouses across Goa, the company is dedicated to quality improvisation combined with refined aesthetics and prime locations, attracting high-profile clients and celebrities.

B&F Realty's impeccable track record and customer referrals are a testament to the company's ethos. With ongoing and upcoming projects, B&F Realty is the premier choice for premium real estate in North Goa.



# WG

## Where Luxury Resides in Nature's Embrace Your Gateway to Serene Living in Whispering Glenz

Introducing Whispering Glenz, an exquisite residential haven nestled amidst lush greenery, an idyllic retreat that seamlessly integrates luxury living with nature's tranquillity. You can immerse yourself in a world of opulence within the confines of our gated community, boasting a host of premium amenities.

It features a refreshing swimming pool, a multi-functional sports court and elitist penthouse residences where one can take a sunset swim on your private terrace pool, luxuriate in your intimate Jacuzzi, or relax in the quietness and solitude of your residence.

Whispering Glenz is located just a stone's throw away from the beaches, the city centre, the airport, shopping malls, and esteemed educational institutions, an exemplary blend of convenience and leisure.

At Whispering Glenz, you can enjoy a life of luxury and comfort, with every detail expertly curated to perfection. It's the ideal residence for those who seek the pinnacle of modern living.

Working, playing, and living in serenity is the Nouveau dream, and Whispering Glenz hits that mark perfectly, making it a reality!

*Come Unlock –  
Peace and live the sossegado lifestyle with flair at Whispering Glenz*



A sanctuary that transcends every desire.



# “Discover opulence in a prime locale at Whispering Glenz Residences”

- Equidistant between the North Goa beach belt and Mapusa city.
- Good road connectivity for essential services.
- Tranquil environment set back from the hustle and bustle of traffic.

# WG



## LOCATION PLAN

- 1 Mopa Airport - 18.7km
- 2 Galaxy Hospital - 1.6 km
- 3 Vision Hospital - 2.7 km
- 4 Thivim Railway Station - 10.3 km
- 5 St. Xavier's Collage - 2.9 km
- 6 Mall De Goa - 14.2 km
- 7 St. Anthony Church - 4.3 km
- 8 Mapusa City - 3 km
- 9 Arambol Beach - 18.6 km
- 10 Ashwem Beach - 13.8 km
- 11 Morjim Beach - 11.7 km
- 12 Uddo Beach - 7.8 km
- 13 Chapora Beach - 9.2 km
- 14 Vagator Beach - 10.0 km
- 15 Anjuna Beach - 11.1 km
- 16 Baga Beach - 12.9 km
- 17 Calangute Beach - 12. km
- 18 Candolim Beach - 14.3 km

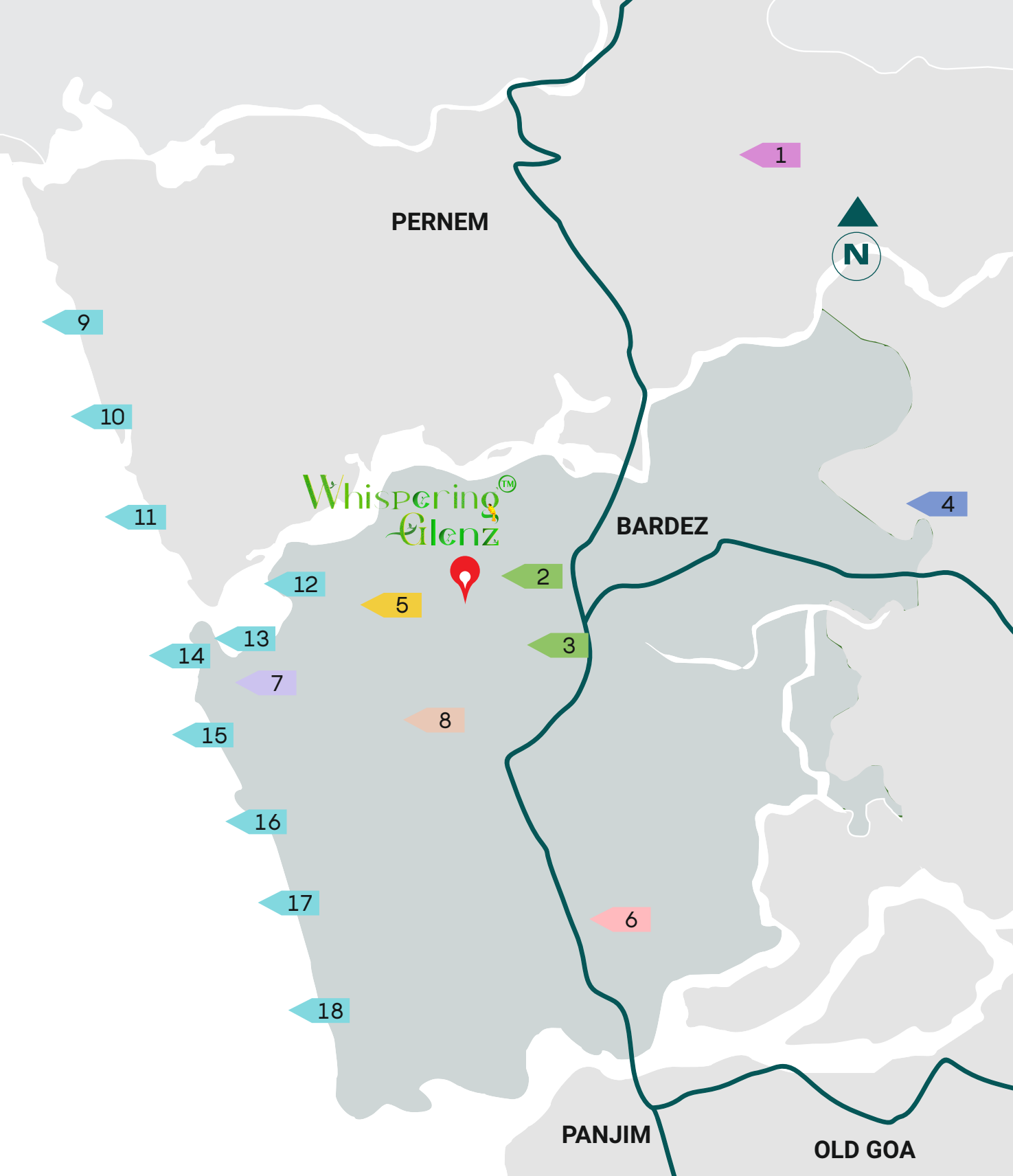

### DISCLAIMER:

Please be advised that the depictions presented in this presentation are the artist's impression and are subject to change at any time. The developer holds the right to make any changes to the project or any detail for improvement purposes. It is important to note that changes in government rules and regulations will apply to all those who purchase the project. The furnishings shown in the interior images are not part of the offerings. Please note that this brochure is conceptual and is meant solely for advertisement purposes only. It should not be considered as a part of a legal document.