

દયાળુ જય સ્વામિનારાયણ



REDEFINING THE LAVISH LIFESTYLE...!!!



Dev Aashish Z+
Opp. Hanspura Residency, Nr. D-mart, Naroda - Dehgam Road,
Naroda, Ahmedabad - 382 330 | **Contact: 95 12 381 381**



Scan Above QR code
for Location



Scan Above QR code
for
Dev Aashish
Mobile App



GUJRERA.GUJARAT.GOV.IN | RERA NO: PR/GJ/AHMEDABAD/DASKROI/AUDA/RAA08919/210821

   DevAashishAhmedabad DevAashishGroup.com



Established in 2009, Dev Aashish has been constructing numerous Residential & Commercial paragons that carved a unique niche in the world of construction.

With its quality construction clubbed with world-class amenities and aesthetics, the group is constantly augmenting the urban sprawls of Ahmedabad and Gandhinagar.

With an attestation to excellence, Dev Aashish strives to serve the best of amenities for a plush lifestyle surrounded by a green, clean and eco-friendly environment.

We are renowned for our pre-eminent quality, efficiency, commitment and technological advancements incorporated in all our residential and commercial spaces.

Today, Dev Aashish has become a proud community of 1000+ delighted families and 3000+ members with its 9+ Residential and Commercial spaces spread over urbane conurbations of Ahmedabad and Gandhinagar.



38 Units



219 Units



393 Units



280 Units



182 Units



Coming Soon...





Dev
Aashish

2|3 BHK LAVISH APARTMENTS



A prelude to the flawless lifestyle

With its latest edition to the urban agglomeration, Dev Aashish proudly introduces Z+...

a new sensation in Ahmedabad's realty world. The residence is sure to be the new address to elegance with its amalgam of 70+ amenities and cosmopolitan appeal.

With its capacious 2 & 3 BHK apartment layouts, the magnum opus is designed by envisioning to cater to the cultured class of the society.

The ambience that resonates plush living...

An assemblage of unsurpassed amenities

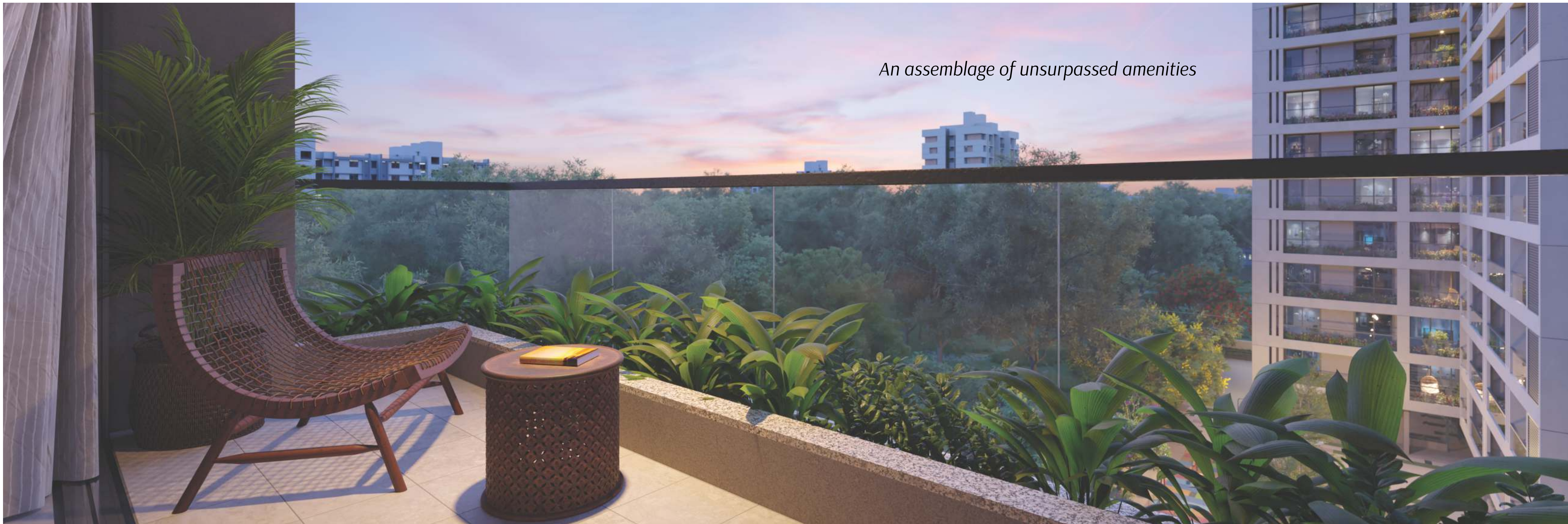



The key highlight of this Haute living space is its amenities. A rendezvous embellished with an abundance of facilities put together with an eye to detail approach.

Each fragment of this marvel is designed by keeping the everyday routine of a suave family in mind, their demeanours right from the beginning to the end of their day.

Z+ is an endeavour to match the elegance of a neoteric family right from its aesthetic façade to its interconnected terrace for those evening congregations.

The imposing edifice and its precincts are categorized in the following utility area.



06:00 AM

Set your day in motion with wellness

*Being fit has become essential,
now more than ever...*

Kick start your day with our alfresco yoga and fitness
fraternity and unleash the sanity to rule the concrete
jungle outside...

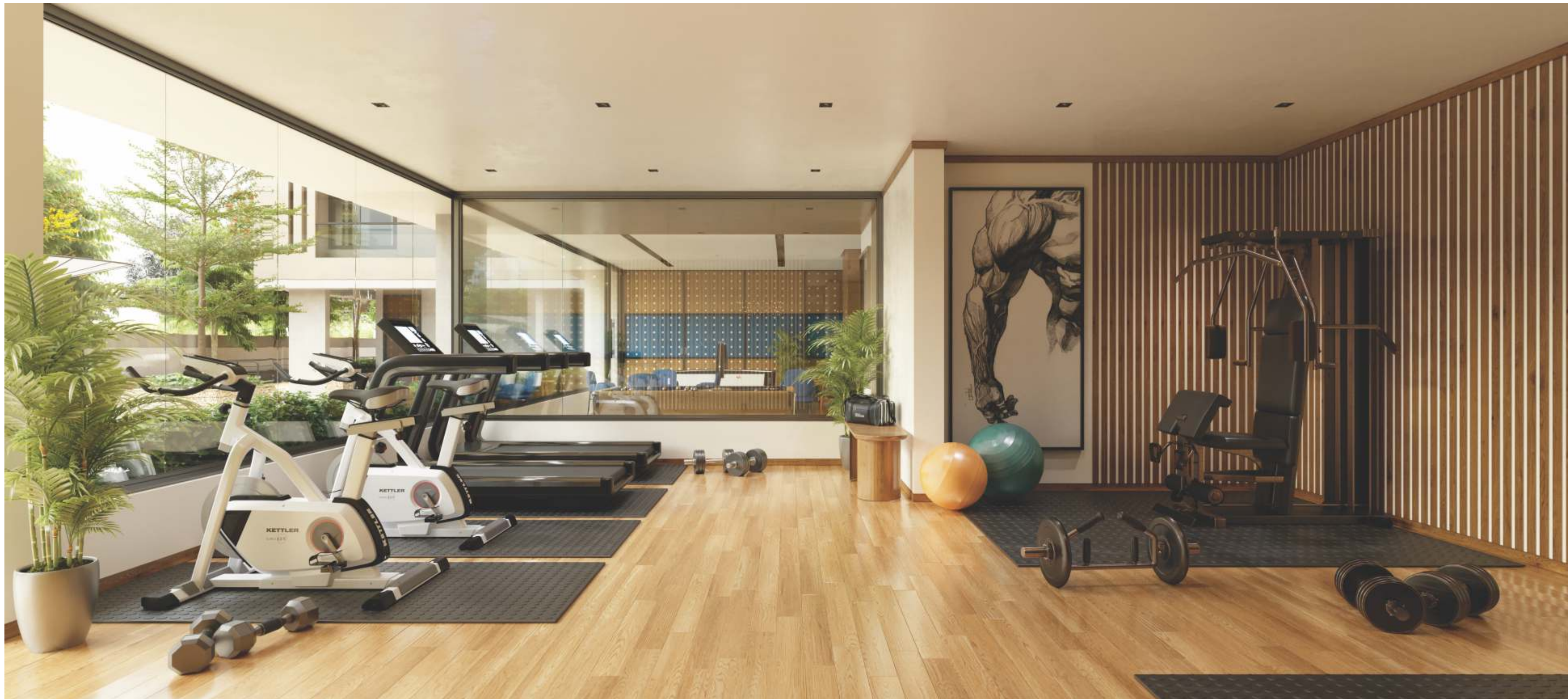

07:00 AM

Our fully equipped indoor gym is sure to become your new Strength dwelling Coz life is better when you're lifting...



08:00 AM

As they say...

"A reader lives a thousand lives before he dies."

Spend a few moments of your morning in the Nirvana Lounge to untangle your scrutiny...



09:00 AM

*By leaving your tiny tots to the
heeds of our toddler castle, you'll
never go off beam at work
worrying about their safety...*



03:00 PM

Outplay those lazy afternoons with an indoor games room clubbed with some chitter-chatter...



05:00 PM

Turf, Swings and Slides...

As Kids don't remember their best days of watching TV...



06:00 PM

Exclusive roller skating rink for your kids

*Because tough times never last...
but tough skaters do...*



The zenith of this realty masterpiece is it's one of its kind interconnected terrace... that not only connects the buildings but also bridges the gap between cosmopolitan manifolds...

A unique terrace promenade adorned with pergolas and porch swings provides a perfect backdrop for those evening socializers with your proximates...

An open-air, multi-purpose court and a cricket pitch for your emerging sports stars...



07:00 PM

Unwind yourself of your stressed working hours with a gym under that painted sunset sky...



08:00 PM

*A multifaceted hall to become a
fulcrum of exuberance and
festivity each evening.*



10:00 PM

Witness the cinematic charisma right in the vicinity of your home with an Avante-gadre mini plex exclusively for the Z+ residents.

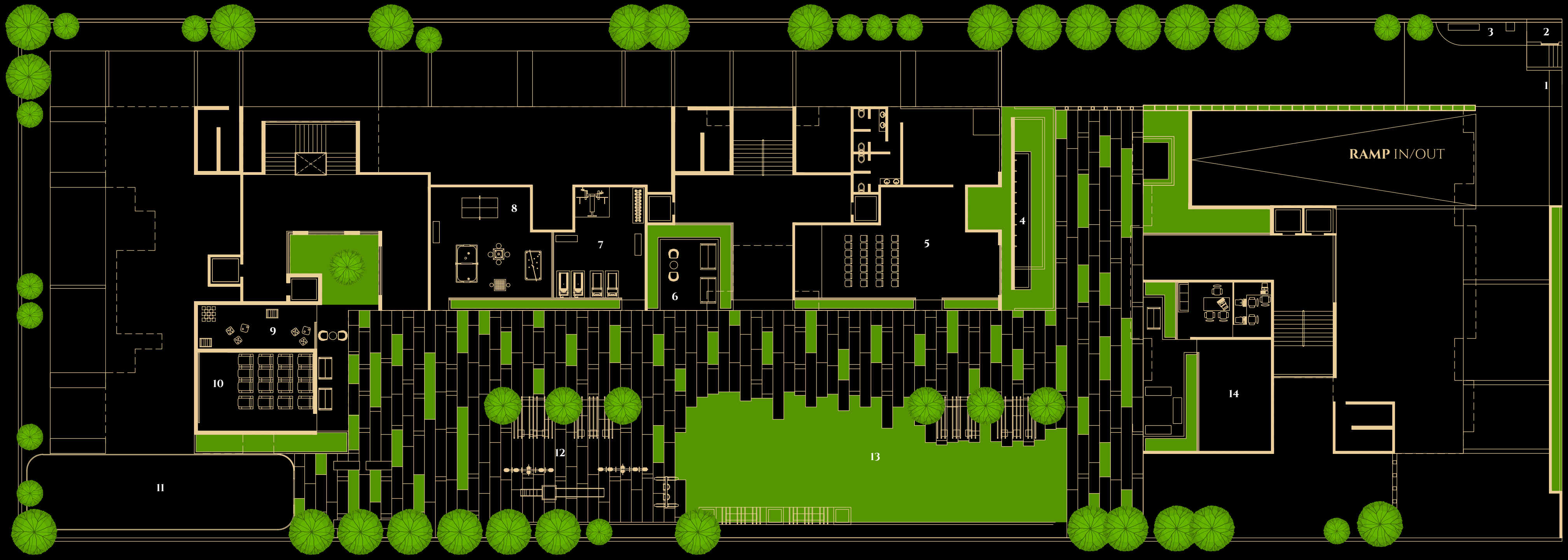

**GROUND FLOOR
LAYOUT PLAN**



ENTRY

18 MT WIDE TP ROAD

- 1. Entrance
- 2. Security Cabin
- 3. Drop Off Zone
- 4. Sculpture With Lilly Pond
- 5. Multi Purpose Hall
- 6. Senior Citizen Seating & Swing Area
- 7. Gym
- 8. Indoor Games Zone
- 9. Toddler Zone
- 10. Miniplex (Theater)
- 11. Skating Rink
- 12. Kids Play Area
- 13. Landscaped Garden
- 14. Yoga and Dance Zone

RAMP IN/OUT

AMENITIES

- Mini Theater
- Entrance Foyer Each Block
- Multi Purpose Hall
- Gym
- Indoor Games
- Sky Walkway
- Toddler Zone
- Library / Reading Area
- Allotted Car Parking
- Allotted Bike Parking
- Visitor's Parking Area
- Yoga Zone
- Drop Off Zone
- Skating Rink
- No Vehicle Zone Landscape Area
- Landscaped Gardens
- Decorative Foyer Area
- Kitty Joint Seating Area Verandah
- Children Play Area
- Double Basement With Sensor Light
- 50% Open Space
- Gazebo
- Community Seating Area
- Only Residential Units
- Society Office
- Security Cabin
- Security Control Room
- Main Door With Veneer
- 24x7 Security
- Space For Electric Sub Station
- Lilly Pond / Water Body
- Open Sky Gym
- Terrace Swing Area
- Box Cricket
- Basketball Court
- Get-together Space on Terrace
- Ambiance Lighting in Garden
- Golf Putting Practice Area
- Common Toilets
- Theme Wall
- Wi-Fi Zone
- Table Tennis
- Carrom Table
- Chess Table
- Pool Table
- Piping of Adani's Gas Line
- Open Kite Flying Area
- Common Car Wash Area
- Wooden Deck Floor Loose Swing
- Open Sky Meditation & Yoga
- Generator For Common Light
- Solar System Common Light
- Event Kitchen
- Meter Room Each Block
- Service Area
- Community Seating Area
- Two Lifts Per Block
- Morden Decorative Elevation
- Broom Finish Timex Road
- Wooden Deck Floor Seating Area
- CCTV Cameras
- Granite Paved Walkway
- Common Toilet
- Water Cascade & Bubbler Fountain
- Chit-chat Area
- No Vehicle Zone Bollard Area
- Renewal Energy
- Near By Shopping Plaza
- SS Railing
- Dance Zone

and many more...

TYPICAL LAYOUT
FIRST TO TOP FLOOR

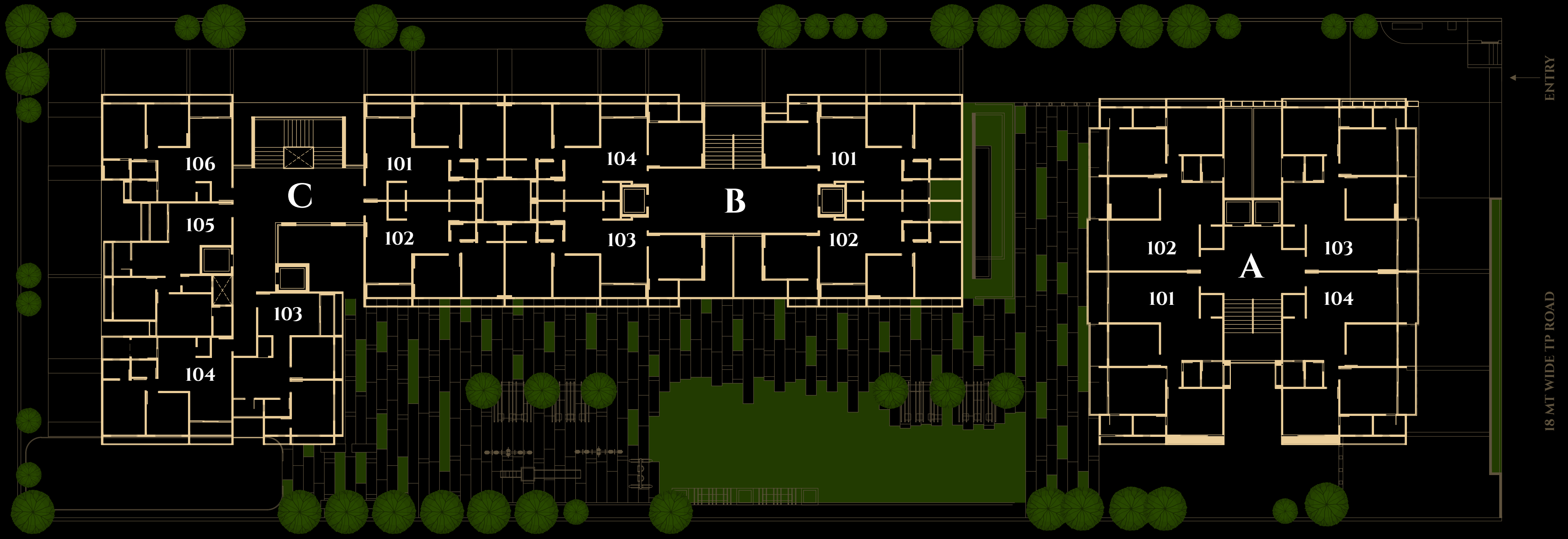

ENTRY

18 MT WIDE TP ROAD





BLOCK A

UNIT 101, 102, 103 & 104
1188 SQ.FT.

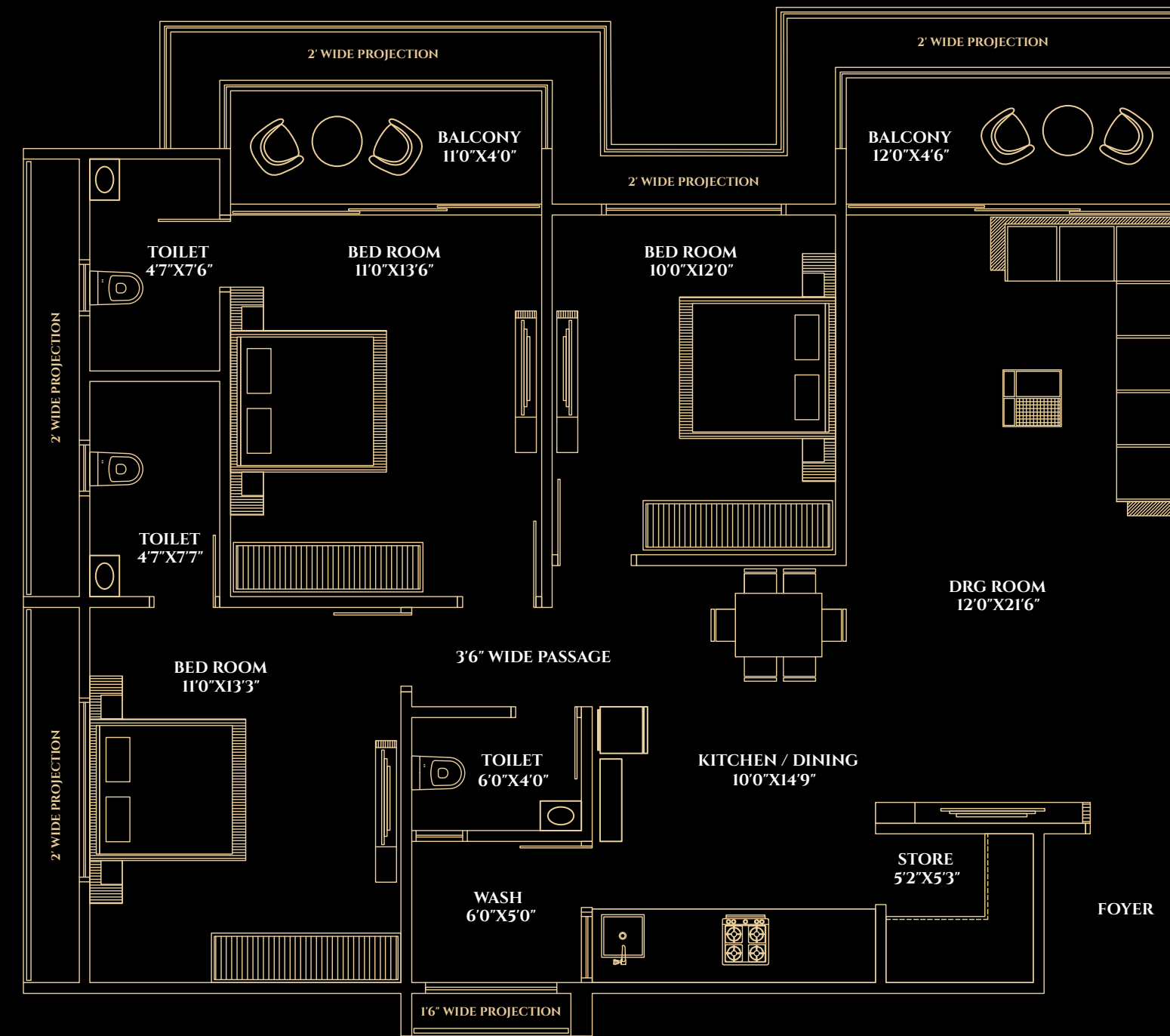



BLOCK B

UNIT 101, 102, 103 & 104
930 SQ.FT.

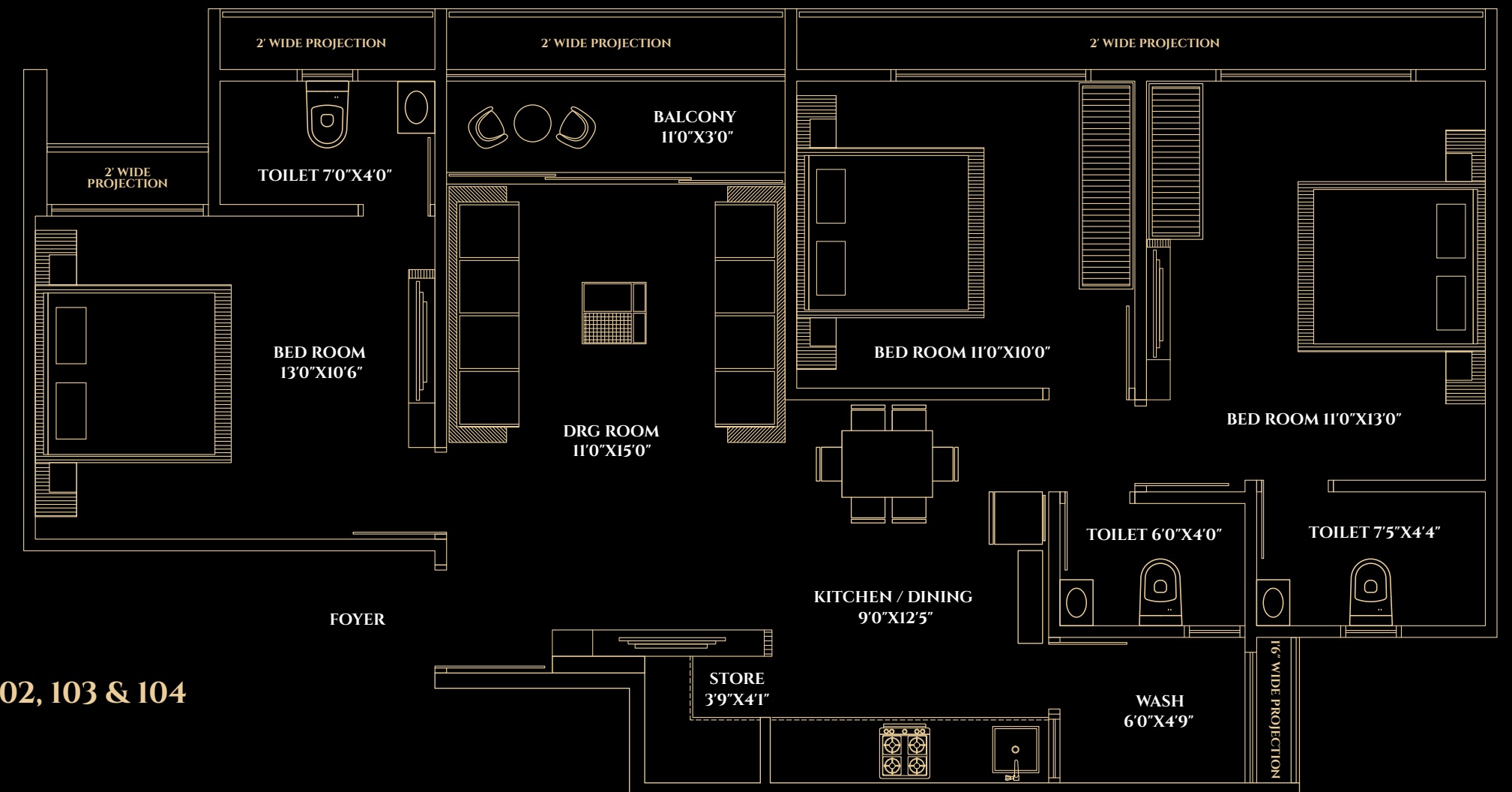
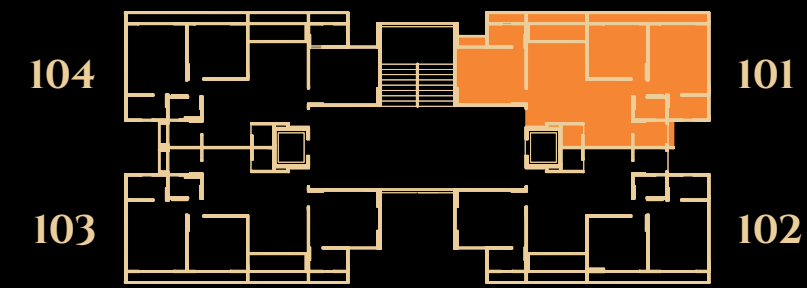



DEWANDAN

SATYA SANKALP

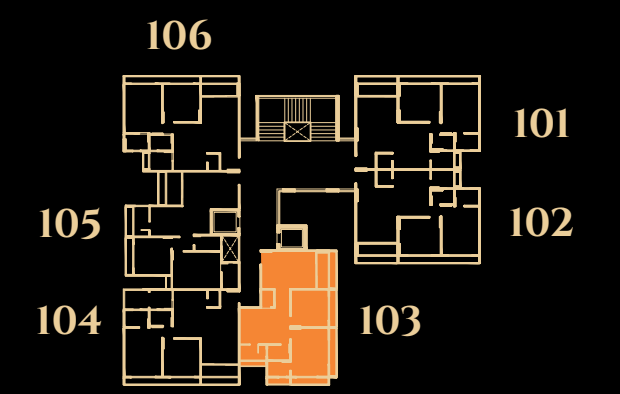
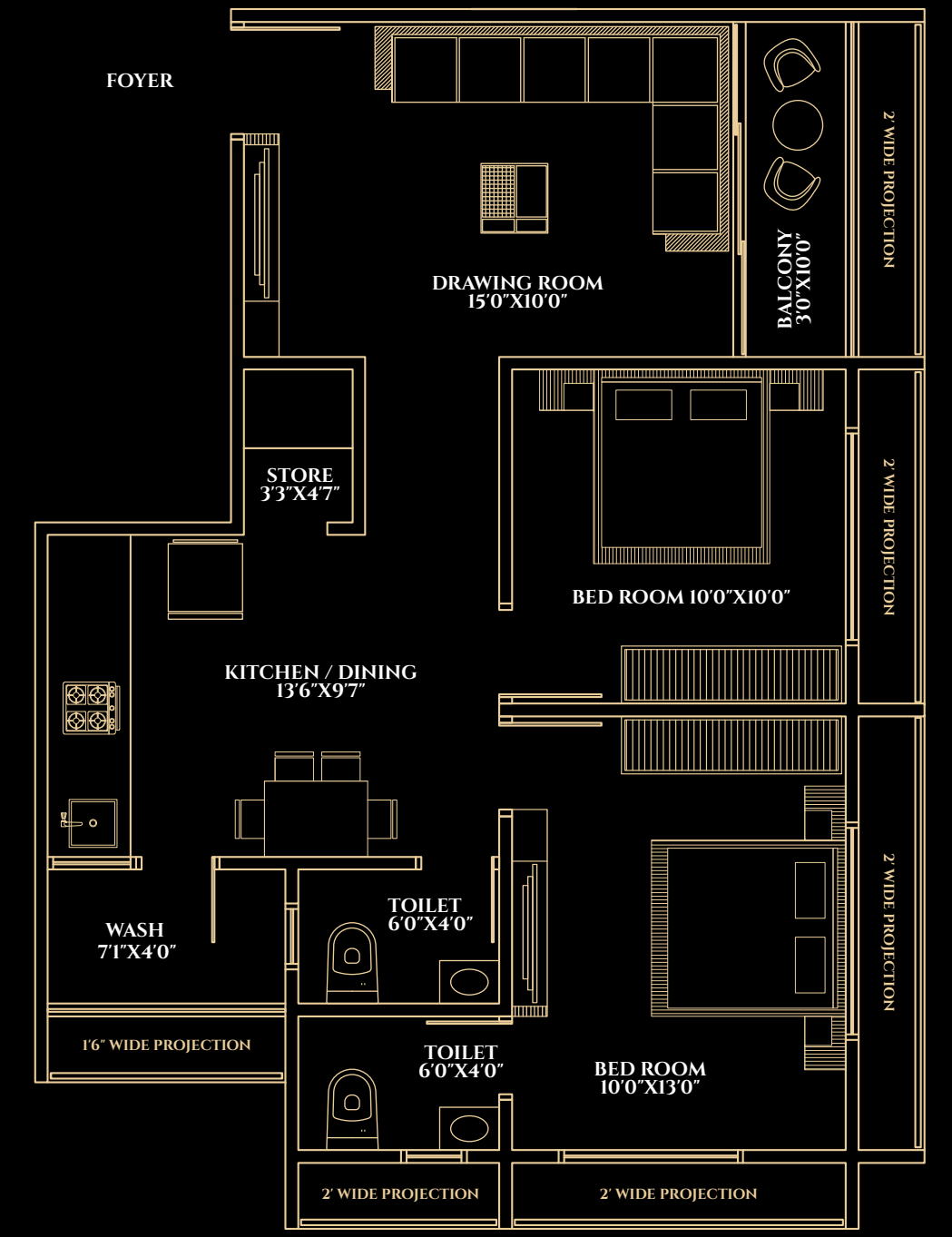
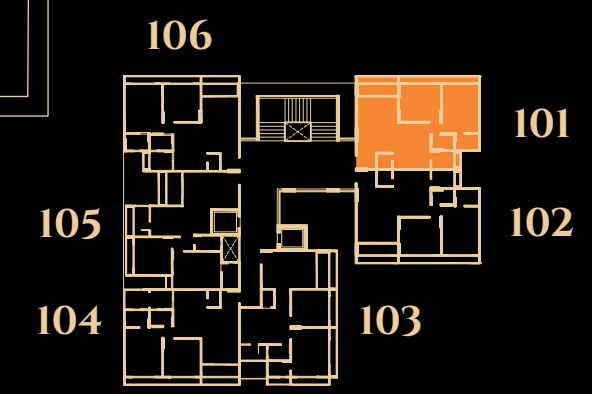
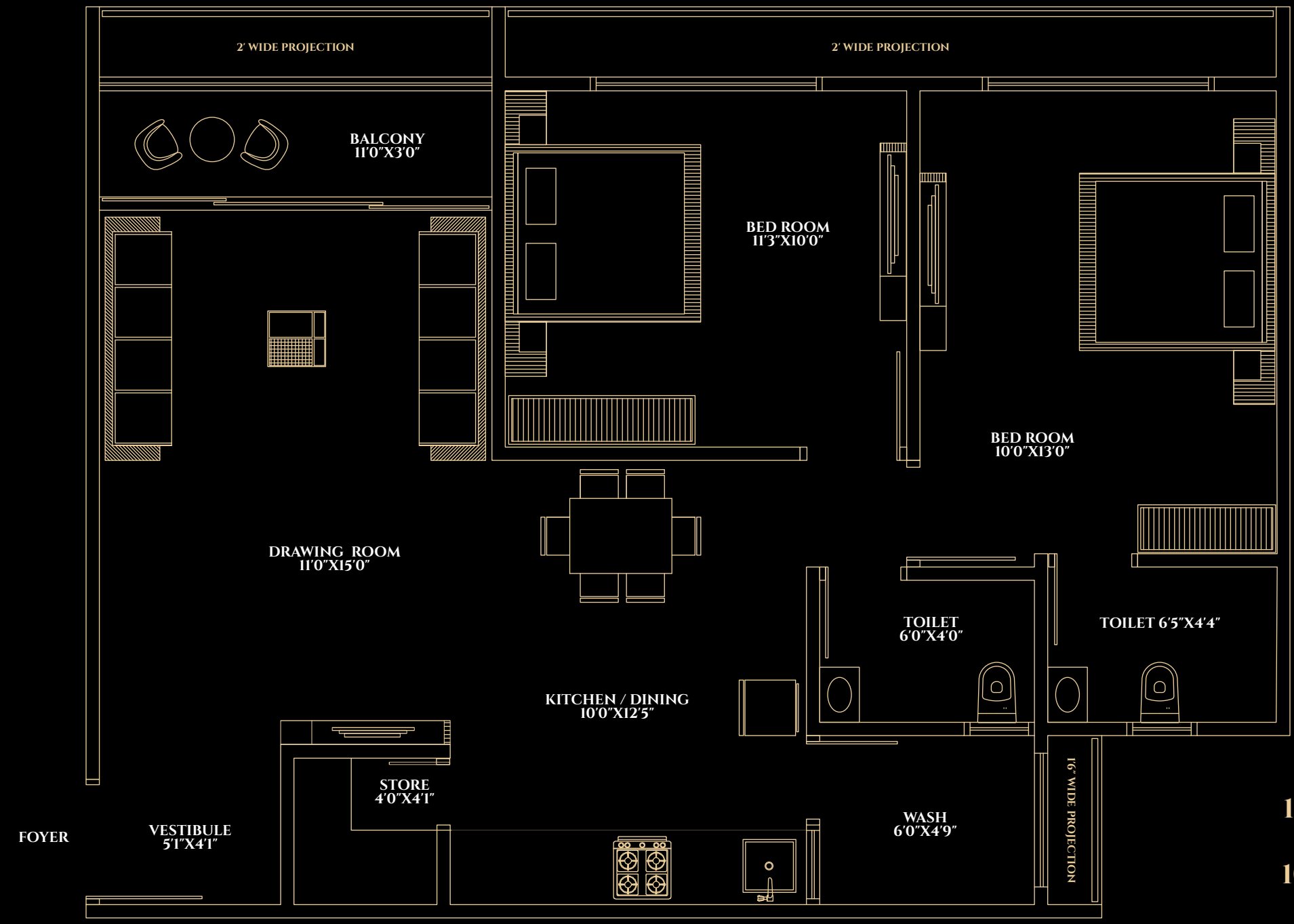

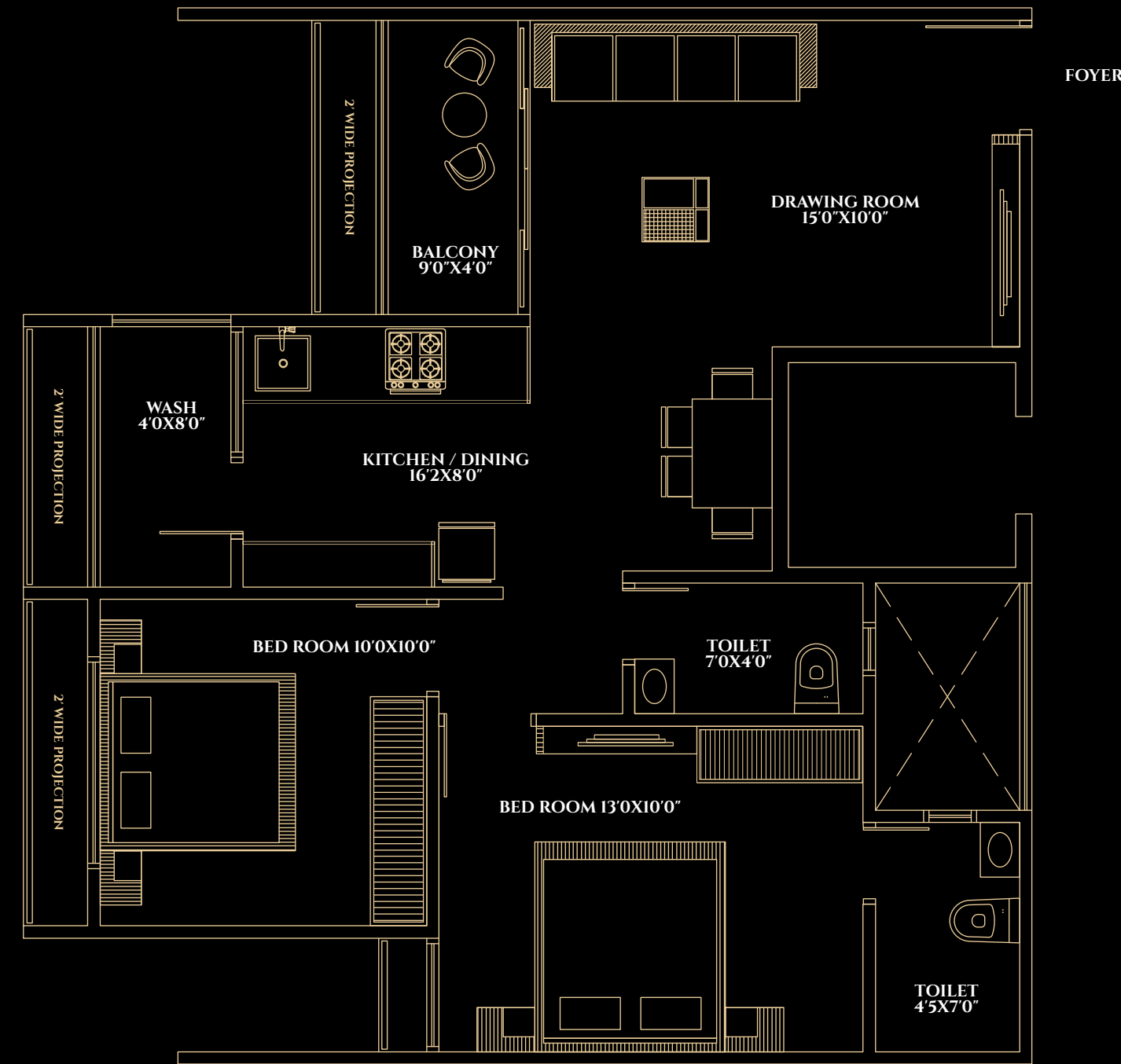
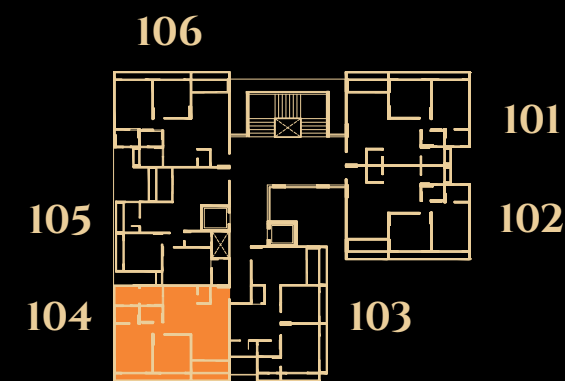
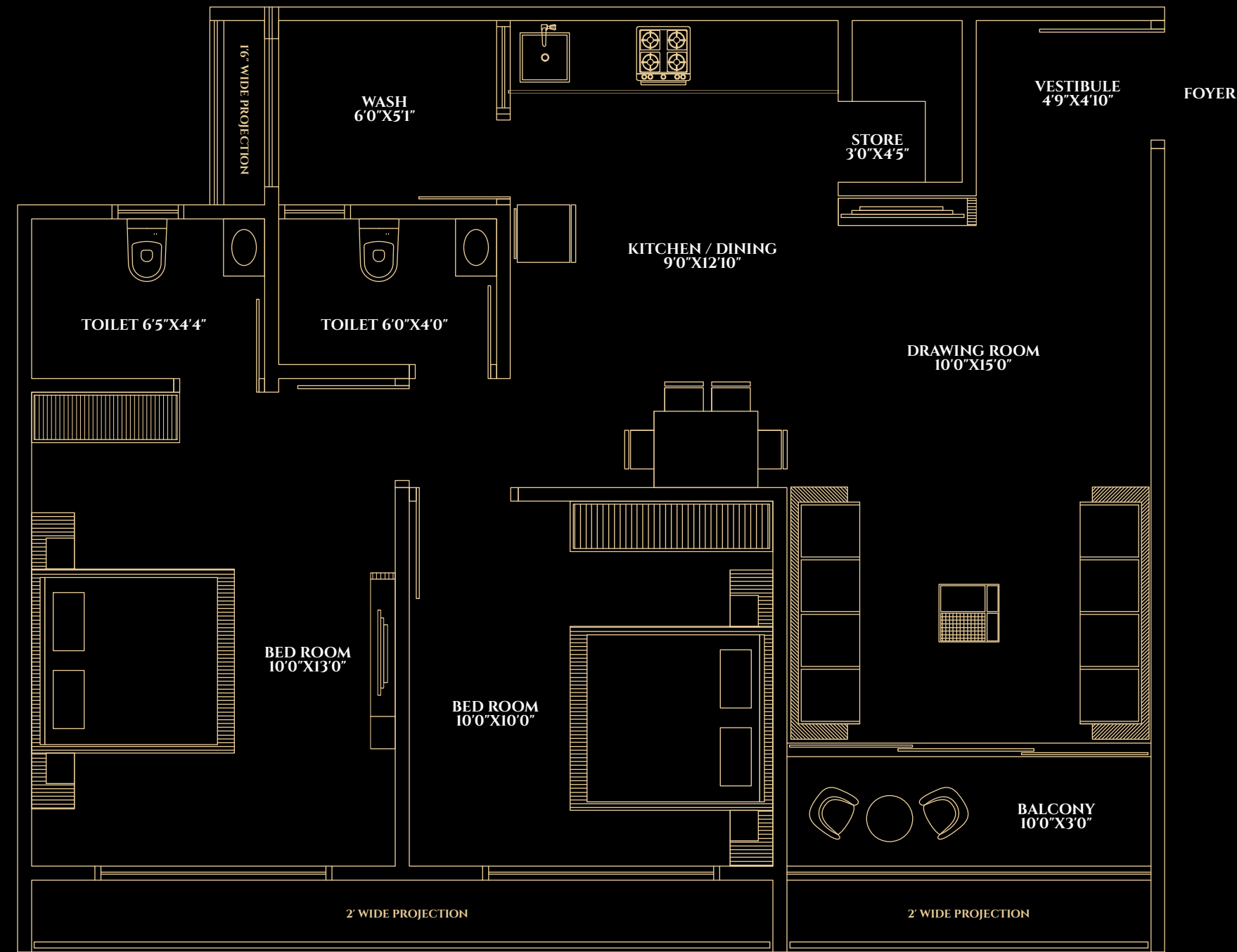



SPECIFICATION

Structure: RCC Framed Structure, Structure Design as per IS Code for Earthquake Resistance

Wall: Internal Wall – Putty over Mala Plaster, External Wall – Double Coat Mala Plaster with Texture Finish

Door: Decorative Main Entrance Door with Veener with Brass Fitting and Fixtures. All Other Doors are Both Side Laminated Flush Door

Window: Aluminum Windows Domal Series with Plain Reflective Glass, and Granite/Marble Jambs

Flooring: PGVT Flooring Size: 1200 X 1800mm in Drawing, Dining, Kitchen and all bedrooms. All bathroom Flooring Size 600 X 1200mm

Kitchen Platform: PNG Line, Marble Finish Kitchen Platform, SS Sink, Electrical Points for Microwave, Mixture, Water Purifier and Washing Machine

Plumbing: ISI UPVC and CPVC Premium Quality Pipes and Fittings Plumbing & Drainage Work

Sanitary: Premium Quality Faucet, Tap and Diverter in each Bathroom/Toilet Wall Mounted Toilet for Better Utility

Electrical: Concealed Copper flexible ISI wiring, MCB & ELCB as per Requirements, Branded Power Generator, Double Wiring for Invertor Provision, Sufficient Electric point with modular switches

Terrace: Durable water Proofing with China mosaic flooring for heat reflection and water resistance























Renewable Energy: Solar System As per Rules

Fire: Fire Safety System as per Government Rules

Lift & Capacity: 8 Passenger Automatic Lifts



BRANDS

- STEEL   FE500 STEEL
- CEMENT  JK LAKSHMI  UltraTech  Rishi
- PAINT  asianpaints  Berger
- PLUMBING  ASTRAL PIPES  ashirvad
- ALUMINUM WINDOWS  Domal Type
- ELECTRIC WIRE   RR  SYSKA
- MODULAR SWITCHES  Hi-Fi  fybrus 
- SANITARY WARE  jaguar  CERA  VARMORA
- LIFTS  KRUPA ELEVATORS  TRIO  OMEGA ELEVATORS EXPRESS

OR EQUIVALENT BRAND*



STRATEGIC LOCALE

Paying heed to all prerequisites of the modern family, Z+ is located in the heart of the urbanized sprawls of Naroda. With barely a brisk away from the SP Ring Road, the locale still manages to be the centrepiece of accessibility.

Hospital	School/Preschool	Shopping Center & Mall	Multiplex
Pramukh Hospital 1 K.M 2 Min	The South International School 1 K.M 2 Min	D - Mart 500 M 1 Min	New Rajhans Multiplex 3 K.M 5 Min
Shalby Hospital 2 K.M 2 Min	Aditya International School 2 K.M 2 Min	M - Mart 3 K.M 5 Min	Devi Multiplex 4 K.M 5 Min
Vedant Hospital 2 K.M 2 Min	Divine Life International School 3 K.M 5 Min	Pancham Shopping Center 3 K.M 5 Min	Rajhans Cinema 5 K.M 10 Min
Life Care Hospital 2 K.M 2 Min	Little Child School 3 K.M 5 Min	Jp Complex 3 K.M 5 Min	Miraj Cinema 6 K.M 10 Min
Apex Hospital 3 K.M 5 Min	Aatmiya School 3 K.M 5 Min	D - Mart Nikol 4 K.M 5 Min	Cineworld 7 K.M 10 Min
Uma Hospital 3 K.M 5 Min	Shri TS Patel School 3 K.M 5 Min	Pavillion Mall 5 K.M 10 Min	
Vikas Hospital 3 K.M 5 Min	C.M Thaker High School 3 K.M 5 Min	National Handloom 5 K.M 10 Min	
Rainbow Hospital 3 K.M 5 Min	St Mary's School 4 K.M 5 Min	Just Price 5 K.M 10 Min	
Om Women's Hospital 3 K.M 5 Min	Devasya International School 4 K.M 5 Min		
Nilam Hospital 3 K.M 5 Min	Vedant International School 4 K.M 5 Min		
		Near By Me	Banks
		S,P Ring Road 500 M 1 Min	HDFC Bank 1 K.M 2 Min
		AMTS Bus Stand 3 K.M 5 Min	Axis Bank 1 K.M 2 Min
		BRTS Bus Stand 3 K.M 5 Min	IDBI Bank 2 K.M 2 Min
		Railways Station 10 K.M 15 Min	Yes Bank 3 K.M 5 Min
		Airport 10 K.M 15 Min	SBI Bank 3 K.M 5 Min
		Metro Station 10 K.M 15 Min	Kotak Bank 2 K.M 2 Min
		Express High Way 12 K.M 15 Min	BOB Bank 3 K.M 5 Min
			BOI Bank 3 K.M 5 Min
			LIC of India Branch 3 K.M 5 Min
Picnic Spot	Temples		
Mini Kankariya 3 K.M 5 Min	SMVS Swaminarayan Temple 2 K.M 5 Min		
RD'S Club 3 K.M 5 Min	Padmavati Jain Derasar 3 K.M 5 Min		
Auto Car Museum 4 K.M 5 Min	Radha Soami Satsang Beas 4 K.M 5 Min		
Beti Bachao Garden 5 K.M 10 Min	Shree Mahaprabhuji Ki Bethak 3 K.M 5 Min		
	ISKCON Temple 5 K.M 5 Min		

GEB, AMC, GST document and any other government taxes & levies to be born by the member. In the interest of continual developments in design & quality of construction, the developer reserves all the rights to make any changes in the scheme including technical specifications, designs planning - layout and the purchaser shall abide by such changes. Irregular payment shall cause cancellation of booking. In the case of cancellation, 20% service charge of the total amount paid shall be levied and balance payment shall be made only after the next available booking of the said unit. Electricity substation and cable charges, AMC, Stamp duty, Legal Charges, Other Tax, Labour Cess, Narmada Water Connection & charges related to maintenance will be levied extra. Possession of the Apartment shall be given 30 days after full payment. Changes/alteration of any nature including the elevation, exterior colour scheme of the apartment or any other change affecting the overall design concept and outlook of the scheme are strictly NOT PERMITTED during or after the completion of the scheme. Detail and dimensions in model and brochure are indicative and for the tentative representation only which should not be treated as legal document and/or consumer contract. Size mentioned in the unit plan are Brick to Brick and may have variation of 1-2 inch due to plaster and size of block. Variation in shades & size likely in Vitrified & Glazed tiles due to constraints of manufacturing and availability. The terms and condition of the booking form will be considered as final and abide to Member.