



# DOLLARS COUNTY



**Dollars County stands as a testament to architectural elegance and natural beauty. You are immediately enveloped in an atmosphere of opulence and luxury the moment You step inside and sets the tone for the luxurious experience that awaits.**

**The villa boasts spacious living areas, meticulously designed to blend comfort with sophistication. The living room, bathed in natural light streaming invites you to unwind.**

**The villa is a haven of relaxation and entertainment, offering an array of amenities to cater to every whim. As night falls, the villa transforms into a magical sanctuary, illuminated by its architectural splendor of a place called Home.**

**Dollars County is not just a villa; it's a sanctuary where time stands still, and every moment is infused with a sense of wonder and enchantment. Whether you seek solitude or adventure, relaxation or excitement, this extraordinary retreat offers the perfect canvas for creating timeless memories.**

**Experience the epitome of luxury living at Dollars County, where every indulgence is catered to and every desire fulfilled. Welcome to the Paradise.**



<b>6</b> Years of Excellence	<b>130+</b> Completed Projects	<b>35+</b> Ongoing Projects	<b>1900+</b> Happy Families
------------------------------------	--------------------------------------	-----------------------------------	-----------------------------------

# Street View



VILLA 03  
DOLLARS COUNTRY

VILLA 03  
DOLLARS COUNTRY

# Front View





# Villa 1A



## Ground Floor



## First Floor

Villa No	Area	Plot Area
1A	1664	921

# Villa 1B, 1C, 1D, 1E, 1F



**Ground Floor**



**First Floor**

Villa No	Area	Plot Area
1B	1671	963
1C	1671	981
1D	1671	997
1E	1671	992
1F	1671	946



# Villa 1G



## Ground Floor

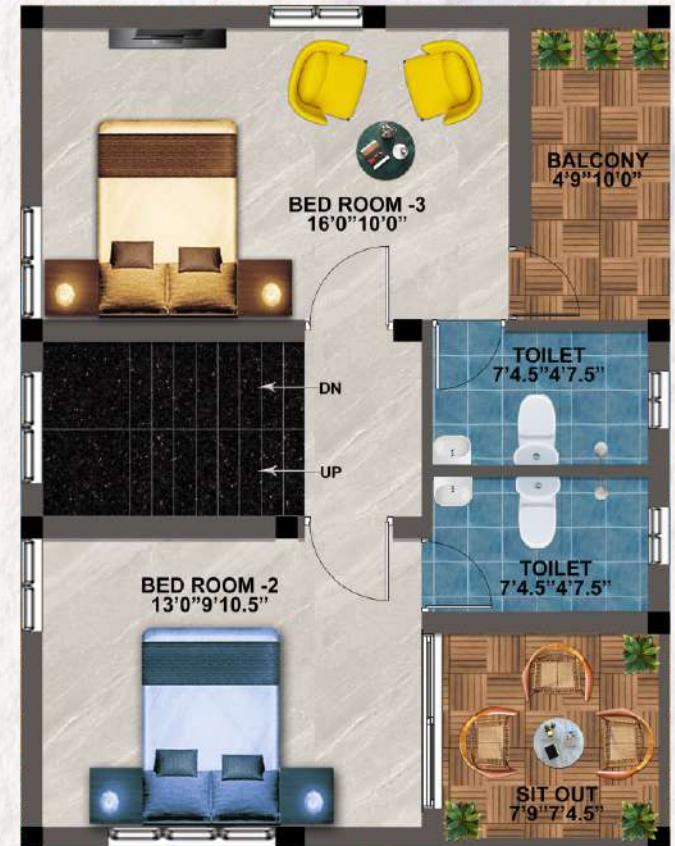

## First Floor

Villa No	Area	Plot Area
1G	1671	891

# Villa 2G



## Ground Floor



## First Floor

Villa No	Area	Plot Area
2G	1735	990



# Villa 3B, 3C, 3D, 3E, 3F



**Ground Floor**



**First Floor**

Villa No	Area	Plot Area
3B	1735	1052
3C	1735	1000
3D	1735	978
3E	1735	953
3F	1735	953



# Villa 4C, 4E



## Ground Floor



## First Floor

Villa No	Area	Plot Area
4C	1695	963
4E	1695	1055



# Villa 4G, 4F

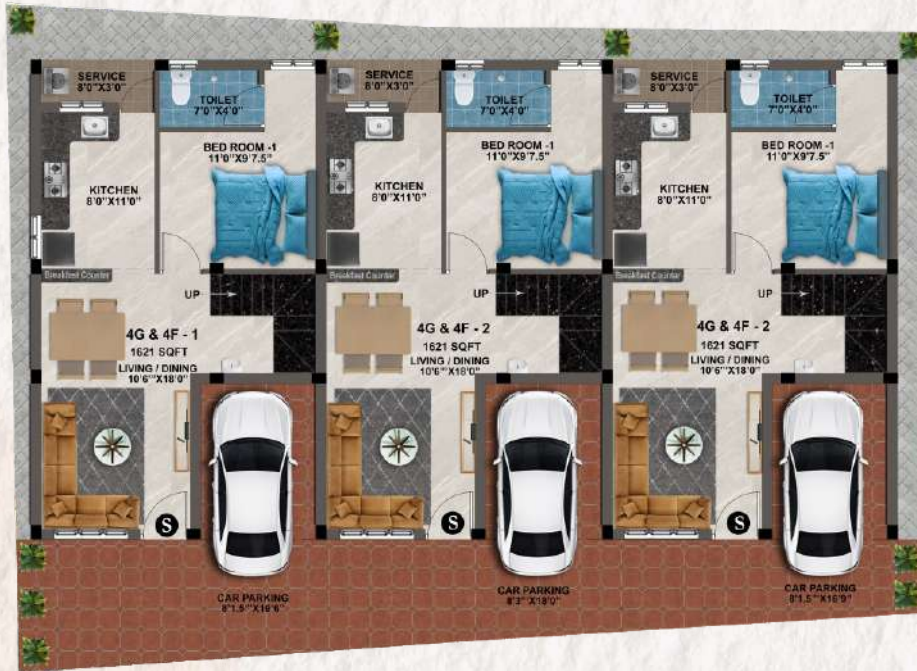

## Ground Floor



## First Floor

Villa No	Area	Plot Area
4F & 4G - 1	1621	931
4F & 4G - 2	1621	931
4F & 4G - 3	1621	931



# Site Map

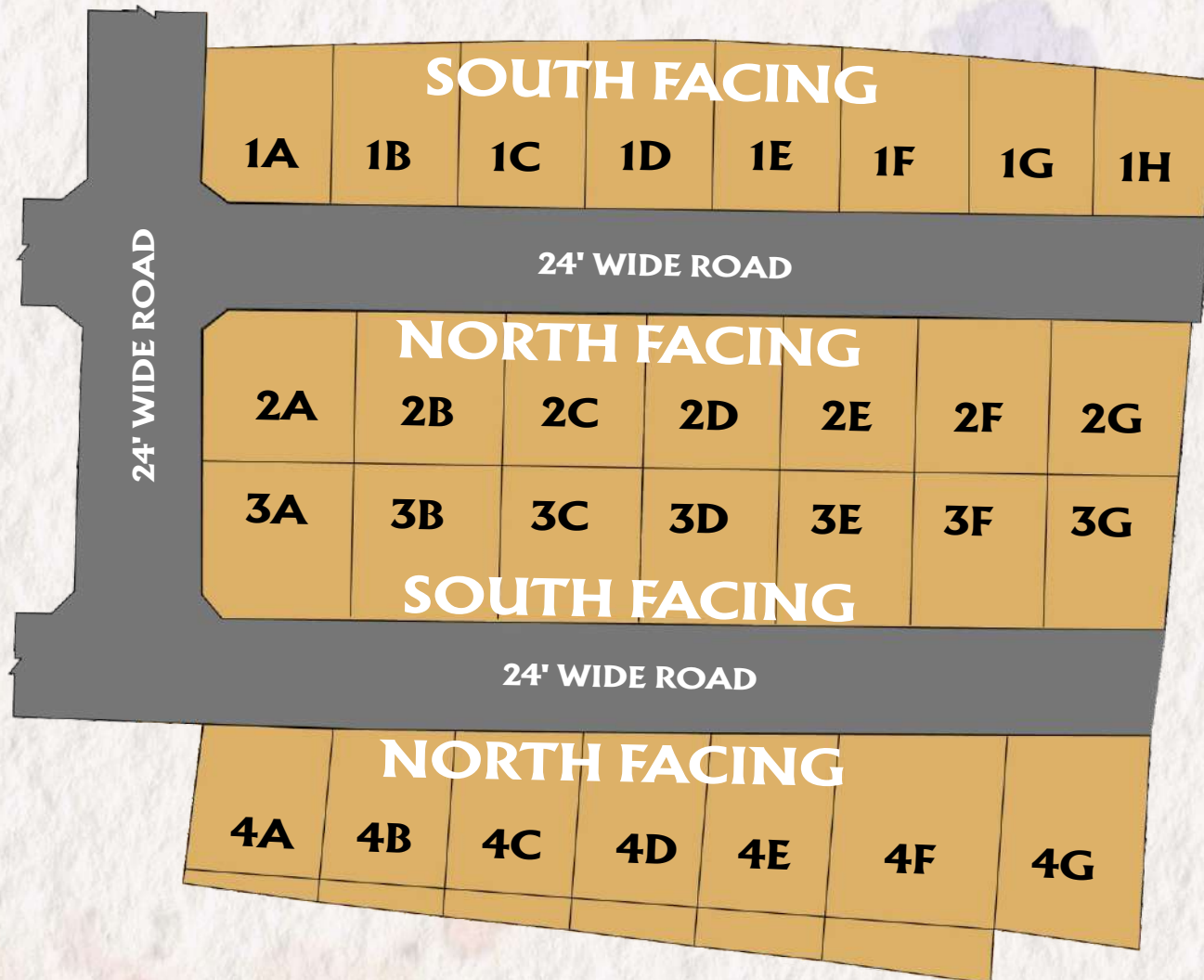

# Amenities



**Digital Door  
Lock**



**100% Vaastu**



**Potable Water**



**Covered Car  
Parking**



**Terrace Cooling  
Tiles**



**EV - Charging  
Point**

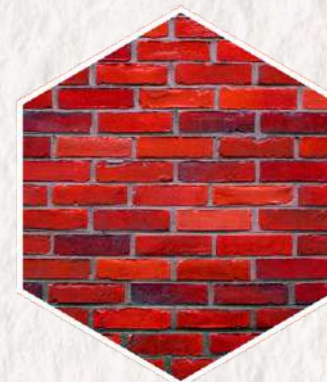

**Red Bricks**

# Specifications

## Exterior/Interior Finishes

### ❖ Living/Foyer/Dining

Flooring - 4'X2' Vitrified tiles ISO Certified

Walls - Finished with 2 coat wall Putty,  
1 Coat Primer, 2 coat color - Asian\*  
or Equivalent brand

### ❖ Bedroom

Flooring - 4'X2' Vitrified tiles ISO Certified

Walls - Finished with 2 Coat a wall Putty,  
1 Coat Primer, 2 Coat color - Asian\*  
or Equivalent brand

### ❖ Toilet

Flooring - Anti skid Ceramic Tiles (Orient Bell  
or Equivalent)

Walls - Glazed tile upto 7'0" from floor  
level

Fixtures - Parryware or Equivalent\* - CP  
Fittings & Sanitary ware

### ❖ Passage or Lobby area

Flooring - Tiles 1' x 1'

### ❖ Windows - UPVC sliding windows with safety grills

### ❖ Kitchen

Flooring - 4'X2' Vitrified tiles ISO Certified

Walls - Glazed tile 2'0" above counter

Counter - Well polished G10 Black Granite  
counter top

Sink - Ceramic

### ❖ Doors

Maindoor - 2nd quality Teakwood wooden door

Bedroom - Patterned Skin door panel  
with Enamel Coating

Toilet - WPC waterproof door

### ❖ External

Walls - Asian paint or Equivalent

### ❖ Car Parking

Flooring - Anti skid Tiles, Standard Size 1' x 1'

### ❖ Staircase

Flooring - Granite

Railing - SS Handrailing

# Specifications

## Electrical Points

(Norwood / Equivalent Switches and Orbit Wires)

- ❖ **Living/Foyer/Dining:** 2 Light Point , 2 Fan Point ,  
1 TV Power point,  
1 Cable point(with wire),  
1 Telephone point(without wire),  
Home theater provision,  
5Amps charging point,  
1USB charging point.
- ❖ **Kitchen:** 1 Light point, 1 Exhaust Fan point,  
2-15 Amps point, 2-5 Amps point,  
RO provision.
- ❖ **Toilet:** 1 Light point, 1 Exhaust Fan point, 1 Geysor Point.
- ❖ **Bedroom:** 2 Light Point, 1 Fan Point ,  
1-5 Amps charging point, 1 AC Point.
- ❖ **Entrance/Verandah:** 1 Light point, 1 Calling bell point.
- ❖ **Inverter:** Wiring-Living-1 No.Fan, Light, Bedroom-1 No. Fan,  
Light, Kitchen-Light, Kitchen-1 light.

- ❖ **General Points:** Washing machine point,  
Refrigerator Point.
- ❖ **Car Parking:** EV Charging point .

## General

- ❖ **Walls(9"/4.5") - Chamber Burnt Red Brick Wall**
- ❖ **Septic Tank - 8,000 Liters Capacity**
- ❖ **Maindoor Lock - Digital lock**
- ❖ **CCTV - Common**
- ❖ **Safety Gate - Safety Grill Gate**
- ❖ **Over Head Tank - 1000 Liters Capacity Sintex Tank**
- ❖ **Head Room - WPVC Door with Grill Gate**
- ❖ **Car Parking Gate - MS frame with wood finish**

<b>PAYMENT SCHEDULE</b>	<b>STAGE</b>
<b>Booking Advance</b>	<b>4%</b>
<b>15 Days from Date of Booking - Agreement</b>	<b>15%</b>
<b>On Completion of Ground Floor Roof Slab</b>	<b>18%</b>
<b>On Completion of Second Roof Slab</b>	<b>15%</b>
<b>On Completion of Brickwork</b>	<b>15%</b>
<b>On Completion of Plastering</b>	<b>15%</b>
<b>On Completion of Flooring</b>	<b>14%</b>
<b>On Completion of Villa</b>	<b>4%</b>
<b>TOTAL</b>	<b>100%</b>

# The Neighbourhood For Everyone In Your Family

## SCHOOL'S & COLLEGE'S

- Kalama Paati Play School - 400 Meters
- Peace on Green Earth Public School - 400 Meters
- Shivanthi Public School - 1.5 Meters
- Vivekanda Vidyalaya School - 2 Kms
- Govt Hr.Sec.School Anakaputhur- 2.3 Kms
- Madha Arts and Science College - 3.7 Kms
- Madha Dental College - 5.2 Kms

## PUBLIC FACILITIES

- Temple, Mosque & Church - 100 to 1.2 Meters
- Super Markets - 500 to 900 Meters
- Pallavaram Police Station - 1.5 Kms
- Pallavaram Bus Stand & Railway Station - 1.6 Kms
- Gym & Fitness Centre - 400 Meters
- Airport & Metro - 5.5 Kms

## HOSPITALS

- Anakaputhur Primary Health Center - 1.9 Kms
- Madha Medical Hospital - 3.4 Kms
- Kovur Kanaga Hospital - 3.8 Meters
- Sri Lakshmi Child Care Center - 3 Kms
- Sankara Eye Hospital - 4.6 Kms
- Muthukumaran Medical Hospital - 4.6 Kms





GROUND FLOOR PLAN

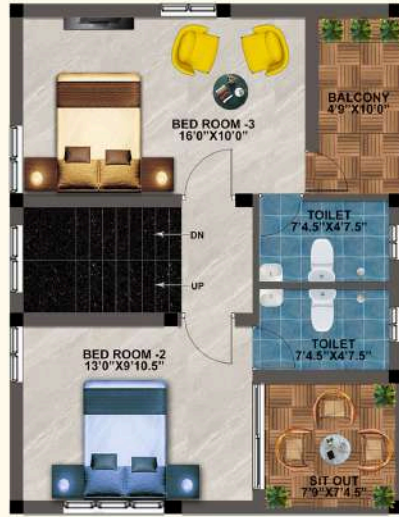

FIRST FLOOR PLAN



Row 1 - (Builtup Area 1664, 1671, & 1511 Sqft - 8 Villas)



GROUND FLOOR PLAN



FIRST FLOOR PLAN



Row 2 & 4 - (Builtup Area -1735, 1684, 1695 Sqft - 12 Villas)



GROUND FLOOR PLAN



FIRST FLOOR PLAN



Row 3 - (Builtup Area 1735, 1671 Sqft - 7 Villas)



## Our Bankers



360° View



[www.mpdevelopers.com](http://www.mpdevelopers.com)

