

ANJ | ANANDA

INTRODUCING **ANANDA**



A Residential Marvel That Bonds
Connectivity And Lavish Living Together Effortlessly.

Masterfully crafted in the metropolitan utopia of Mahim West,
Ananda provides everything you desire in a home. Be it the city centre
or a calm, setting sun over the sea with the views of Bandra-Worli Sealink,
Ananda elevates your standard of living.

“THEY SAY **HOME**
IS WHERE THE HEART IS...”

So we connect you to the heart
of the city, to present you with
a place you can call home.



BREATHTAKING VIEW OF
BANDRA-WORLI
SEALINK





Stock Image



Stock Image



Stock Image

Crafted Luxury



CCTV Surveillance System



Air-conditioned Fitness Centre



Solar Panel



5-Storey Parking Space



Stretcher Size Lift



Podium Parking with EV Charging Point



Stock Image

Rooftop Amenities

Experience elevated leisure with our thoughtfully designed rooftop amenities, perfect for every age and interest. Let children explore and play in a safe, open-air kids zone, while adults unwind in the cozy gazebo or find peace in the serene yoga space. As the day turns to night, the star-gazing deck invites you to marvel at the wonders above, making every evening unforgettable. This rooftop is more than an amenity; it's a space for relaxation, connection, and a touch of magic under the sky.

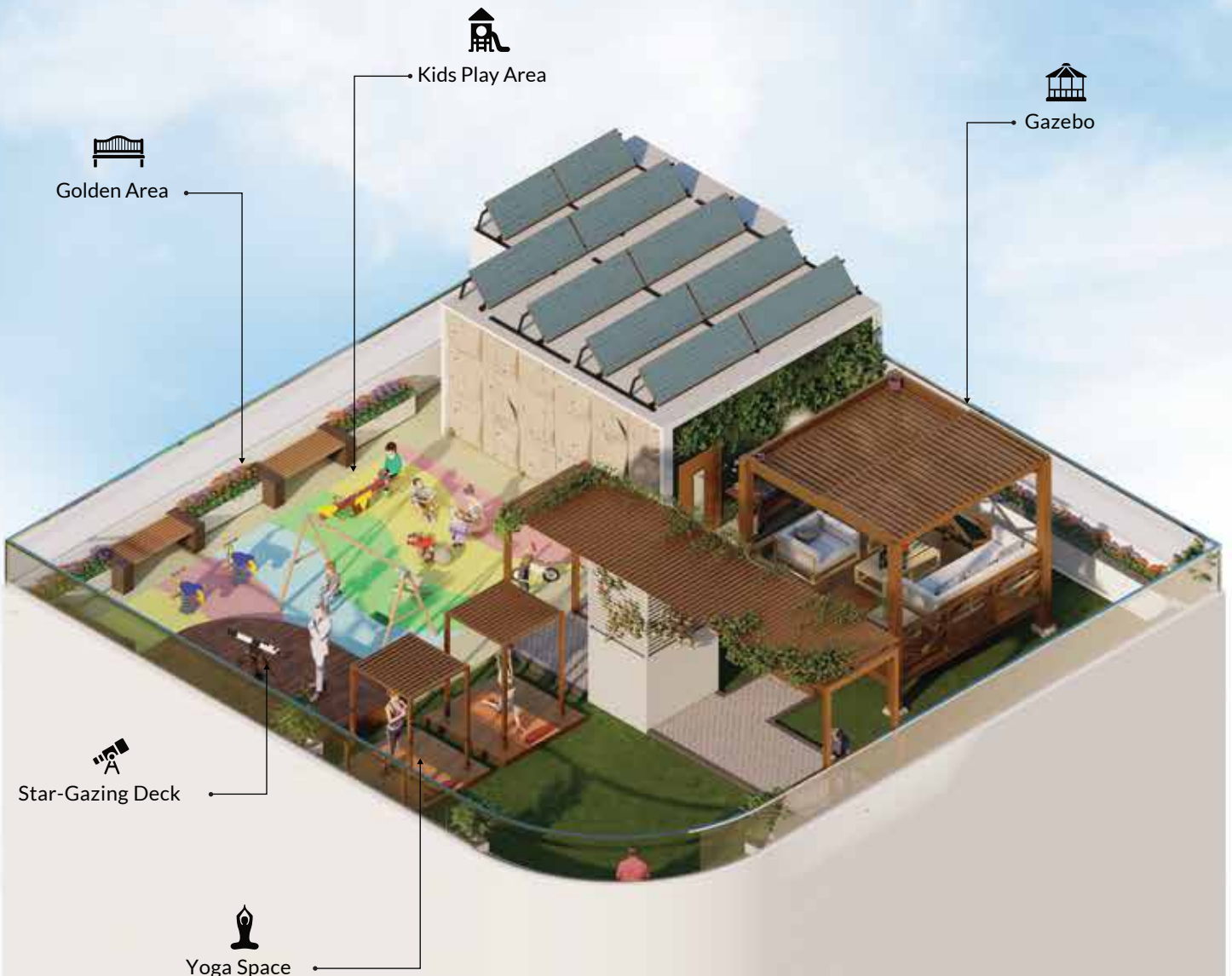



Artist's impression



Stock Image

Internal Amenities



Vitrified Tiles
Flooring



Granite Kitchen
Platform with
Branded SS Sink



Premium Sanitary
Fixture and
CP Fittings



Electrical
Switches







Powder Coated
Aluminium Windows



Intercom



KEY LOCATIONS

-  BKC- 6.3km (15mins)
-  Eastern Express Highway
3km (10mins)
-  Western Express Highway
1.9km (8mins)
-  Siddhivinayak Temple
3km (12mins)

CONNECTIVITY

-  Dadar Station- 2.7km (10mins)
-  Matunga Road Station-
0.9km (4mins)
-  Mahim Station- 0.5km (4mins)
-  Airport- 8.4km (17mins)
-  Aqua Line Shitladevi Metro Station -
0.35Km (3mins)



Stock Image

MALLS

- 🏢 Jio Garden-
5.5km (18mins)
- 🏢 Phoenix Mall-
6.4km (15mins)
- 🏢 Nakshatra Mall-
2.2km (8mins)



Stock Image

SCHOOLS

- 🏫 Bombay Scottish School-
1km (5mins)
- 🏫 Victoria High School-
290m (2mins)



Stock Image

HOSPITALS

- ✚ Hinduja Hospital-
1.3km (4mins)
- ✚ SL Raheja Hospital-
1.7km (5mins)

Location Map



Scan for Google Location



Disclaimer: The specifications and other details herein are only indicative, and the Developer/Lessee reserves the right to change any or all of these at its / their sole discretion. All maps, images and views are indicative of architect's impressions and may not be to scale and are for illustrative purposes only. Proposed infrastructure are presently proposed by the Government of Maharashtra and the change in the policy, rule or notification of the Government of Maharashtra as regards the same. This document is purely conceptual and does not constitute an offer and/or a contract of any type between the Developer/Lessee & the recipients and acquisition in this Project shall strictly be governed by the terms and conditions of the Agreement to be executed between the parties. *Terms & Conditions Applicable.



ANJ

Typical Floor Plan

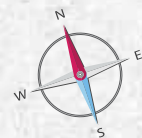

2 BHK- Large

	Sq. Mt.	Sq. Ft.
RERA Carpet	68.06	732.60

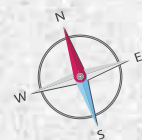
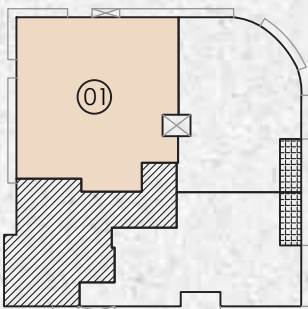

2 BHK- Medium

	Sq. Mt.	Sq. Ft.
RERA Carpet	49.51	532.93
Deck	2.81	30.25
Total Area	52.32	563.18

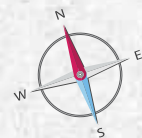
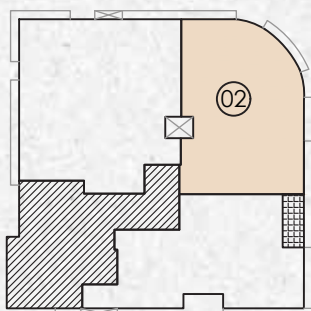

2BHK Affordable - With Deck

	Sq. Mt.	Sq. Ft.
RERA Carpet	46.92	505.05
Deck	2.81	30.25
Total Area	49.73	535.3

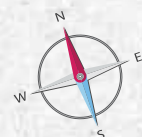
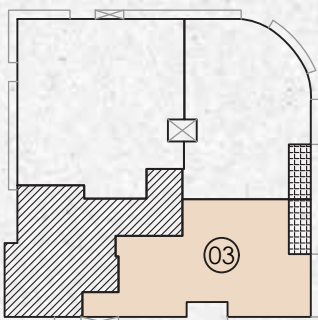

Project By:



Site Address: Ananda CHS Ltd. (Bhaskar Mansion) F.P. 339,
33J Shitladevi Temple Road, Mahim (W), Mumbai- 400 016

Head Office Address: Unit No. 323, Omega Business Park, Opp. D Mart Corporate
Office, Road No.16Z, Wagle Estate, Thane (W) - 400 604

Contact: 8879900066

Email: sales@groupanj.in



Maharera Reg. No.P51900077239
<http://maharera.maharashtra.gov.in>

Architect:
M/s Dezino Estudio

Developer:
M/s A N J Recon LLP

RCC Consultant:
**M/s Vinayak Chopdekar
& Associates**

Legal Advisor:
Mr. Tejas Doshi

DISCLAIMER: The information provided in this advertisement, including all pictures, images, plans, drawings amenities elevation, dimensions, illustration, facilities features, specification and other information etc. mentioned, is the indicative kind of development that is proposed and subject to approvals from the competent authorities. Floor Plans, pictures, visuals, prospective views of the building, model furniture, maps are artist conception and not the actual. Actual area of the apartment will Vary +/- 3%. *1 sq. mt. =10.764 sq.ft. "T&C apply Location specified herein is schematic and not as per actuals.