



**Distance from various landmarks**

- ☑ 3 min drive from Aashima Mall
- ☑ 3 min drive from Bagh Sevania Thana & C-21 Mall
- ☑ 5 min drive from Barkatullah University
- ☑ 5 min drive from AIIMS
- ☑ 10 min drive from Habibganj Railway Station
- ☑ 10 min drive from ISBT, MP Nagar & DB Mall



Luxury that your life deserves



**SITE ADDRESS** - Next to Pebble bay, Near Aashima Mall, Hoshangabad Road, Bagh Mughaliya, Bhopal  
**OFFICE ADDRESS** - DK-5 - 1/11, Near Danish Kunj Chouraha, Kolar Road, Bhopal.

Architect -  
**VIKARAM & ARADHNA MOHILE**  
 Interarch Bhopal

AASHIMA  
**DIVINE** *Infinity*  
DREAM A NEW LIFE.

## A place that honors your choices

Just what you desire is just what we offer. Sprawling across an extensive area of 15 acres, Aashima Divine Infinity is a host of almost everything you expect in your dream home. 140 duplexes is the exact number Aashima Divine Infinity encompasses. Here, each unit is equally luxurious and comfy, assuring a pleasant life for you and your loved ones.





## PROJECT FEATURES

- A class development & construction.
- Gazebo And Water Body In Garden
- High-tech security system with ultra-modern CCTV cameras.
- Covered campus with 24 x 7 security guard.
- Vastu based layout planning.
- Beautifully developed gardens.
- Well-equipped clubhouse.
- Shopping Area For Daily Needs
- Mini Amphitheatre
- Attractive swimming pool.
- Badminton Court
- children play area.
- Adequate water supply.
- Wide RCC / paved roads within the campus.
- Stunning street lighting in entire campus.
- Rain water harvesting system.
- Loan facility by leading banks.



AASHIMA  
**DIVINE** Infinity  
DREAM A NEW LIFE.



Don't just live life,  
**celebrate it**

- JUMBO SWIMMING POOL
- CHANGING ROOMS WITH SHOWERS
- GYM
- POOL TABLE GAME
- POOL PARTY LAWN

# Make a bond with bounty

The moment you enter Aashima Divine Infinity the first thing you would be introduced to is abundance, which is not confined to a corner or two, but spread all across the campus. The profusion and lavishness is reflected everywhere right from your home to everything you come across in the campus. Even the amenities offered here will give you the feeling of abundance too.



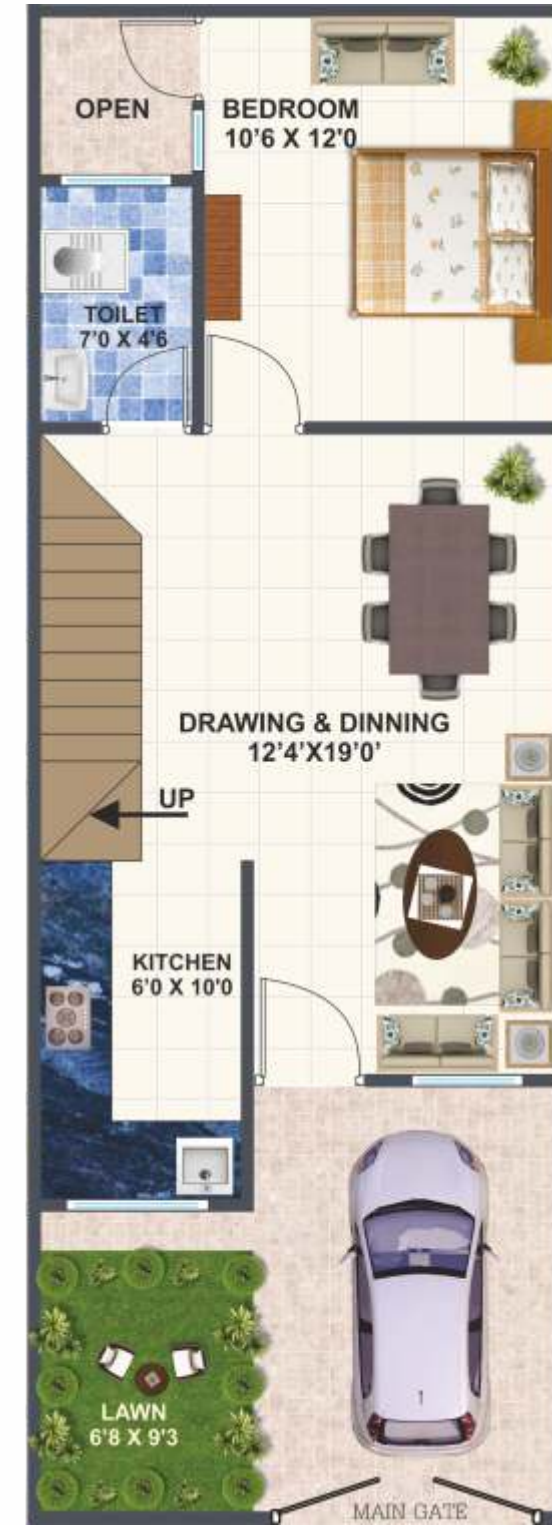

**3BHK DUPLEX HOUSE**  
 PLOT SIZE - 16'0" X 45'0"  
 PLOT AREA - 720.00 SQ.FT.

**SPECIFICATIONS**



- Structure:**  
 Earthquake resistant A-class  
 RCC structure.
- Doors & Windows:**  
 Wooden frame with laminated main entrance door  
 wooden paneling in every door & all aluminium 3 track windows  
 in your home
- Kitchen:**  
 Granite counter with stainless steel sink.  
 Plumbing point for water filter. 2' dado over counter.
- Electrical:**  
 Concealed copper wiring with modular switches and MCB's.  
 Inverter point for one light and one fan point in each room.  
 15A point for microwave in kitchen and geyser in toilets.  
 AC point in all bedrooms.
- Flooring:**  
 32"x32" vitrified tiles/ 2'x4' Double Charge/ 2'x2' Vitrified Tiles in corridor.  
 Granite staircase and I.T. flooring on terrace.
- Wall Finish:**  
 Good quality acrylic emulsion paint on interior walls  
 and equivalent quality of paint for exterior walls.  
 Enamel paint on MS grill works.
- Toilets:**  
 Premium quality ceramic anti-skid tile flooring and  
 designer wall tiles up to 7' height. Good quality  
 plumbing and ceramic fittings of renowned brand.
- Water Proofing:**  
 Water proofing treatment  
 in terrace and toilets.



AASHIMA  
**DIVINE** *Infinity*  
DREAM A NEW LIFE.

## The location... perfect and preferable

What would be a better place than Hoshangabad Road Near Aashima Mall to have exceptional convenience and excellent connectivity with all the key venues of Bhopal? Furthermore, the presence of renowned institutes, restaurants, marriage gardens, shopping destinations like mall and super markets in the vicinity add some extra worth to the location. Aashima Divine Infinity promises you the access to everything with no hassles.



project layout



# SUCCESSFUL & COMPLETED PROJECTS BY MADHUBAN GROUP LAST 7 YEARS

MADHUBAN HEIGHTS 2019-2020



AASHIMA ROYAL CITY 2016-2018



AASHIMA DIVINE CITY 2016-2018



MADHUBAN CITY 2015-2018



MADHURAM HEIGHTS ON GOING PROJECT



MADHUBAN PARK PHASE -12011-2013



MADHUBAN PARK PHASE 2 - 2013-2015

