

# A HAPPENING LIFE IN THE HEART OF PANVEL

# AAM♥D

PALASPE - PANVEL



# NAVI MUMBAI

## A HAPPENING FUTURE DESTINATION



- ONE OF THE CLEANEST CITIES IN INDIA
- EXCELLENT INFRASTRUCTURE AND SPECTACULAR DEVELOPMENTS
- PROXIMITY TO INTERNATIONAL AIRPORT
- 300 ACRES OF CORPORATE PARK
- CONNECTED TO METRO RAIL

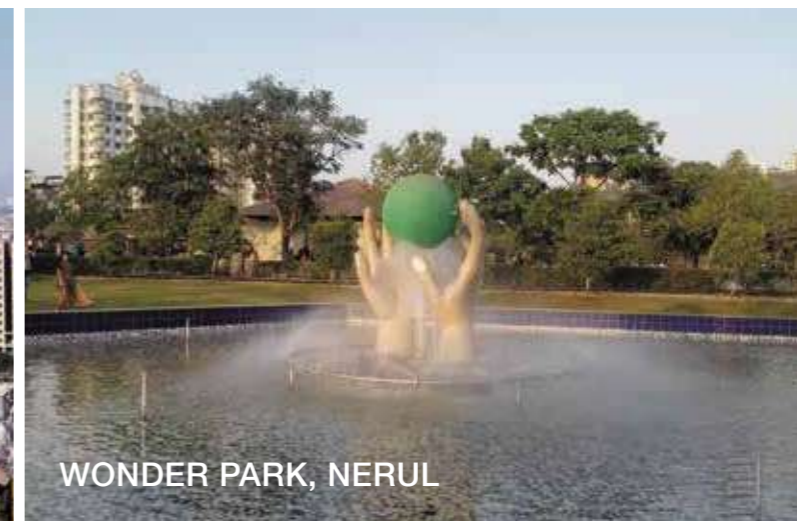
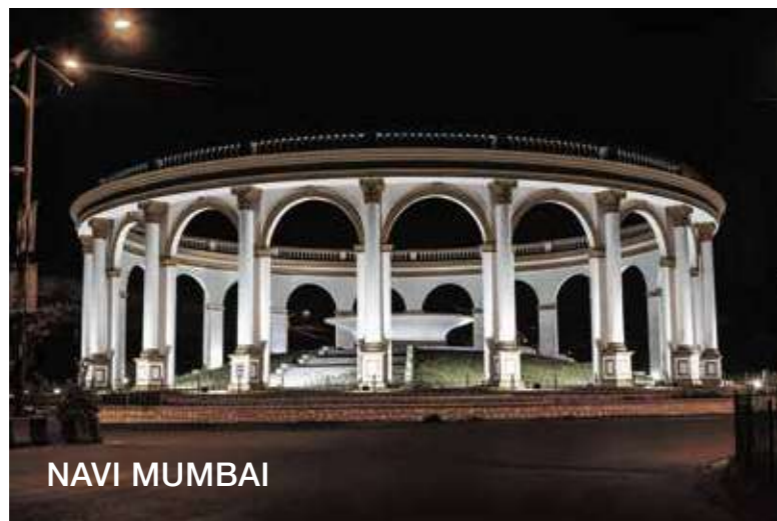

# PANVEL

## THE HAPPENING ADDRESS OF PRIVILEGES



- THE BIGGEST RAIL TERMINAL, WITH MORE THAN 11 TRAIN CORRIDORS
- FASTEST CONNECTIVITY TO MUMBAI & PUNE. (MTHL, SUPER EXPRESSWAY & RAIL )
- PROXIMITY TO INTERNATIONAL AIRPORT.
- SURROUNDED BY LUSH GREEN ZONES.



NAVI MUMBAI INTERNATIONAL AIRPORT



MUMBAI-PUNE EXPRESSWAY



RAIL TERMINAL



LUSH GREEN ZONES



**6 PILLARS**  
THAT MAKE TODAY GLOBAL  
MOST-TRUSTED CORPORATE



15+ YEARS OF EXPERIENCE  
IN REAL ESTATE

---



THE WINNER OF TIMES OF INDIA AWARD  
FOR MOST PROMISING DEVELOPERS

---



HIGH RETURN OF INVESTMENT  
ON ALL PREVIOUS PROJECTS

---



STRONG ETHICS & CSR POLICY

---



ON TRACK DELIVERY OF  
MORE THAN 10 LAKH SQ. FT.

---



MOST ACTIVE BUILDER IN SOCIAL  
ACTIVITIES (BETI BACHAO- BETI PADHAO,  
BACK 2 BACHAPAN & MORE)



A HAPPENING WORLD THAT  
TAKES HAPPINESS TO THE NEXT LEVEL

PRESENTING

AAMD

PALASPE - PANVEL

# THE LANDMARK OF A HAPPENING LIFE



## PROJECT HIGHLIGHTS

- 3 TOWERS OF G+ 7 STOREYS
  - 1 AND 2 BHK HOMES
- STATE-OF-THE-ART AMENITIES
- PROXIMITY TO THE UPCOMING INTERNATIONAL AIRPORT
  - CONNECTED TO UPCOMING METRO RAIL
- PRICED 32% LESSER COMPARED TO OTHER NEIGHBOURHOOD PROJECTS



**TODAY**  
GLOBAL DEVELOPERS

**TODAY**  
GLOBAL DEVELOPERS

PHILIPS

samsung

lookern

Virgin

Jolly day

New

Cafe up

**TODAY**  
GLOBAL DEVELOPERS

PHILIPS

samsung

lookern

Virgin

Jolly day

New

Cafe up



ENTER INTO  
A HAPPENING WORLD  
OF LUXURIES



LANDSCAPED LIFESTYLE FEATURES

# A PLACE TO DISCOVER CALM & PEACE



YOGA MEDITATION CORNER



# WALK ON THE PATH OF WELLNESS



REFLEXOLOGY PATHWAY



# CHERISH LIFE IN THE PURITY OF NATURE



THERAPEUTIC NATURAL GREENS



# LET EACH STEP LEAD TO A HEALTHY LIFE



LANDSCAPED GARDEN WITH JOGGING TRACK



# A SPACE FOR THEIR HAPPY RETREAT



SENIOR CITIZEN CORNER



# LITTLE JOYS IMMENSE HAPPINESS



CHILDREN'S PLAY AREA



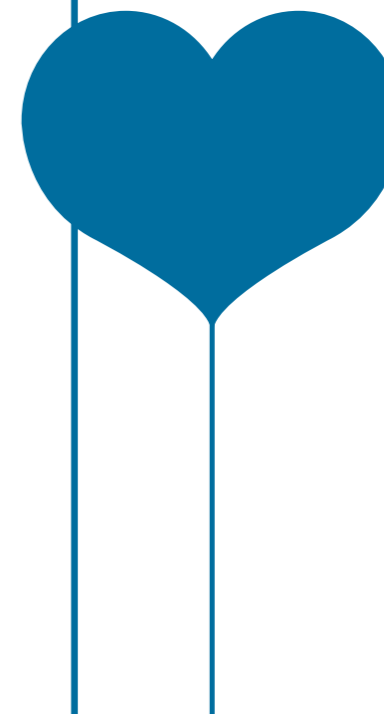
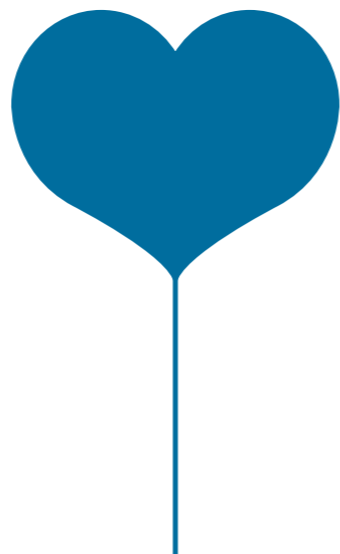
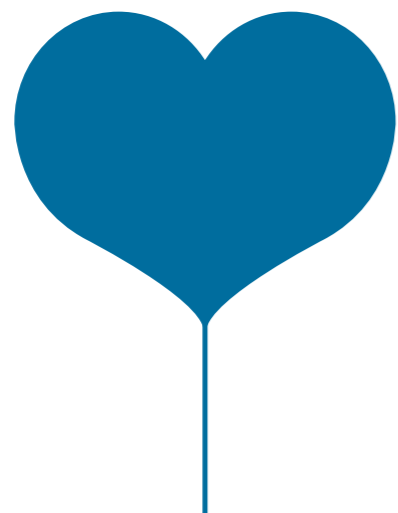
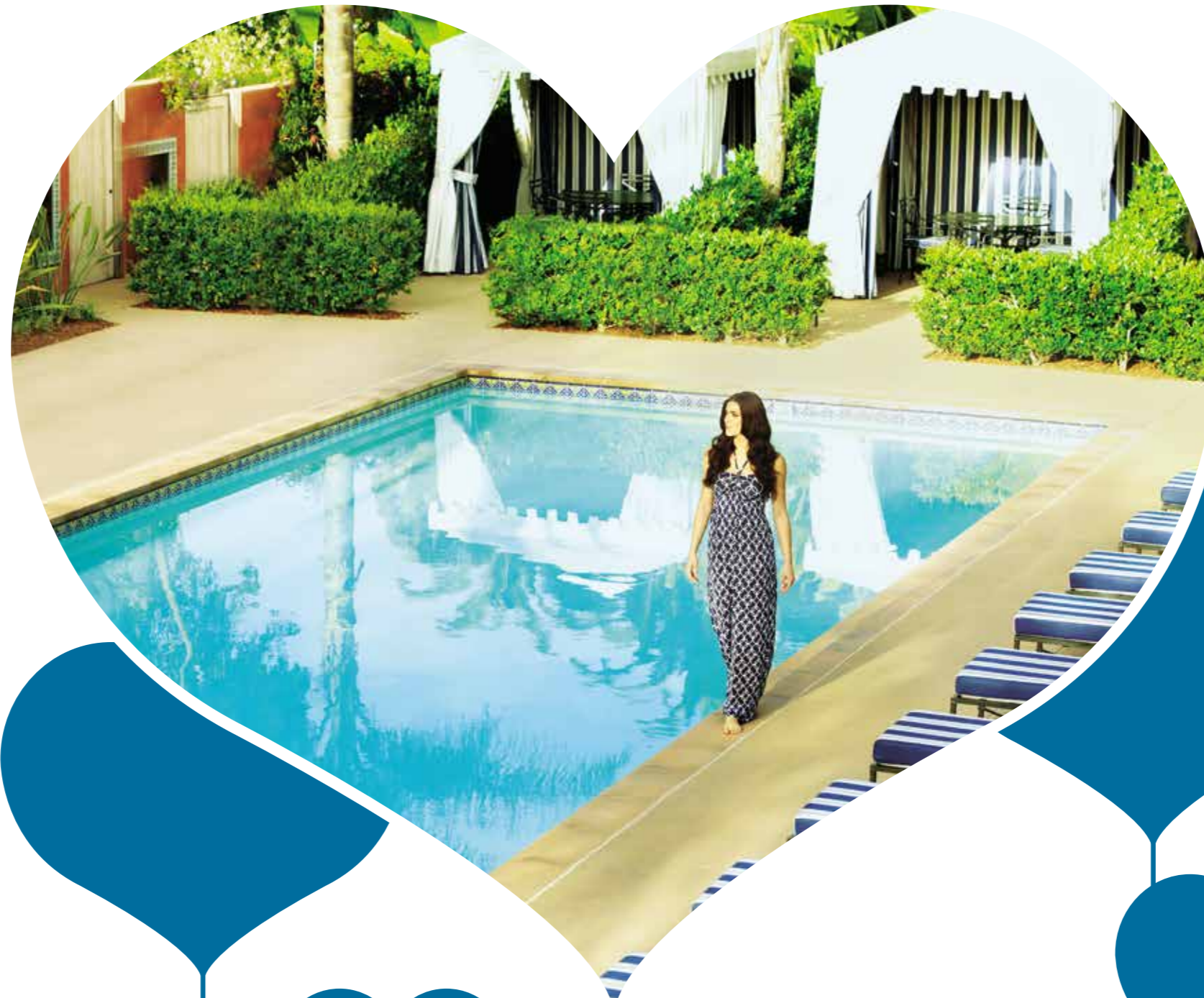

DISCOVER  
THE DESTINATION ON  
HAPPENING CLUB LIFE



CLUB LIFE FEATURES

# WELCOME TO A LIFE OF EXCLUSIVITY

CLUB HOUSE WITH  
AZURE SWIMMING POOL

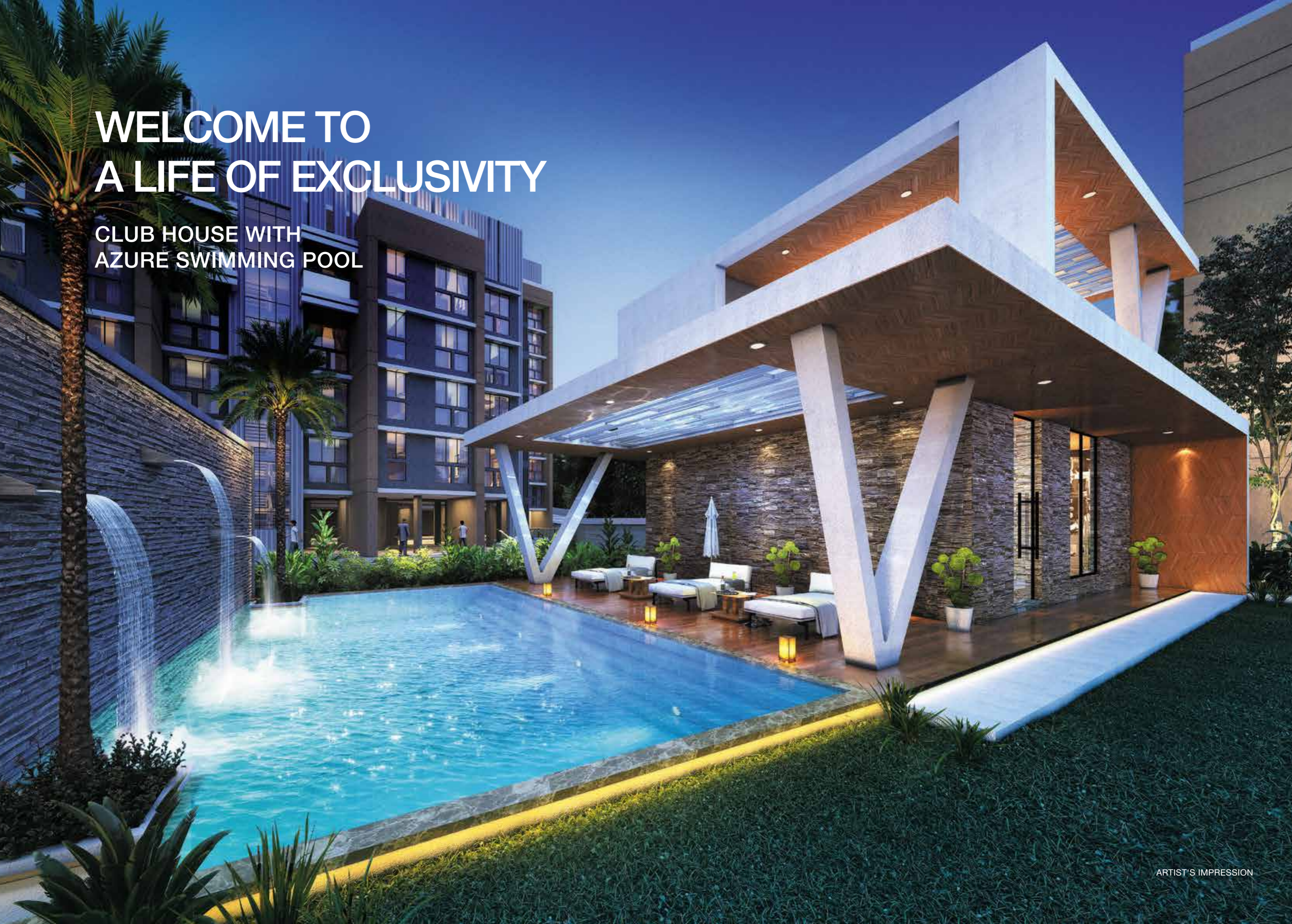

# YOUR COMMITMENT TO HEALTH FINDS A DESTINATION



WORLD-CLASS GYMNASIUM



# MOMENTS OF CELEBRATIONS BECOME MEMORIES OF LIFE

G+2 STOREY LAVISH CLUBHOUSE



TODAY  
GLOBAL DEVELOPERS

# A SPECIAL PLACE FOR YOUR SPECIAL OCCASIONS



GRAND CELEBRATION HALL



# **PANVEL,** A LOCATION WHERE CONVENIENCE BECOMES AN ATTRIBUTE



## **LOCATION ADVANTAGES**

- UPCOMING INTERNATIONAL AIRPORT - 7 MINS
  - UPCOMING NAVI MUMBAI SEZ - 25 MINS
  - MUMBAI-PUNE EXPRESSWAY - 2 MINS
  - PANVEL RAILWAY JUNCTION - 7 MINS
- JAWAHARLAL NEHRU PORT TRUST (JNPT) - 20 MINS
  - UPCOMING METRO RAILWAYS - 20 MINS
  - NHAVA-SHEVA SEA-LINK - 25 MINS
- CLOSE PROXIMITY TO SCHOOLS, COLLEGES, HOSPITALS, MALLS, MULTIPLEXES, HOTELS & BANKS

# LOCATION MAP



# AAMOD

PALASPE - PANVEL



ARTIST'S IMPRESSION

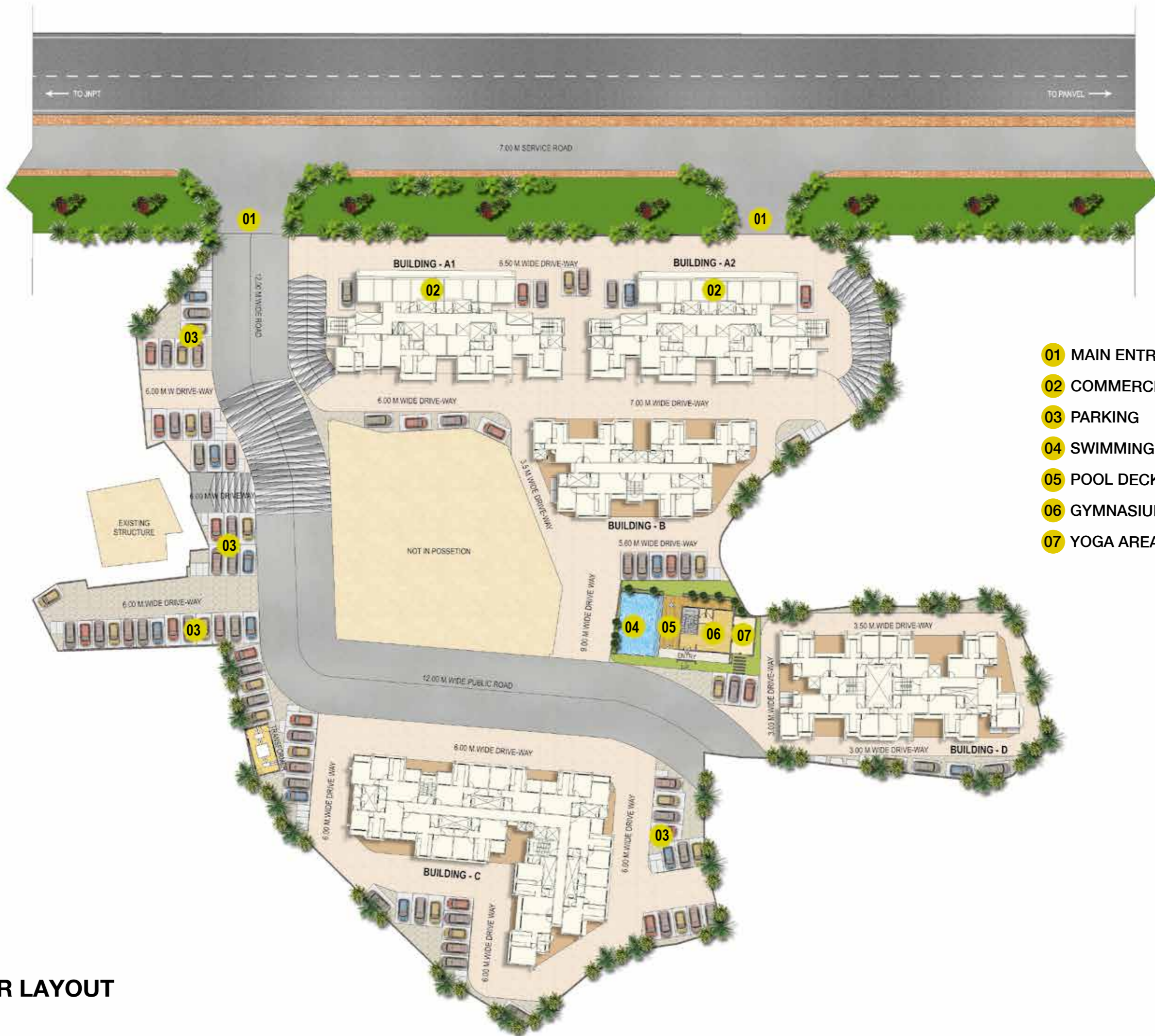

- 01 MAIN ENTRANCE
- 02 COMMERCIAL / SHOP
- 03 PARKING
- 04 SWIMMING POOL
- 05 POOL DECK
- 06 GYMNASIUM
- 07 YOGA AREA

**MASTER LAYOUT**

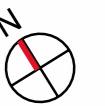

# UNIT PLAN - 1 BHK



# UNIT PLAN - 2 BHK





# AAMOD AT A GLANCE

## PROJECT HALLMARKS

- 3 Towers of G+7 with 1 and 2 BHK Homes
- State-of-the-art Amenities
- Proximity to the Upcoming International Airport
- Connected to Upcoming Metro Rail
- The most competitive Pricing

## RECREATION AND RELAXATION

- Swimming Pool
- Yoga Meditation Corner
- Reflexology Pathway
- Therapeutic Natural Greens
- Landscaped Garden With Jogging Track
- Multipurpose Hall
- Gymnasium
- Children's Play Area
- Senior Citizen Corner

## APARTMENT FEATURES

- Impressive Living Rooms
- Vastu Compliant Living Room
- Elegant and Spacious Bedrooms
- Modern Kitchen with Space for Utilities
- Bathrooms with Branded Sanitary Fittings

## TOWER FEATURES

- Grand Welcome Lobby
- High Speed Elevators
- Automated Parking on Ground Level
- 3 Tier Security Solutions
- 24 Hour CCTV Surveillance
- Fully Compounded Wall
- Security Cabin
- Intercom

## INTERNAL SPECIFICATIONS

### LIVING AND DINING ROOMS

- Flooring - Italian Marble Finish Vitrified Tiles 2' X 2'
- Walls - Acrylic Emulsion Paint Kitchens
- Tiles Above the Counter and Acrylic Emulsion Paint In Balance Area
- Anti-skid Tiles/ Vitrified Tiles
- Granite Counters For Stability
- Acrylic Emulsion Paint Ceiling

### DOORS

- Decorative Main Entrance Door with S.S. Fittings Flush Doors

### WINDOWS

- Anodize Aluminium Section with Mosquito Nets and Branded Glass, Aluminium Louvers in Bathroom

### ELECTRICAL

- Reputed Brand in Wires and Modular Switches

### BATHROOMS

- Anti-skid Vitrified Tiles for Flooring
- Acrylic Emulsion Paint Ceiling
- Walls with Full Height Dado Tiles
- Granite Counters for Stability
- Fixture & Accessories - Kohler/ Jaguar or Equivalent Brand
- Sanitary Fittings -
  - Wall Hung WC of Reputed Make.
  - Wall Hung Washbasin of Reputed Brand
- Plumbing - CpvC & Upvc Piping for Water Supply (Reputed Brand)

A PROJECT BY  
**TODAY**  
GLOBAL DEVELOPERS  
TODAY'S PROMISE, TOMORROW'S REALITY

Strategic Partner  
**JUSTO**  
advice . create . nurture .  
JUSTO RERA Reg. No.: A51900020277

Maha Rera No. P52000030717 Available at [maharera.mahaonline.gov.in](http://maharera.mahaonline.gov.in)

**Call: 080660 84424**

---

Site Address: Today Aamod, At Palaspe Phata, Panvel Maharashtra-410221.

Corporate Address: 1601-1602, Kesar Solitaire, Palm Beach Road, Sector 19, Sanpada, Navi Mumbai Maharashtra-400705.

---

Disclaimer: The plans, specifications, images and other details herein are only indicative and the developer/owner reserve their rights to change any or all of these in the interest of the development. This printed material does not constitute an offer and/or contract of any type between the developer/owner and the recipient. The purchases lessee of this development shall be governed by the terms and conditions of the agreement for sale/lease entered into between parties and no details mentioned in this printed material shall in anyway govern such transaction.

AAMOD

PALASPE - PANVEL

A HAPPENING LIFE  
IN THE HEART OF PANVEL



# A LOCATION WHERE WORLD COMES CLOSER

## LOCATION ADVANTAGES

- Upcoming International Airport - 7 Mins
- Upcoming Navi Mumbai SEZ - 25 Mins
- Mumbai-Pune Expressway - 2 Mins
- Panvel Railway Junction - 7 Mins
- Jawaharlal Nehru Port Trust (JNPT) - 20 Mins
- Upcoming Metro Railways - 20 Mins
- Nhava-Sheva Sea-link - 25 Mins
- Close Proximity To Schools, Colleges, Hospitals, Malls, Multiplexes, Hotels & Banks

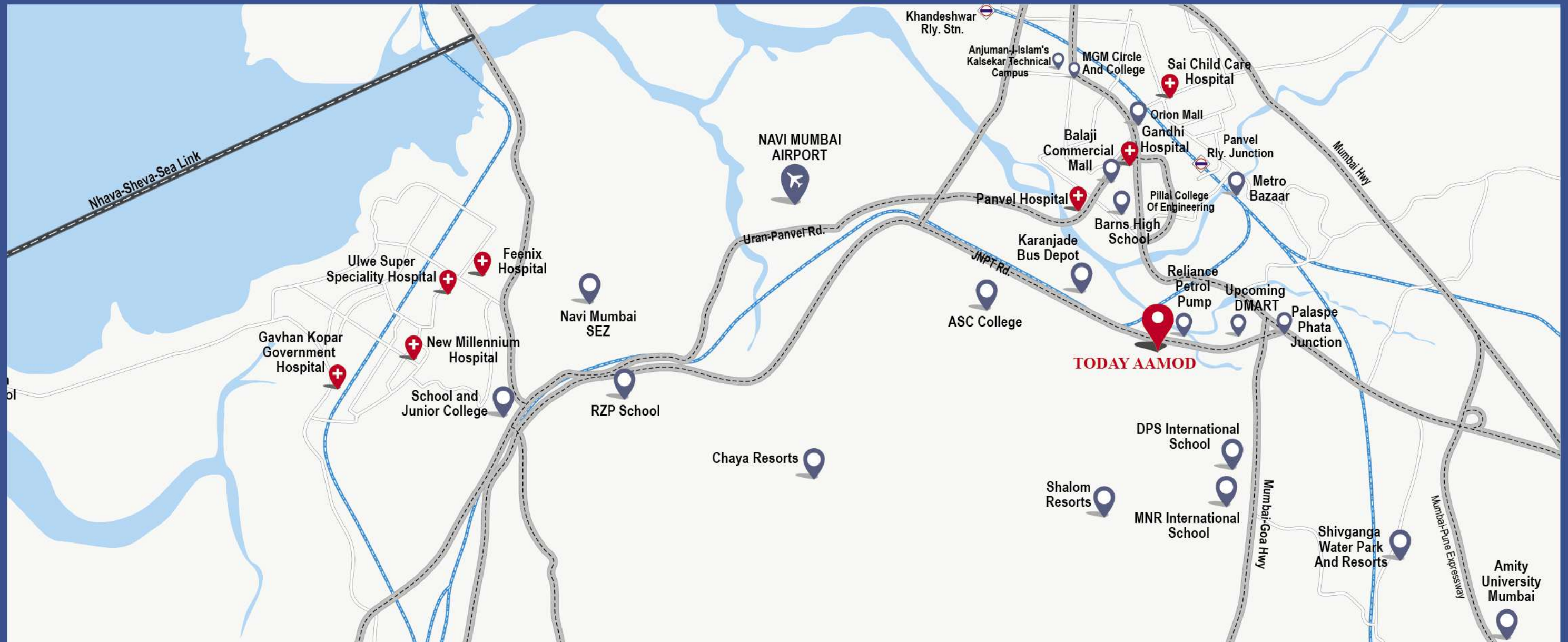

# MASTER LAYOUT



- 01 MAIN ENTRANCE
- 02 COMMERCIAL / SHOP
- 03 PARKING
- 04 SWIMMING POOL
- 05 POOL DECK
- 06 GYMNASIUM
- 07 YOGA AREA

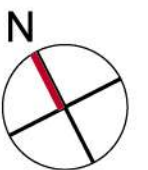

# TYPICAL FLOOR PLAN

1<sup>ST</sup>, 3<sup>RD</sup>, 5<sup>TH</sup> & 7<sup>TH</sup> (BUILDING - A1)

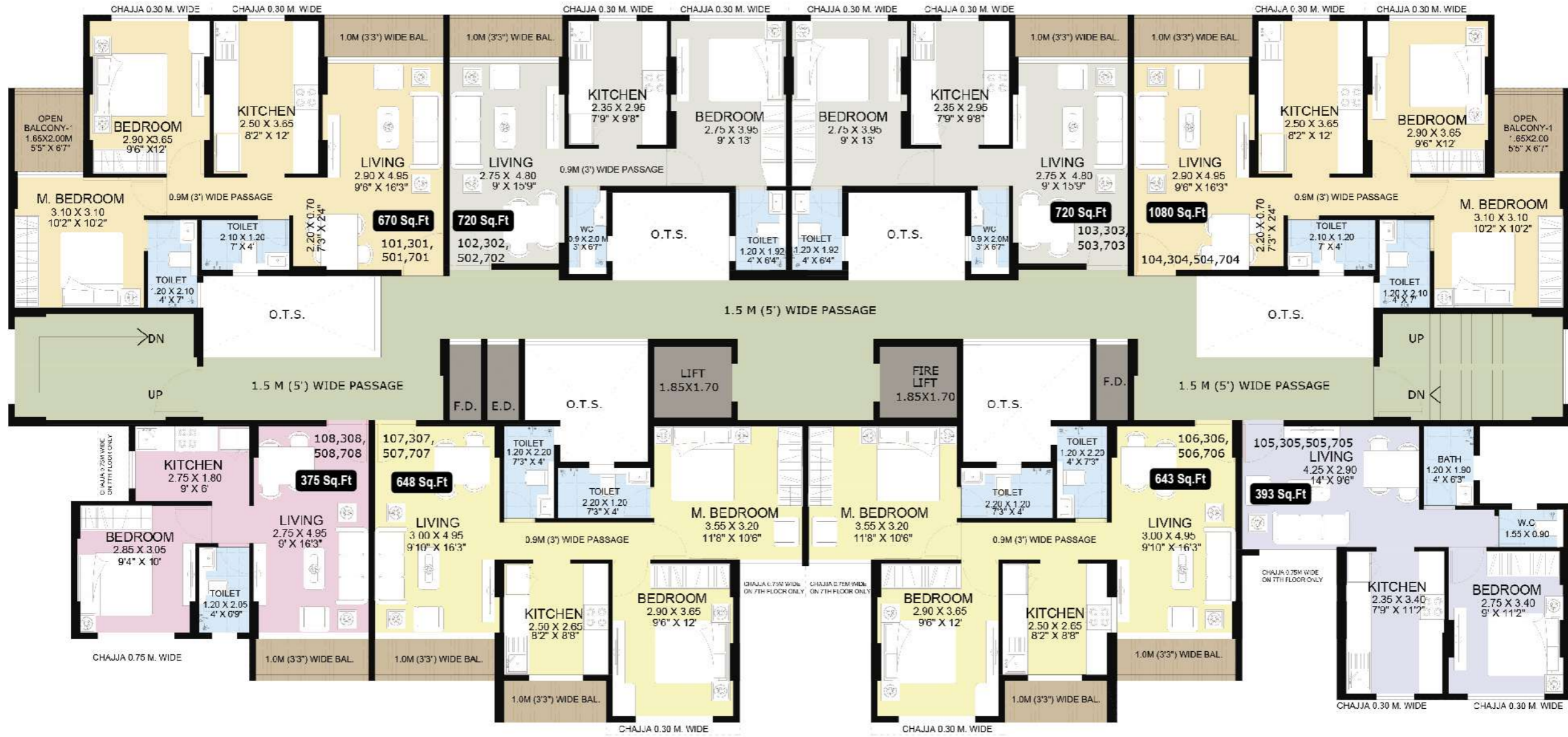

# TYPICAL FLOOR PLAN

2<sup>ND</sup>, 4<sup>TH</sup>, & 6<sup>TH</sup> (BUILDING - A1)

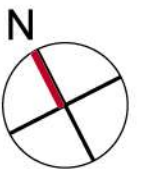

# TYPICAL FLOOR PLAN

1<sup>ST</sup>, 3<sup>RD</sup>, 5<sup>TH</sup> & 7<sup>TH</sup> (BUILDING - C)

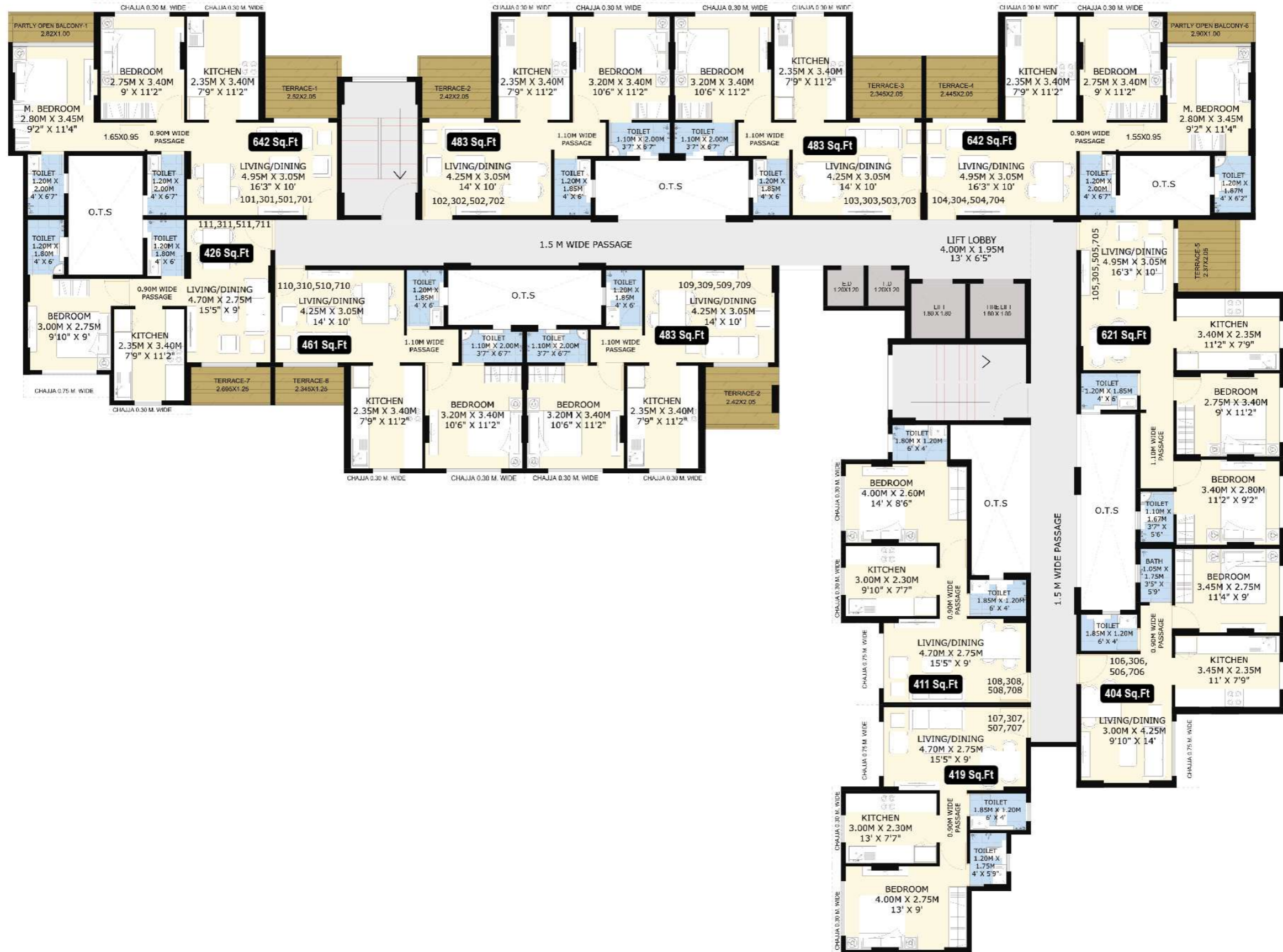

# TYPICAL FLOOR PLAN

2<sup>ND</sup>, 4<sup>TH</sup>, & 6<sup>TH</sup> (BUILDING - C)

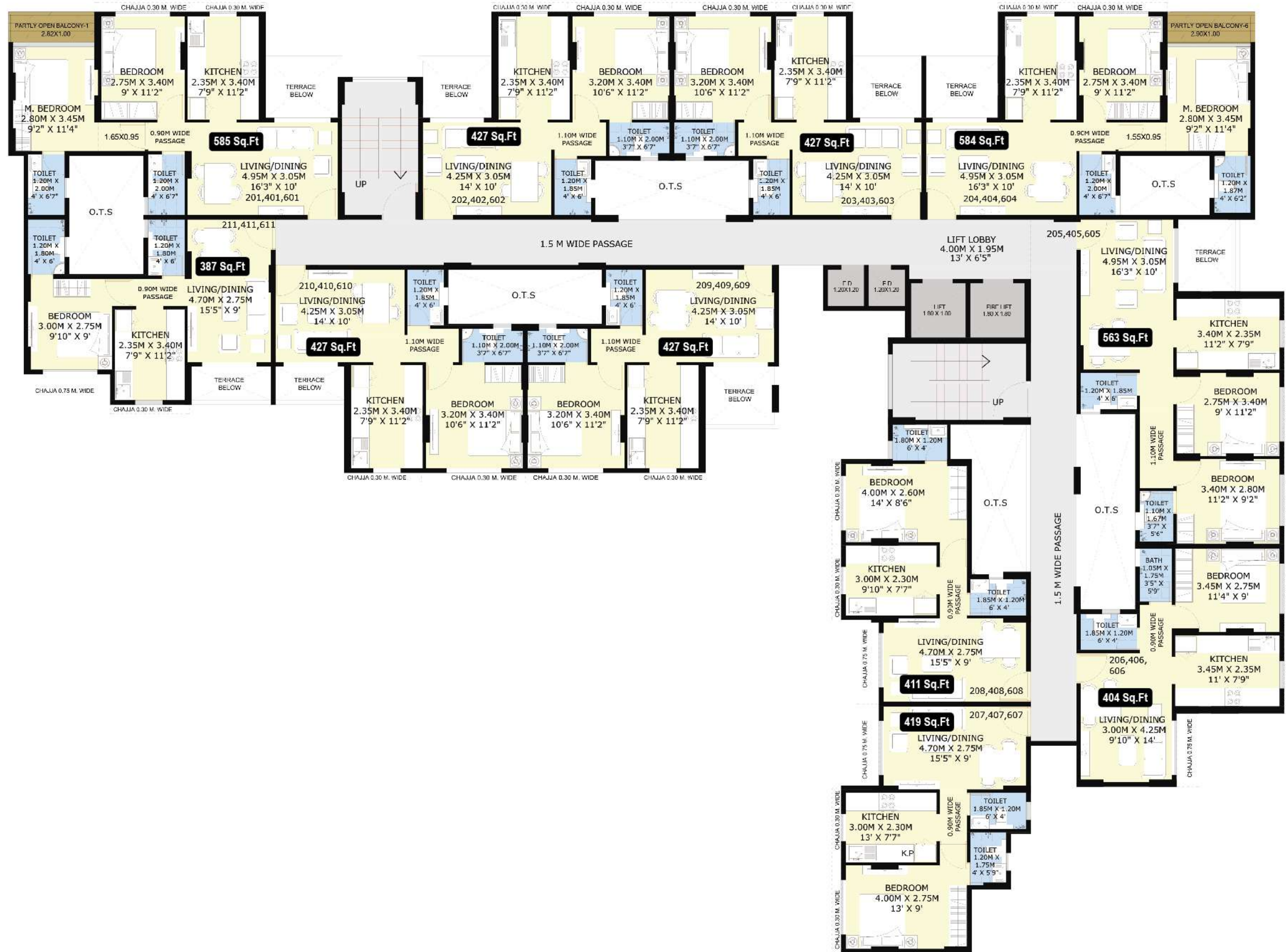

# UNIT PLANS

1 BHK - TYPE - 1



2 BHK - TYPE - 2





# THE GLIMPSE OF A HAPPENING LIFE

## PROJECT HALLMARKS

- 3 Towers of G+7 with 1 and 2 BHK Homes
- State-of-the-art Amenities
- Proximity to the Upcoming International Airport
- Connected to Upcoming Metro Rail
- The most competitive Pricing

## RECREATION AND RELAXATION

- Swimming Pool
- Yoga Meditation Corner
- Reflexology Pathway
- Therapeutic Natural Greens
- Landscaped Garden With Jogging Track
- Multipurpose Hall
- Gymnasium
- Children's Play Area
- Senior Citizen Corner

## APARTMENT FEATURES

- Impressive Living Rooms
- Vastu Compliant Living Room
- Elegant and Spacious Bedrooms
- Modern Kitchen with Space for Utilities
- Bathrooms with Branded Sanitary Fittings

## TOWER FEATURES

- Grand Welcome Lobby
- High Speed Elevators
- 24 Hour CCTV Surveillance
- Fully Compounded Wall
- Security Cabin
- Intercom
- 3 Tier Security Solutions

## INTERNAL SPECIFICATIONS

### LIVING AND DINING ROOMS:

- Flooring - Italian Marble Finish  
Vitrified Tiles 2' X 2'
- Walls - Acrylic Emulsion Paint

### KITCHENS:

- Tiles Above the Counter and Acrylic Emulsion  
Paint In Balance Area
- Anti-skid Tiles/ Vitrified Tiles
- Granite Counters For Stability
- Acrylic Emulsion Paint Ceiling

### DOORS:

- Decorative Main Entrance Door  
With S.S. Fittings Flush Doors

### WINDOWS:

- Anodize Aluminium Section with Mosquito Nets  
and Branded Glass, Aluminium Louvers in Bathroom

### ELECTRICAL:

- Reputed Brand in Wires And Modular Switches

### BATHROOMS:

- Anti-skid Vitrified Tiles for Flooring
- Acrylic Emulsion Paint Ceiling
- Walls with Full Height Dado Tiles
- Granite Counters for Stability
- Fixture & Accessories - Kohler / Jaguar or Equivalent Brand
- Sanitary Fittings -
- Wall Hung WC of Reputed Make
- Wall Hung Washbasin of Reputed Brand
- Plumbing - CPVC & UPVC Piping for Water Supply  
(Reputed Brand)

# WINNING HEARTS, SPREADING HAPPINESS

## A Glimpse of Awards and CSR Activities

Winner of Times Iconic Promising Developer -2018



CSR Initiative: Distributed Scholarships to Many Girl Students under 'Beti Bachao, Beti Padhao' scheme

