

THE LAND OF
SMART OPPORTUNITIES



DOSTI
GREATER
THANE

SECTOR 3A - CLUSTER 2

WELCOME TO



A GRAND COMMUNITY WITH ALL THE FEATURES FOR
A GREATER TOMORROW

- Just 7 Km (10 Mins)* from Viviana Mall
- Just 4 Km (6 Mins)* from Balkum, Thane
- The Newly Emerging Destination with every lifestyle convenience
- Strategic connectivity with the Metro Line 5 (Thane-Bhiwandi-Kalyan) - Kalher Station outside Dosti Greater Thane
- Easy accessibility to Thane, Kalyan, Navi Mumbai, Mumbai & key localities via rail and road.
- Desirable lifestyle amenities and all the comforts of a modernistic life
- Various Schools, Hospitals, Malls, Temples and Shops right within its vicinity
- Dosti Greater Thane offers the liberty to live the much-desired life at an extremely affordable pricing



NOW, NO DISTANCE IS
OUT OF YOUR REACH

DISTANCE FROM VIVIANA MALL



ALL THESE DISTANCES ARE FROM VIVIANA MALL
Source: Google Maps. Not to Scale. As per normal traffic conditions.

Kasheli Toll Naka	2 kms	4 mins	Vartak Nagar	9.5 kms	18 mins
Balkum Naka	4 kms	6 mins	Thane Station	10 kms	20 mins
Bhiwandi	4 kms	7 mins	Kalyan	15 kms	30 mins
Bhiwandi Station	4.3 kms	8 mins	Dombivli	23 kms	40 mins
Kapurbawdi Naka	6.3 kms	8 mins	Navi Mumbai	28 kms	50 mins
Majiwada Naka	6.6 kms	9 mins	Borivali	30 kms	52 mins
Viviana Mall	7 kms	10 mins	Chhatrapati Shivaji International Airport	30 kms	52 mins
R Mall	8 kms	12 mins	Domestic Airport	33 kms	57 mins
Korum Mall	8.5 kms	13 mins	Under Construction Navi Mumbai International Airport	35 kms	60 mins
Kalwa	8.7 kms	14 mins			
Vasant Vihar	9 kms	15 mins			

GREATER THANE TO GREATER MUMBAI IN MINUTES



METRO LINE 4

This under construction Metro Line 4 connects Wadala - Ghatkopar - Mulund - Thane - Kasarvadavali thereby reducing travel time between the south-central and northern-central locations.

THANE BHIWANDI KALYAN* (METRO LINE 5)

The 24.9 km-long Thane-Bhiwandi-Kalyan Metro-5 corridor which is under construction will have 16 stations and will be a totally elevated corridor. It will connect Thane to Bhiwandi and Kalyan in the Eastern suburbs. Kalher station is located outside DOSTI GREATER THANE.

UNDER CONSTRUCTION METRO LINE 5 PROPOSED STATIONS

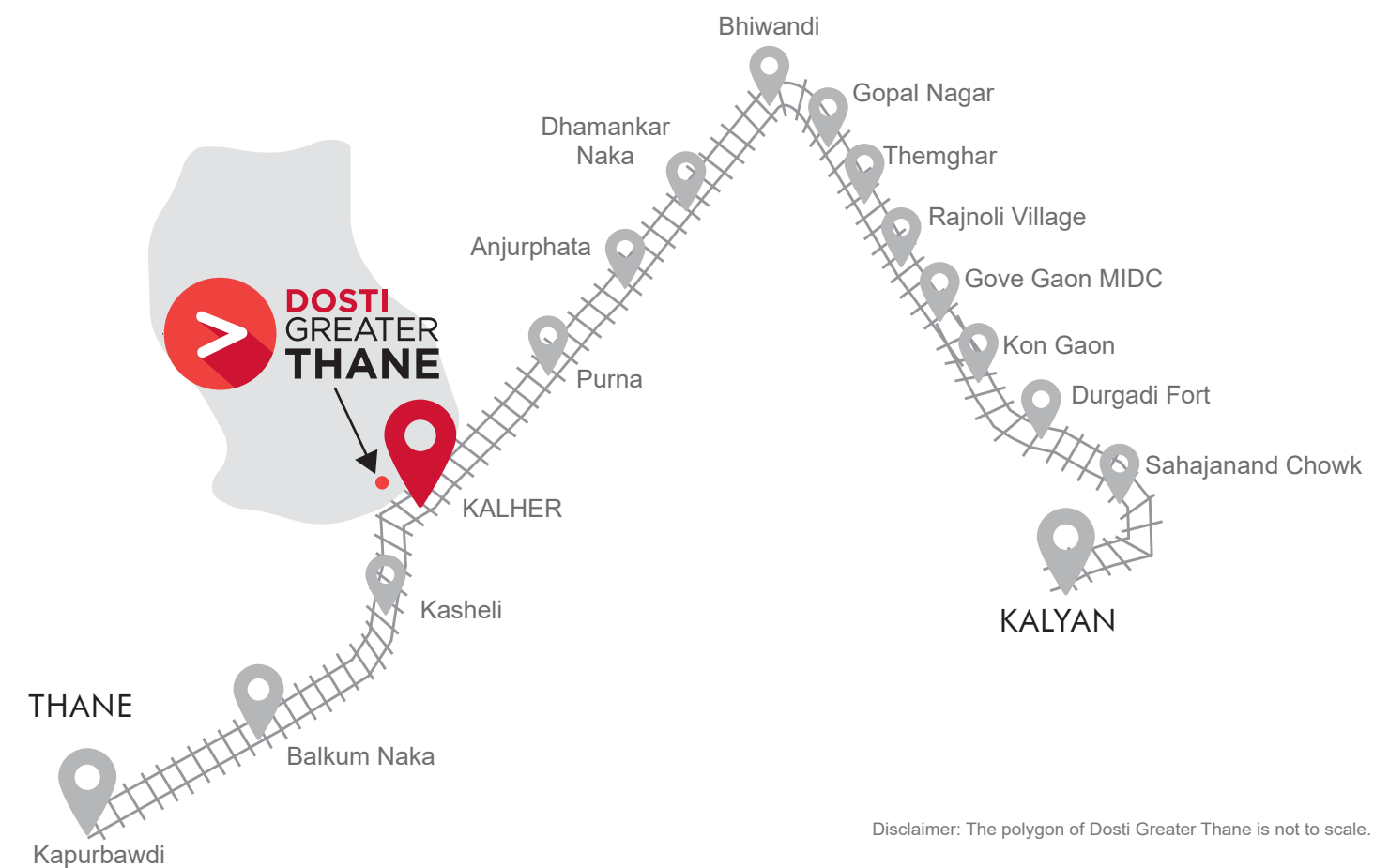

Disclaimer: The polygon of Dosti Greater Thane is not to scale.

OTHER UPCOMING INFRASTRUCTURE



PROPOSED THANE - BORIVALI TUNNEL

This 10 km long tunnel will start from Tikujiniwadi (Thane) and connect with the Western Express Highway at Borivali passing through Sanjay Gandhi National Park.

Source: Free Press Journal article dated November 11, 2022
Link: <https://www.freepressjournal.in/mumbai/mumbai-thane-borivalitunnel-to-undergo-design-change>



PROPOSED VIRAR ALIBAUG MULTIMODAL TRANSPORT CORRIDOR

Phase 1 is a 79 kms stretch between Virar and Balavali while phase 2 between Balavali and Alibag stretches up to 47 kms. This corridor will have 72 bridges, 21 flyovers, 2 over passes and 35 vehicular passes thus cutting down the commute time between Virar and Alibag. It's expected to provide easy access to the upcoming Navi Mumbai International Airport, JNPT & Mumbai Trans Harbour Link.

Source: Indian Express dated Jun 22, 2021
Link: <https://indianexpress.com/article/cities/mumbai/mumbai-green-nod-to-section-of-virar-alibaug-multimodal-corridor-project-7369564/>



THANE WATERWAYS

The first phase of the inland water transport project is under construction and will connect Thane, Kalyan and Vasai thus reducing the strain on the roads and railways in those areas.

Source: Times of India, article dated March 12, 2022
Link: <https://timesofindia.indiatimes.com/city/mumbai/take-the-waterway-to-the-suburbs-rides-to-be-10-cheaper/articleshow/90160339.cms>



RO-RO WATERWAYS

This would be a hovercraft service between South Mumbai and Navi Mumbai in Phase 1 with plans to extend the same to Thane in Phase 2. This is expected to be a cost effective transport solution that will help ease road and rail traffic congestion within MMR. Bhaucha Dhakka to Belapur waterways service is now operational.

Source: Times of India, article dated March 12, 2022
Link: <https://timesofindia.indiatimes.com/city/mumbai/take-the-waterway-to-the-suburbs-rides-to-be-10-cheaper/articleshow/90160339.cms>



PROPOSED CST - THANE UNDERGROUND RAILWAY LINE

The railways have proposed a 34 km fully underground high-speed route between Chhatrapati Shivaji Maharaj Terminus (CSMT) and Thane that will run under the current corridor and is expected to halve the commuting time.

Source: Times of India, article dated July 25, 2019
Link: <https://timesofindia.indiatimes.com/city/mumbai/railways-moots-underground-cst-thane-ride-in-21-minute/articleshow/70373109.cms>



THANE - DOMBIVLI BRIDGE

This six-lane bridge over the Ulhas creek is 980 metres long and will connect Thane & Dombivli via the Nashik highway.

Source: Hindustan Times article dated October 14, 2022
Link: <https://www.hindustantimes.com/cities/mumbai-news/motagaonmankoli-bridge-80-per-cent-complete-expected-to-be-opened-to-traffic-by-april-2023-101665686071233.html>



PROPOSED EASTERN FREEWAY EXTENSION FROM CHEMBUR TO THANE

A freeway connecting two major centre points of the city. This will enable a seamless flow of traffic and reduction in bottlenecks along with swift connectivity.

Source: Times of India article dated November 16, 2022
Link: <https://timesofindia.indiatimes.com/city/thane/maharashtra-cm-eknath-shinde-announces-extension-of-eastern-freeway-till-end-of-gb-road/articleshow/95501222.cms>



PROPOSED COASTAL ROAD FROM BALKUM TO GAIMUKH

Approval has been granted to construct this coastal road connecting Gaimukh and Balkum in Thane. This will reduce the travel time to mere minutes and avoid traffic on the main highway.

Source: Hindustan Times article dated July 16, 2022
Link: <https://www.hindustantimes.com/cities/mumbai-news/shindefadnavis-big-infra-push-cabinet-allows-mmrd-to-borrow-60-000-crore-101657993640145.html>

Stock images used for representation purpose only

- Airport
- Eastern Express Highway
- Western Express Highway
- Ghodbunder Road
- Old Mumbai-Pune Road (NH 4)
- Thane-Belapur Road
- Chembur - Jacob Circle Monorail Line
- Santacruz - Chembur Link Road
- Eastern Freeway
- Bandra - Worli Sea Link
- Business Hub
- Ghatkopar - Versova Metro Line 4
- Western Railway
- Central Railway
- Harbour Railway
- Ferry Wharf Jetty

UNDER CONSTRUCTION INFRASTRUCTURE

- DN Nagar - Dahisar Metro Line 2A (Partly operational)
- DN Nagar - Bandra - Mandale Metro Line 2B
- Colaba - Bandra - Seepz Metro Line 3
- Wadala - Ghatkopar - Thane Metro Line 4
- Thane - Bhiwandi - Kalyan Metro Line 5
- Swami Samarth Nagar - Jogeshwari - Vikhroli Metro Line 6
- Andheri (E) - Dahisar (E) Metro Line 7 (Partly operational)
- Dahisar (E) - Mira Bhayandar Metro Line 7A
- CSIA - Navi Mumbai International Airport Metro Line 8
- Dahisar (E) - Mira Bhayandar Metro Line 9
- Wadala - GPO (CST) Metro Line 11
- Coastal Road (Bandra - Versova - Kandivali)
- Mumbai Trans Harbour Link (Sewri - Nhava Sheva)
- Thane - Dombivli Flyover
- Mumbra - Airoli Tunnel
- Navi Mumbai International Airport
- Thane Water Ways Transport Along Ulhas River (Thane to Vasai, Kalyan & Bhiwandi)

PROPOSED INFRASTRUCTURE

- Thane - Borivali Tunnel
- Virar - Alibaug Multi-modal transport Corridor
- Metro Line 10 Gaimukh (Ghodbunder) - Shivaji Chowk (Mira Road)
- Metro Line 12 Kalyan - Taloja
- Kolshet Jetty
- Bandra - Versova Sea Link
- Coastal Road (Kandivali to Ghodbunder Road)
- Worli to Sewri connector
- Eastern Freeway (Chembur to Thane)
- Coastal Road (Balkum to Gaimukh)

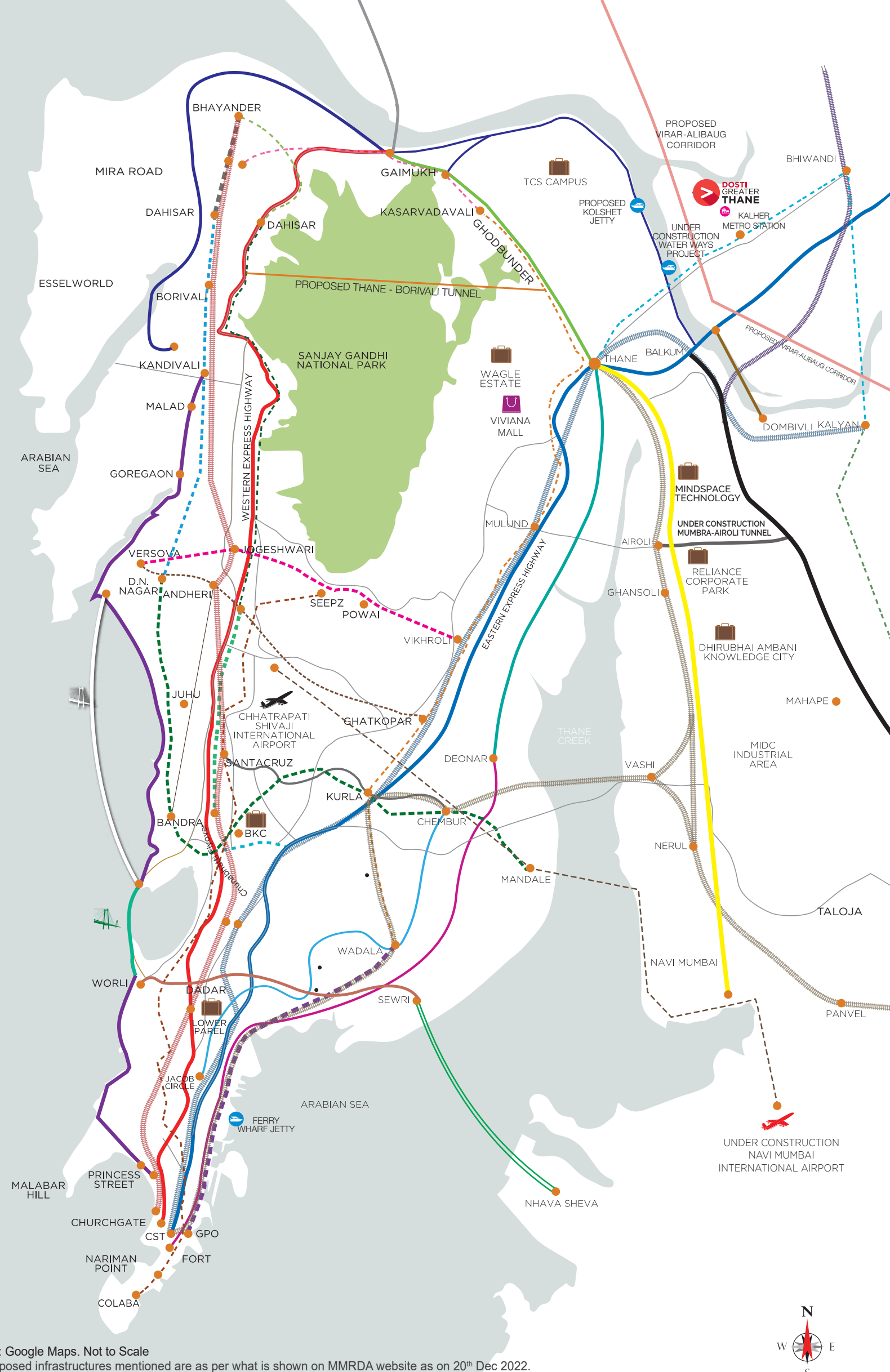

Source: Google Maps. Not to Scale

*All proposed infrastructures mentioned are as per what is shown on MMRDA website as on 20th Dec 2022.

STRATEGICALLY CONNECTED SO ALL COVENIENCES ARE JUST NEXT DOOR



EDUCATIONAL INSTITUTES

Leo International School	400 M	01 Min
Evershine English School	400 M	01 Min
Divine English School and Junior College	2.8 Km	05 Mins
CP Goenka International School	6.3 Km	08 Mins
Nett Paramedical College	6.9 Km	10 Mins
Lodha World School	7.9 Km	13 Mins
Orchids International School	8.0 Km	13 Mins
Rainbow International School	8.0 Km	13 Mins
Universal High School	8.0 Km	13 Mins
Vasant Vihar School	8.3 Km	13 Mins
St. Xaviers English High School	8.3 Km	13 Mins
Smt. S. Singhania High School	8.3 Km	13 Mins
TMC Law Colleges	9 Km	15 Mins
Vidya Prasarak Mandal's Polytechnic	9.4 Km	18 Mins
Hiranandani Foundation School	10 Km	20 Mins
Rustomjee Cambridge School & Jr. College	10 Km	20 Mins
Billabong High International School	11 Km	22 Mins



FINE DINING RESTAURANTS

Clove Bar & Kitchen	6.0 Km	08 Mins
The Yellow Chili	7.0 Km	10 Mins
Mainland China	7.0 Km	10 Mins
China Bistro	7.5 Km	11 Mins
Oriental Spice	8.0 Km	15 Mins
Urban Tadka	8.5 Km	15 Mins
Barbeque Nation	10 Km	20 Mins
Fusion Dhaba	10 Km	20 Mins



MALLS AND HYPERMARKETS

MY D Mall	350 M	01 Min
Bangar Plaza	650 M	02 Mins
Big Bazaar	6.0 Km	06 Mins
High Street Mall	6.0 Km	06 Mins
Lake City Mall	6.3 Km	08 Mins
D Mart	6.5 Km	09 Mins
Viviana Mall	7.0 Km	10 Mins
R Mall	8.0 Km	12 Mins
Star Bazaar	8.3 Km	13 Mins
Korum Mall	8.5 Km	13 Mins
Wood Packer Interior	10 Km	20 Mins
The Walk	10.5 Km	23 Mins
Hypercity	13 Km	26 Mins



MULTI-SPECIALITY HOSPITALS

J. D. Memorial Hospital	70 M	0.5 Min
S.S. Hospital & Research Centre	160 M	01 Min
Sai Krishna Hospital	800 M	02 Mins
Aasha Multi Speciality Hospital	2.0 Km	04 Mins
Jupiter Hospital	7.0 Km	10 Mins
Bethany Hospital	9.3 Km	18 Min
Horizon's Hospital	9.3 Km	18 Mins
Life Care Hospital	10.5 Km	21 Mins
Hiranandani Hospital	11 Km	22 Mins



MULTIPLEXES AND THEATRES

Cinema Star	6.0 Km	08 Mins
Kala Bhavan	6.8 Km	10 Mins
Cinemax	6.9 Km	10 Mins
Cinepolis	7.0 Km	10 Mins
Dr. Kashinath Ghanekar Auditorium	7.0 Km	10 Mins
Gadkari Rangayatan	9.0 Km	17 Mins



LAKES AND WATERFRONTS

Rewale, Makhmali	6.6 Km	09 Mins
Upvan, Masunda	10.6 Km	21 Mins



AMUSEMENT & WATER PARKS

Tikuji-ni-Wadi	10 Km	20 Mins
Suraj Water Park	11 Km	22 Mins



PUBLIC PARKS

Under Cons. Thane Grand Central Park	4.0 Km	06 Mins
Ovalekar Wadi Butterfly Garden	14.6 Km	28 Mins
Jogger's Park, Patwardhan Park, etc.	29.3 Km	45 Mins
Sanjay Gandhi National Park (Main Entry)	29.9 Km	47 Mins



TEMPLE

Jain Derasar	200 M	01 Min
Hanuman Temple	500 M	02 Mins
Shankar Temple	500 M	02 Mins
Ayyappa Temple	950 M	02 Mins
Ganpati Mandir	950 M	02 Mins
Sai Baba Temple	1.0 Km	05 Mins

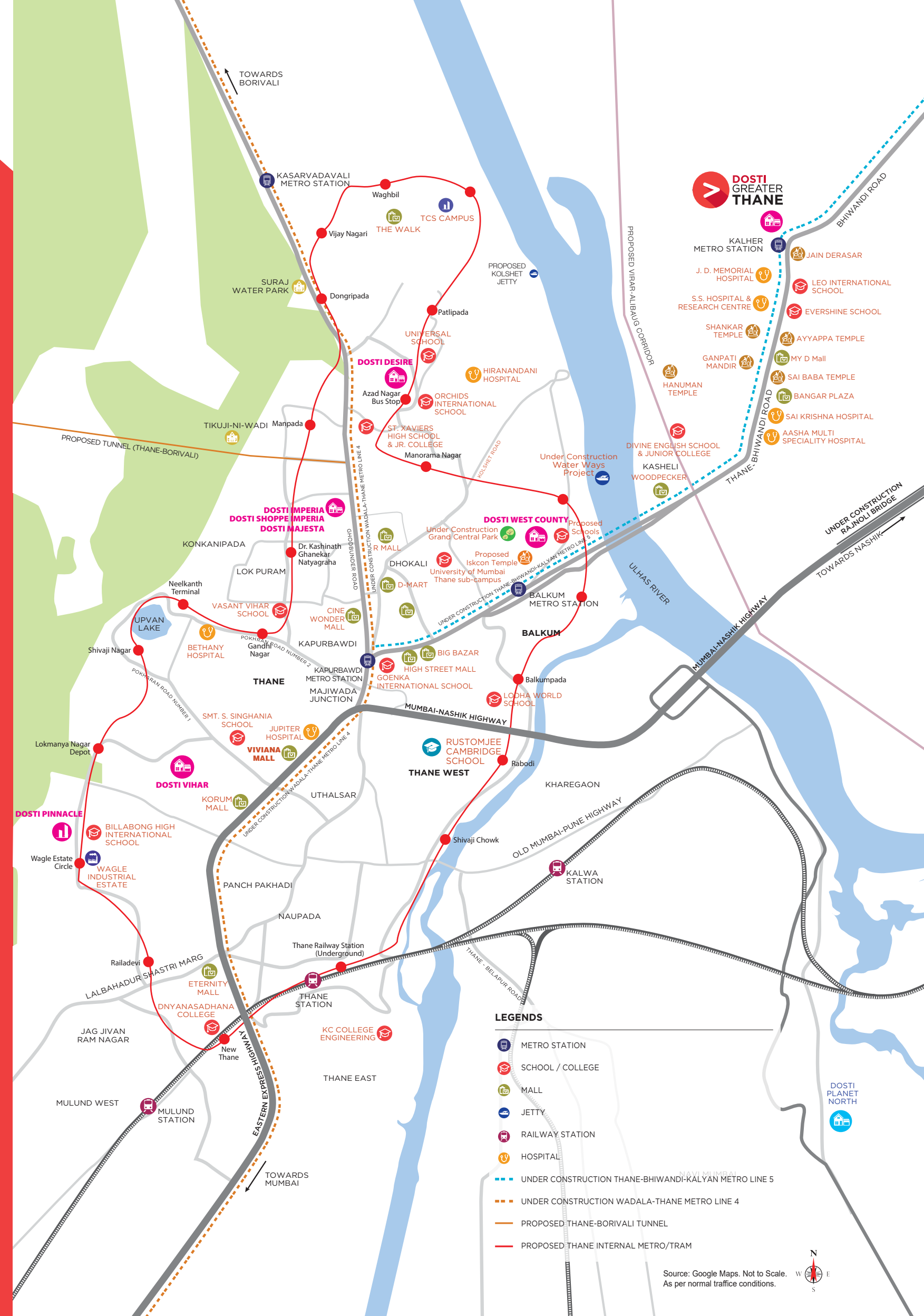

DESIGNED FOR
EFFORTLESS LIVING

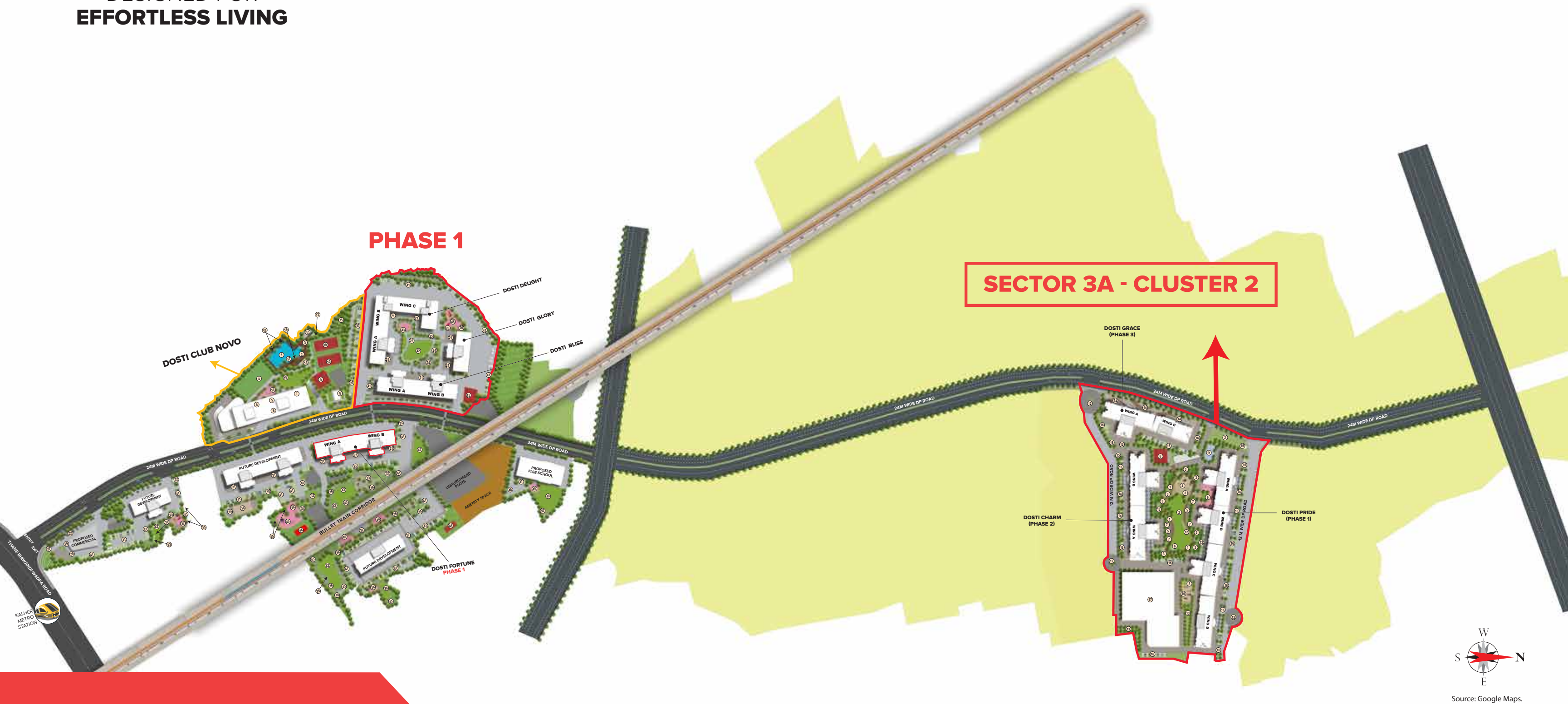

PHASE 1

SECTOR 3A - CLUSTER 2

1100+ TREES TO BE PLANTED IN DOSTI GREATER THANE

CLUBHOUSE OUTDOOR AMENITIES

- 1. Lap Pool
- 2. Kids' Pool
- 3. Pool Deck
- 4. Cricket Pitch / Futsal Court
- 5. Kiosk
- 6. Tropical Planting
- 7. Drop-Off for Clubhouse
- 8. Temple
- 9. Half Basketball Court
- 10. Tennis Court
- 11. Orchard Walk
- 12. Outdoor Shower Area
- 13. Changing Rooms
- 14. Gazebo Seating
- 15. Multipurpose Lawn
- 16. Jacuzzi
- 17. Floating Cabana
- 18. Loungers in Pool
- 19. Kids' Play Area
- 20. Parking Area

RESIDENTIAL SECTOR (PHASE 1)

- 21. Building Drop-Off
- 22. Reflexology Path
- 23. Seating below Trees
- 24. Outdoor Gym
- 25. Interactive Seating
- 26. Senior Citizen Seating
- 27. Stepped Planting
- 28. Shopping Promenade
- 29. Focal Sculpture
- 30. Plaza
- 31. Stepping Stones
- 32. Activity Area
- 33. Security Cabin
- 34. Amphitheatre
- 35. Volleyball Court
- 36. Walking/Jogging Track
- 37. Sculpture
- 38. Yoga Lawn
- 39. Seating Area
- 40. Kids' Play Area
- 41. Parking Area
- 42. Multipurpose Lawn
- 43. Gazebo Seating
- 44. Tennis Court
- 45. Half Basketball Court

SCHOOL AMENITIES

- 46. Plant Nursery
- 47. VIP Parking
- 48. School Bus Drop-Off Area
- 49. Play Lawn
- 50. Stage with Mural Wall

RESIDENTIAL SECTOR (3A - CLUSTER 2)

- 1. Jogging Track
- 2. Multipurpose Lawn
- 3. Seating Area
- 4. Kids' Play Area
- 5. Gazebo
- 6. Amphitheatre
- 7. Lawn
- 8. Multipurpose Court
- 9. Floor Games
- 10. Outdoor Gym
- 11. Skating Rink
- 12. Sculpture
- 13. Plantation
- 14. Shopping Promenade
- 15. Security Cabin
- 16. Parking
- 17. Common Parking Building for the Entire Layout

Dosti Club Novo is a Private Club House in the vicinity of Dosti Greater Thane projects. The right to admission, use and enjoyment of all or any of the facilities/amenities in the Dosti Club Novo is reserved by the Promoters and shall be subject to payment of such admission fees, annual charges and compliance of terms and conditions as may be specified from time to time by the Promoters.

**DOSTI GREATER THANE
SECTOR 3A - CLUSTER 2**

- | | |
|-----------------------|---|
| 1. Jogging Track | 10. Outdoor Gym |
| 2. Multipurpose Lawn | 11. Skating Rink |
| 3. Seating Area | 12. Sculpture |
| 4. Kids' Play Area | 13. Plantation |
| 5. Gazebo | 14. Shopping Promenade |
| 6. Amphitheatre | 15. Security Cabin |
| 7. Lawn | 16. Parking |
| 8. Multipurpose Court | 17. Common Parking Building for the Entire Layout |
| 9. Floor Games | |

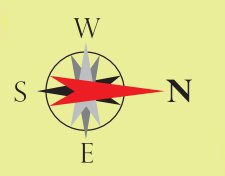

Source: Google Maps.

ENTER ELEGANTLY INTO
A LAND OF SMART OPPORTUNITIES



APPROXIMATELY 1 LAKH SQ.FT CLUBHOUSE
WITH BEST-IN-CLASS AMENITIES



Artist's Impression

Dosti Club Novo is a Private Club House in the vicinity of Dosti Greater Thane projects. The right to admission, use and enjoyment of all or any of the facilities/amenities in the Dosti Club Novo is reserved by the Promoters and shall be subject to payment of such admission fees, annual charges and compliance of terms and conditions as may be specified from time to time by the Promoters.

DISCOVER NEW POSSIBILITIES
EVERY DAY WITH RICH LEISURE ACTIVITIES



Artist's Impression

Dosti Club Novo is a Private Club House in the vicinity of Dosti Greater Thane projects. The right to admission, use and enjoyment of all or any of the facilities/amenities in the Dosti Club Novo is reserved by the Promoters and shall be subject to payment of such admission fees, annual charges and compliance of terms and conditions as may be specified from time to time by the Promoters.

EXPLORE THE DEPTHS OF HAPPINESS
FOR AN EXTRAVAGANT EXPERIENCE



Artist's Impression

Dosti Club Novo is a Private Club House in the vicinity of Dosti Greater Thane projects. The right to admission, use and enjoyment of all or any of the facilities/amenities in the Dosti Club Novo is reserved by the Promoters and shall be subject to payment of such admission fees, annual charges and compliance of terms and conditions as may be specified from time to time by the Promoters.

AMAZING LIFESTYLE

INDULGENCES ENGULFED IN SERENITY.



HALF BASKETBALL COURT

TENNIS COURTS

KID'S POOL

POOL DECK

KIDS' PLAY AREA

CRICKET PITCH / FUTSAL COURT

LAP POOL

A JOYFUL ESCAPE FROM THE DAILY STRESS & WORRIES

OUTDOOR CLUB AMENITIES

- LAP POOL AND KIDS' POOL
- POOL DECK
- OUTDOOR SHOWER
- JACUZZI
- AQUA GYM
- FOUNTAIN WALL
- HALF BASKETBALL COURT
- TENNIS COURTS
- AMPHITHEATRE
- JOGGING TRACK
- KIDS' PLAY AREA / SKATING AREA
- CRICKET PITCH / FUTSAL COURT
- GAZEBO SEATING
- TROPICAL GARDEN
- ORCHARD WALK
- FLOATING CABANAS

INDOOR CLUB AMENITIES

- RESTAURANT
- GAMING ROOM
- BADMINTON COURTS
- BILLIARDS
- MUSIC ROOM
- TABLE TENNIS
- GYMNASIUM
- CARROM & CARDS ROOM
- SPA
- MINI THEATRE
- BANQUET HALLS WITH KITCHENS
- GUEST ROOMS

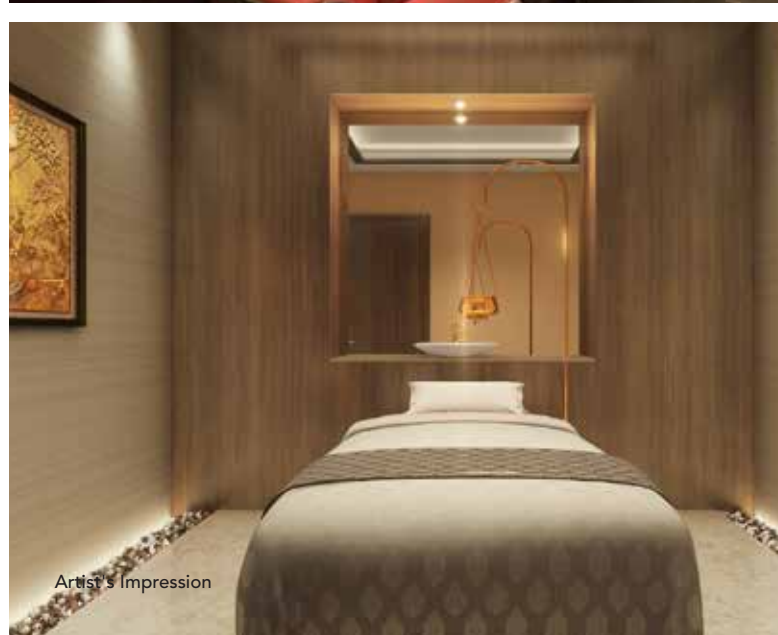

THOUGHTFULLY CRAFTED SPACES
TO ENSURE A GREAT CHILDHOOD



IT'S A GREAT FEELING WHEN YOU
EMBRACE SERENITY FOR A LIFETIME

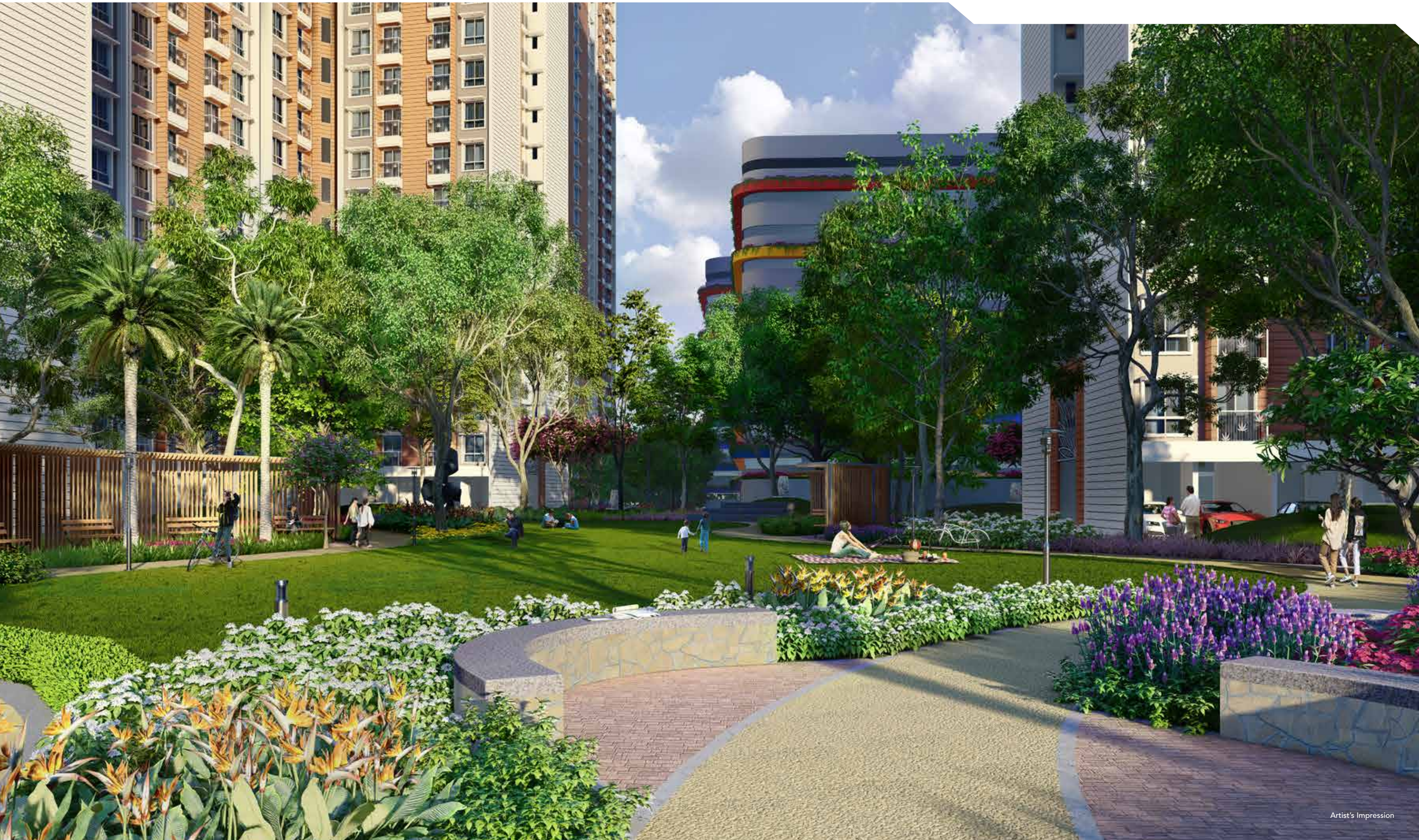

THOUGHTFULLY CRAFTED TO
ENSURE FUN FOR EVERYONE



OUTDOOR RECREATIONS TO BRING OUT THE BEST IN YOU

- JOGGING TRACK
- MULTIPURPOSE LAWN
- SEATING AREA
- KIDS' PLAY AREA
- GAZEBO
- AMPHITHEATRE
- LAWN
- MULTIPURPOSE COURT
- FLOOR GAMES
- OUTDOOR GYM
- SKATING RINK



DISCOVER GREATER CONVENIENCE FOR BETTER LIVING

DOSTI GREATER THANE OFFERS EVERY TYPE OF CONVENIENCE JUST A WALK AWAY.
THE SHOPPING PROMENADE CATERS TO YOUR EVERYDAY NEEDS AND DESIRES.



PROPOSED ICSE SCHOOL

Education is the foundation of a bright future. Taking a step in this direction, a world-class school that will cater to Primary and Secondary Education, shall be in the vicinity of Dosti Greater Thane in order to mould today's young generation into success stories of tomorrow. Admissions are subject to rules & regulations.



INTERNAL SPECIFICATIONS



LIVING ROOM



KITCHEN & DINING



MASTER BEDROOM

FLOORING

- Vitrified flooring in living, dining, bedroom, kitchen and passage

KITCHEN

- Granite kitchen platform with marble support
- Stainless steel sink
- Tile dado above platform

ELECTRICAL

- Electrical wiring & fitting of concealed type P.V.C conduit – good quality wires
- All switches of reputed make
- One ELCB per flat and MCB for each room
- TV, Internet, AC point, ceiling fan point and regulator point in living
- TV, AC point, ceiling fan point and regulator point in bedroom
- Ceiling fan point and regulator in kitchen

DOORS

- Flushed Doors in living, and bedrooms with the laminate finish on both sides

WINDOWS

- Sliding windows with clear glass
- Decorative M.S. railing for living room balcony & kitchen utility
- M.S. grills for bedroom windows
- Mosquito net for bedroom and living room

PAINTING

- All walls painted in premium quality paint

SANITARY

- Anti-skid tiles for all toilets flooring
- All toilets with tiles dado up to beam bottom level
- State-of-the-art CP fittings and sanitary fixtures
- Instant geyser and hot-cold water mixer in shower area
- Dry area – aluminium glass door
- Well-ventilated bathrooms
- Mirror above wash basin
- Elegant false ceilings in toilets

SECURITY

- Intercom system in each flat
- Fire fighting and fire alarm system for entire building

AN ECO-FRIENDLY ENVIRONMENT WITH SAFETY AND SECURITY

At Dosti Greater Thane, we will have you covered from all angles with our Safety & Security System and the smartest innovations built right into your homes. The homes are also thoughtfully designed keeping the well-being of the environment in mind.

- Water Efficient Fixtures to Reduce Water Consumption
- Electricity and Power Backup for Common Areas
- Energy Efficient Lights in Common Areas
- EV Charging Stations for Electrical Car Charging
- Solar Panels for Hot Water
- BMS (Building Maintenance System) Room
- Society office
- Rain Water Harvesting
- Sewage Treatment Plant
- Organic Waste Composter
- Low VOC Paints

BUILDING MANAGEMENT



INTERCOM FACILITY



SOLAR PANELS



EV CHARGING STATION



SEWAGE WATER TREATMENT PLANT



ORGANIC WASTE COMPOSTER



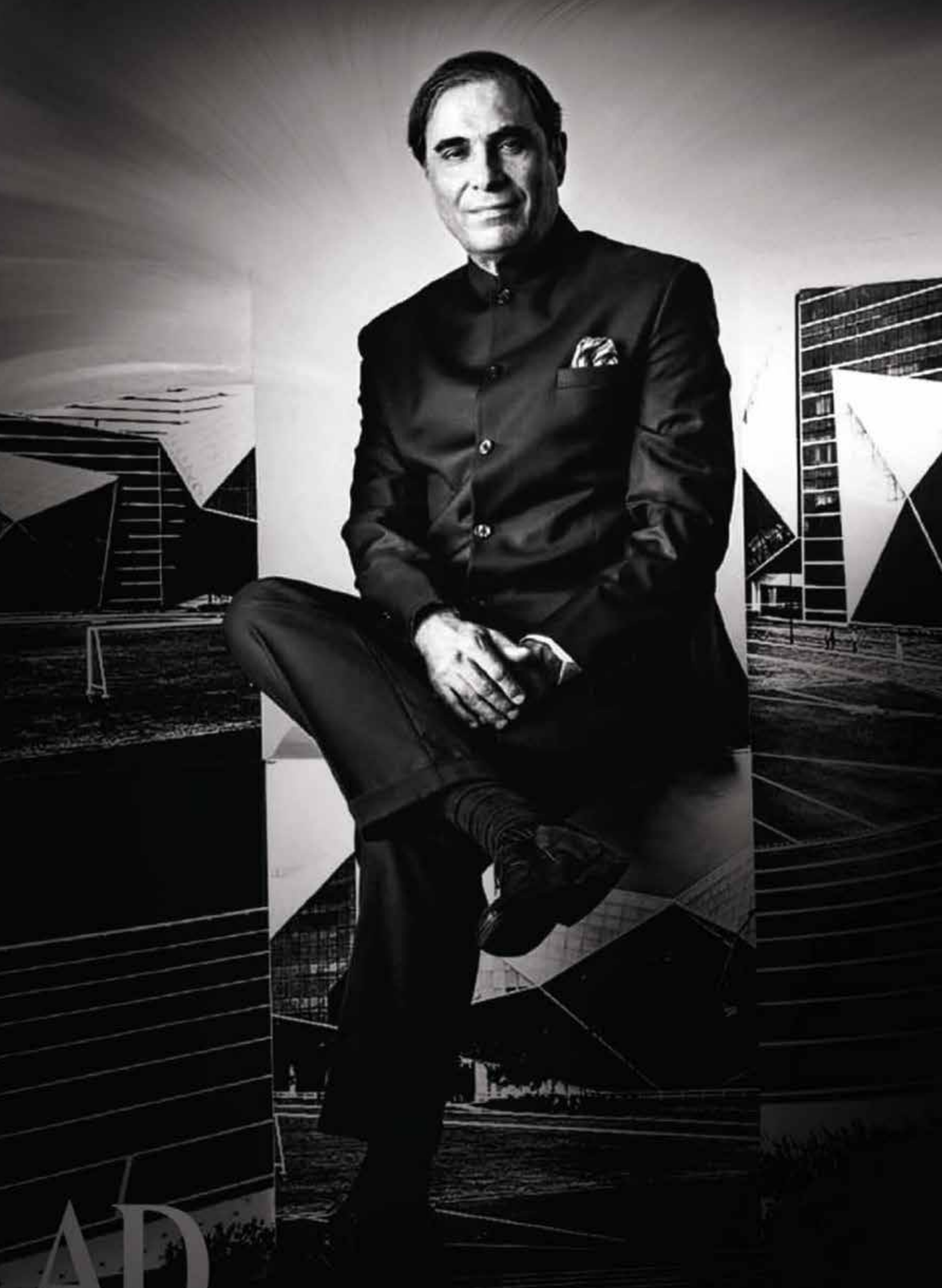

ARCHITECT HAFEEZ CONTRACTOR

PROJECT ARCHITECT

With extraordinary architectural expertise, Architect Hafeez Contractor has impacted the skyline of major Metropolitan Cities of India with an unmistakable identifying stamp. He set up the practice in 1982 with a dedication to design excellence, efficient delivery and sophistication in building technology. Today, Hafeez Contractor heads the largest architectural firm in India, with over 550 team members, comprising of architects, urban/town planners, interior designers, landscape artists, civil engineers, CAD operators and 3D and graphic designers.

He is the winner of over 75 National and International Awards for excellence in contributions to architecture including CWAB Architect of the Year (2006 to 2013), A+D Hall of Fame for the Decade Award. In the year 2016, he was accorded Padma Bhushan, the third Highest Civilian Award in India. He has been included twice in India Today's Most Powerful Indians List in last decade and has won innumerable awards for best residential, commercial, educational and hospitality projects across India. The impressive chart of work that Ar. Contractor catalogs, include some of the tallest structures on the subcontinent, The Imperial Towers, Mumbai; one of the tallest residential buildings in the world, 23 Marina, Dubai, Infosys campus in Shanghai and Hang Zhou. He has modernized the two busiest airports of the country, Mumbai and New Delhi; and one of the best cricket stadiums of the world, DY Patil Stadium, Mumbai.

Mr. Contractor has further designed Dosti Elite, Dosti Flamingo, Dosti Galaxy, Dosti Acres, Dosti Ambrosia, Dosti Greater Thane, Dosti Eastern Bay, Dosti Mezzo 22 and is designing other projects for Dosti in Lower Parel and Pune.

THE TEAM



Mahimtura Consultants Pvt. Ltd.

MCPL- Structural Consultant



Mahimtura Consultants Pvt. Ltd. the pioneering structural & civil engineering giant we know today. With more than 68 years of experience in the construction industry they have grown into a national multi-disciplinary organization with 9 different offices spread across India. They are single-stop answer for all engineering & design demands. They offer the capability of handling any type of project, be it a diminutive dream home or a massive multi-use township complex, their services are provided right from concept development to the overall completion & execution of the project in a timely fashion. Mahimtura Consultants Pvt. Ltd., possess extensive knowledge and expertise in the planning and design of engineering systems of multi-complexes, single component institutions and Infrastructure facilities. They offers a wide range of services & expertise pertaining to all aspects of the construction industry. Their services are highly valuable & dynamic with the capacity to adapt and deliver various integrated end-to-end solutions to any complex situation. Their competence with the latest construction methods & sustainable technologies has earned an enviable track record of being able to excel and deliver on the most challenging of projects. They are a Pan India Company catering to structural design requirements across the Indian subcontinent. The firm is engaged as Structural Consultants and Project Consultants by Individual Clients, as well as various Corporate, and State, Semi & Central Government organizations, all across India. In Mumbai, they are designing many High Rise Residential Towers with number of floors ranging from 30 onwards to 80. They have also designed Dosti Elite, a prestigious project at Sion in the past as well.



PSLDE

PS Landscape Design And Ecology

Landscape Architect

PSLDE started providing Landscape architectural and urban design services from 2007 out of Navi Mumbai. In thirteen years, all types of projects, of both public and private domain, big and small have been designed. The clients include all major developers, hospitality brands, industrial houses and municipalities. The Team consists of landscape architects, architects, civil engineers, visualizers and draftsmen. Design philosophy is user centric. Aesthetics and functionality are governed by how they affect the user. While design narratives make marketing sense, actual product – the way it is designed and executed, is given precedence over all. They focus on to make the outdoor spaces as lively and environmentally and ecologically responsible.



SpaceAge Consultants

Municipal Architect

Spaceage Consultants provide Liaison & Regulatory Consulting Services for Obtaining Development Permissions and Regulatory Approvals for Real Estate Projects. They have In-House expertise for obtaining most approvals, and are engaged in Projects across Mumbai, Thane, Navi Mumbai and Panvel Region.

Their team is a group of dedicated professionals with expertise of Development Regulations and experience across a wide range of projects. Integrity and Perseverance form the core values of the organisation enabling them to gain our clients' trust and appreciation.



S.N.Joshi Consultants Pvt. Ltd.

MEP Consultant



They were established in the year 1991 & are one of the leading consultancy firm offering exclusive engineering and design consultancy services for Real Estate Developers in India. They provide design of HVAC systems, Electrical installations, Fire Fighting, BMS and Plumbing for residential, institutional, and commercial and infrastructure projects. They take pride in timely deliveries of quality outputs and demonstrating high degree of Professionalism. The outputs are well coordinated for all the disciplines as they are executed under the same roof.

The organisation has successfully delivered their expertise in various projects such as Tata Housing Development Project at Kolkatta, DLF Akriti Pune, Viviana Mall Thane, Rohinjan Garden, Auris Serenity & The Xclusiv at Mumbai. S. N. Joshi Consultants Pvt. Ltd. are designing other projects of Dosti Realty such as Dosti Mezzo 22 at Sion and Lower Parel, Mumbai and Residential Township styled project in Pune.

VIGIL JURIS

Solicitors

Vigil Juris Advocates & Solicitors is one of the prominent law firms in India. The Firm has rich legal heritage and specializes in certain corporate and commercial laws. The Firm caters to some of the biggest corporate houses and high networth individuals, providing end to end legal services through its expert and experienced team of lawyers. Dosti Realty Limited has worked with Vigil Juris for over 20 years wherein their consultancy is opted all our projects across Mumbai & Thane.

AWARDS AND ACCOLADES

- Dosti Mezzo 22, Sion - Awarded Iconic Premium Residential Project at Mid-Day International Real Estate & Infrastructure Icons Awards 2022
- Dosti West County - Dosti Nest , Thane (W) - Awarded Iconic Project of the Year at Mid-Day International Real Estate & Infrastructure Icons Awards 2022
- Dosti Eastern Bay, Wadala - Awarded Iconic Residential Project of the Year South Mumbai at the Times Real Estate Conclave & Awards 2021
- Dosti Oro 67, Kandivali (W) - Awarded Upcoming Residential Project - Western Suburbs at the Mid-Day Real Estate International Icons Award 2021
- Dosti Eastern Bay, Wadala - Awarded Iconic Residential Project South Mumbai by Hindustan Times Real Estate Titans 2020
- Dosti Eastern Bay, Wadala - Won Iconic Luxury Homes - South Mumbai by Mid-Day Real Estate Icons Awards 2020
- Dosti Realty - Awarded Developer of the Year (Residential) at the Real Estate Business Excellence Awards, 2020 in association with CNN-News 18.
- Dosti West County, Thane (W) - Awarded Iconic Planned Project Central Mumbai 2019 - Mid-day Real Estate Icons Awards 2019
- Dosti West County, Thane (W) - Awarded Iconic Planned Project Central Mumbai 2019 by Mid-Day Real Estate & Infrastructure Icons Award 2019
- Dosti West County, Thane (W) - Awarded Best Project of the Year Thane in 2018 by Accommodation Times
- Dosti West County, Thane (W) - Awarded Ultimate Residential Project - Thane in 2018 by Hindustan Times
- Dosti Desire, Thane (W) - Awarded Residential Project of the Year Thane in 2018 by Accommodation Times
- Dosti Realty Ltd - Awarded Excellence in Quality Residential Projects by Lokmat Corporate Excellence Awards 2018
- Dosti Realty Ltd - Awarded Best Developer Residential by ET NOW in 2018
- Dosti Realty Ltd - Awarded Best Green Building for Dosti Ambrosia - Wadala by ET NOW in 2018
- Dosti Realty Ltd - Awarded Real Estate Industry Achievement Award - 2017 GroheHurun
- Dosti Desire, Thane (W) - Awarded the Iconic Residential Project, Thane - Mid-Day Real Estate Icons in 2017
- Dosti Realty Ltd - Awarded Iconic Developer Thane by Mid-Day Real Estate Icons (Thane & Navi Mumbai) in 2017
- Dosti Planet North, Shil Thane - Awarded Iconic Residential Project Beyond Thane, Mid-Day Real Estate Icons (Thane & Navi Mumbai) in 2017
- Dosti Planet North, Shil Thane - Certified as Times Realty Icons 2017 Navi Mumbai, Thane & Beyond, in the category of Value Homes in 2017
- Dosti Majesta, Ghodbunder Road, Thane (W) - Certified as Times Realty Icons 2017 Navi Mumbai, Thane & Beyond, in the category of Ultra Luxury Homes in 2017
- Dosti Ambrosia, Wadala - Project of the Year Mumbai at the 31st National Real Estate Awards by Accommodation Times in 2017
- Dosti Ambrosia, Wadala - Awarded Iconic Residential Project - South Mumbai at the Mid-Day Real Estate Icons Awards in 2016
- Dosti Ambrosia, Wadala - Certified Gold Rating under IGBC for Green Building by LEED in 2016
- Dosti Acres, Wadala - Awarded 2nd place at the Exhibition for Gardening at the Veermata Jeejabai Bhosle Garden, Byculla by the Tree Authority and Brihan Mumbai Mahanagarपालिका in 2015
- Dosti Ambrosia, Wadala - Awarded Best Residential Project of the Year by Construction Times in 2015
- Dosti Vihar, Thane (W) - Won the Premium Apartment Project of the Year (West) by NDTV in 2015
- Dosti Realty Ltd - Ranked Mumbai's Top Developer and the Best in Indian Real Estate for on-time delivery and possession by NDTV in 2014
- Dosti Vihar, Thane (W) - Awarded Project of the Year by Accommodation Times in 2014
- Dosti Imperia, Thane (W) - Pre-certified Green Building aiming for Gold rating by LEED in 2013
- Dosti Vihar, Thane (W) - Won the title of an Artist in Concrete Awards for Space Planning in Big Residential projects by REIFY Artisans & Projects Pvt. Ltd. in 2013
- Dosti Realty Ltd - OHSAS 18001: 2007 (in 2018) & ISO 9001:2008 (in 2012) Certified Company by URS
- Dosti Acres, Wadala - Won the Best Maintained Podium Garden by the Municipal Corporation of Mumbai for 3 consecutive years from 2008 onwards
- Dosti Elite, Sion - Won the 3rd Prize for display of class 27-B at the 13th Exhibition for plants, flowers, fruits & vegetables by Municipal Corporation of Mumbai in 2008
- Dosti Elite, Sion - Awarded the Best Maintained Podium Garden for 3 consecutive years
- Dosti Flamingos, Parel-Sewree - Won the Best Maintained Landscaped Garden by the Municipal Corporation of Mumbai in 2005

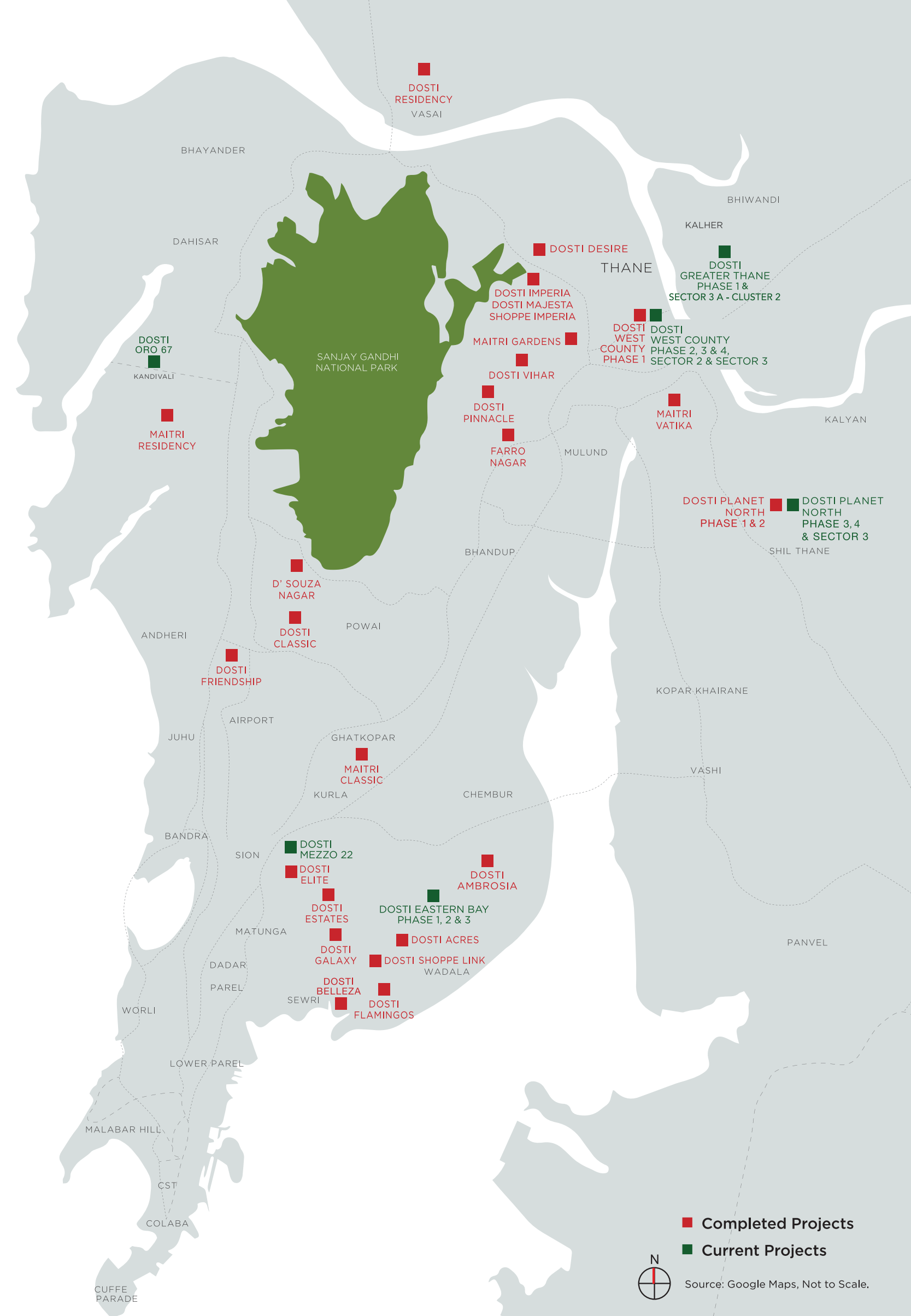

DISCOVER YOUR FRIENDS FOR LIFE

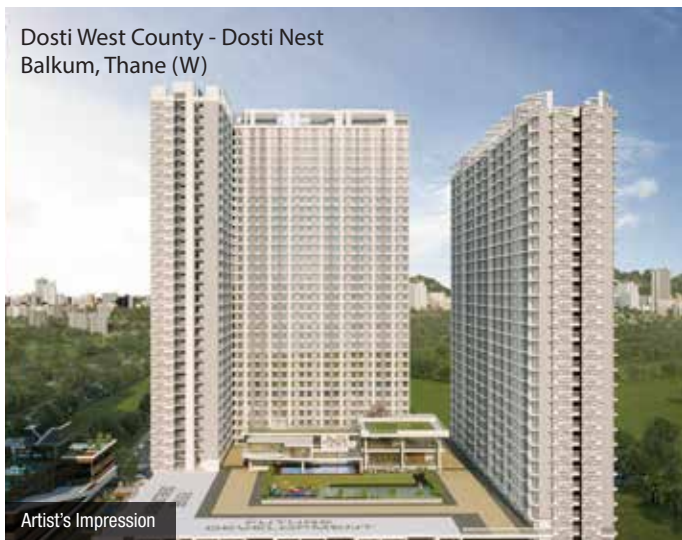

Dosti Eastern Bay Wadala - Phase 1 - MahaRERA No. P51900025142, Phase 2 - MahaRERA No. P51900030769, Phase 3 - MahaRERA No. P51900032067, Dosti West County - Dosti Nest, Balkum, Thane (W) - Phase 1 - MahaRERA No. P51700033640 Phase 2 - MahaRERA No. P51700033663, Dosti West County - Dosti Tulip Balkum, Thane (W) - MahaRERA No. P51700032666, Dosti Mezzo 22 Sion - MahaRERA No. P51900026976 are available on website - <https://maharera.mahaonline.gov.in> under registered projects.

Dosti Realty has been in the real estate business for over 4 decades and delivered more than 127 properties to date, encompassing a portfolio of over 11.44 mn. sq. ft. Currently Dosti Realty is constructing around 6 mn. sq. ft. across Mumbai and Thane. Till date it has sold homes to 15000+ happy families and continues to transform the skyline with its developments. The company has experience in various development types, be it Residential, Retail, IT Parks, etc. Over the years, it has been known for its Aesthetics, Innovation, Quality, Timely Delivery, Trust and Transparency, values that have built lasting relationships.



Site Address: Dosti Greater Thane, Near SS Hospital, Kalher Junction 421 302.

Corp. Address: Adrika Developers Pvt. Ltd., Lawrence & Mayo House, 1st Floor, 276, Dr. D. N. Road, Fort, Mumbai - 400 001 • www.dostirealty.com

Dosti Greater Thane - Phase 1 is registered under MahaRERA No. **P51700024923**, DGT - Sector 3A - Cluster 2 - Phase 1 is registered under MahaRERA No. **P51700048334**, DGT - Sector 3A - Cluster 2 - Phase 2 is registered under MahaRERA No. **P51700048335**, DGT - Sector 3A - Cluster 2 - Phase 3 is registered under MahaRERA No. **P51700048333** and are available on website - <https://maharera.mahaonline.gov.in> under registered projects.

Disclosures: (1) The artist's impressions and stock image are used for representation purpose only. (2) Furniture, fittings and fixtures as shown/displayed in the show flat are for the purpose of showcasing only and do not form part of actual standard amenities to be provided in the flat. The flats offered for sale are unfurnished and all the amenities proposed to be provided in the flat shall be incorporated in the Agreement for Sale. (3) The plans are tentative in nature and proposed but not yet sanctioned. The plans, when sanctioned, may vary from the plans shown herein. (4) Dosti Club Novo is a Private Club House in the vicinity of Dosti Greater Thane projects. The right to admission, use and enjoyment of all or any of the facilities/amenities in the Dosti Club Novo is reserved by the Promoters and shall be subject to payment of such admission fees, annual charges and compliance of terms and conditions as may be specified from time to time by the Promoters. (5) The Bullet Train Corridor, the DP Road, the Existing Road, the School Plot, the Garden Reservation, the Amenity Plot and the Dosti Novo Club House and the Club House Plot shall be formally sub-divided from the rest of the layout Land in due course, and shall not form part of the layout which shall be ultimately conveyed to the Apex Body or Federation. (6) The sale of all the premises in the Dosti Greater Thane projects shall be governed by terms and conditions incorporated in the Agreement for Sale. Dosti Greater Thane - Phase 1 is funded by Kotak Mahindra Bank Ltd and Dosti Greater Thane - Sector 3A - Cluster 2 - Phase 1, 2 & 3 is funded by Kotak Realty Fund.