

F L O O R P L A N S

BRIGADE
NORTHRIDGE

KOGILU ROAD, JAKKUR

BRIGADE NORTHRIDGE

KOGILU ROAD, JAKKUR



DISCLAIMER: The amenities depicted in the master plan and / or the marketing brochure are only indicative and are subject to future variation/s & changes. The Developer reserves the right to add or delete any of the amenities or features shown in master plan or brochure or change its location at its sole discretion. The Developer is wholly exempt from any liability on account of any claim in this regard. E&OE

KEY PLAN



- ★ CORNER UNIT
- ★ PREMIUM UNIT
- ★ PREFERENTIAL LOCATION

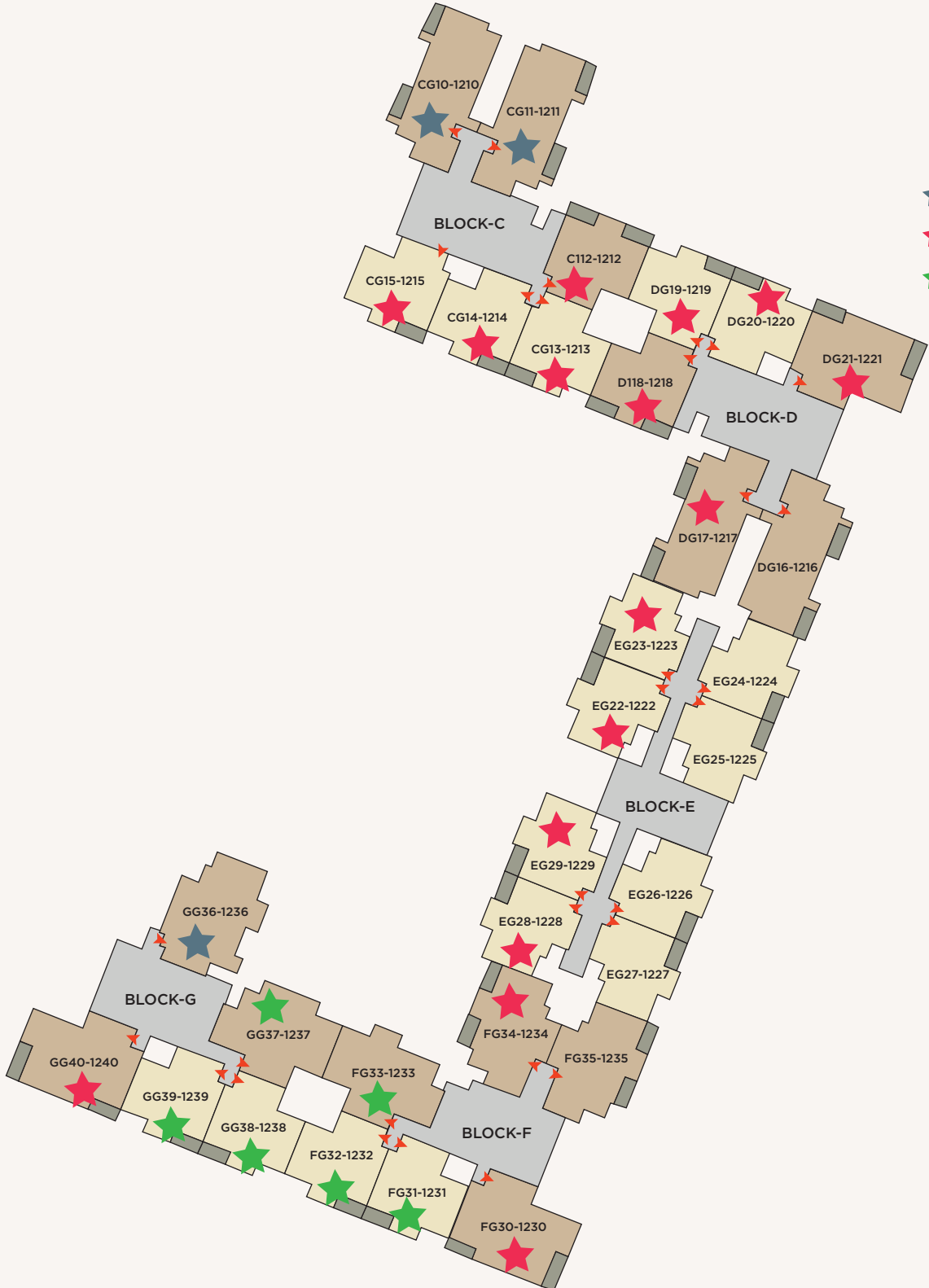

TYPICAL UNIT PLANS



2 BEDROOMS + 2 TOILETS 1230 SQ.FT.

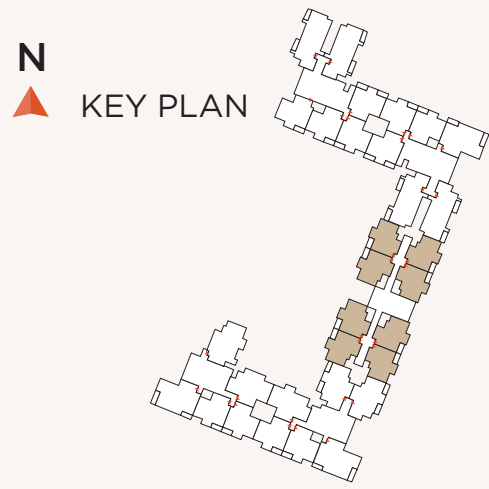

BRIGADE
NORTHRIDGE
KOGILU ROAD, JAKKUR



2 BEDROOMS + 2 TOILETS 1290 SQ.FT.

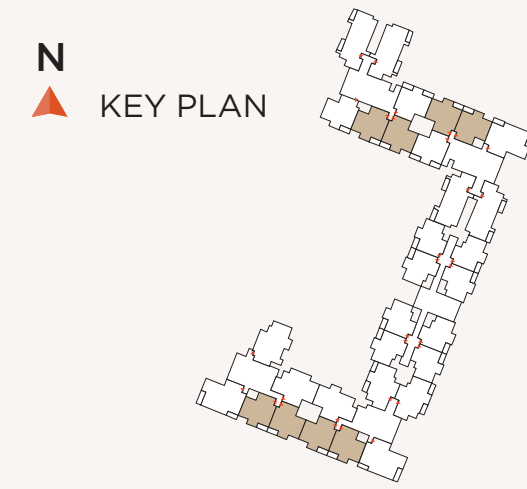

BRIGADE
NORTHRIDGE
KOGILU ROAD, JAKKUR



3 BEDROOMS + 3 TOILETS 1610 SQ.FT.

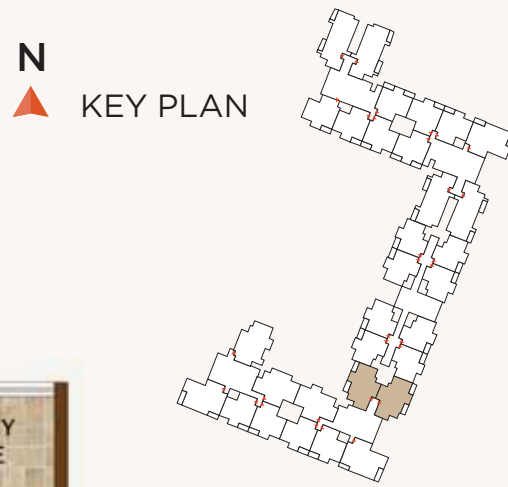

N
▲ KEY PLAN

BRIGADE
NORTHRIDGE
KOGILU ROAD, JAKKUR



3 BEDROOMS + 3 TOILETS 1660 SQ.FT.

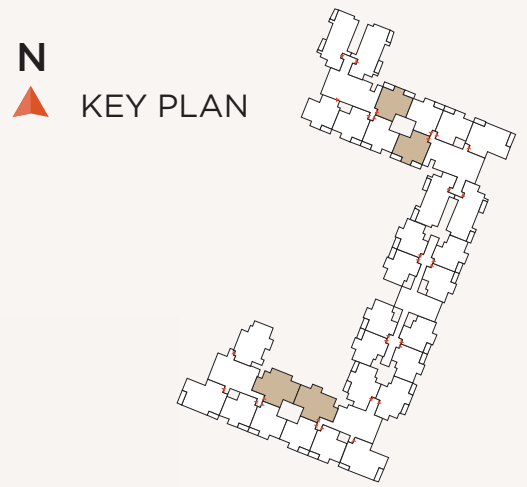

N
▲ KEY PLAN

BRIGADE
NORTHRIDGE
KOGILU ROAD, JAKKUR



3 BEDROOMS + 3 TOILETS 1710 SQ.FT.

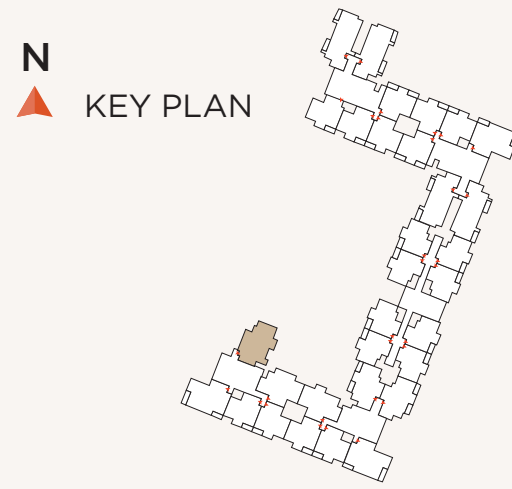

BRIGADE
NORTHRIDGE
KOGILU ROAD, JAKKUR



3 BEDROOMS + 3 TOILETS 1760 SQ.FT.

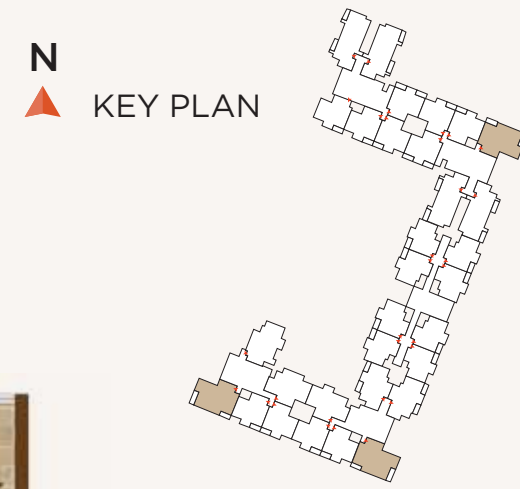

BRIGADE
NORTHRIDGE
KOGILU ROAD, JAKKUR



N
▲ KEY PLAN

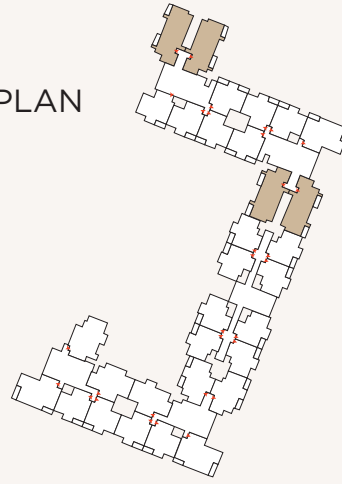

Specifications

Common Area - Flooring

- Waiting lounge / Reception - Marble / Granite
- Staircase - Vitrified tiles
- Lift lobby & Corridors - Vitrified tiles

Apartment Units - Flooring

- Living / Dining / Foyer - Vitrified tiles
- Kitchen - Vitrified tiles
- Master bedroom - Laminated wooden flooring
- Other bedrooms - Vitrified tiles
- Balcony / Deck - Anti-skid ceramic tiles
- Bathrooms - Ceramic tiles
- Servant's room and bathroom - Ceramic tiles

Kitchen

- Provision for modular kitchen
- Provision for water purifier point, refrigerator point and microwave point

Bathrooms

- CP fittings - Jaquar or equivalent
- Sanitary fittings - Parryware or equivalent

Doors & Windows

- Main door to the apartment - Teakwood frame, natural PU lacquer polish shutter & architrave
- Bedroom & Bathroom doors - Hardwood frame, enamel paint shutter & architrave
- Balcony door - UPVC / Aluminium with 3-track bug screen
- Windows - UPVC / Aluminium with bug screen

Painting & Finishes

- Exterior - External texture paint
- Internal ceilings - Oil bound distemper
- Internal walls - Emulsion paint

Air-conditioning

Provision for split air-conditioning in living room and bedrooms

Electricals

- 2-bedroom - 4 kW
- 3-bedroom - 6 kW
- Modular switches - Anchor Viola or equivalent

DG Backup

- 2-bedroom - 2 kW
- 3-bedroom - 3 kW

Others

Rainwater harvesting, Organic waste convertor and Groundwater recharging

3 BEDROOMS + 3 TOILETS + SERVANT'S ROOM 1880 SQ.FT.

BRIGADE
NORTHRIDGE
KOGILU ROAD, JAKKUR

BRIGADE
NORTHRIDGE
KOGILU ROAD, JAKKUR

Location Map

Today, Bangalore North is one of the fastest real estate growth zones in India. Over the years, this part of Bangalore has witnessed rapid development along the Hebbal-Airport corridor, accelerated by the completion of the elevated expressway.



BrigadeNorthRidge.com

The information herein i.e. the master plan, floor plans, furniture layout and fittings, illustrations and specifications are indicative only and subject to variations. The furniture/fittings are representational and are not part of the standard offering. 1 sq.m = 10.764 sq.ft. E&OE



Model Apartment & Marketing Office: Brigade NorthRidge, Kogilu Road, Bangalore.
Also visit us at **Experience Centre:** Ground Level, World Trade Center, Brigade Gateway Campus,
Dr. Rajkumar Road, Malleswaram-Rajajinagar, Bangalore.

Toll-free: 1800-102-9977 | E-mail: salesenquiry@brigadegroup.com | BrigadeNorthRidge.com