



EESHANYA
CONSTRUCTIONS

Building trust, not just homes



— EESHANYA'S —
SYNCHRONY

Luxury Lifestyle Apartment

Rera no : TN/11/Building/0133/2025 dated 09.04.2025





AMENITIES



SEWAGE TREATMENT
PLANT



CCTV CAMERA
SECURITY



LIFT - 3 NO'S



CAR PARKING



NO COMMON
WALLS



LANDSCAPED GARDEN
WITH AVENUE TREES



POWER BACKUP FOR
COMMON AREAS



CHILDREN'S PLAY
AREA



24X7 SECURITY
WITH CABIN



GAS PIPE LINE



SENIOR CITIZEN'S
PLACE



INDIVIDUAL RO
FOR EACH FLAT



FLAT C (1-5), D (1-5), E (1-5), F (1-5), G (1-5), H (1-5), I (1-5), J (1-5)



2 BHK

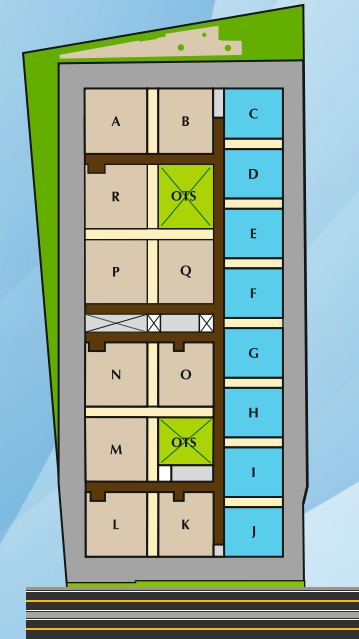

| Unit No. | Unit Type | Facing | Plinth Area (Sq. Ft) | RERA Carpet Area (Sq. Ft) | Total Area (Sq. Ft) | Covered Car Parking |
|----------|-----------|--------|----------------------|---------------------------|---------------------|---------------------|
| C to J | 2 BHK | East | 921 Sq. Ft | 765.66 Sq. Ft | 1145 Sq. Ft | 1 |

FLAT B (1-5), Q (1-5)



2.5 BHK

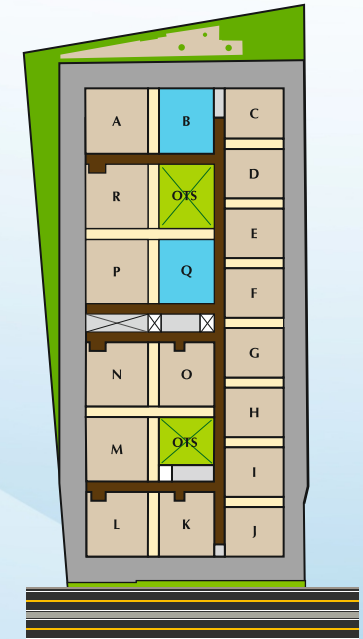

| Unit No. | Unit Type | Facing | Plinth Area (Sq. Ft) | RERA Carpet Area (Sq. Ft) | Total Area (Sq. Ft) | Covered Car Parking |
|----------|-----------|--------|----------------------|---------------------------|---------------------|---------------------|
| B, Q | 2.5 BHK | North | 1115 Sq. Ft | 934.13 Sq. Ft | 1385 Sq. Ft | 1 |

FLAT K (1-5), O (1-5)



2.5 BHK

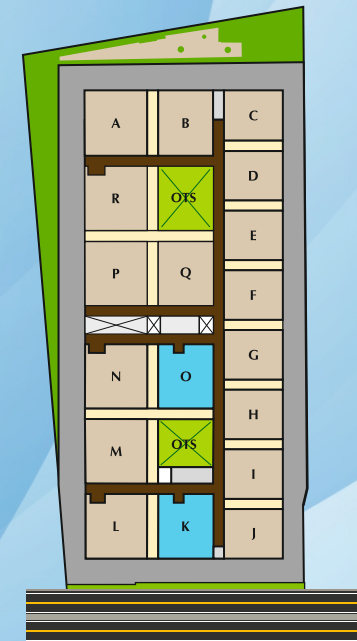

| Unit No. | Unit Type | Facing | Plinth Area (Sq. Ft) | RERA Carpet Area (Sq. Ft) | Saleable Area (Sq. Ft) | Covered Car Parking |
|----------|-----------|--------|----------------------|---------------------------|------------------------|---------------------|
| K, O | 2.5 BHK | East | 1115 Sq. Ft | 932.21 Sq. Ft | 1385 Sq. Ft | 1 |

FLAT L (1-5), N (1-5), R (1-5)



3 BHK

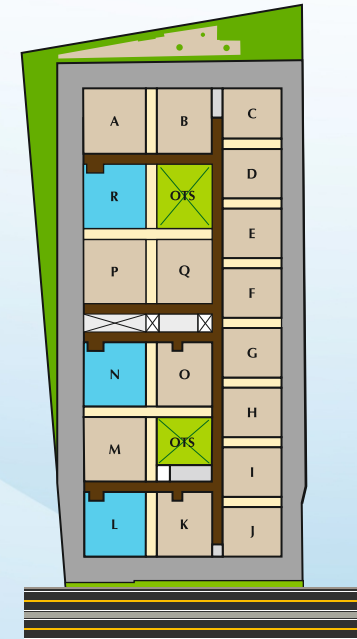

| Unit No. | Unit Type | Facing | Plinth Area (Sq. Ft) | RERA Carpet Area (Sq. Ft) | Total Area (Sq. Ft) | Covered Car Parking |
|----------|-----------|--------|----------------------|---------------------------|---------------------|---------------------|
| L, N, R | 3 BHK | East | 1258 Sq. Ft | 1089.58 Sq. Ft | 1563 Sq. Ft | 1 |

FLAT A (1-5), M (1-5), P (1-5)

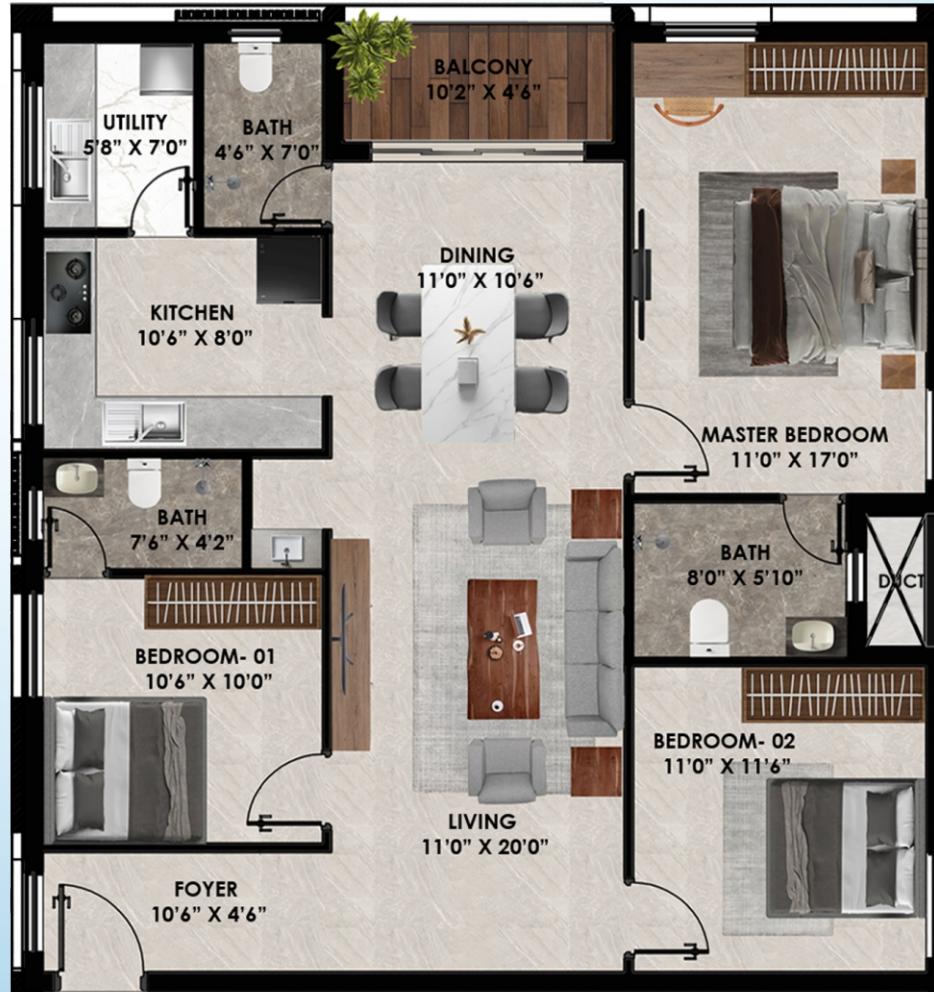

3 BHK

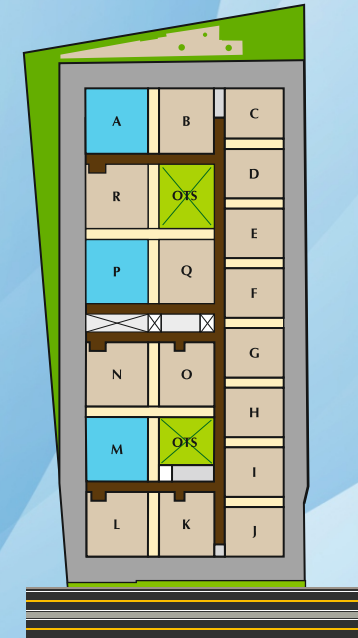

| Unit No. | Unit Type | Facing | Plinth Area (Sq. Ft) | RERA Carpet Area (Sq. Ft) | Total Area (Sq. Ft) | Covered Car Parking |
|----------|-----------|--------|----------------------|---------------------------|---------------------|---------------------|
| A, M, P | 3 BHK | North | 1254 Sq. Ft | 1088.23 Sq. Ft | 1558 Sq. Ft | 1 |

SPECIFICATIONS

| | |
|---------------------|--|
| Structure | RCC framed structure with earthquake resistance. |
| Flooring & Tiles | <p>Living Area : Branded vitrified tiles.</p> <p>Lift Lobbies & Common Area : Tile/granite flooring with MS handrails.</p> <p>Car Parking : VDF Stamp Flooring</p> <p>Kitchen : Vitrified tiles (7 ft height), polished granite slab with full-nosed edges</p> <p>Balcony & Utility : Anti-Skid Ceramic/ Vitrified tiles.</p> <p>Toilets : Branded anti-skid tiles for flooring and wall dado up to roof height with false ceiling.</p> <p>Terrace : Weather proofing treatment.</p> |
| Painting | <p>Interior (Living, Dining, Bedrooms, Kitchen) : 2 coats of putty, 1 coat of primer, 2 coats premium emulsion.</p> <p>Exterior : As per Architect's design.</p> |
| Electrical | <p>Wiring : Copper wires from leading brands (e.g., Finolex).</p> <p>Switches : Crompton/ GM or Equivalent.</p> <p>Kitchen : Provision for chimney, exhaust, water filter, and common electrical points.</p> <p>Bedrooms : Common electrical points with split AC provision.</p> <p>Utility : Points for washing machine, dishwasher, and dryer.</p> <p>Bathrooms : Geyser & exhaust provision with required points.</p> <p>Ups : UPS provision setup will be provided.</p> |
| Plumbing | <p>Kitchen : SS sink with Plumbing points & RO Water inlet.</p> <p>Utility : SS Sink with Washing Machine and Dish Washer provision</p> <p>Bathrooms : Branded CP & Sanitary fittings with Towel rod</p> <p>Sanitary & CP Fittings : Jaguar or Equivalent</p> |
| Doors & Windows | <p>Entrance Door : Designer wood panel with ready-made paneled door & lock.</p> <p>Bedrooms : Readymade flush doors.</p> <p>Bathrooms : Waterproof doors.</p> <p>Windows and ventilators : UPVC with glass shutters & metal grills.</p> |
| Additional Features | <p>Drinking Water : Individual branded 8-10L RO filter per flat.</p> <p>Lifts : Lifts with power backup.</p> <p>Security : Security room with automatic boom barrier.</p> <p>Sewage Treatment : Centralized STP.</p> <p>Safety : 24x7 CCTV surveillance.</p> |

Rera No : TN/11/Building/0133/2025 dated 09.04.2025

* Note: EB, Tax, Water Connection, Registration at extra cost.

OTHER PROJECTS



WHITE MEADOWS
Building Trust Not Just Homes

EESHANYA
Tropique
"Poetry of nature"



Aādhyā

EESHANYA
one



CLASSIC MEADOWS

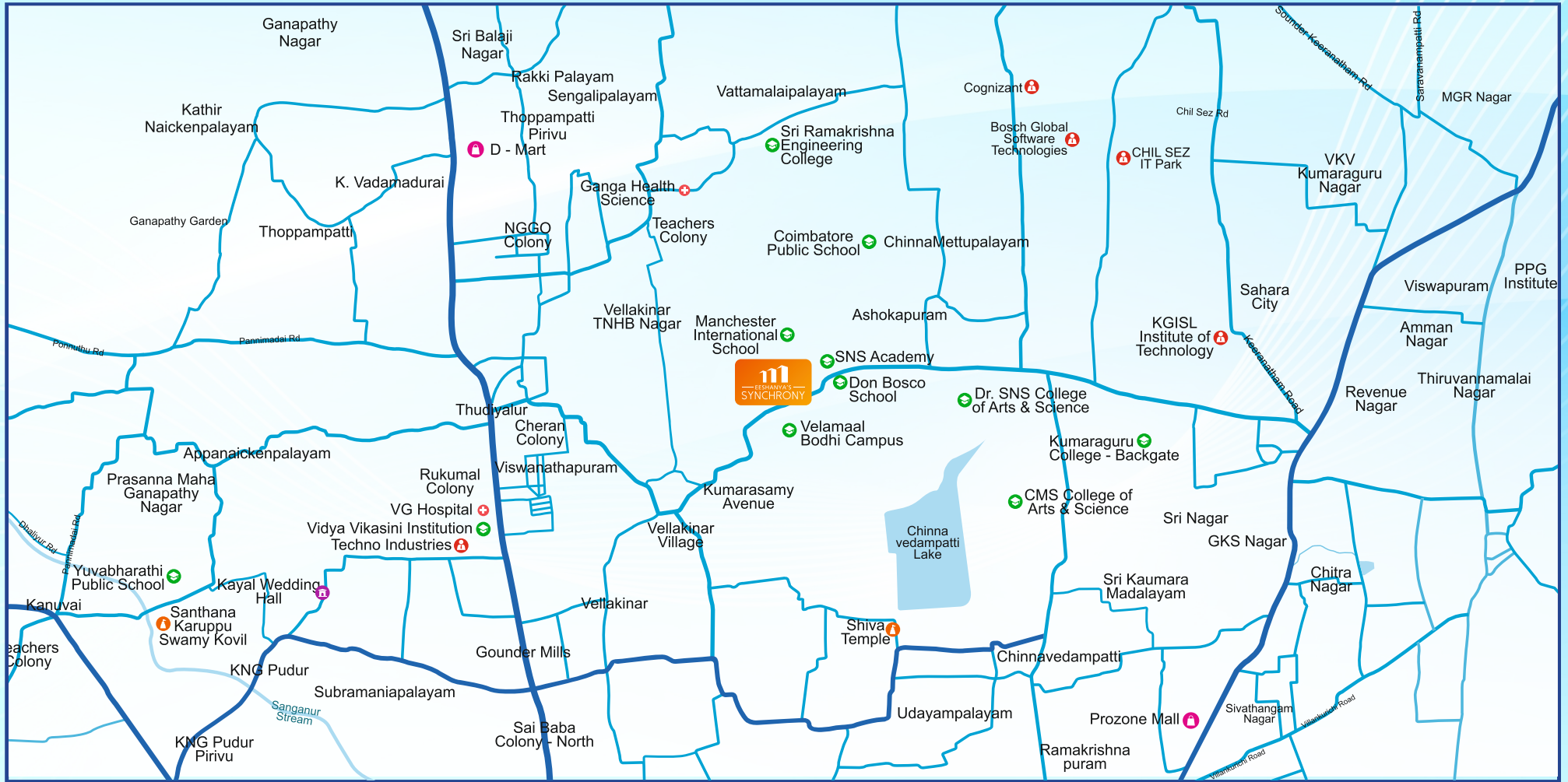

Eeshanya Constructions, 1st Floor, Above Naturals Saloon,
GKS Nagar Main Road, Saravanampatti, Coimbatore - 641035

Contact : +91 96559 12777, 96559 11771, 63032 43902



Disclaimer: All the Floor plans, elevations, Amenities, drawings, facilities, surrounding infrastructure, image renders, interior renders herein are purely indicative and for representational purposes and may differ from the actuals. Revision, alteration, modification, addition, deletion, substitution or recast, if any, may be necessary during construction.