

Alpine

144 PREMIUM 2 & 3 BHK HOMES &
38 SMART SHOPS

— A Project By —



PUSHPRIT
REALTY

📍 Hirawadi Road, Amrutdham, Panchavati, Nashik



ABOUT US

At Pushprit Realty, we are a dedicated team of four partners, each bringing a wealth of experience from our backgrounds in civil engineering and a strong track record in leading companies in the industry.

ALPINE is a revolution in design-thinking. A revolution in the way we think about homes. At ALPINE, every single experience has been deeply thought about and taken to a level that hardly anyone could have imagined. Be it our apartments, our landscaping, our amenities - you will find that every experience is designed to blow you away. And you'll see how every space at ALPINE has been designed around these experiences. The more you learn about Alpine, the more you will realise how unique and revolutionary it is. At ALPINE, you will see how

design can change your world.



SERENE LIVING, TAILORED FOR YOU

35+

TOP-NOTCH
AMENITIES



SOUTHWEST CORNER VIEW



HOMES LIKE YOU'VE NEVER SEEN BEFORE

At ALPINE, our greatest focus has been the experience of our apartments. We've thought about every inch, every function and every corner of your house. We've obsessed about the view and the orientation of each and every apartment. The result? Huge windows, picture perfect views and floor plans that make more sense than they ever did before.



**ELEGANTLY CRAFTED SPACES,
ARTFULLY DESIGNED**

144	38
PREMIUM APARTMENTS	SMART SHOPS



SOUTH SIDE FRONT ELEVATION



ELEVATE YOUR LIFESTYLE WITH 2 LUSH PODIUM AND 3 TERRACE GARDENS

The Podium Garden offers a serene, elevated space for residents to unwind amidst lush greenery. It serves as a peaceful retreat, perfect for relaxation and social gatherings, away from the hustle of the city.

The Terrace Garden adds a touch of tranquility, providing an open, refreshing environment with panoramic views. Designed to enhance outdoor living, it's an ideal spot for leisure, fitness, or simply enjoying the natural surroundings. Both gardens create a harmonious blend of nature and luxury.





**EXPERIENCE UNPARALLELED LUXURY IN 31000 sqft
STATE-OF-THE-ART AMENITIES THAT ELEVATE EVERYDAY LIVING.**



NOT JUST AMENITIES - BUT EXPERIENCES

Everyone talks about 'world class amenities', and sure, we have them all at ALPINE. But what we think deeply about is the experience of each amenity. And this kind of design thinking results in amenities that go far beyond serving their function that become epic, unforgettable experiences.





Sand Pit



Lily Pond



Accupressure
Pathway



Adventure
Park



Herb
Garden



Ninja Line



Barbeque
Corner



Designer
Lobby



Party Lawn



Yoga Deck



Star Gazing



Floor
Games



Senior
Citizens Corner



Childrens
Play Area



Community
Lawn



Open Green
Gym



Hammock
Garden



Temple
Pavillion



Cricket Turf



Pergola



Amphitheater



SAIBABA CHAVDI



PODIUM GARDEN
A AND B WING



CHILDRENS PLAY AREA





GREEN GYM



PODIUM GARDEN
B AND C WING



FLOOR GAMES

FLOOR PLAN

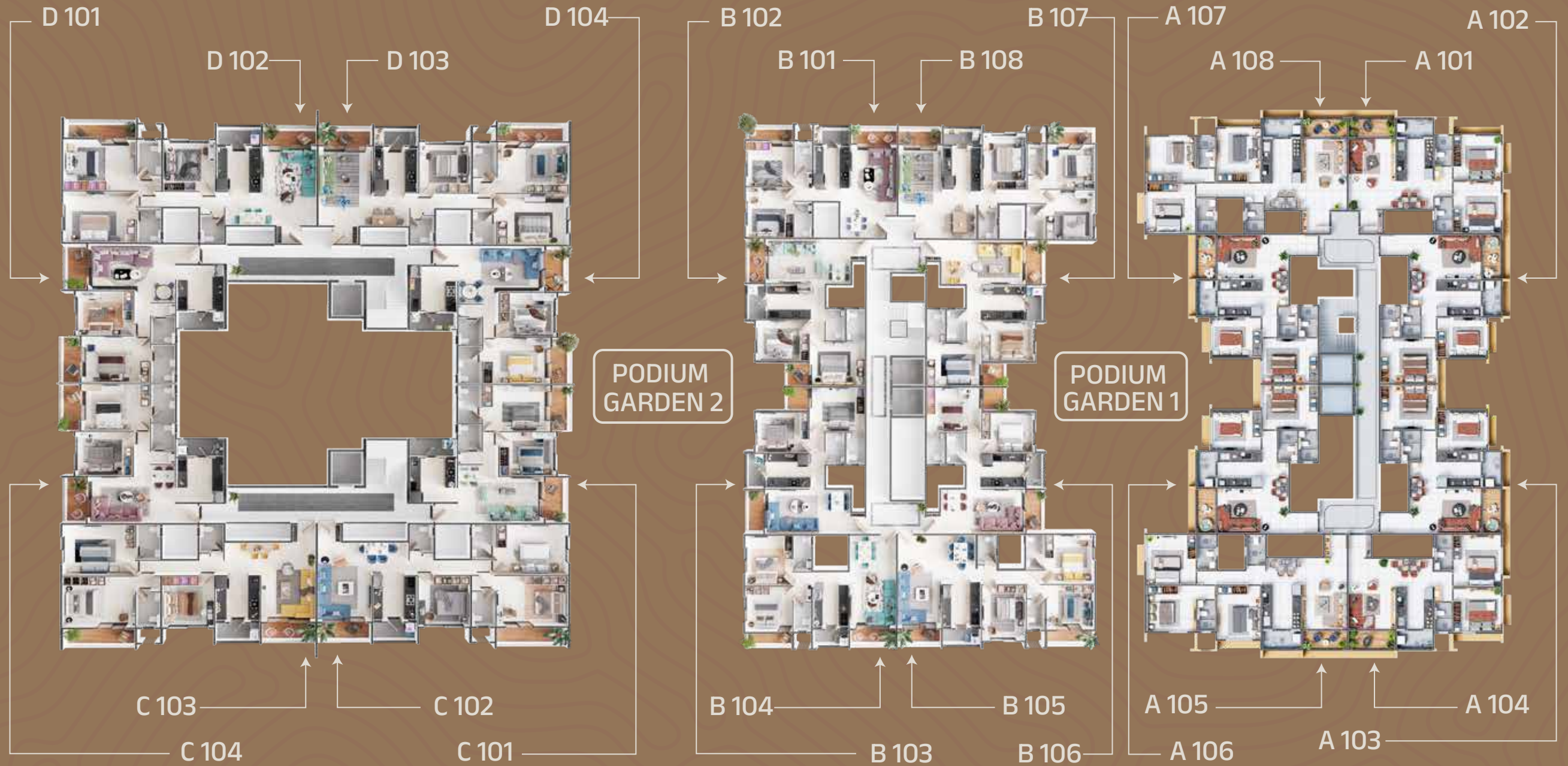

C/D WING

B WING

A WING



B WING PREMIUM 2 BHK



EAST / WEST
FACING

B WING LUXURIOUS 2 BHK



B WING LAVISH 3 BHK



C WING LUXURIOUS 2 BHK



C WING GRAND 3 BHK

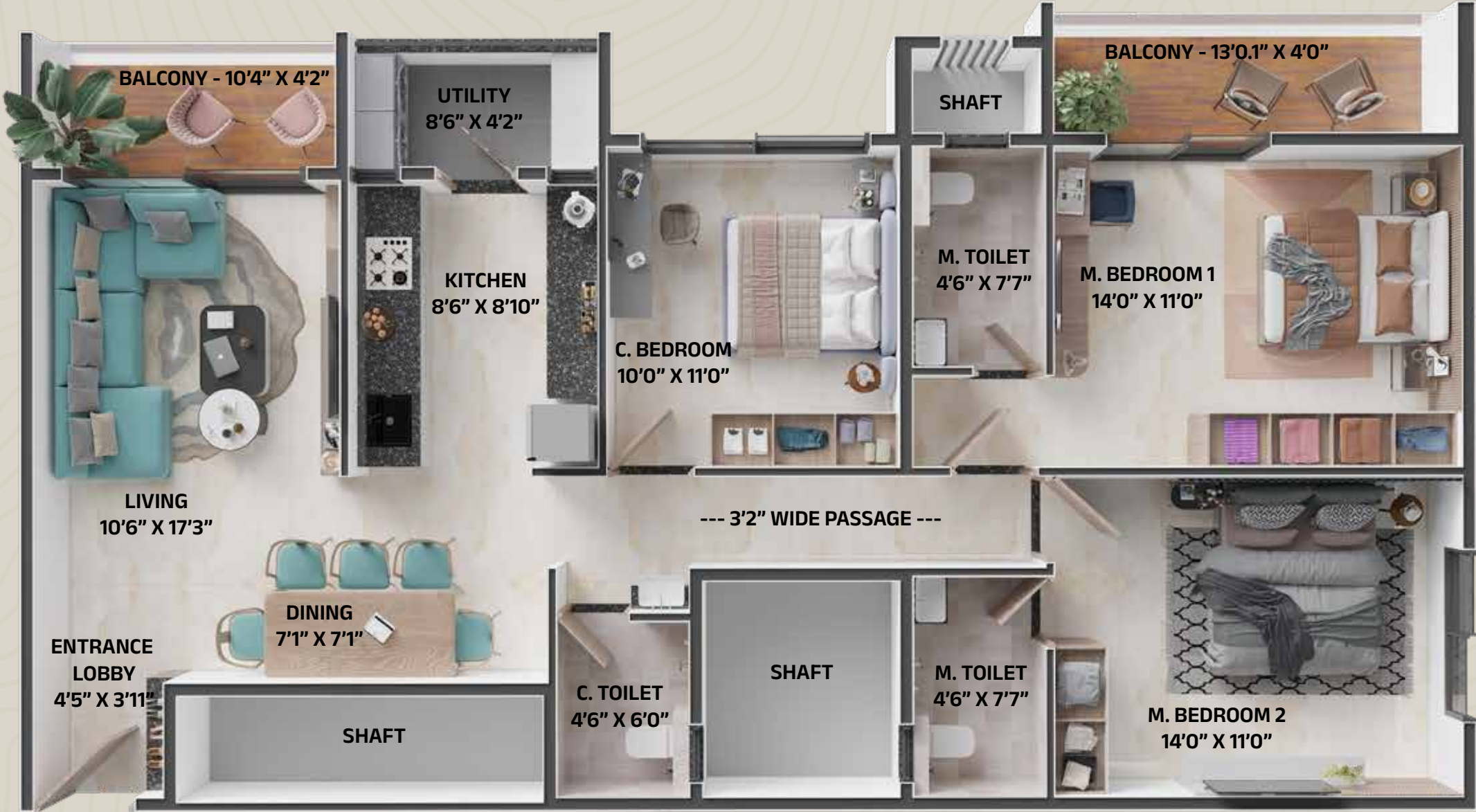

NORTH FACING



**38 CONVENIENT SHOPS MAKING LIFE EASY
BY BRING EVERYTHING SO NEARER TO YOU.**

SPECIFICATION

1. STRUCTURE

- Earthquake Resistant RCC framed Structure.

2. WALL AND CEILING

- 6" Thick External Wall and 4" Thick Internal Wall with AAC BLOCK.
- On External Surface, Two Coat Sand faced Plaster and Weather Shied Paint along with Primer.
- On Internal Surface, One Coat Sand faced Plaster and Second Coat of Gypsum Punning along with Primer and Emulsion Paints.

3. KITCHEN

- Granite Kitchen Platform with designer Ceramic Sink and Cladding till
- Lintel Level attached with Dry Balcony.
- Chimney, Refrigerator, Mixer, Micro-oven Point in Kitchen and Washing Machine Point in Dry Balcony.

4. FLOORING

- Vitrified Tiles for Hall, Kitchen and all Bedroom.
- Antiskid Ceramic Tiles for Bathroom.
- Dado in Bathroom, Kitchen and around Washbasin.
- Granite for Staircase.

5. BATHROOM AND TOILET

- C.P fitting of Jaquar, Cera or Equivalent Make.
- White Sanitary Ware of Jaquar, Cera, or Equivalent Make.
- Provision for Geyser and Exhaust Fan.
- Concealed Plumbing.
- Waterproofing for all Bathroom and Toilet.
- Designer Tiles with Highlighter till Dado.



NEROLAC

POLLENS[®]
GRANITO

 **legrand**

UltraTech
CEMENT
The Engineer's Choice

ICON STEEL
TMT BARS

SPECIFICATION

6. DOORS

- Decorative Main Door with Wooden Frame along with Europa/Godrej Night Latch.
- Internal Door with Granite Frame and Laminate on Both Side.
- Fully Openable Powder Coated French Door for Kitchen.

7. WINDOWS

- Anodised /Powder Coated, 3 Track Aluminum Sliding Window with Mosquito Net and MS Grill.
- Granite Frame for all Windows.

8. ELECTRICAL

- Adequate Light Points in each room.
- Concealed Copper Wiring with Modular Switches of Legrand.
- Inventor Point with its Wiring.
- For Electrical Safety, ELCB and MCB Switches.
- Sensor and Timer for Common Lighting, to save electricity.

9. PLUMBING

- Concealing CPVC/ UPVC Waterlines of Astral/Paras.
- Separate Grey water, Black water and Storm water Lines.

10. GRILLS

- SS Grills with Toughened Glass for Balcony

11. PARKING

- 5 Guest Parking to welcome your Guest
- Alloted Parking to each Flat
- Paver Block with attractive Landscaping
- CCTV Camera and Security Gate.



SAMPLE FLAT



— A Project By —



PUSHPRIT
REALTY

WE ARE PROUD TO BE ASSOCIATED WITH THE LEGENDS

CREDITS:

Architects: Ar. Sumit and Bansri Kumath
Structural Consultant: Strudcom Consultants Pvt. Ltd.

Legal Advisor: Adv. Santosh Shetty

Approved By SBI, HDFC Bank, ICICI Bank, and many more



CONTACT:

Directors:
Pushkar Lunkad, ACM NICMAR, B.E Civil : 94211 78895
Pritam Jain, M.E Structure, B.E Civil : 99600 99888
Ashish Bora, M.E Structure, B.E Civil : 84468 89495
Rahul Burad, M.com, Indratara Group.

Contact: +91 9 130 130 160 (Office)
Email: pushpritrealty@gmail.com
Website: www.pushpritrealty.com

Corporate Address: Sr. No. 204, Opp. Nova Hospital, Amrutdham
Link Road, Hirawadi, Panchavati, Nashik.

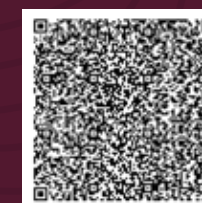

SCAN FOR LOCATION



MRN. P51600051628

The amenities are indicative, based on the construction of building as is proposed at present and is issued in good faith, subject to approval by authorities or in the interest of continuous improvement of the project. The Promoters/Developers reserve the right to alter the layout, plans, specifications, or features without prior notice or obligation. The details contained in the brochure or any other printed material are only indicative and artistic imagination, and may not be exact or accurate, and the same does not form either the basis or part of the offer or contract. All project elevations are artistic designs. MAHA RERA REGISTRATION No. P51600051628 and is available on Website <https://maharera.mahaonline.gov.in>. Terms and conditions apply.