



**WESTLINE GROUP**  
BUILDING TRUST BRICK BY BRICK

**: CONTACTS :**

+91 99000 33888

+91 99000 72752

**[www.westlinebuilders.com](http://www.westlinebuilders.com)**

[properties@westlinebuilders.com](mailto:properties@westlinebuilders.com)

Mangalore Gate Building, Kankanady Circle  
Mangalore 575 002

- DISCLAIMER -

THE IMAGES SHOWN IN THIS BROCHURE ARE ARTISTIC IMPRESSIONS OF THE PROJECT. THE ARCHITECT OR THE PROMOTER RESERVE THE RIGHTS TO CHANGE OR IMPROVISE THE LOOK, FEEL AND CONTENT OF THESE ELEVATION, GARDEN OR SPACES

# WESTLINE SIGNATURE, HERALDING NEW TRENDS AND LEAVING A LEGACY



## STRIVING FOR A GREEN BUILDING CONCEPT

Going green in design is an exclusive and path breaking feature of 'Westline Signature'. With construction activity causing significant impact on environment in our country there is increasing focus on eco construction, also known as green buildings. Westline stands for energy efficient construction and the same shall give the project an aura of being trendy yet with concern for a healthier environment.

## THE GRAND LOBBY A REFLECTION OF THE LUXURIOSNESS

At Signature no effort is lost to provide an innovative and eye catching concept of a lobby that can reflect the opulence of the apartments. The spacious, stylish, double-height lobby with concealed elevator space and ample natural light is simply awe-inspiring. The lobby is interconnected with entry to the spacious indoor games area, modern library, mini movie theatre and exit to the gardens creating an impression of ultimate grandeur.

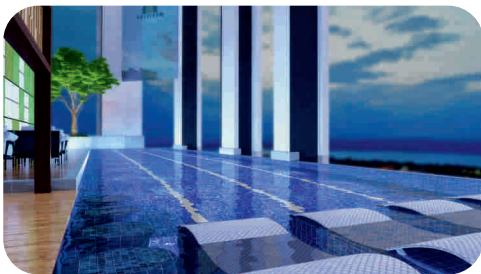

## AN IDEAL WAY TO SKYLARK, RELAX AND ENJOY WITH FAMILY

'Westline Signature' is going to be the epitome of a home of your dreams. When it comes to opulent lifestyle amenities there is nothing to what Signature has in store for its inhabitants. Signature comes with an Infinity lap swimming pool, a wading pool and also a Jacuzzi - just the perfect tonic to rejuvenate a tired body and mind. There is also the pool juice bar and vertical green walls in the pool area to complement the milieu and make it a fun-filled, invigorating and recreational activity for the entire family.

## WATCHING MOVIE IN THE COMFORTS OF YOUR HOME

After a hectic day out at work or a tiring time at school/college residents can relax and unwind in the evening or during holidays and weekends by cosying up on these couches to watch a film. You can make it a special family occasion or choose to enjoy a movie with friends. It is a great place to spend some quiet but pleasurable leisure time.



## BE SPORTIVE BY CHOOSING FROM AN ARRAY OF INDOOR AND OUTDOOR GAMES

Recreation coupled with fitness is an essential pre-requisite to enjoy and lead life king-size. Gym and health club facilities apart, residents can choose from a number of indoor and outdoor games as part of their fitness and recreation regime. Indulge and unwind with little competition in the form of indoor leisure games like Billiards, snooker or table tennis. For those who prefer outdoor games there are basket ball and monkey bar gym. Whatever form of game or sport you choose you sure gonna love it.

## LIBRARY, YOGA, JACUZZI, SAUNA, STEAM AND MASSAGE FURTHER HELP TONE YOUR BODY AND SOUL

Yoga has become the fitness mantra these days. You can be smart and stay fit and healthy with regular yoga exercises. The roof top yoga space overlooking the Arabian Sea provides you an idyllic milieu to rejuvenate your senses with yoga and meditation. Soak in the pristine beauty of nature, breathing in the fresh air to keep you refreshed. The same open space is ideal for aerobic buffs as well. A sophisticated open air Jacuzzi, Sauna and Steam is ready to rejuvenate you after a long tiring day will only add up to your smiles.

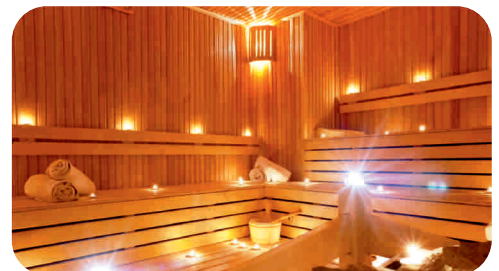

## YOUR EXEMPLARY HOME IS YOUR UN-UNEQUALLED LIFESTYLE

Westline Signature offers you an unbeatable 80% Lung Space; which mean only 20% of the land is used as the building foot print. This beautifully elevated land on a hillock surrounded with beautifully sculpted landscape and greenery offers you an irresistible heaven-on-earth kind of home. With walking tracks, cycling track and resting pods, amphitheatre, children play area, green walls and water bodies it is surely a home you always dreamt of owning. It's elegance and central location with pristine environs is sure to grab eyeballs and envious looks.