

Homes that leave an impression, every time!



**SG**  
impressions PLUS

2/3/4 BR APARTMENTS • NH-58, RAJNAGAR EXT., GZB



# SG impressions PLUS

impressive features with impressive functionality

## LOCATIONAL ADVANTAGE

- Situated on NH-58 - A new 6 lane highway being developed to bypass the congested area of Ghaziabad
- Adjoining the 2000 acre green belt.

## VALUE FOR MONEY

- On 45m Wide Road • Freehold • Neo-rich Specification
- Centrally Landscaped Park • Health Club & Gymnasium
- Well Ventilated Apartments • Adequate Power Back-up\*
- Dedicated Parking Space\* • Option of 2,3,4 Bedroom Apartments • 2 Tier Security • Commercial Area within Project



\*Additional Charges



Not an actual picture



## BUDGET HOMES 2/3/4 BR OPTIONS AESTHETICALLY DESIGNED RAJNAGAR EXT., (GZB, NH-58)

## Specifications

### KITCHEN

**Floors:** Vitrified Tiles **Doors & Windows:** Flush Door **Walls:** Ceramic tiles upto 2 feet on working counter **Electrical Fittings:** Modular switches  
**Fixtures & Fittings:** Granite counter, stainless steel sink & wooden cabinet below the kitchen working counter

### BALCONIES

**Floors:** Ceramic Tiles **Railing:** M-Steel Railings **Ceiling:** Texture Paint

### LIFT LOBBIES/CORRIDORS

**Floors:** Baroda Green with white marble **Walls:** Oil Distemper **Ceiling:** Oil Distemper  
**Fixtures & Fittings:** Adequate light points

### STAIRCASE

**Floors:** Baroda Green with white marble

### EXTERIOR

**Outer Finishing:** Weather proof coating

### DRAWING & DINING ROOM

**Floors:** Vitrified Tiles **Doors & Windows:** M.S. Frame and Flush Door Shutter  
**Walls:** POP Cornice & Oil bound Distemper **Electrical Fittings:** Modular switches telephone cable outlet etc.

### BEDROOMS

**Floors:** Vitrified Tiles  
**Doors & Windows:** M.S. Frame and Flush Door **Walls:** POP Cornice & Oil bound Distemper Paint **Electrical Fittings:** Modular switches telephone cable outlet  
**Fixtures & Fittings:** Wooden Almirah in Master Bedroom only

### TOILETS

**Floors:** Floor Tiles **Doors & Windows:** Wooden Flush Door **Walls:** Ceramic tiles upto 7 feet  
**Electrical Fittings:** Arrangement of hot & cold water, western seat with cistern of Hindware or its equivalent washbasin with CP fittings (ISI mark)



**AREA**  
1150 sq. ft.

3 B/R  
Drawing/Dining  
Kitchen  
2 Toilets  
1 Wide Balcony



ENT.

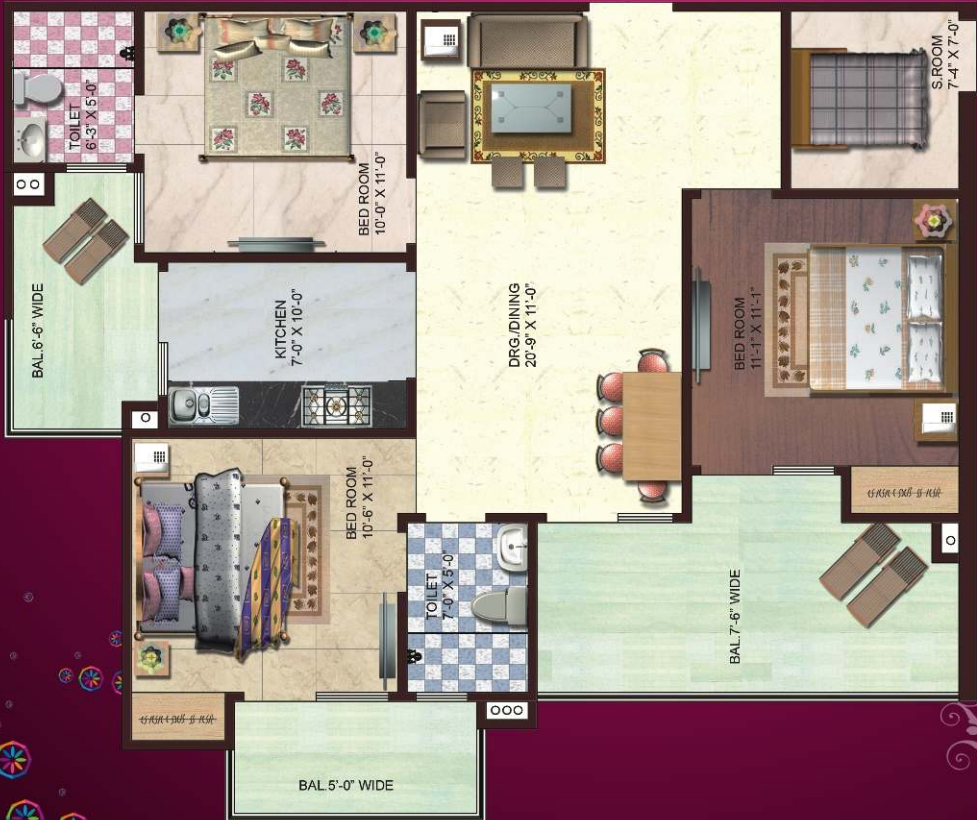

**AREA**  
1530 sq. ft.

3 B/R  
Drawing/Dining  
Kitchen  
Servant Room  
2 Toilets  
3 Balconies

**AREA**  
1760 sq. ft.

- 3 B/R
- Drawing/Dining
- Kitchen
- Servant Room with Toilet
- 2 Toilets
- 3 Balconies



**AREA**  
2075 sq. ft.

- 4 B/R
- Drawing/Dining
- Kitchen
- Servant Room with Toilet
- 3 Toilets
- 3 Balconies



# Road Map



## Other Ghaziabad Projects



SG HOMES, Vasundhara  
(Construction in full swing)



SG Alpha Tower, Vasundhara  
(Possession handed over)



Impressions 58, Rajnagar Extn., Ghaziabad  
(Possession handed over)



Indigo & Ivory Tower (SG Impression 58, Ph-II)  
(Under Construction)



**SG ESTATES LIMITED**

QUALITY CONSTRUCTION, OUTSTANDING INTEGRITY

-An ISO 9001-2000 certified company-

105-106, Deep Shikha Tower, Rajendra Place, New Delhi-110008 • Mob.: 9899929163, 9899975167, 9899951043  
Tel: 011-42323230 (Hunting Lines) • Telefax: 011-42323244 • Email : enquiry@sgestates.in  
www.sgestates.in, http://www.sgimpressionsplus.com/