

# REIMAGINING HYDERABAD'S RESIDENTIAL REAL ESTATE!



Inspired by the World.  
Aspired by You.

urbanrise  
the world of  
*joy*  
MIYAPUR



# A FIRST OF ITS KIND ULTRA-LUXE PROJECT

WORLD CLASS ARCHITECTURE | NEVER BEFORE AMENITIES

<b>10.6</b> Acres	<b>5</b> Towers
<b>42</b> Floors	<b>3&amp;4</b> BHKs

# MASTER PLAN



**PARK BY THE LAKE**

- 1. LAKE
- 2. PETS RUN
- 3. SQUASH COURT
- 4. BILLYARD COURT
- 5. SQUASH COURT
- 6. BILLYARD COURT
- 7. HALL BASKETBALL COURT
- 8. ROLLER SKATING
- 9. BASKETBALL COURT
- 10. BASKETBALL COURT
- 11. PAVILION
- 12. STAFF REST ROOM FOR YOUNG
- 13. RELAX AND READ HAMMOCK
- 14. AMPHITHEATRE
- 15. TENNIS COURT
- 16. TENNIS COURT
- 17. TENNIS COURT
- 18. TENNIS COURT
- 19. TENNIS COURT
- 20. TENNIS COURT
- 21. TENNIS COURT
- 22. TENNIS COURT
- 23. TENNIS COURT
- 24. TENNIS COURT
- 25. TENNIS COURT
- 26. TENNIS COURT
- 27. TENNIS COURT
- 28. TENNIS COURT
- 29. TENNIS COURT
- 30. TENNIS COURT
- 31. TENNIS COURT
- 32. TENNIS COURT
- 33. TENNIS COURT
- 34. TENNIS COURT
- 35. TENNIS COURT
- 36. TENNIS COURT
- 37. TENNIS COURT
- 38. TENNIS COURT
- 39. TENNIS COURT
- 40. TENNIS COURT
- 41. TENNIS COURT
- 42. TENNIS COURT
- 43. TENNIS COURT
- 44. TENNIS COURT
- 45. TENNIS COURT
- 46. TENNIS COURT
- 47. TENNIS COURT
- 48. TENNIS COURT
- 49. TENNIS COURT
- 50. TENNIS COURT
- 51. TENNIS COURT
- 52. TENNIS COURT
- 53. TENNIS COURT
- 54. TENNIS COURT
- 55. TENNIS COURT
- 56. TENNIS COURT
- 57. TENNIS COURT
- 58. TENNIS COURT
- 59. TENNIS COURT
- 60. TENNIS COURT
- 61. TENNIS COURT
- 62. TENNIS COURT
- 63. TENNIS COURT
- 64. TENNIS COURT
- 65. TENNIS COURT
- 66. TENNIS COURT
- 67. TENNIS COURT
- 68. TENNIS COURT
- 69. TENNIS COURT
- 70. TENNIS COURT
- 71. TENNIS COURT
- 72. TENNIS COURT
- 73. TENNIS COURT
- 74. TENNIS COURT
- 75. TENNIS COURT
- 76. TENNIS COURT
- 77. TENNIS COURT
- 78. TENNIS COURT
- 79. TENNIS COURT
- 80. TENNIS COURT
- 81. TENNIS COURT
- 82. TENNIS COURT
- 83. TENNIS COURT
- 84. TENNIS COURT
- 85. TENNIS COURT
- 86. TENNIS COURT
- 87. TENNIS COURT
- 88. TENNIS COURT
- 89. TENNIS COURT
- 90. TENNIS COURT
- 91. TENNIS COURT
- 92. TENNIS COURT
- 93. TENNIS COURT
- 94. TENNIS COURT
- 95. TENNIS COURT
- 96. TENNIS COURT
- 97. TENNIS COURT
- 98. TENNIS COURT
- 99. TENNIS COURT
- 100. TENNIS COURT

**GROUND**

- 01. ENTRANCE
- 02. SECURITY CASH
- 03. DRIVEWAY
- 04. WALKWAY
- 05. CRICKET PRACTICE NETS
- 06. OUTDOOR GYM
- 07. OUTDOOR TABLE TENNIS
- 08. SAND PIT
- 09. EXERCISE YARD
- 10. PET PARK
- 11. SKATING RINK
- 12. CHILDREN PLAY AREA
- 13. ELEVATED DECK
- 14. WAVE POOL
- 15. TENNIS COURT
- 16. SEATING PLAZA
- 17. BANQUET LAWN
- 18. BASKETBALL COURT
- 19. WALKWAY
- 20. HALF BASKETBALL COURT

**POOLAM**

- 21. HANGING GARDENS
- 22. PAVILION
- 23. LOFT NET
- 24. SEATER
- 25. SPARK GAZBO
- 26. DICE WALK
- 27. ZEN GARDEN
- 28. CHILDREN PLAY AREA
- 29. PADDLE POOL WITH JUMPING FOUNTAIN
- 30. SWIMMING POOL
- 31. SEATING ZONE
- 32. KITCHEN
- 33. INFANTRY POOL
- 34. YOGA LAWN
- 35. PAVILION
- 36. SEATED SEATING
- 37. BUCKWORM PAVILION
- 38. HANGING ZONE
- 39. SWIMMING POOL
- 40. ELEVATED WALKWAY
- 41. HANGING GARDENS

**COURT HOUSE TERRACE**

- A. SWIMMING POOL
- B. BAR & LOUNGE
- C. INTERACTIVE SPACE

**TERRACE**

- A. YOGA AND MEDITATION ZONE
- B. INTERACTIVE LOUNGE
- C. PRIVATE SPA WITH PARTY LOUNGE
- D. DINING WITH NATURE
- E. CO-MIXING SPACE WITH SPA
- F. MINI THEATRE
- G. SWIMMING POOL
- H. GAZE ZONE



SCALE 1:600

# MASTER PLAN



Ground Amenities

Tower E

Tower D

Tower B

Elevated Walkway

Podium Amenities

Interconnected Skywalk

Rooftop Amenities

Tower C

# UNIT PLANS

EAST FACING_3B2T COMPACT	AREA	1333 SFT.
--------------------------	------	-----------

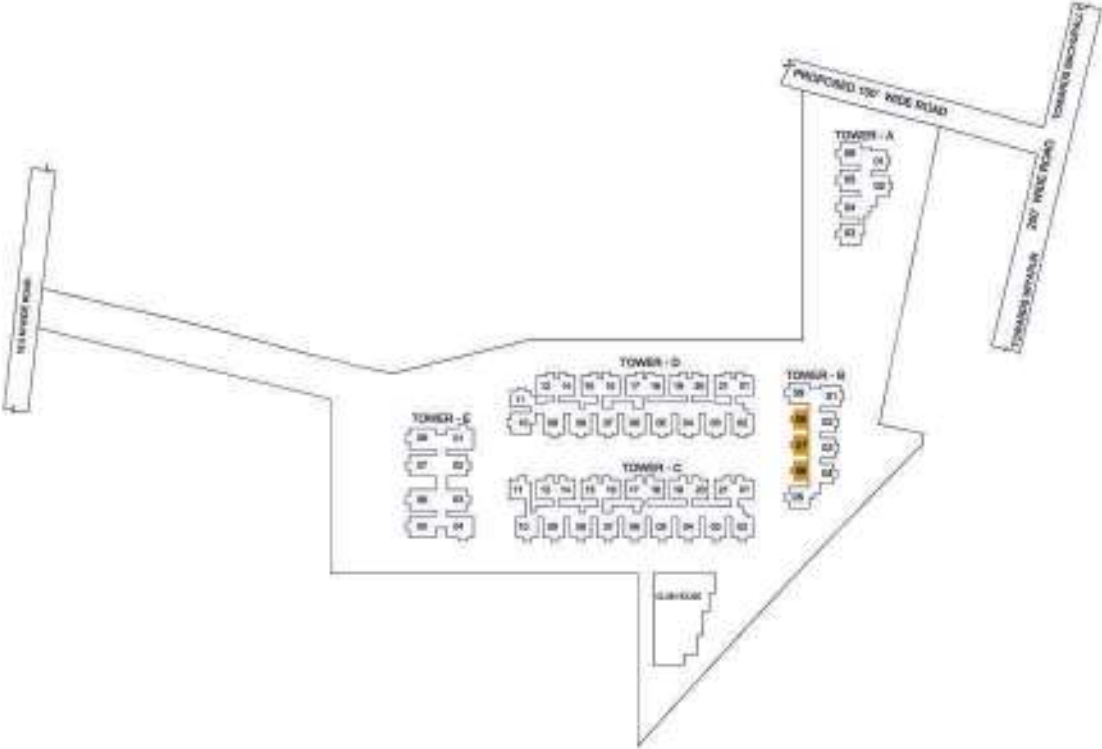

UNIT NUMBERS : B\_106-4206, 307-4207, 108-4208

# UNIT PLANS

WEST FACING\_3B2T COMPACT

AREA

1333 SFT.

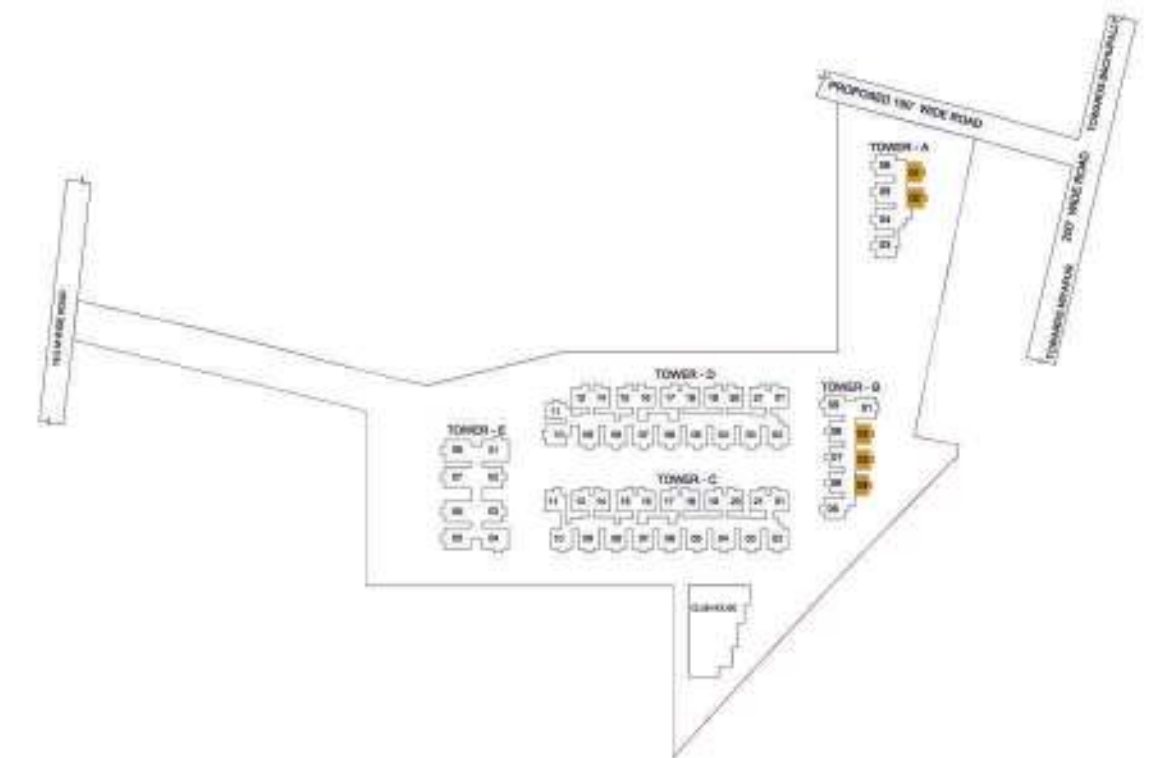

UNIT NUMBERS : A\_101-4101, 302-4102  
 B\_102-1502, 1702-2502, 2702-3502,  
 3702-4202, 103-4203, 104-4204

# UNIT PLANS

EAST FACING_2B2T	AREA	1348 SFT.
------------------	------	-----------

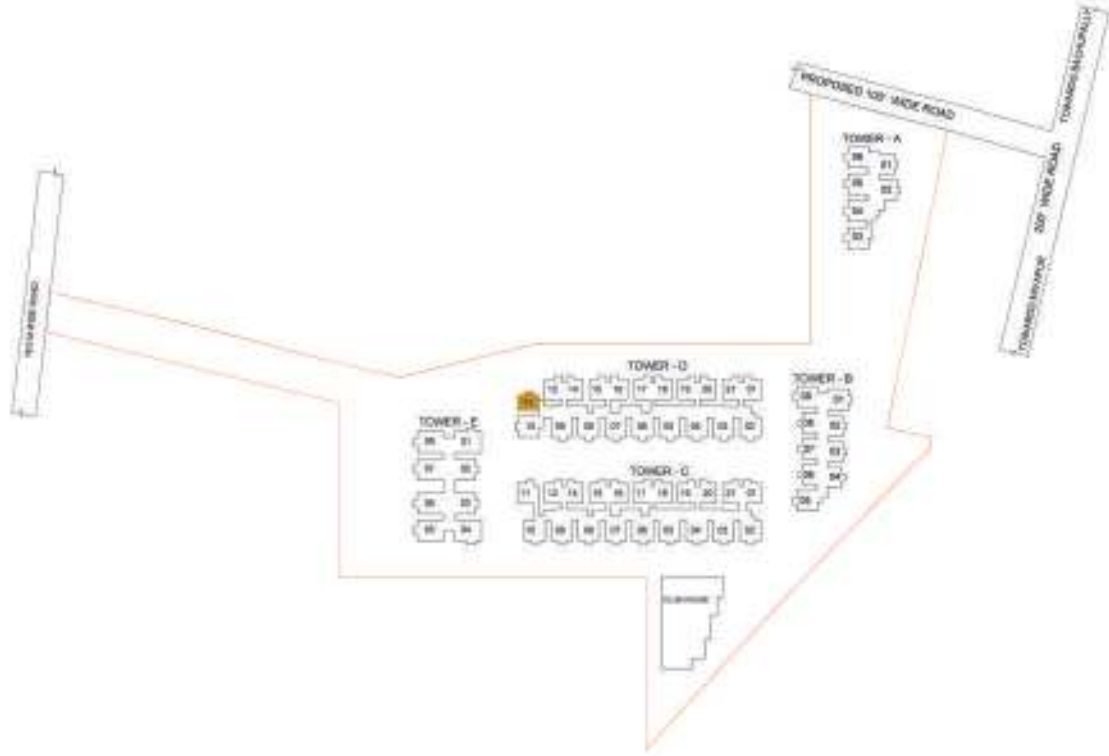

UNIT NUMBERS : D\_111-4211

# UNIT PLANS



EAST FACING_3B2T REGULAR	AREA	1509 SFT.
--------------------------	------	-----------

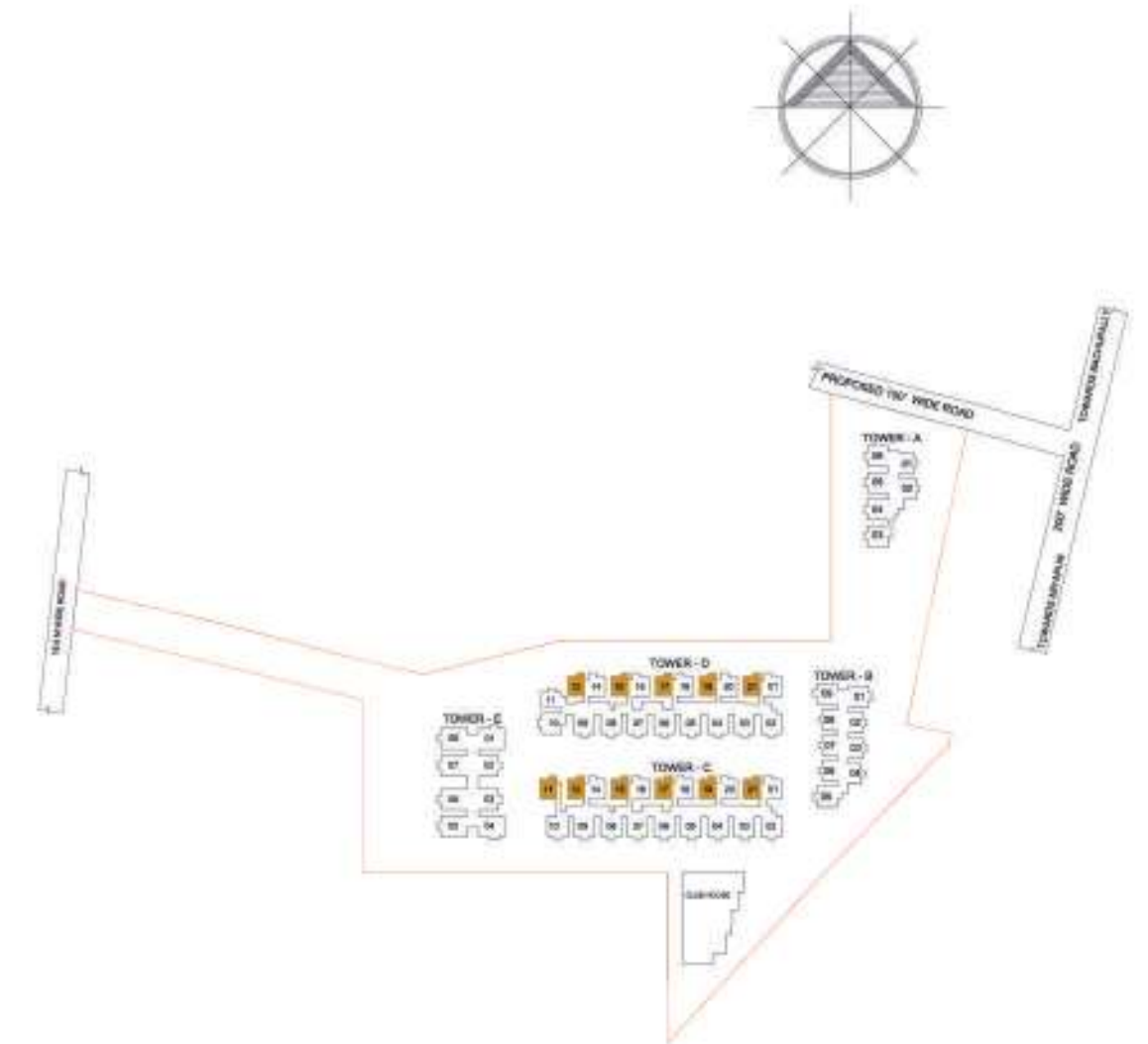

UNIT NUMBERS : C\_111-4211, 112-4212, 115-4215,  
 117-4217, 119-4219, 121-4221  
 D\_112-4212, 115-4215, 117-4217,  
 119-4219, 121-4221

# UNIT PLANS



WEST FACING\_3B2T REGULAR

AREA

1509 SFT.

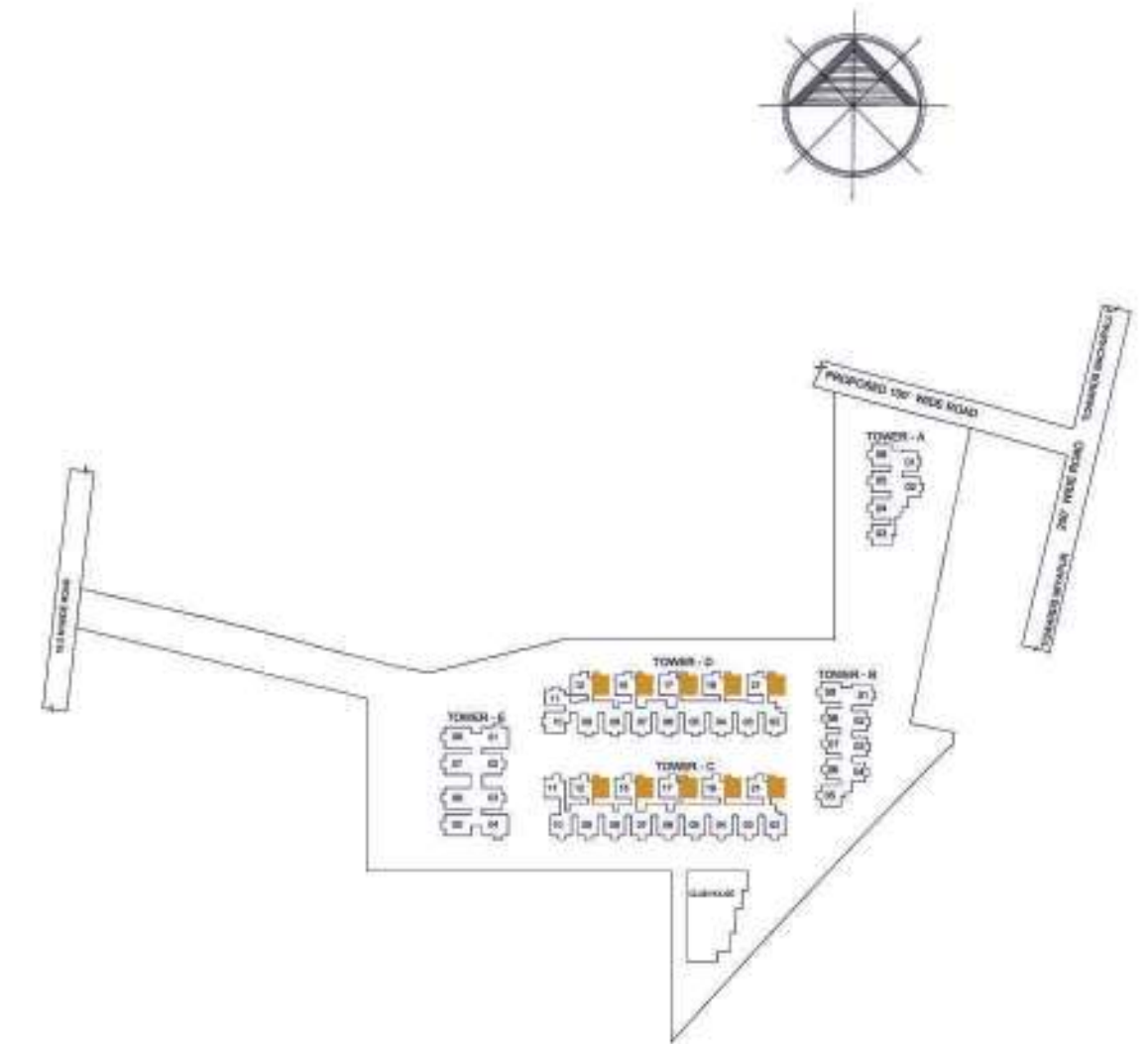

UNIT NUMBERS : C\_101-4201, 114-4214, 116-4216,  
118-4218, 120-4220  
D\_101-4201, 114-4214, 116-4216,  
118-1518, 1718-2518, 2718-3518,  
3718-4218, 120-4220

# UNIT PLANS

EAST FACING_3B3T	AREA	1839 SFT.
------------------	------	-----------

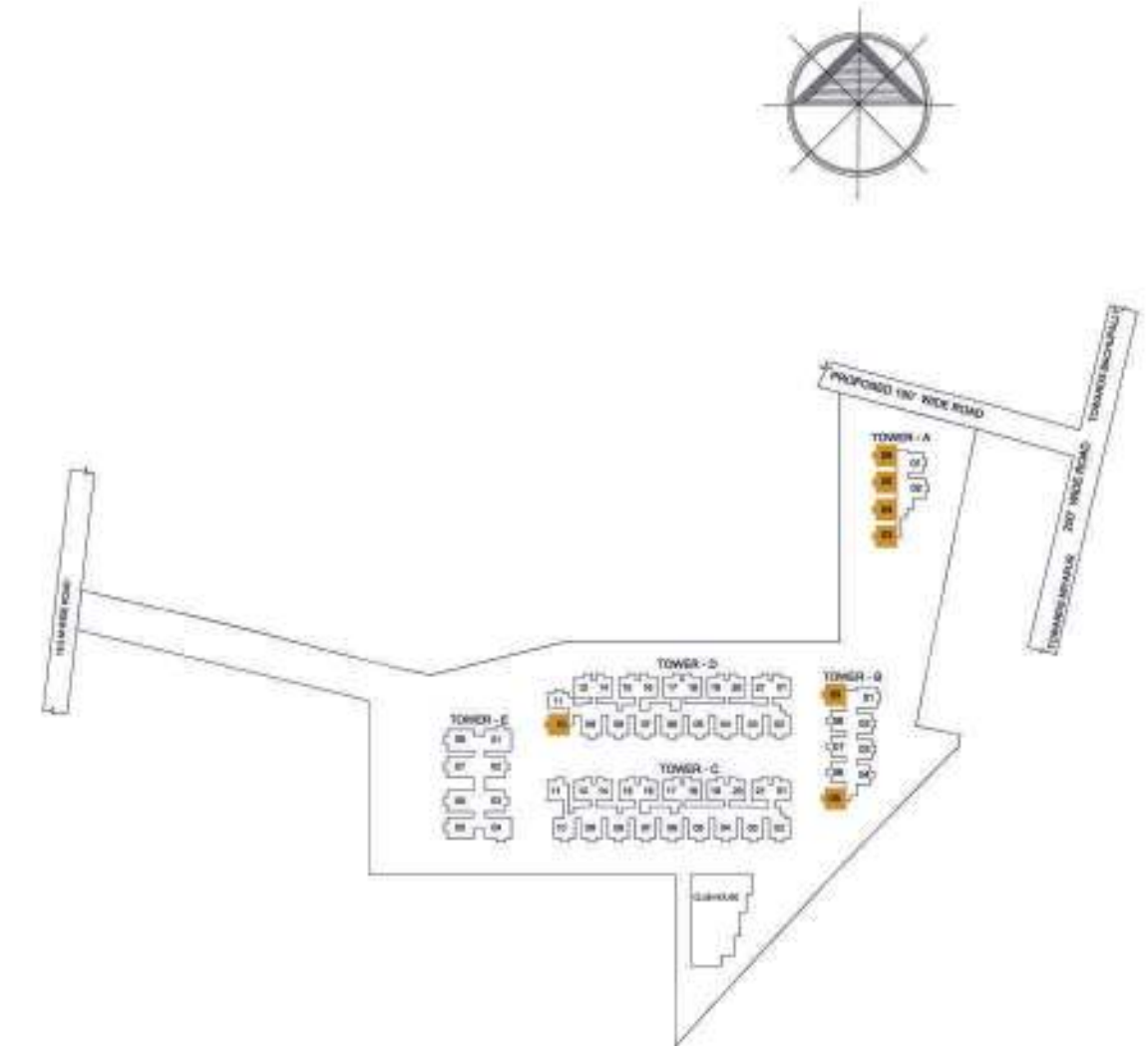

UNIT NUMBERS : A\_103-4103, 104-4104, 105-1405,  
 1605-2405, 2605-3405, 3605-4105  
 B\_105-4209, 109-4209  
 D\_110-4210,

# UNIT PLANS

WEST FACING\_3B3T

AREA

1839 SFT.

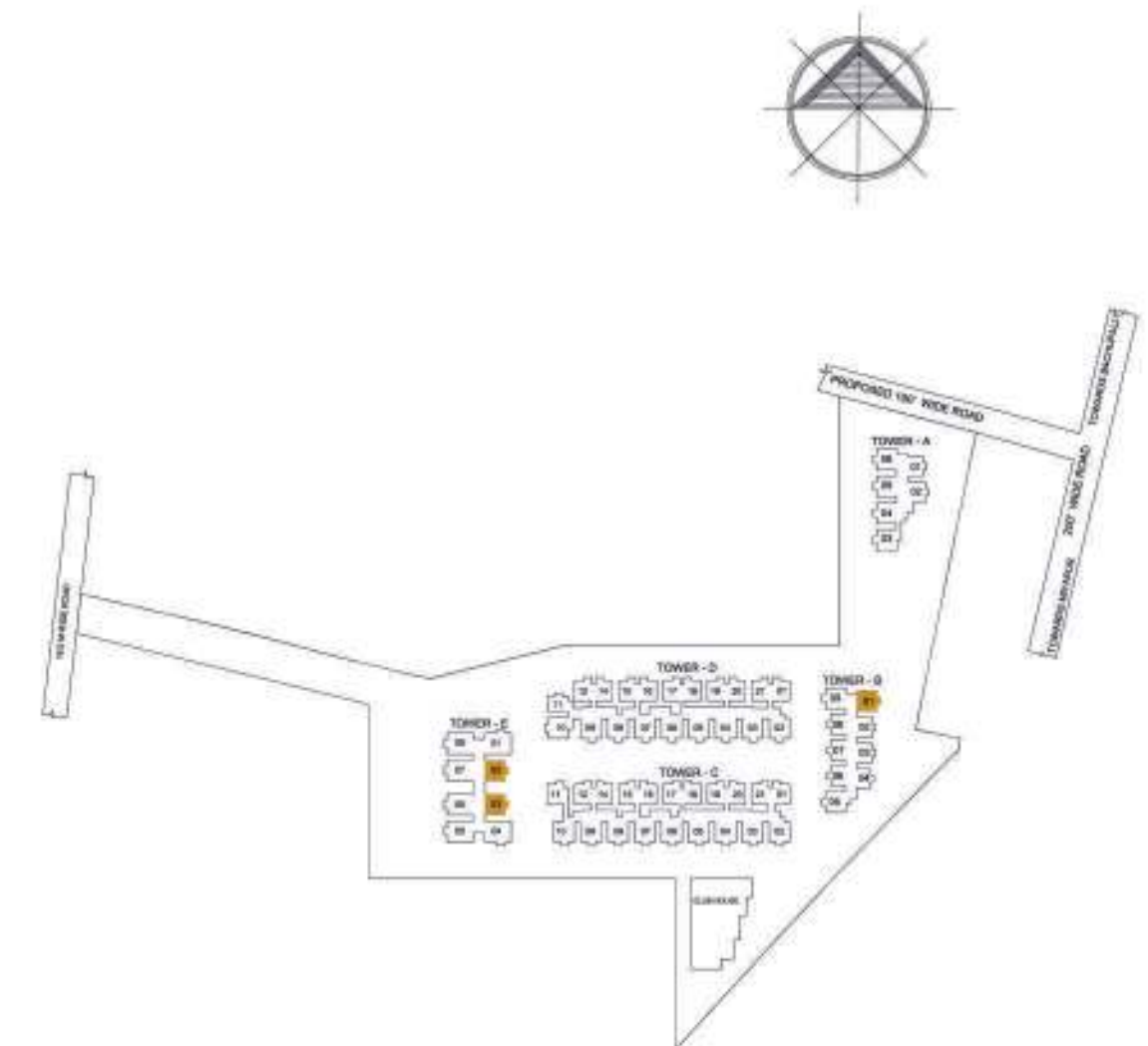

UNIT NUMBERS : B\_101-4201  
E\_102-4202, 103-4203

# UNIT PLANS

NORTH FACING_3B3T	AREA	1839 SFT.
-------------------	------	-----------

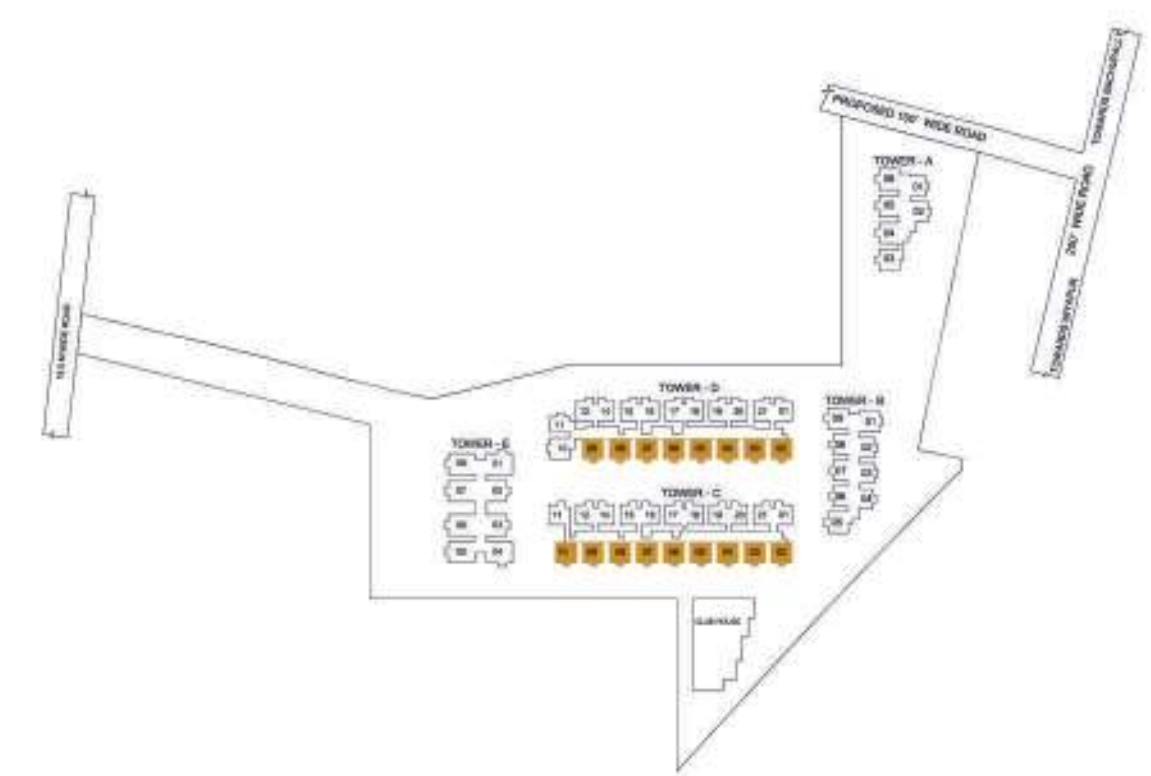

UNIT NUMBERS : C\_102-4202, 103-4203, 104-4204,  
 105-1505, 1705-2505, 2705-3505,  
 3705-4205, 306-4206, 107-4207,  
 108-4208, 109-4209, 110-4210  
 D\_102-4202, 103-4203, 104-4204,  
 105-4205, 306-4206, 107-4207,  
 108-4208, 108-4208, 109-4209

# UNIT PLANS

EAST FACING_4B3T	AREA	2309 SFT.
------------------	------	-----------

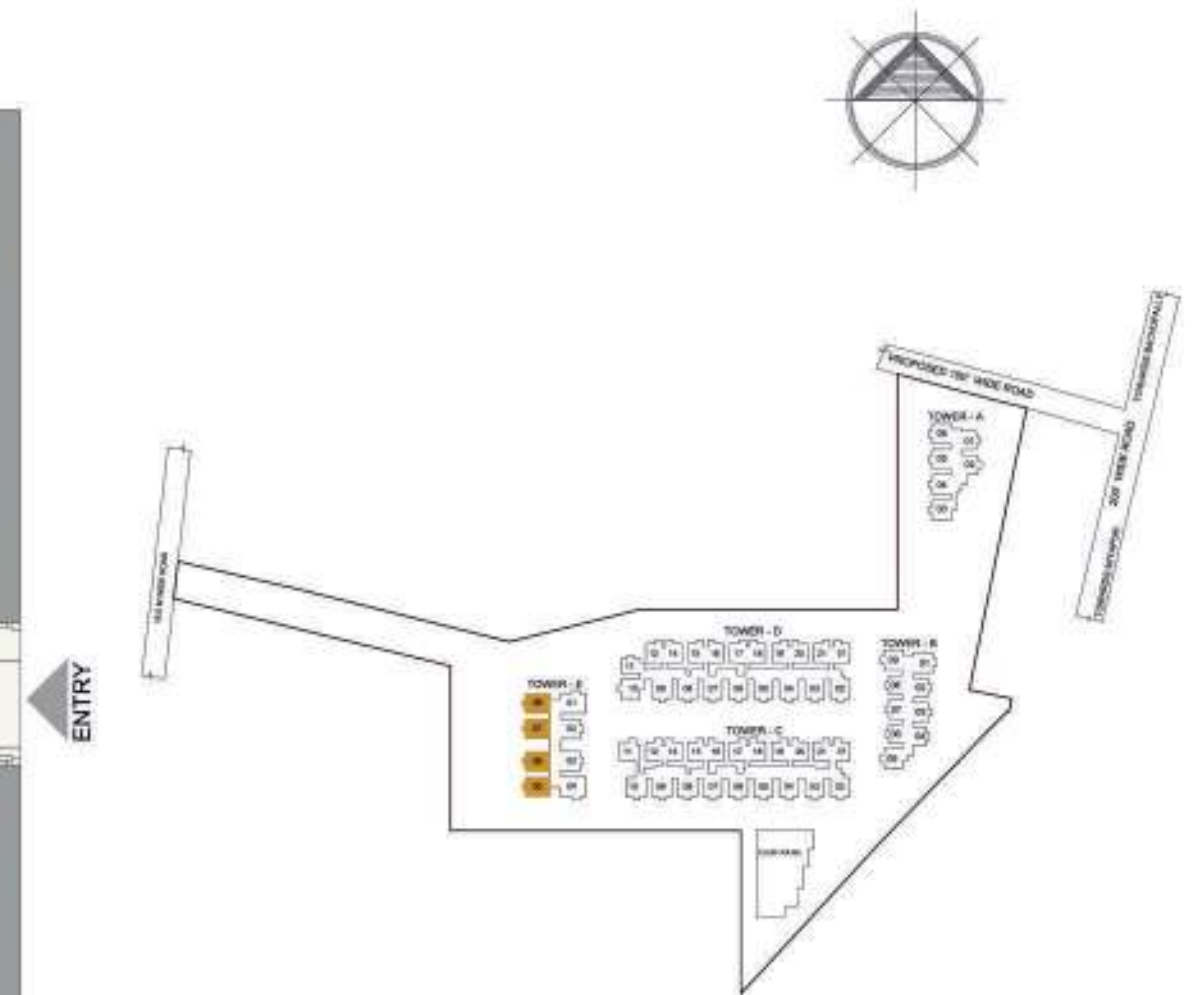

UNIT NUMBERS : E\_105-4205, 106-1406, 1606-2406,  
2606-3406, 3606-4106, 307-4207,  
108-4208

# UNIT PLANS

WEST FACING\_CORNER\_4B3T- TOP

AREA

2339 SFT.

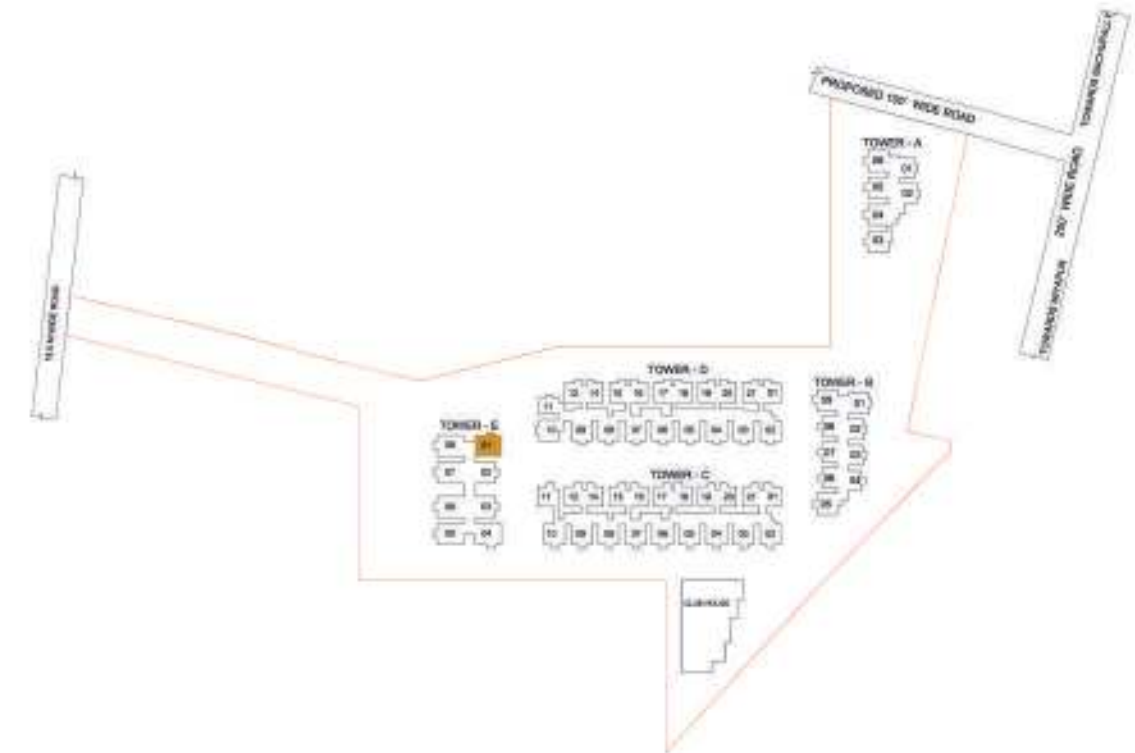

UNIT NUMBERS : E\_101-4201

# UNIT PLANS

WEST FACING_CORNER_4B3T- BOT	AREA	2339 SFT.
------------------------------	------	-----------

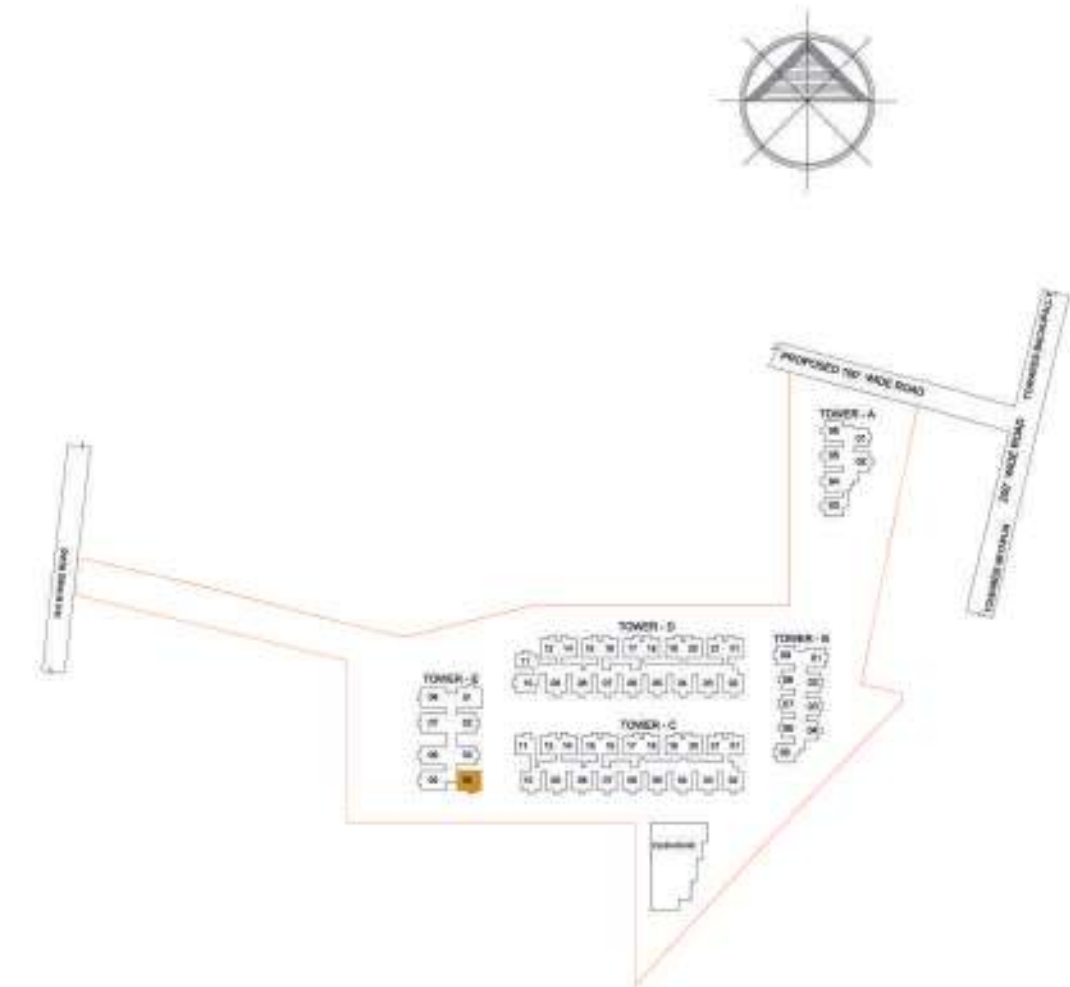

UNIT NUMBERS : E\_104-4204

# TOWER B

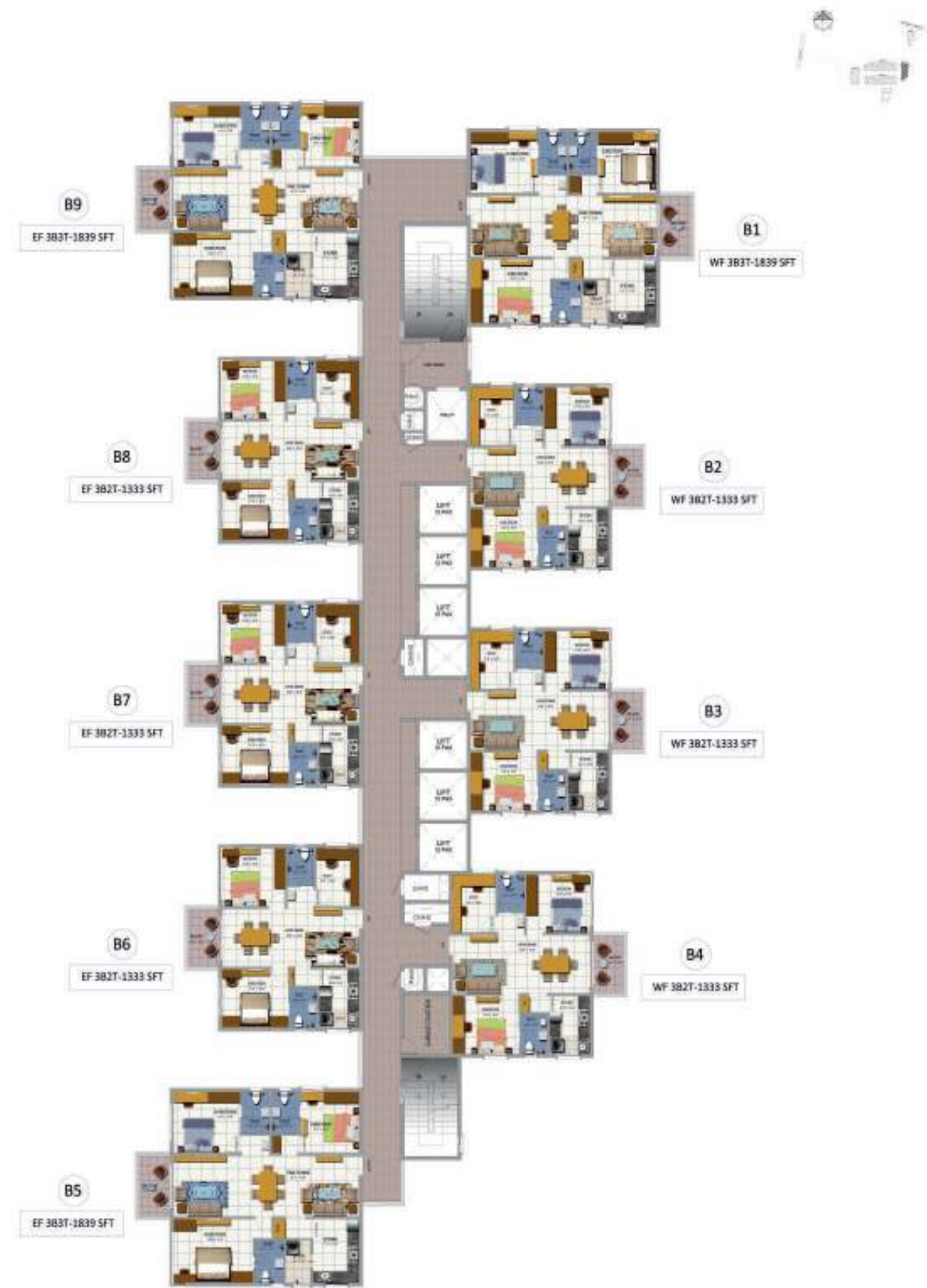

TOWER - B

# TOWER C



TOWER - C

# TOWER D

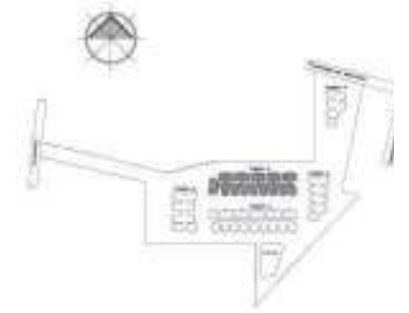

TOWER - D

# TOWER E



TOWER - E

# SPECIFICATIONS

## Structure

**Reinforced cement concrete structure (RCC) with shear walls by Aluminium formwork system**

## Windows

**uPVC / Aluminium frames with toughened glass sliding shutters and Grills with provision for Mosquito mesh**

## Doors

- **Main Door:** 2100mm high wooden door frame and Flush shutter with Veneer on both sides finished with Melamine/ PU polish Coating
- **Internal Door:** 2100mm high engineered wood door frame and Flush shutter with Laminate finish
- **Balcony:** uPVC French Door with toughened glass sliding shutter

## Flooring

800mm x 800mm Vitrified tiles

## Kitchen

Granite platform and Stainless steel sink

## Tiles Cladding & Dadoing

- **Kitchen:** Glazed Ceramic tiles dadoing upto 2'0" height from the kitchen platform
- **Toilets:** Glazed Ceramic tiles dadoing upto false ceiling
- **Utility :** Glazed ceramic tiles dado upto 4'0" height

## Toilets

- Sanitary ware of Kohler/ Jaquar / Hindware / Grohe / American Standard or equivalent brand
- C.P. Fittings are of Kohler/ Jaquar / Hindware / Grohe / American Standard or equivalent brand

## Electrical

- Anchor Panasonic/Legrand/MK Honeywell / Schneider / Havells or equivalent Modular switches & sockets
- AC point in all bedrooms and Living room

## Painting

- Internal Wall - Finished smooth with Acrylic Emulsion paint
- External - Finished with texture and Acrylic Emulsion paint

## Utility & Balcony

Finished with Anti-skid tiles of standard make

## Lift lobby & Corridor

Finished with antiskid vitrified tiles

## Lifts

Johnson/ Schindler/ Thyssenkrupp / OTIS / Kone or equivalent

## Raw Power

- 2BHK - 3 KW
- 3BHK - 4 KW
- 4BHK - 6 KW

## Power back up

- Common area - 100% DG Back up
- Backup inside flat - 1 KVA (Except Geyser, AC and 15A socket)

## Security

- CCTV surveillance in main Entry and Exit
- Boom Barriers at the Entry gateway for regulating access

# 1 LAKH+ SQFT OF CLUBHOUSE SPACES

## 5 LEVELS

Co-Working Spaces

Multipurpose Hall

Rooftop Party Area

Rooftop Swimming Pool

Badminton Court

Super Market

Spa & Hydrotherapy

Pharmacy

Billiards

Squash Court

GYM

Salon





**3 & 4 BHK  
ULTRA - LUXE HOMES**

**RERA NO: P01100006655**

LEGAL DISCLAIMER: All depictions of interiors, furniture, fixtures, are conceptual only and are not included in your house. The photos contained in the marketing collaterals such as marketing brochure, sales kits, walkthroughs etc. may be stock photographs or have been shot off-site and are used to depict the lifestyle to be achieved. All drawings in the marketing collaterals are illustrations and not actual images. The plans are subject to changes based on final approvals from state government, HMDA, RERA & local bodies. This marketing collateral is purely conceptual and does not constitute a legal document. Visual representation are not to be taken as representation of facts and do not form part of an offer or contract.