



# POETREE



## Ananda Homes

Phone : +91 7679 777 888

Website : [ananda-homes.com](http://ananda-homes.com)

Website : [aryamitrargroup.com](http://aryamitrargroup.com)

NOTE : This brochure is only a conceptual presentation of the project and not a legal offering.  
The promoters reserve the right to make changes in plans, specifications and elevation as deemed fit.

Artifice +91 98852 53570



**2 & 3 BHK** CONTEMPORARY GATED COMMUNITY  
AT NARSINGI, NEAR ALKAPUR TOWNSHIP



Since its inception in 2007, Aryamitra Group has built its reputation in Hyderabad realty space for identifying prime locations for its residential projects, fast completion of projects, excellent built-quality and most importantly, reasonable prices.

The founders of Aryamitra Group have tremendous know-how of the Hyderabad real estate industry and deep consumer insight. They are passionate about delivering homes that are modern and yet cost-effective, thereby creating immense value for its customers and stakeholders.

Today, Aryamitra Group stands tall on the foundation of its values, delivering quality and excellent real estate spaces, ensuring customer satisfaction and redefining lifestyles.

Its latest flagship project is Poetree, under its group company, Ananda Homes in Alkapur Township, Narsingi.





# POETREE

Your place,  
your passion.

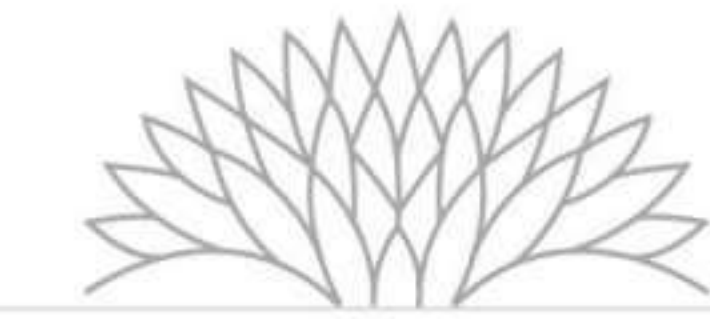

Welcome to Poetree by Ananda Homes, designed to be a place that will complement your passion for living. Because you're someone we believe does not like to live an ordinary life, but someone who likes to live with a passion for living.



Entrance View



# POETREE

Your imagination,  
your destination.



You have arrived in life, arrived after years of endeavour, pursuing your vision through times that have seen you through phases only you know of. Now that you have come past instances that have made you into what you are today, it's time to reward yourself suitably. For here's where your imagination will turn true.



## LEGEND

- A. Entrance with Frame Walls
- B. Seating under Pergola
- C. Pathway
- D. Amphitheatre
- E. Seating
- F. Seating in Gravel
- G. Badminton Court
- H. Children's Play Area
- I. EPDM Kids' Play Area
- J. Lawn
- K. Reflexology Pathway for Elders
- L. Lawn for Party Hall Extension



## MASTER PLAN





POETREE

Your surroundings,  
your ecstasy.

Aerial View

Area Statement

Flat No	Type	Facing	Areas
1	3BHK	West	1628.00
2	2BHK	West	1240.00
3	2BHK	West	1240.00
4	3BHK	West	1912.00
5	3BHK	West	1636.00
6	2BHK	West	1380.00
7	2BHK	East	1216.00
8	3BHK	East	1912.00
9	3BHK	East	1616.00
10	2BHK	East	1216.00
11	2BHK	East	1267.00
12	2BHK	East	1216.00

# POETREE

Your space,  
your moments.

Poetree is a community of three blocks: Peony, Orchid, Erica. The first block is Peony, that hosts an array of 2 BHK and 3 BHK homes that are well separated from each other, spaciouly. This is where you will find apartments ranging between 1216 sft and 1912 sft.

KEY PLAN



TYPICAL FLOOR PLAN | PEONY - BLOCK



TYPICAL FLOOR PLAN | ORCHID - BLOCK



Area Statement

Flat No	Type	Facing	Areas
1	2BHK	West	1200.00
2	2BHK	West	1200.00
3	2BHK	West	1200.00
4	3BHK	North	1591.00
5	3BHK	North	1591.00
6	3BHK	East	1584.00
7	2BHK	East	1116.00
8	2BHK	East	1200.00
9	2BHK	West	1200.00
10	2BHK	West	1200.00
11	2BHK	East	1205.00
12	2BHK	East	1205.00

Your ideas,  
your creation.



Move on to the next block of Poetree, that is Orchid, and you'll discover that it houses the largest flats of the entire community. This block also hosts numerous 2 BHK and 3 BHK apartments that range anywhere between 1116 sft and 1591 sft.



TYPICAL FLOOR PLAN | ERICA - BLOCK



Area Statement

Flat No	Type	Facing	Areas
1	2BHK	West	1275.00
2	2BHK	West	1275.00
3	3BHK	West	1765.00
4	3BHK	North	1658.00
5	3BHK	North	1658.00
6	3BHK	East	1754.00
7	2BHK	East	1280.00
8	2BHK	East	1280.00
9	3BHK	West	1731.00
10	3BHK	East	1731.00

Your mood,  
your pleasure.



Now we arrive to the third and the last block of Poetree and that is Erica. Like the other two blocks, even this block is airy and spacious, home to 2 BHK and 3 BHK apartments that span in the range of 1275 sft and 1765 sft.

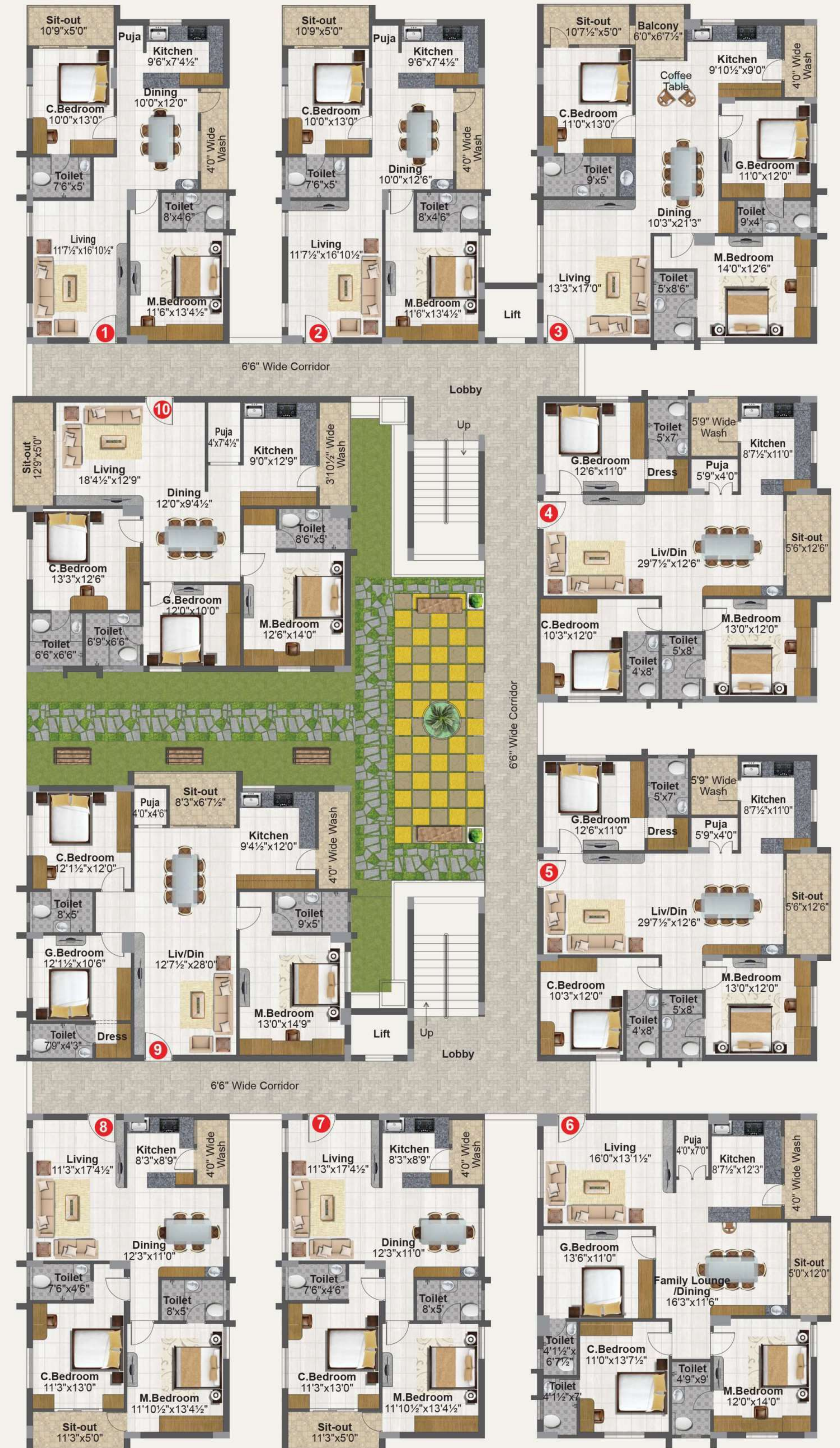

Your moment,  
your delight.

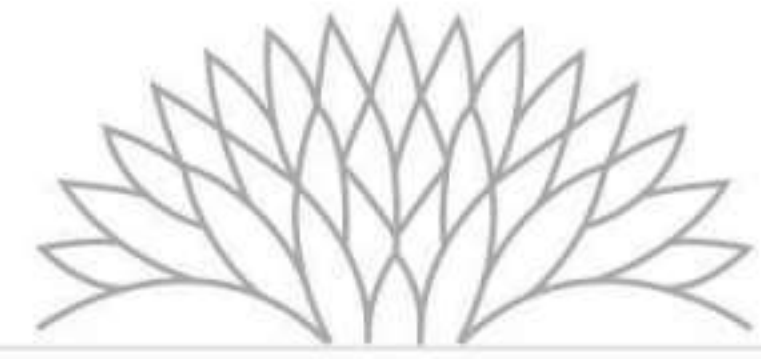

Make every moment a time you'll never forget. For Poetree has it all: the beauty, the grandeur, the ambience and the perfect setting to make good things possible for you. Live a life glorious here, as the sun descends and the moon ascends into the night sky. Make every night a night to celebrate under the moonlight.

  
POETREE



Night View

## Amenities & Features

- Yoga / Meditation
- Kids' Pool
- Gymnasium
- Walking Track
- Seating Area
- Indoor Games
- Multipurpose Hall
- Guest Rooms
- Party Lawns
- Seating Deck

POETREE



- Wi-fi Enabled
- Preview Theatre
- Kids' Play Area
- Shuttle Court
- Power backup Generators
- Amphitheatre
- CCTV
- Intercom
- Lifts
- Car Parking
- Solar Fencing

OVER 20 AMENITIES

Clubhouse



Your leisure,  
your relaxation.

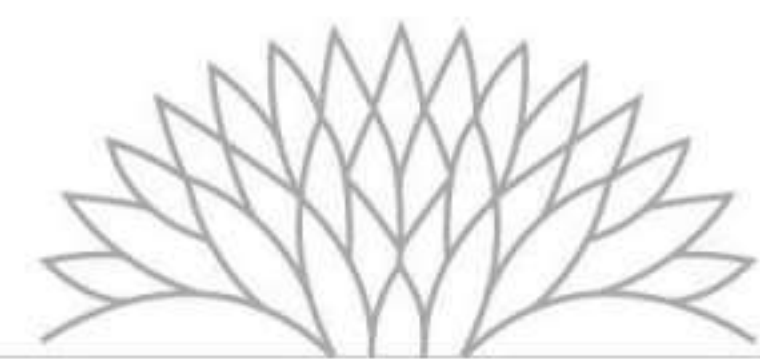

For all that Poetree is imagined to be, it has much more than just amenities to flaunt. It's a treasure trove of leisure spaces and a place to relax and refresh with whoever you wish to. Discover what suits your idea of play and pleasure, and set a schedule for yourself.





Your expectations,  
your standards.



Quality is subjective, they say. But fortunately, we have set certain standards of construction at Poetree. Be it the bricks that go into the walls or the putty that covers them. Be it the fittings in the bathroom or the tiles that shall be beneath you. We have set certain scale for ourselves to meet standards that are yours.

# POETREE



**STRUCTURE**  
RCC-framed structure.



**SUPERSTRUCTURE**  
Clay moulded first-class brick masonry in cement mortar.



**WINDOWS**  
UPVC Windows with sliding shutters with clear glass and provision for mosquito mesh fitted with elegantly designed MS painted grills.



**TOILETS**  
a) Anti-skid ceramic tile flooring and wall dadoing upto 7 feet height.  
b) Pedestal wash basins in all toilets of Cera / equivalent make.  
c) Wall-mounted commode in all toilets of Cera / equivalent make.  
d) Hot and cold water wall mixture with shower of Jaquar / Grohe / equivalent make.  
e) All C.P. fittings of Jaquar / Grohe / equivalent make.



**POWER BACK-UP**  
Adequate power back-up for each flat and common area.



**UTILITIES**  
Provision for washing machine and wet area for washing utensils etc. Anti-skid ceramic tile flooring and wall dadoing up to 3 feet height.



**SECURITY**  
Intercom facility for the main security hub and security surveillance in common areas.



**PARKING**  
Every flat will be provided with one car parking.



**DOORS**  
**Main Door:** Teak - wood frame with teak veneer shutter aesthetically designed with melamine polishing and designer hardware.  
**Internal Doors:** Teak/Sal - wood frame with both sides painted skin moulded flush doors.  
**French Doors:** UPVC sliding doors with mosquito mesh.



## SPECIFICATIONS



**PLUMBING**  
a) All internal and external waterlines are of CPVC of Dutron / Astral / equivalent make.  
b) All drainage fittings and lines are of PVC of Dutron / Prince / equivalent make.



**FLOORING**  
Double-charged vitrified tiles for the entire flat.



**PAINTING**  
**Internal:** Two coats of good quality luxury emulsion paint over putty finished surface / primer coat.  
**External:** Combination of textured / smooth putty finish with Propex paint of Asian or equivalent make.



**ELECTRICAL**  
a) Concealed copper wiring in conduits for lights, fan and power plugs wherever necessary of HPL / equivalent make.  
b) Power outlets for air conditioners in all bedrooms.  
c) Power outlets for geysers in all toilets.  
d) Power outlets for cooking range, chimney, refrigerator, microwave ovens, mixer / grinders in kitchen.  
e) MCBs for each distribution board of Legrand / HPL / equivalent make.  
f) All flats with modular switches of Legrand / HPL / equivalent make.



**TELECOM**  
Telephone point in master bedroom and living areas.



**CABLE TV**  
Provision for cable connection in all bedrooms and living room.



**LIFT**  
6-passenger lift of Kone or equivalent make with front granite cladding and rich interiors.



Side View



Your location,  
your convenience.

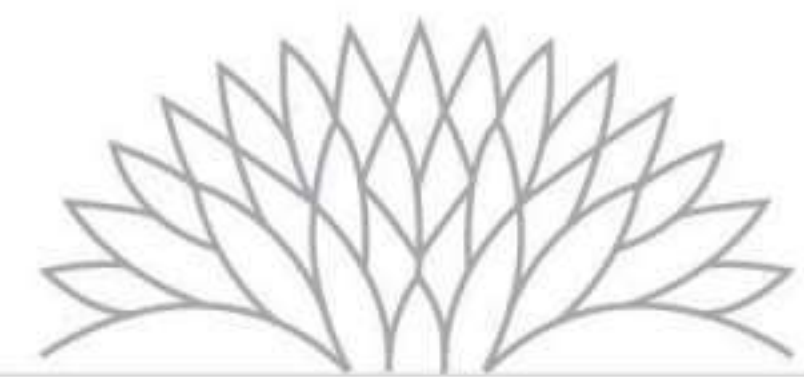

In the midst of buzz and the ever-expanding locale of Alkapur Township, Poetree is a complete community of apartments to belong to. With a home here, you'll be amidst a beautiful view of the Golconda Fort on one side. And also the convenience of nearness to Hitech City, Jubilee Hills and Banjara Hills. Plus, there's top-quality healthcare with Continental Hospital, education with Scholars International School, Rockwell International School, Phoenix International School, then there's the Que Convention Centre for events. Here's where you'll be in the centre of all the activity.

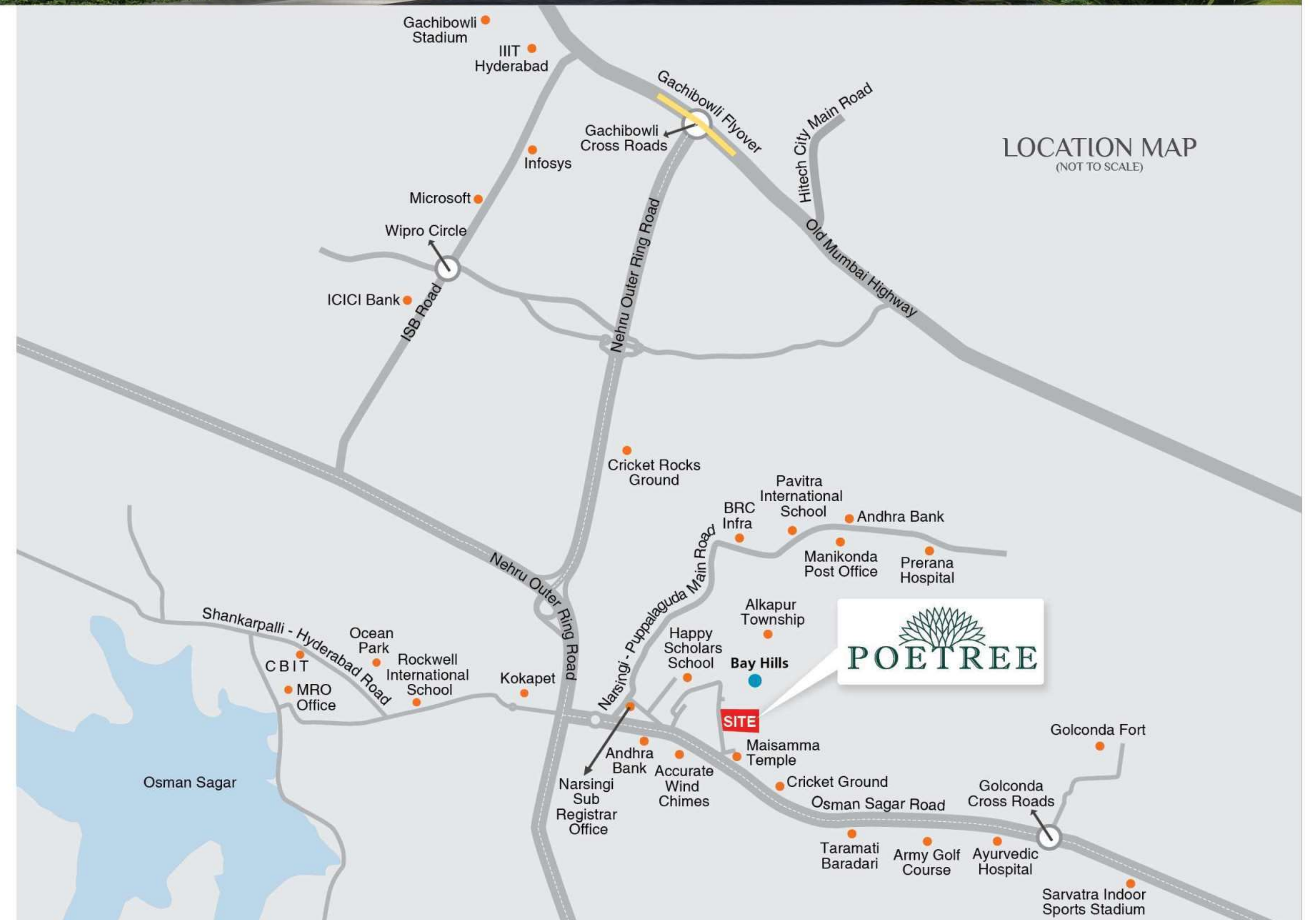

LOCATION MAP  
(NOT TO SCALE)

