

Project By



KPS Enterprises
Builders & Developers

WE CREATE OUR
Tomorrows
BY WHAT WE DREAM
Today...



Registration No.

P52000020029

<https://maharera.mahaonline.gov.in>



KPS Park

Survey No. 144/0 & 142/2, Shivkar, Panvel.

Project By



KPS Park

A home

away from city's chaos,
close to the nature...





KPS PARK

CADNAV.COM

Secure Your Future with Us

Amenities

WALL

External wall to be 6" thick brick work with two coats sand face plaster & internal partition walls to be 4" thick brick work with wall putti finish on plaster work.

PAINTING

Plastic coated / Acrylic paints for interior & cement paint / fungus proof oil based paints for exterior.

DOOR

The main door will be decorated with laminate sheets & fittings, having door bell, door eye, Beautiful handle, safety chain & night latch with wooden door frame.

ELECTRIFICATION

Concealed copper wiring, ample electrical points and Moduler switches with ISI marks in common area & in parking area. MCB & MCCB fitted for safety aspects. Adequate electrical point for T.V. cable, Fridge, Air-Condition, Mixer & Geyser and Extra inverter point.

FLOORING

2'X2' vitrified flooring in all rooms. Full height tiles fitted in w.c. Well bathrooms designed with anti-skid ceramic floor tiles.

WINDOWS

Powder coated aluminum sliding windows, Mosquito net fitted on marble frames.

KITCHEN

Granite kitchen platform with stainless steel sink. Dodo tiles fitted on walls up to lintel level. Kitchens are well ventilated.

PLUMBING

Concealed plumbing with branded C.P. fittings, Wash Basin, Provision for drinking water tap & regular Use water tap in kitchen.

COMFORT

Each wing having lift facility & adequate size of stair case for handling materials.

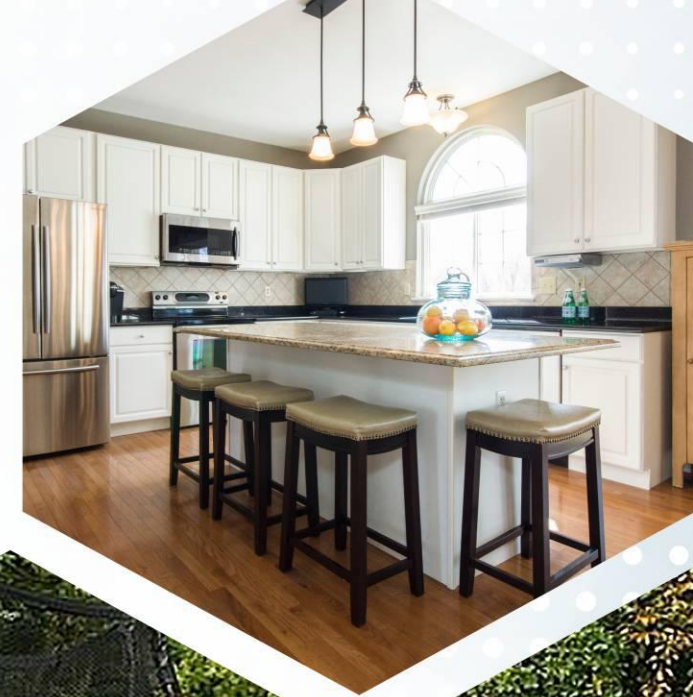

Features

- **Pollution free natural environment**
 - **Site surrounded with natural greenery**
- **Title clear Land**
 - **Approved from CIDCO NAINA**
- **Earthquake resistant structure / RCC design**
 - **All wings aesthetically painted with good quality paint**
- **Decorative entrance lobby for each wing**
 - **Parking space in stilt / Lift / Security Cabin**
- **Society Office / Society Intercom**
 - **Children Play area, Gym & Ample Parking**

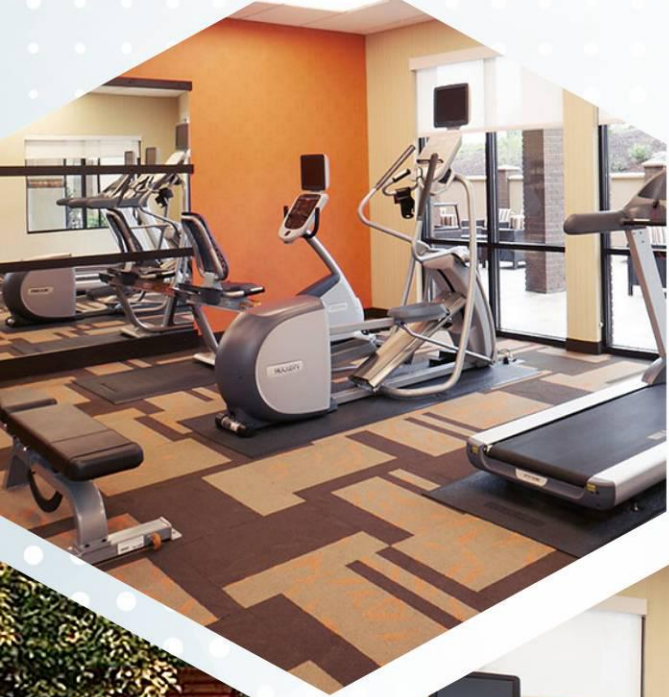



Maharashtra Real Estate Regulatory Authority

REGISTRATION CERTIFICATE OF PROJECT

FORM 'C'

[See rule 6(a)]

Project By



KPS Park

This registration is granted under section 5 of the Act to the following project under project registration number : **P52000020029**

Project: **KPS Park** Plot Bearing / CTS / Survey / Final Plot No.: **Survey Number - 142/2, 144/0 at Shivkar, Panvel, Raigarh, 410206;**

1. **Kps Enterprises** having its registered office / principal place of business at Tehsil: **Panvel, District: Raigarh, Pin: 410206.**
2. This registration is granted subject to the following conditions, namely:-
 - The promoter shall enter into an agreement for sale with the allottees;
 - The promoter shall execute and register a conveyance deed in favour of the allottee or the association of the allottees, as the case may be, of the apartment or the common areas as per Rule 9 of Maharashtra Real Estate (Regulation and Development) (Registration of Real Estate Projects, Registration of Real Estate Agents, Rates of Interest and Disclosures on Website) Rules, 2017;
 - The promoter shall deposit seventy percent of the amounts realised by the promoter in a separate account to be maintained in a schedule bank to cover the cost of construction and the land cost to be used only for that purpose as per sub- clause (D) of clause (l) of sub-section (2) of section 4 read with Rule 5;
OR
That entire of the amounts to be realised hereinafter by promoter for the real estate project from the allottees, from time to time, shall be deposited in a separate account to be maintained in a scheduled bank to cover the cost of construction and the land cost and shall be used only for that purpose, since the estimated receivable of the project is less than the estimated cost of completion of the project.
 - The Registration shall be valid for a period commencing from **19/03/2019** and ending with **28/02/2022** unless renewed by the Maharashtra Real Estate Regulatory Authority in accordance with section 5 of the Act read with rule 6.
 - The promoter shall comply with the provisions of the Act and the rules and regulations made there under;
 - That the promoter shall take all the pending approvals from the competent authorities
3. If the above mentioned conditions are not fulfilled by the promoter, the Authority may take necessary action against the promoter including revoking the registration granted herein, as per the Act and the rules and regulations made there under.

Signature valid
Digitally Signed by
Dr. Vasant Premnand Prabhu
(Secretary, MahaRERA)
Date: 3/27/2018 10:38:24 AM

Dated: **19/03/2019**
Place: **Mumbai**

Signature and seal of the Authorized Officer
Maharashtra Real Estate Regulatory Authority

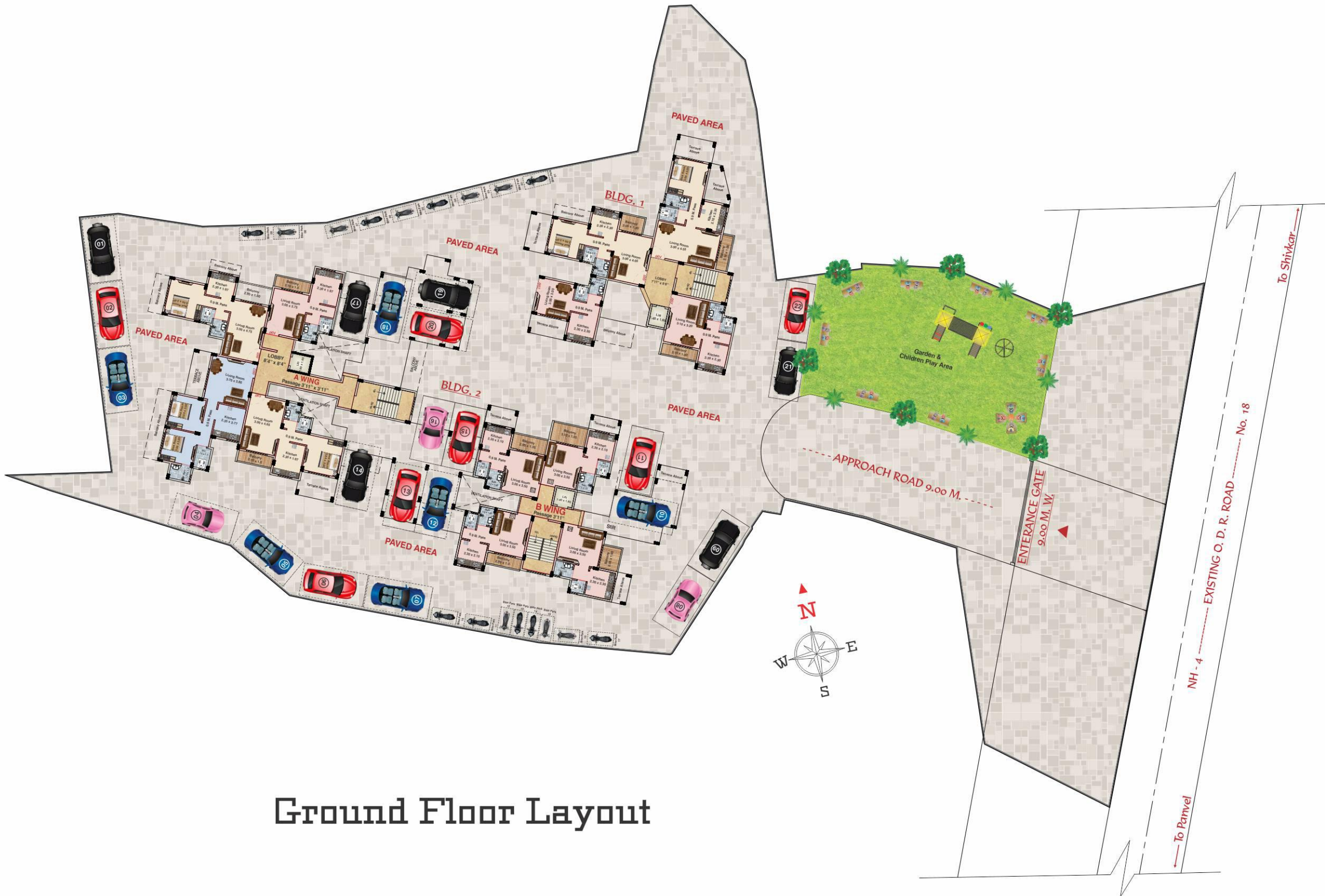

Ground Floor Layout

Bldg. 1 - Ground Floor Plan



Bldg. 1 - 1st & 3rd Floor Plan



Bldg. 1 - 2nd & 4th Floor Plan





Bldg. 2 - Ground Floor Plan



Bldg. 2 - 2nd & 4th Floor Plan

1 RK
Sample Flat



1 BHK
Sample Flat



2 BHK
Sample Flat





1A

KPS PARK

APPROACH ROAD 9.0 M

EXISTING O.D.R. ROAD NO.18
shiykar
panivel

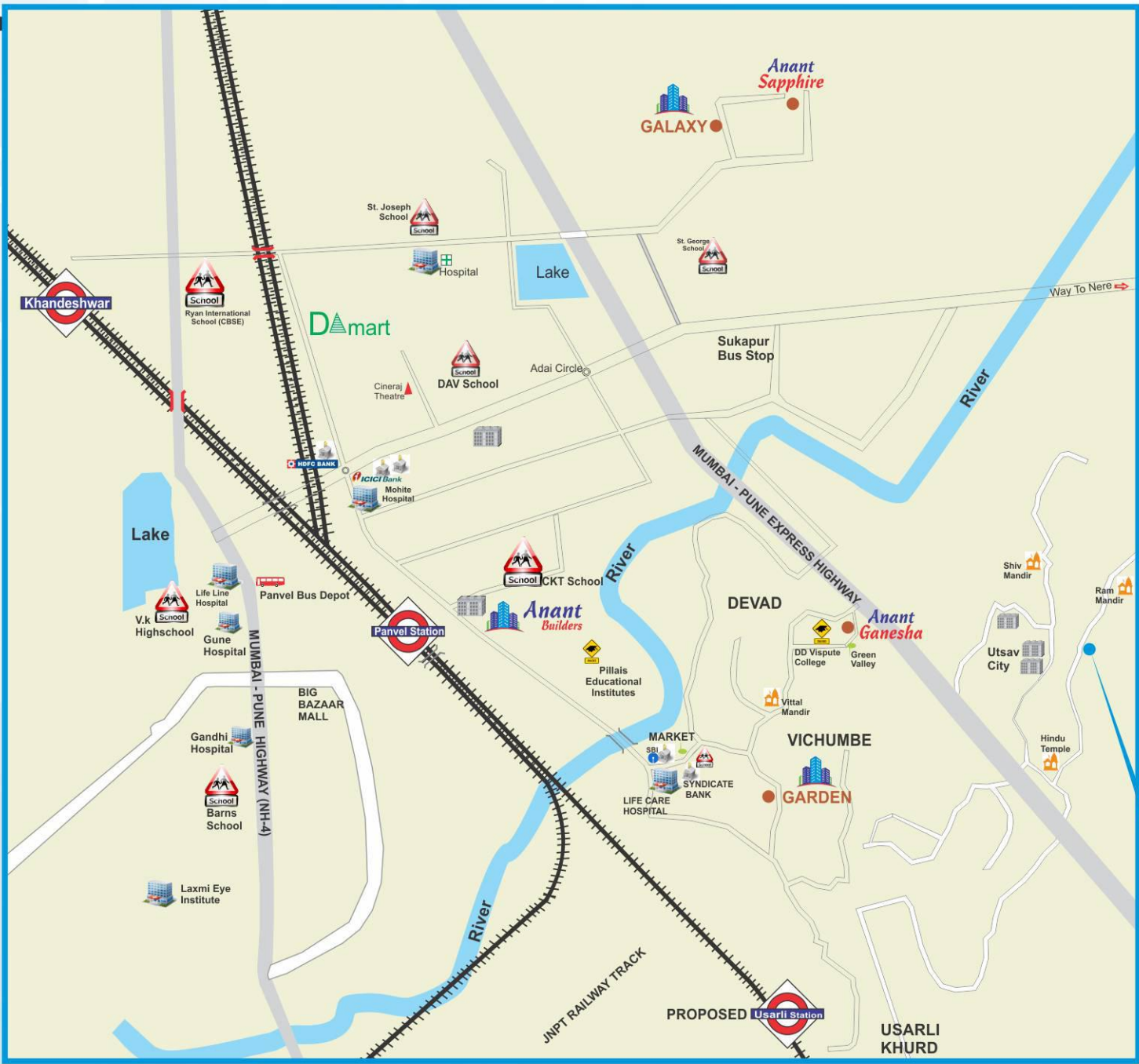

HIGHLIGHTS

- Panvel Railway Station 3.5 Km**
- Khandeshwar Railway Station near by**
- Panvel ST Bus Depot 3 Km**
- Upcoming International Airport 4 Km**
- CKT, DAV, St. Joseph & Rayan International Etc. within 3 Km range**
- Market near by**
- Hospitals near by**
- Banks near by**
- D Mart near by**
- Theaters 1 Km**



Panvel Railway Station



Panvel St Stand



Mumbai -Pune Highway



Up Coming Airport



Project By



KPS Enterprises
Builders & Developers

Panvel Office
Plot No. 24, Omkar Arcade, Shop No. 18/19,
Sec. 15A, Opp NewPanvel Railway St.,
New Panvel 410206.
Contact No. ☎ 77384 85151 / 81081 13355 / 11
Email - kpsenterprises2014@gmail.com

Architect
Jeetendra Parmar
Panvel

Legal Advisor
Advocate Sanjay K Kanade,
Panvel

* DISCLAIMER - All specifications amenities, pictures and other information provided in the advertisement are indicative. Conceptual and not a legal offering of the kind development proposed. Subject to the approval at the authorities, the developers reserve the rights to change the layout plans, specifications and features without prior notice or obligation at their sole discretion