

ARRIVE AT THE
Beautiful side of life
WITH PANACHE



Callisto
PANACHE YOURSELF!

**DISCOVER AN EXCLUSIVE LIFE
AT A FUTURISTIC DESTINATION**



**Not many, but very few are born to live life of a king.
Not all, but very few can address their home as a
heavenly lifestyle destination.**

You are the chosen one, because you belong to a home, called Callisto.
Welcome to a heaven, where life is all about celebrating moments.
Welcome to Callisto.



EXPERIENCE A LIFE NOTCH-HIGHER AT THE LANDMARK OF ELEGANCE



The Project:

Soaring 12 storeys high, Callisto is an iconic landmark of Ulwe stands true to your aspirations. Offering you lavish abodes with choicest amenities, Callisto brings you a life notch-higher located in the heart of Ulwe. More than just a dream home, Callisto is here to offer you exclusive extravagances that you cannot count on your fingertips.

- G+ 12 storeyed residential tower
- Offering premium 2 BHK & 3 BHK apartments
- Ample car parking
- Retail shops available on the ground floor
- In close proximity to sports complex
- Walking distance from Kharkopar Railway Station (Proposed)



PANACHE YOURSELF!



CELEBRATE TOGETHERNESS IN AN ELEGANT AMBIENCE



GROUND FLOOR PLAN

30.00 MT Wide Road

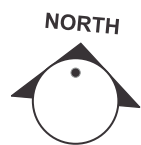

Step in to the happiness kingdom, where life welcomes you with unparalleled luxuries. With a plethora of recreational features, you can foster a sense of your inner calm at Callisto. Take a stroll in the serene garden or celebrate a majestic moment of togetherness at the modern clubhouse, at Callisto you can enjoy a life you have always dreamt of.

- Beautiful Entrance lobby
- Ample Car Parking



REJUVENATE YOUR SENSES WITH AN ARRAY OF AMENITIES



PODIUM PLAN

30.00 MT Wide Road



FIRST FLOOR PLAN

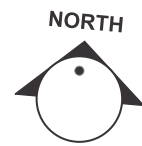

- Well-equipped children's play area
- Refreshing swimming pool with open deck area
- Rejuvenating jacuzzi
- Ultra-modern club house

More than just a living space, this magnificent landmark - Callisto presents you a complete rejuvenation package in an exotic environment radiating pure bliss. Being a sheer dweller's delight, it comes loaded with world-class facilities that add charm to your lifestyle making your life a journey of happiness.



Callisto
PANACHE YOURSELF!

3 BHK
ISOMETRIC VIEW



TYPICAL FLOOR PLAN
2, 4, 6, 8, 10, 12 EVEN FLOOR PLAN

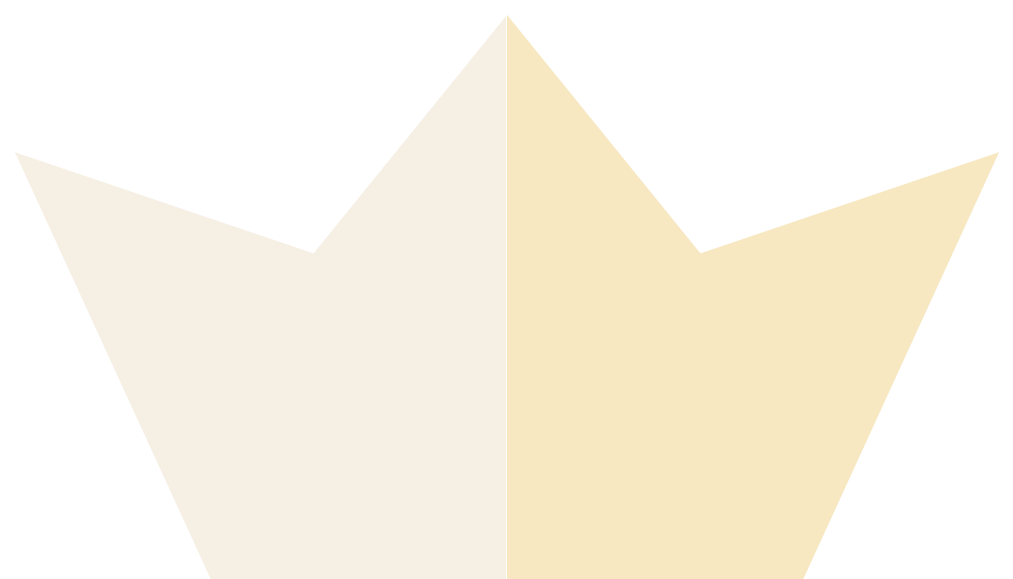
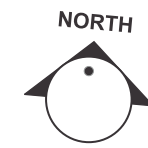

TYPICAL FLOOR PLAN
3, 5, 7, 9 & 11 ODD FLOOR PLAN

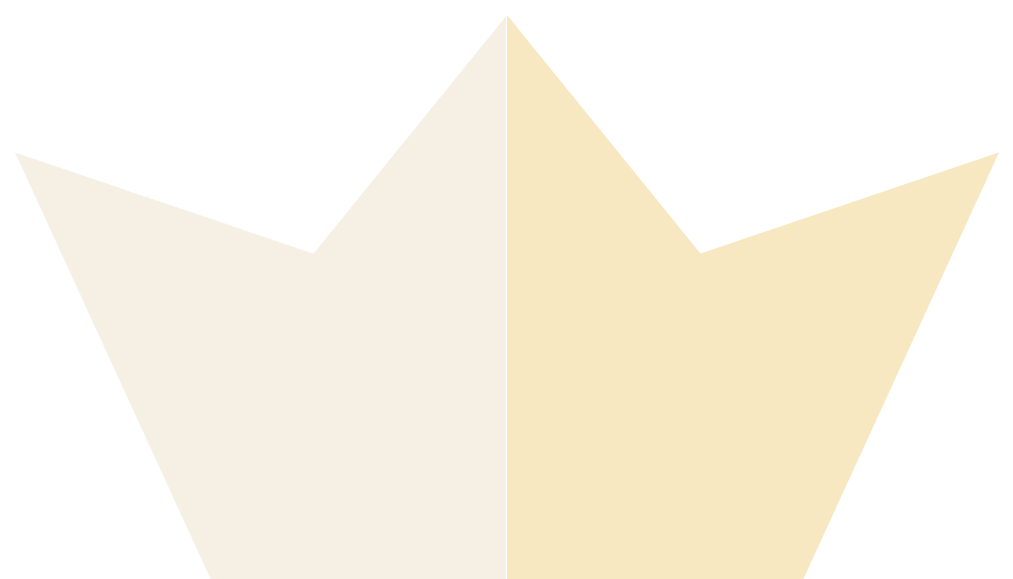
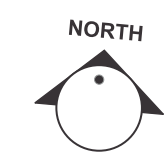



EXPLORE A HOME CRAFT WITH CLASS



Arrive at your abode that is crafted with grace, an atmosphere that pampers your senses. Equipped with elegant finishes specially chosen for you, spacious homes at Callisto offers you an ambience filled with sheer luxury.

Internal amenities

WALLS

- External Wall will be 6" thick
- Internal Partition Walls to be 4" .thick
- Sand for Plaster will be River Sand

FLOORING

- 32" X 32" Vitrified Flooring in all Rooms
- Antiskid Flooring in Bathroom, W.C. & Terrace

DOORS

- The Main Door will be Flush Door with Decorative Laminate Sheet fitting having Door Bell, Door Eye, beautiful Brass Handle, Safety Chain & Night Latch
- Bedroom will have Flush Door with Laminate sheet

KITCHEN

- S.S. Sink and Glazed Tiles up to Beam Height
- Granite Platform

WINDOWS

- Composite Marble in all Windows
- Anodized Sliding Windows

ELECTRIFICATION

- All Electric Points of Concealed Copper Wiring with Modular switches
- Ample Light Points in Parking Area

PLUMBING

- Concealed Plumbing Work, reputed make Bathroom Fittings
- Wash Basins
- Provision of Drinking Water Tap

PAINTINGS

- Acrylic Paint with Outer Textured for the External Face of the Building
- Plastic Emulsion Paint for the Internal Face of the Apartments

BATHROOM & W.C.

- Glazed Tiles in Bath & W.C. up to Beam Height with Modern Concepts

WATER SOURCE

- Provision of Separate Overhead and Underground Drinking Water Tank

OTHER UNIQUE FEATURES

- Good Quality Lift with power backup

DISCOVER A WORLD OF OPULENCE IN THE HEART OF ULWE

Located perfectly at one of the futuristic nodes of Navi Mumbai - Ulwe, Callisto is built keeping in mind the conveniences and proximity to all the major landmarks. Set amidst all the real advantages that you need in everyday life, this is your abode cuddled by Mother Nature.

Location advantages of Ulwe:

- Located near to the Proposed Navi Mumbai International Airport (NMIA)
- Easy accessibility to South Mumbai via Mumbai Trans Harbour Link (MTHL)
- Close proximity to the major business centers, shopping malls & educational institutes
- Offering well-organized sport complex with Football ground, Badminton court, Indoor Stadium etc.
- NMSEZ, JNPT and Central Business District Belapur is in close proximity

STRUCTURAL CONSULTANT

RAJESH LADAD

CONSULTING ARCHITECT

**STAPL
(SOYUZ TALIB)**

LEGAL ADVISOR

SUNIL GARG

Callisto
PANACHE YOURSELF!

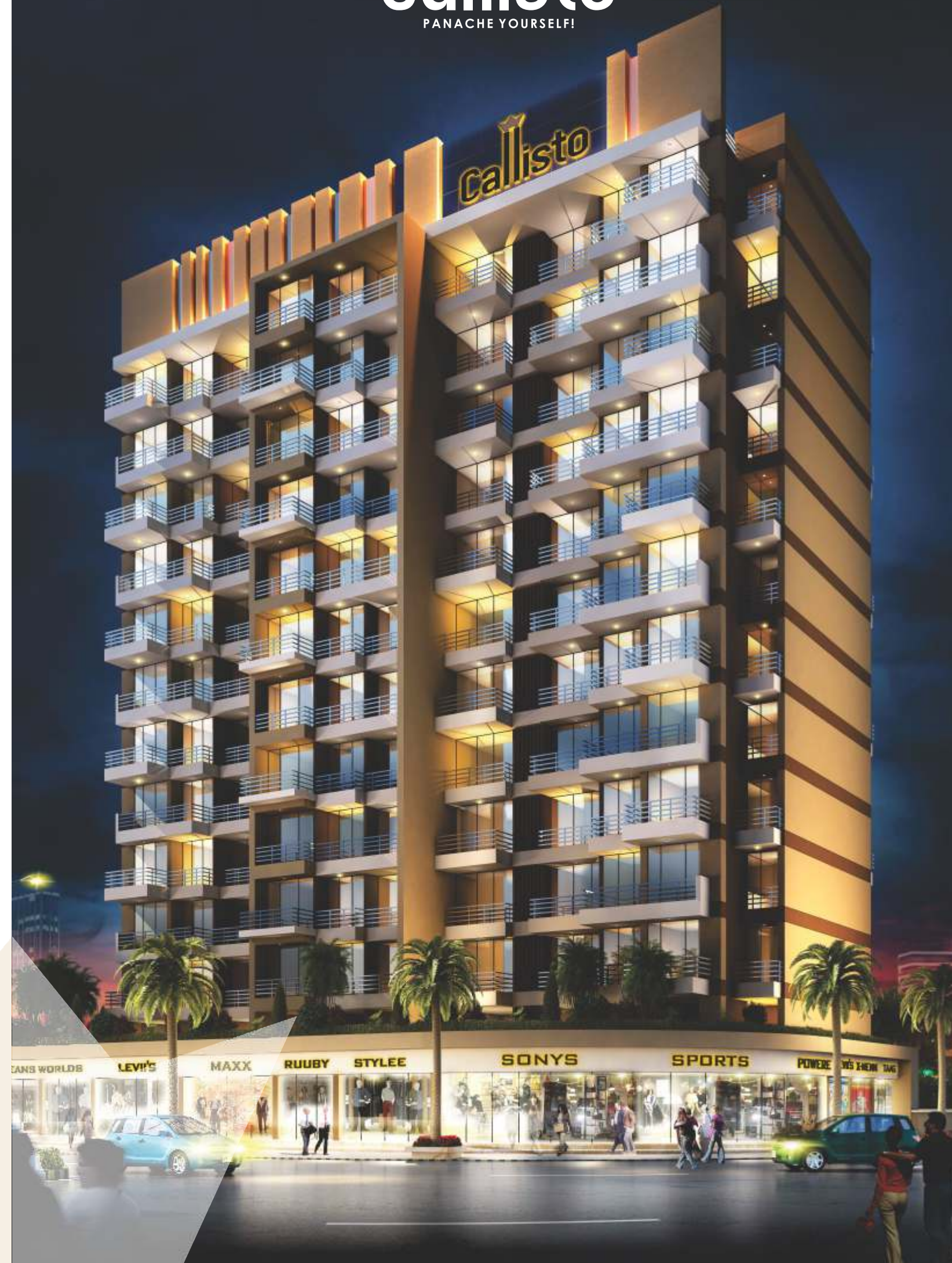

Callisto

PANACHE YOURSELF!



Location Plan

