



HOME FOR

ME & WE

Zenith

AT PUSHPANJALI RESIDENCY

**1 & 2 BHK Apartments
Thane (West)**

Your pursuit of happiness ends here well with joyful living amidst nature filled with lifestyle amenities, great connectivity and tranquility situated in the lap of Yeor Hills.

Artist Impression



HOME
WHERE
WE SMILE

Come home to an abode designed keeping everyone's need in mind.

Enjoy the serenity of nature and experience living in your spacious home where you can compliment work life balance beautifully and achieve Zenith of happiness.

Zenith

AT PUSHPANJALI RESIDENCY

1 & 2 BHK Apartments
Thane (West)



Artist Impression

HOME WHERE WE UNITE



Artist Impression

Welcoming you all to experience the most affluent lifestyle at the heart of Thane. Zenith introduces the ultra-modern & spacious 1 & 2 BHK homes with world-class amenities. Landscaped garden will fill your hearts with calmness & peace. The location will connect you exclusively with every corners of the city. At Zenith all your precious dreams would be preserved and fulfilled.

1 & 2 BHK LUXURY HOMES

SCENIC MOUNTAIN VIEW

ONE TOWER & 2 WINGS OF 30 STOREYS

AMPLE PARKING SPACE

DESIGNER ENTRANCE LOBBY



HOME WHERE WE REJOICE

Landscaped Garden

Children's Play Area

Swimming Pool in Club House

Nana Nani Park

Ample Parking

Fully – equipped Gymnasium

Meditation Room

Open Terrace for Parties

Indoor Game Zone

Jogging Track

Multipurpose Lounge



Artist Impression



Artist Impression



Artist Impression

PROJECT HALLMARKS

- Structural Advantages
- Earthquake Resistant Structure
- Environment - Friendly Construction
- Efficient Construction Technique

APARTMENT SPECIFICATIONS

■ Flooring

- 2 x 2 Vitrified Tiles in all rooms

■ Door & Window:

- All Windows with Marble Frames
- Molded shutter main door with Polish / Enamel Paint

- Flush / Molded door with Enamel Paint
- Powder - coated Aluminum Windows

■ Kitchen:

- Polished Granite platform with Dado Tiles up to full height
- Stainless steel Sink

■ Bath & Sanitary Fittings:

- Anti-skid Ceramic Tiles for Flooring
- Glazed Ceramic Tiles Dado up to full height in shower area

- Concealed Plumbing with Hot & Cold water mixer
- 'A' Class Sanitary Fittings
- High Quality Sanitary ware
- High Quality Sanitary ware with wash basin
- Elegant Water closet

■ Electrical & Lighting:

- Branded ISI mark modular switches
- MCB and phase changers

- Concealed wiring in Copper Conductor
- Adequate Lighting of common areas
- Generator Back - up for lifts & common area

■ Paint & Exterior:

- Smooth Plaster Finish Internal wall with oil bound distemper
- Sand- faced plaster finish external walls with good quality cement / acrylic paint



Artist Impression



Artist Impression



REG. RERA NO. P51700008949
www.maharera.online.gov.in

Zenith

AT PUSHPANJALI RESIDENCY

1 & 2 BHK Apartments
Thane (West)

Artist Impression

Location Map

Towards Borivali



PROXIMITY

Ghodbunder Road 5 Mins (Walk)

Vedant Hospital 5 Mins (Walk)

Garib Nagar Bus Stop 5 Mins (Walk)

Banks 5 Mins (Walk)

Hyper City 5 Mins (Drive)

G Corp Tech Park 5 Mins (Drive)

Restaurants 5 Mins (Drive)

Kasarvadavli Proposed Metro Station
5 Mins (Drive)

Viviana Mall 10 Mins (Drive)

Thane Station 20 Mins (Drive)

G Corp Tech Park

Towards Thane

PARADIGM REALTY'S OTHER CREATIONS



NIVAN
Khar (West)
RERA NO : P51800011423



VOGUE
Santacruz (West)
OC & BCC Received



HUBTOWN PREMIERE
Versova-Lokhandwala
PROJECT RERA ID : MALIBU : P51800005224
BEVERLY : P51800002671 | BEL AIR : P51800005688



ANANDA RESIDENCY
Borivali (West)
RERA NO : P51800000204



ARIANA RESIDENCY
Borivali (East)
RERA NO : P51800008691



CASA PALAZZO
Borivali (East)
RERA NO : P51800008441

Zenith
AT PUSHPANJALI RESIDENCY



IN ASSOCIATION WITH

RAM DEVELOPERS



REG. RERA NO. P51700008949

www.maharera.online.gov.in

Disclaimer: The information, layout, pictures etc. shown/ contained in this brochure are indicative only. The Builder/ Developer shall not be liable, responsible, obligated and/ or required to provide any/ or all such amenities, specification etc. as contained in this brochure. All plans, drawings, information, amenities, layout etc. are subject to approval from all the concerned authorities. The Builder/ Developer shall have irrevocable and unconditional right to change, delete, substitute, alter, subtract, add, amend etc. the said plans, drawings, information, specification, amenities, layout etc. in such manner as the Builder/ Developer may deem fit. No right of any nature whatsoever shall be construed and/ or deemed to have accrued in favour of any person and/ or purchaser of the premises from or by virtue of this brochure. The Builder/ Developer shall not be liable and/ or responsible for any loss, damages, cost, charges, expenses suffered/ incurred and/ or likely to be suffered and/ or incurred by any person and/ or purchaser of the premises. No person or purchaser of the premises shall have any right or be entitled to claim more for any right based on this brochure.

Ghodbunder Road

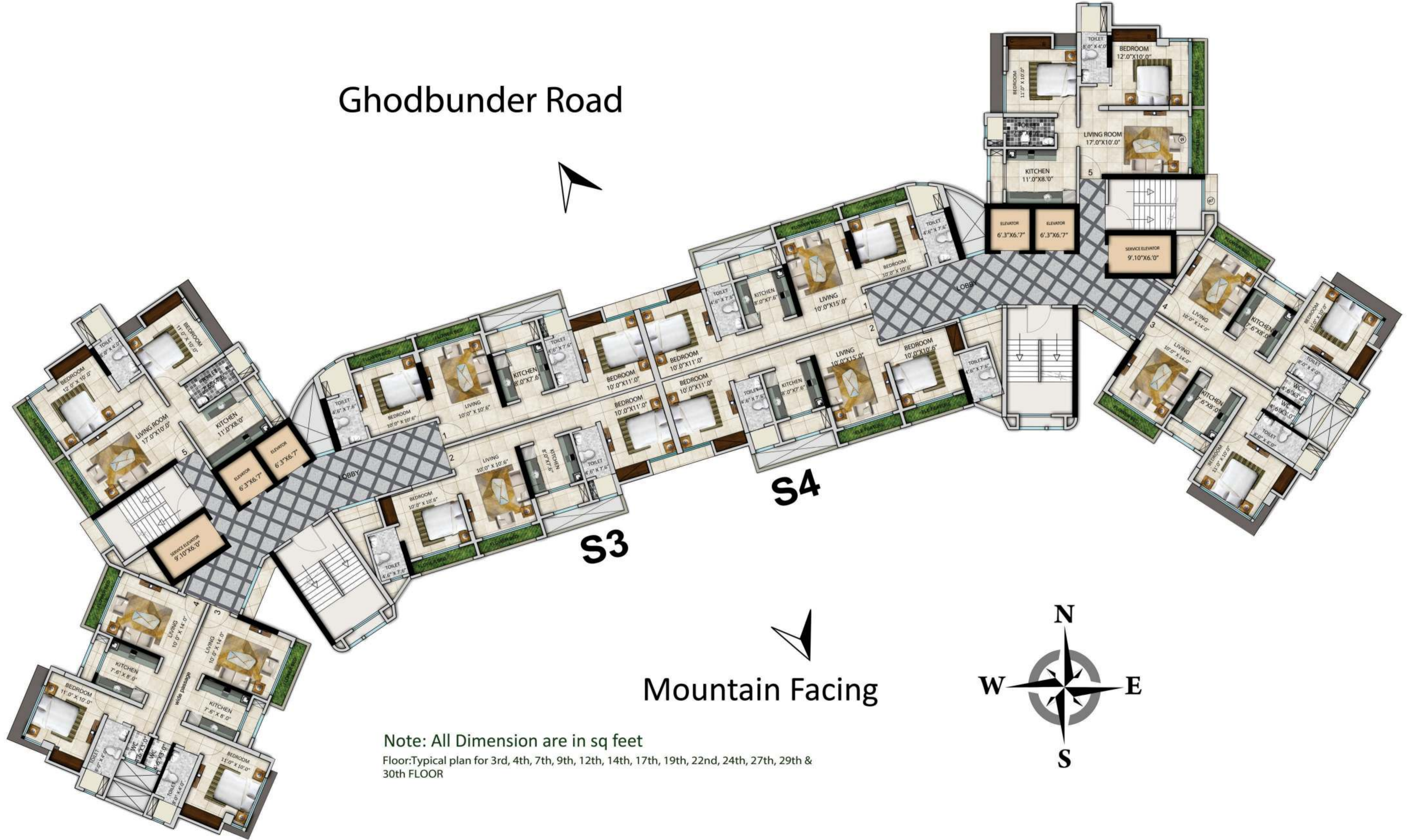

S4

S3

Mountain Facing



Note: All Dimension are in sq feet
Floor: Typical plan for 3rd, 4th, 7th, 9th, 12th, 14th, 17th, 19th, 22nd, 24th, 27th, 29th & 30th FLOOR

Ghodbunder Road

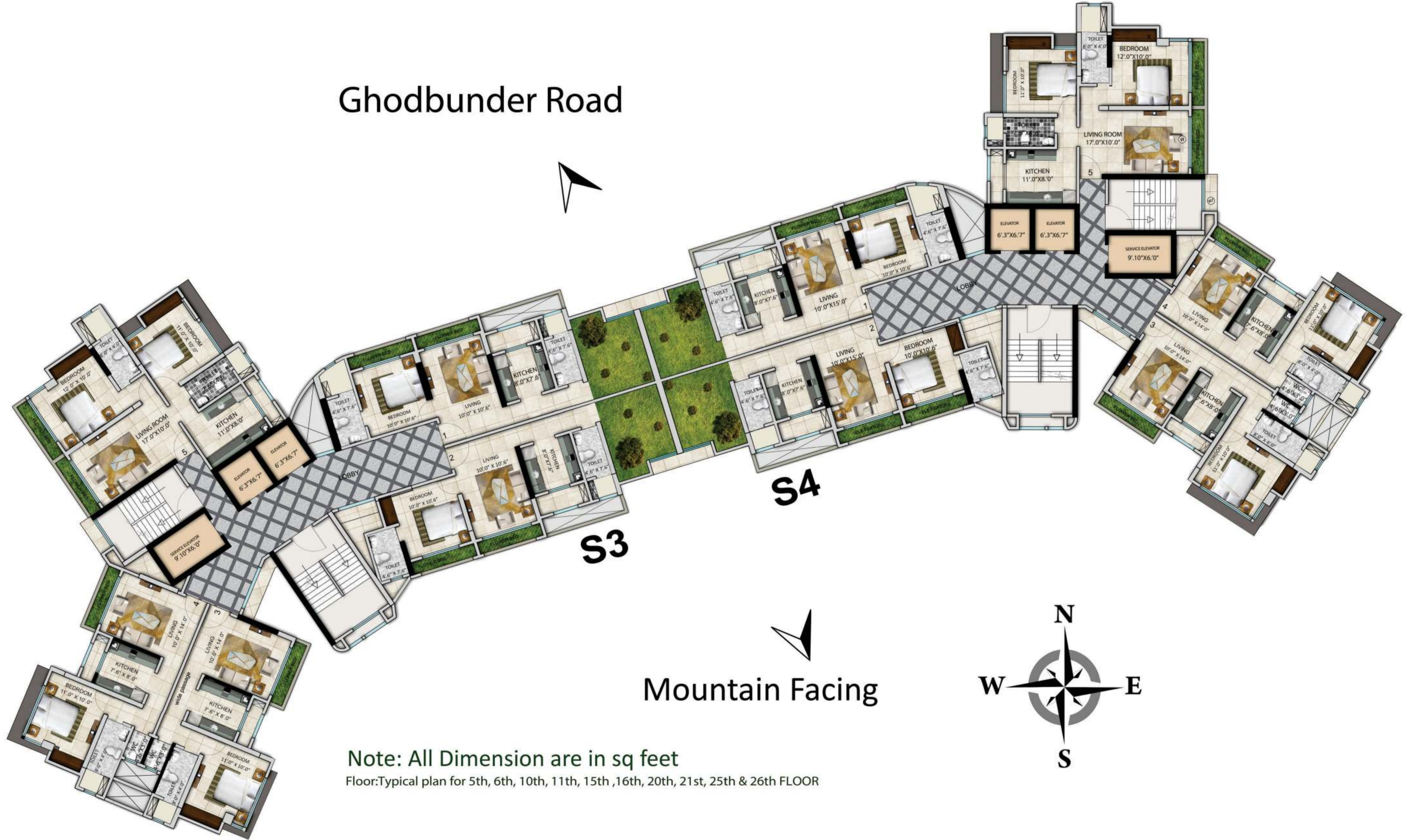

S4

S3

Mountain Facing



Note: All Dimension are in sq feet

Floor: Typical plan for 5th, 6th, 10th, 11th, 15th, 16th, 20th, 21st, 25th & 26th FLOOR